

PH0010111

**NATIONAL REGISTER OF HISTORIC PLACES
INVENTORY - NOMINATION FORM**

(Type all entries - complete applicable sections)

STATE: Alabama	
COUNTY: Mobile	
FOR NPS USE ONLY	
ENTRY NUMBER 10-2-05- 006 0004	DATE 2/26/70

1. NAME

COMMON: *(Raphael)*
Admiral Semmes Home

AND/OR HISTORIC:
Admiral Raphael Semmes Home

2. LOCATION

STREET AND NUMBER:
804 Government Street

CITY OR TOWN:
Mobile

STATE: Alabama CODE: 01 COUNTY: Mobile CODE: 097

3. CLASSIFICATION

CATEGORY (Check One)	OWNERSHIP	STATUS	ACCESSIBLE TO THE PUBLIC
<input type="checkbox"/> District <input checked="" type="checkbox"/> Building <input type="checkbox"/> Site <input type="checkbox"/> Structure <input type="checkbox"/> Object	<input type="checkbox"/> Public <input checked="" type="checkbox"/> Private <input type="checkbox"/> Both	Public Acquisition: <input type="checkbox"/> In Process <input type="checkbox"/> Being Considered	<input checked="" type="checkbox"/> Occupied <input type="checkbox"/> Unoccupied <input type="checkbox"/> Preservation work in progress
PRESENT USE (Check One or More as Appropriate)			
<input type="checkbox"/> Agricultural <input type="checkbox"/> Commercial <input checked="" type="checkbox"/> Educational <input type="checkbox"/> Entertainment	<input type="checkbox"/> Government <input type="checkbox"/> Industrial <input type="checkbox"/> Military <input type="checkbox"/> Museum	<input type="checkbox"/> Park <input type="checkbox"/> Private Residence <input checked="" type="checkbox"/> Religious <input type="checkbox"/> Scientific	<input type="checkbox"/> Transportation <input type="checkbox"/> Other (Specify) _____ <input type="checkbox"/> Comments _____

4. OWNER OF PROPERTY

OWNER'S NAME:
First Baptist Church

STREET AND NUMBER:
806 Government Street

CITY OR TOWN: Mobile STATE: Alabama CODE: 01

5. LOCATION OF LEGAL DESCRIPTION

COURTHOUSE, REGISTRY OF DEEDS, ETC.:
Mobile County Court House

STREET AND NUMBER:
South Royal Street

CITY OR TOWN: Mobile STATE: Alabama CODE: 01

6. REPRESENTATION IN EXISTING SURVEYS

TITLE OF SURVEY:
Historic American Building Survey

DATE OF SURVEY: Federal State County Local

DEPOSITORY FOR SURVEY RECORDS:
Library of Congress

STREET AND NUMBER:

CITY OR TOWN: Washington STATE: D. C. CODE: 08

SEE INSTRUCTIONS

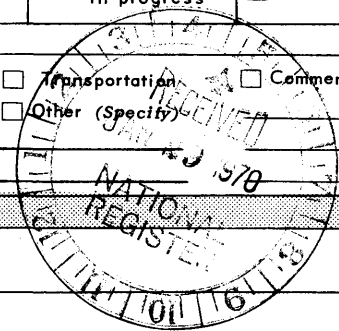

STATE: Alabama
COUNTY: Mobile
FOR NPS USE ONLY
ENTRY NUMBER
DATE

7. DESCRIPTION

CONDITION	(Check One)					
	<input checked="" type="checkbox"/> Excellent	<input type="checkbox"/> Good	<input type="checkbox"/> Fair	<input type="checkbox"/> Deteriorated	<input type="checkbox"/> Ruins	<input type="checkbox"/> Unexposed
	(Check One)			(Check One)		
	<input checked="" type="checkbox"/> Altered	<input type="checkbox"/> Unaltered	<input type="checkbox"/> Moved	<input checked="" type="checkbox"/> Original Site		

DESCRIBE THE PRESENT AND ORIGINAL (if known) PHYSICAL APPEARANCE

STYLE: Transitional Federal Period
 Greek Revival with typical Gulf Coast cast iron added.

PLAN: Composed of two rectangles united at their corners and accessible to one another by exterior only. Larger rectangle: main living area; smaller rectangle: kitchen, storage and servants quarters. Main living area typical townhouse plan with hall and stairs to one side and virtually square rooms, two-deep to the other.

MATERIALS AND METHODS OF CONSTRUCTION: Brick bearing walls with wood roof and floor framing. Plaster interior walls and slate roof. Wooden porches connecting building parts in the rear. Face brick with thin mortar joints at main facade only. Common brick and thick joints through rest of structure.

EXTERIOR APPEARANCE: Brick structure, simple and austere with thin corbeled cornice, high pitched roof, end walls extending above roof line. Windows spanned by brick arches, covered with plaster on main facade. Small stucco basement at main building. High pitched roof, double chimneys both ends of main building.

SCALE AND PROPORTION: Dignified in overall composition but residential in scale by virtue of window placements and thin cornice, and delicate wood detailing especially in the front door.

INTERIOR APPEARANCE: Greek Revival wood detailing at doors, windows and mouldings..typical of LaFever carpentry. Complex plaster rosettes for ceiling light fixtures. Highly refined turned balusters at main stair. Iron and marble fireplace and mantle.

IRONWORK: Cast iron porch railings, steps and gallery.

PRESENT: Shutters added later. Partition between two front rooms removed to form one large room, length of east side of building. Large room used today as a Sunday School classes, and other church activities.

BUILT: In 1858 by Peter Horta

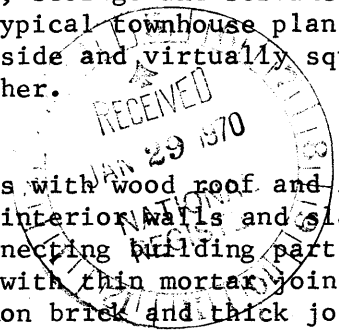

SEE INSTRUCTIONS

SIGNIFICANCE

PERIOD (Check One or More as Appropriate)

- Pre-Columbian | 16th Century | 18th Century | 20th Century
 15th Century | 17th Century | 19th Century

SPECIFIC DATE(S) (If Applicable and Known)

AREAS OF SIGNIFICANCE (Check One or More as Appropriate)

- | | | | |
|--|--|--|--|
| <input type="checkbox"/> Aboriginal | <input type="checkbox"/> Education | <input type="checkbox"/> Political | <input type="checkbox"/> Urban Planning |
| <input type="checkbox"/> Prehistoric | <input type="checkbox"/> Engineering | <input type="checkbox"/> Religion/Philosophy | <input type="checkbox"/> Other (Specify) |
| <input checked="" type="checkbox"/> Historic | <input type="checkbox"/> Industry | <input type="checkbox"/> Science | _____ |
| <input type="checkbox"/> Agriculture | <input type="checkbox"/> Invention | <input type="checkbox"/> Sculpture | _____ |
| <input checked="" type="checkbox"/> Architecture | <input type="checkbox"/> Landscape | <input type="checkbox"/> Social/Humanitarian | _____ |
| <input type="checkbox"/> Art | <input type="checkbox"/> Literature | <input type="checkbox"/> Theater | _____ |
| <input type="checkbox"/> Commerce | <input checked="" type="checkbox"/> Military | <input type="checkbox"/> Transportation | _____ |
| <input type="checkbox"/> Communications | <input type="checkbox"/> Music | | _____ |
| <input type="checkbox"/> Conservation | | | _____ |

STATEMENT OF SIGNIFICANCE

Admiral Raphael Semmes, the most famous Confederate Naval hero of the Civil War, lived in this home from 1871 until his death in 1879.

Admiral Semmes commanded the Confederate raiders Sumter and Alabama. The CSS Alabama captured more than 60 Union ships between 1862 and 1864, and destroyed property with a total estimated value of \$6,500,000. This figure was more than 40 percent of \$15,500,000 damage inflicted on Union vessels by the Alabama and all other Confederate ships. Semmes commanded the Alabama from its commissioning to its sinking by the USS Kearsarge off the coast of France in June, 1864. Rescued by British seamen, Semmes was taken to London and smuggled back to the South where he became possibly the only man in modern military history to hold the rank of an admiral as well as that of a brigadier general. He commanded coastal land forces during the dying months of the Confederacy.

Born on September 27, 1809 in Charles County, Maryland, Semmes went to sea at the age of 15. President John Quincy Adams appointed him a Midshipman Apprentice in 1826. He was graduated the first in his class as a Passed Midshipman in 1832. Between 1832 and 1860, Semmes was a member of the U. S. Navy and participated in the Mexican War. He studied law, passed the bar and practiced law in Alabama from 1842 until 1860 when not busy with Naval duties. Semmes moved his family from Baldwin County to the City of Mobile in 1849.

Admiral Semmes was tried but found innocent of crimes against the Union after the Civil War. He returned to the South and taught briefly at Louisiana State University. Admiral Semmes spent the last 10 years of his life practicing law in Mobile in the state for which his famous ship was named.

Admiral Raphael Semmes was elected to the first Alabama Hall of Fame in 1953.

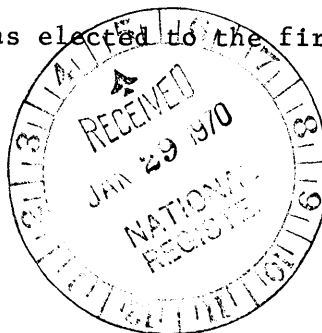

SEE INSTRUCTIONS

9 MAJOR BIBLIOGRAPHICAL REFERENCES

Brown, Virginia Pounds and Helen Morgan Akens. Alabama Heritage. Huntsville: The Strode Publishers, 1967.
 DeLeon, Thomas C. Four Years in Rebel Capitals. Mobile: The Gossip Printing Company, 1892.
 Hamilton, Peter. Mobile of the Five Flags. Mobile: Gill Printing Co., 1913.
 Hammond, Ralph. Ante-Bellum Mansions of Alabama. New York: Bonanza Books, 1951.
 McMillan, Dr. M. C. The Land Called Alabama. Austin: Steck-Vaughan Co., 1968.
 National League of American Pen Women. Historic Homes of Alabama and Their Traditions. Birmingham: Birmingham Publishing Company, 1935.

10 GEOGRAPHICAL DATA

LATITUDE AND LONGITUDE COORDINATES DEFINING A RECTANGLE LOCATING THE PROPERTY			O R	LATITUDE AND LONGITUDE COORDINATES DEFINING THE CENTER POINT OF A PROPERTY OF LESS THAN TEN ACRES		
CORNER	LATITUDE	LONGITUDE		LATITUDE	LONGITUDE	
	Degrees Minutes Seconds	Degrees Minutes Seconds		Degrees Minutes Seconds	Degrees Minutes Seconds	
NW	30° 41' 12.3"	88° 0' 2" 22"		30° 41' 12.5"	88° 0' 2" 22"	
NE	° ' "	° ' "				
SE	° ' "	° ' "				
SW	° ' "	° ' "				

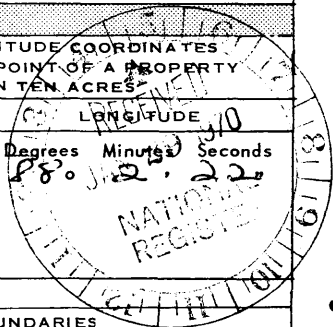

APPROXIMATE ACREAGE OF NOMINATED PROPERTY: .136 acres

LIST ALL STATES AND COUNTIES FOR PROPERTIES OVERLAPPING STATE OR COUNTY BOUNDARIES

STATE:	CODE	COUNTY	CODE
All in Mobile, Alabama	01	Mobile	097
STATE:	CODE	COUNTY:	CODE
STATE:	CODE	COUNTY:	CODE
STATE:	CODE	COUNTY:	CODE

11 FORM PREPARED BY

NAME AND TITLE: W. Warner Floyd, Executive Director, Alabama Historical Comm.; Margaret Rose Ingate, Mobile; Michael Fazzio, Architect, City Planning Comm.

ORGANIZATION: Alabama Historical Commission DATE: December, 1969

STREET AND NUMBER: 305 South Lawrence Street

CITY OR TOWN: Montgomery STATE: Alabama CODE: 01

12. STATE LIAISON OFFICER CERTIFICATION NATIONAL REGISTER VERIFICATION

<p>As the designated State Liaison Officer for the National Historic Preservation Act of 1966 (Public Law 89-665), I hereby nominate this property for inclusion in the National Register and certify that it has been evaluated according to the criteria and procedures set forth by the National Park Service. The recommended level of significance of this nomination is:</p> <p>National <input type="checkbox"/> State <input checked="" type="checkbox"/> Local <input type="checkbox"/></p> <p>Name <u>Nils B. Howard, Jr.</u></p> <p>Title <u>Chairman, Alabama Historical Commission, SLO</u></p> <p>Date <u>Jan. 25, 1970</u></p>	<p>I hereby certify that this property is included in the National Register.</p> <p><u>Ernest Allen Connolly</u> Chief, Office of Archeology and Historic Preservation</p> <p>FEB 26 1970</p> <p>Date _____</p> <p>ATTEST:</p> <p><u>William J. Hurlburt</u> Keeper of The National Register</p> <p>Date <u>FEB 17 1970</u></p>
---	---

SEE INSTRUCTIONS

NATIONAL REGISTER OF HISTORIC PLACES
INVENTORY - NOMINATION FORM

(Continuation Sheet)

STATE	Alabama	
COUNTY	Mobile	
FOR NPS USE ONLY		
ENTRY NUMBER	70-2-05	DATE
	009	1/26/70
	0004	

(Number all entries)

ADMIRAL SEMMES HOME

9. MAJOR BIOGRAPHICAL REFERENCES

Summersell, Dr. Charles G. Alabama History for Schools.
Birmingham: Colonial Press, 1961.

Whitney, David C., managing editor. The World Book Encyclopedia,
Volume A. Chicago: Field Enterprises Educational
Corporation, 1962.

_____. Files. Located in First Baptist Church, Mobile.

