

United States Department of the Interior
National Park Service

National Register of Historic Places
Registration Form

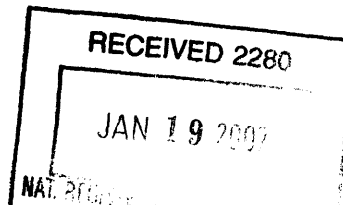

This form is for use in nominating or requesting determinations for individual properties and districts. See instructions in *How to Complete the National Register of Historic Places Registration Form* (National Register Bulletin 16A). Complete each item by marking "X" in the appropriate box or by entering the information requested. If any item does not apply to the property being documented, enter "N/A" for "not applicable." For functions, architectural classification, materials, and areas of significance, enter only categories and subcategories from the instructions. Place additional entries and narrative items on continuation sheets (NPS Form 10-900a). Use a typewriter, word processor, or computer, to complete all items.

1. Name of Property

historic name IOOF Lodge #355

other names/site number _____

2. Location

street & number 18819 East State Highway 88 n/a not for publication

city or town Clements n/a vicinity

state California code CA county San Joaquin code 077 zip code 95227

3. State/Federal Agency Certification

As the designated authority under the National Historic Preservation Act of 1986, as amended, I hereby certify that this nomination request for determination of eligibility meets the documentation standards for registering properties in the National Register of Historic Places and meets the procedural and professional requirements set forth in 36 CFR Part 60. In my opinion, the property meets does not meet the National Register Criteria. I recommend that this property be considered significant nationally statewide locally. (See continuation sheet for additional comments.)

[Signature] 16 JAN 2007
Signature of certifying official/Title Date

California Office of Historic Preservation
State or Federal agency and bureau

In my opinion, the property meets does not meet the National Register criteria. (See continuation sheet for additional comments.)

Signature of commenting or other official Date

State or Federal agency and bureau

4. National Park Service Certification

I hereby certify that this property is:

- entered in the National Register
 See continuation sheet.
- determined eligible for the National Register
 See continuation sheet.
- determined not eligible for the National Register
- removed from the National Register
- other (explain): _____

[Signature] Signature of the Keeper
Edson H. Beall Date of Action
3.1.07

5. Classification

Ownership of Property
(Check as many boxes as apply)

- private
- public-local
- public-State
- public-Federal

Category of Property
(Check only one box)

- building(s)
- district
- site
- structure
- object

Number of Resources within Property
(Do not include previously listed resources in the count.)

Contributing	Noncontributing	
1		buildings
		sites
		structures
		objects
1		Total

Name of related multiple property listing
(Enter "N/A" if property is not part of a multiple property listing.)

n/a

Number of contributing resources previously listed in the National Register

6. Function or Use

Historic Functions
(Enter categories from instructions)

Social/

Meeting Place

Current Functions
(Enter categories from instructions)

Commerce/

Trade- Specialty Store

7. Description

Architectural Classification
(Enter categories from instructions)

No Style

Materials
(Enter categories from instructions)

foundation Concrete

roof Wood

walls Brick

other _____

Narrative Description

(Describe the historic and current condition of the property on one or more continuation sheets.)

8. Statement of Significance

Applicable National Register Criteria

(Mark "x" in one or more boxes for the criteria qualifying the property for National Register listing)

- A Property is associated with events that have made a significant contribution to the broad patterns of our history.
- B Property is associated with the lives of persons significant in our past.
- C Property embodies the distinctive characteristics of a type, period, or method of construction or represents the work of a master, or possesses high artistic values, or represents a significant and distinguishable entity whose components lack individual distinction.
- D Property has yielded, or is likely to yield information important in prehistory or history.

Criteria Considerations

(Mark "X" in all the boxes that apply.)

Property is:

- A owned by a religious institution or used for religious purposes.
- B removed from its original location.
- C a birthplace or a grave.
- D a cemetery.
- E a reconstructed building, object, or structure.
- F a commemorative property.
- G less than 50 years of age or achieved significance within the past 50 years.

Areas of Significance

(Enter categories from instructions)

Social History

Period of Significance

1917-1956

Significant Dates

N/A

Significant Person

(Complete if Criterion B is marked above)

N/A

Cultural Affiliation

N/A

Architect/Builder

N/A

Narrative Statement of Significance

(Explain the significance of the property on one or more continuation sheets.)

9. Major Bibliographical References

(Cite the books, articles, and other sources used in preparing this form on one or more continuation sheets.)

Previous documentation on file (NPS):

- preliminary determination of individual listing (36 CFR 67) has been requested.
- previously listed in the National Register
- previously determined eligible by the National Register
- designated a National Historic Landmark
- recorded by Historic American Buildings Survey # _____
- recorded by Historic American Engineering Record # _____

Primary Location of Additional Data

- State Historic Preservation Office
- Other State agency
- Federal agency
- Local government
- University
- Other _____

Name of repository:

IOOF Lodge # 355
Name of Property

San Joaquin County, CA
County and State

10. Geographical Data

Acreage of Property 1.12

UTM References

(Place additional UTM references on a continuation sheet)

	Zone	Easting	Northing		Zone	Easting	Northing
1	10	667700	4228600	3	---	---	---
2	---	---	---	4	---	---	---

See continuation sheet.

Verbal Boundary Description

(Describe the boundaries of the property on a continuation sheet.)

Boundary Justification

(Explain why the boundaries were selected on a continuation sheet.)

11. Form Prepared By

name/title Sarah Sutherland

organization Chocoholics Divine Desserts date June 20, 2006

street & number 18819 East Highway 88 telephone (209) 759-3340

city or town Clements state CA zip code 95227

Additional Documentation

Submit the following items with the completed form:

Continuation Sheets

Maps

A **USGS map** (7.5 or 15 minute series) indicating the property's location.

A **Sketch map** for historic districts and properties having large acreage or numerous resources.

Photographs

Representative **black and white photographs** of the property.

Additional items

(Check with the SHPO or FPO for any additional items)

Property Owner

(Complete this item at the request of the SHPO or FPO.)

Name Ernie Schenone Jr.

street & number 18819 East Highway 88 telephone (209) 759-3340

city or town Clements state CA zip code 95227

Paperwork Reduction Act Statement: This information is being collected for applications to the National Register of Historic Places to nominate properties for listing or determine eligibility for listing, to list properties, and to amend existing listings. Response to this request is required to obtain a benefit in accordance with the National Historic Preservation Act, as amended (16 U.S.C. 470 *et seq.*).

Estimated Burden Statement: Public reporting burden for this form is estimated to average 18.1 hours per response including the time for reviewing instructions, gathering and maintaining data, and completing and reviewing the form. Direct comments regarding this burden estimate or any aspect of this form to the Chief, Administrative Services Division, National Park Service, P.O. Box 37127, Washington, DC 20013-7127; and the Office of Management and Budget, Paperwork Reductions Project (1024-0018), Washington, DC 20503.

**United States Department of the Interior
National Park Service**

**National Register of Historic Places
Continuation Sheet**

Section number 7 Page 1

IOOF Lodge #355 San Joaquin County, CA

Narrative Description of Physical Appearance

The former Clements Odd Fellows Hall was constructed in March of 1917 and was completed in September of the same year. The building was designed to provide space for Odd Fellows activities and was a focal point for social and fraternal meetings in Clements for years. Date of restoration began in March of 2004 and was completed in March of 2005 according to the Secretary of Interior Standards, for the treatment of historic properties.

The lodge is a two story, flat roofed, unpainted brick building, rectangular in shape. It features pilasters, evenly spaced arched, double hung sash windows on the first and second floors. A small parapet surrounds the roof. The main entry is on the south façade and features a wood glazed door with a sidelight. Another entrance on the west façade is set with a wood door with a transom window. The earliest located historic photograph that depicts the painted IOOF sign is from 1983. The first floor of the building has been altered as the original lathe and plaster has been replaced by painted wood paneling. The building is relatively close to Highway 88 and therefore a low brick wall and a fence with brick and concrete supports were added in 2004 and are used as a physical barrier for pedestrian safety. On the east, extended pilasters are used to blend and transition from the newly constructed chocolate factory to the east of the existing building during the building's restoration.

On the interior, the first floor is divided into two principal spaces, as large open space in the front, and smaller kitchen area behind. The kitchen currently contains cabinets that were not part of the original design (date unknown). The kitchen was used to prepare refreshments at the close of meetings by the birthday committee of the Rebecca Lodge. The first and second floor, both have the original wood flooring.

The second floor contains the rooms mostly used by the Odd Fellows and was dedicated to Lodge meetings. It consists of two restrooms, the original wood staircase and flooring, the old fashioned pews and chairs, and an ante room where the men would change before entering the meeting room. On the entrance door into the meeting room are the original peepholes used by the Odd Fellows to get a view as to who was seeking to enter. This room retains original appearance although it contains no significant architectural detailing of any kind.

An outside restroom was added at an unknown time. This has been demolished and removed.

United States Department of the Interior
National Park Service

National Register of Historic Places
Continuation Sheet

Section number 8 Page 1 IOOF Lodge #355 San Joaquin County, CA

The Independent Order of Odd Fellows (I.O.O.F) Lodge #355 is being nominated to the National Register under Criterion A at the local level of significance in the area of social history for its association with the I.O.O.F. and the important role the organization played in the town of Clements. The period of significance begins in 1917 with the construction of the meeting hall and ends with the arbitrary cutoff date 1956.

Background of the I.O.O.F.

The Odd Fellows is a fraternal organization that started in England in the 1700s as a "convivial society, a product of the working-class tavern culture."¹ Between 1790 and 1796 there were several independent Odd Fellow lodges in England. The independence of these lodges is attributed to the government's suppression of "...all seditious gatherings, and to interdict the unlawful administering of oaths by secret societies." To avoid suspicion, the Odd Fellows suspended large, public meetings. In 1803 the organization was revived and formed the London Union Odd Fellows, which later became the Grand Lodge of England. The Grand Lodge assumed authority over all lodges in England. The Manchester Unity was one of many Orders of Odd Fellows that existed in the nineteenth century, and at its 1813 convention it was agreed that they would unite under the title The Manchester Unity of the Independent Order of Odd Fellows (Manchester Unity). By uniting the Manchester Unity, favored uniformity in the work and general rules and laws of the Order and enlarging its benevolent and charitable acts.

American Odd Fellow lodges trace their existence to English immigrants and the first lodge was established in Baltimore, Maryland in 1819. The American lodges tended to follow the Manchester Unity model, practiced reciprocal relief, helped newly immigrated members find employment, and offered other forms of charity. In 1844 the American Odd Fellows formed the Independent Order of Odd Fellows (I.O.O.F) and disassociated themselves with the Manchester Unity. As the United States expanded its borders west, the I.O.O.F. followed. The first official charter for California Lodge No. 1 was in 1849 in San Francisco.² This lodge was soon followed by lodges in Sacramento, Eureka, Yuba, Stockton, Auburn and El Dorado. By 1900 the I.O.O.F. in America had reached one million members.³

¹ Mary Ann Clawson, *Constructing Brotherhood: Class, Gender and Fraternalism* (Princeton: Princeton University Press, 1989), 118.

² Don R. Smith and Wayne Roberts, *The Three Link Fraternity - Odd Fellowship in California, An Introduction to the Independent Order of Odd Fellows and Rebekas* (Linden, Calif.: Linden Publications, 1993), at http://www.ioof.org/ioof_history.htm, available online, accessed August 16, 2006; Henry Leonard Stillson, ed., *The History and Literature of Odd Fellowship The Three Link Fraternity* (Boston: The Fraternity Publishing Company, 1897), 389.

³ Clawson, *Constructing Brotherhood*, 121, 123, 7.

**United States Department of the Interior
National Park Service**

**National Register of Historic Places
Continuation Sheet**

Section number 8 Page 2 IOOF Lodge #355 San Joaquin County, CA

American fraternal organizations were common and numerous at the turn of the century, and nearly forty percent of all adult men belonged to at least one lodge, with many joining more than one.⁴ Like most fraternal organizations the Odd Fellows offered insurance and some economic relief for their members. Funeral expenses were paid for by the lodges, and the widows and children were also offered extra funds. The Odd Fellows offered “friendship, fellowship, and social integration to newcomers and immigrants.”⁵ “At the local level, the lodges represented their organization’s nationwide efforts to establish ties of brotherhood and mutual aid among members and reflected a broader social purpose characterized by charitable work and educational fund-raising.”⁶

The I.O.O.F. was the first fraternal organization to recognize the women auxiliary that developed. The Daughters of the Rebekah were originally an honorary degree given to the women associated with the I.O.O.F. Their purpose was to administer to the women, care for widows, poverty stricken women, the sick and infirmed. In 1867 the women were incorporated into the order, but the lodges were run by the Odd Fellow men. That changed in 1878 when women became eligible to head local lodges and preside over meetings.

Clements’ I.O.O.F.

The town of Clements was laid out in 1882 on land owned by Thomas Clements and S. L. Magee after the San Joaquin-Sierra Nevada Railroad reached the area. Clements had already established several businesses and the town continued to grow in the early twentieth century.⁷ I.O.O.F. Lodge #355 was established on December 4, 1889. The original charter members of the organization were: W. Buckenau, a 34 year old Blacksmith, Noble Grand; John Harris, a 35 year old Rancher, Vice Grand; R.H. Beard, a 28 year old Clerk, Secretary; E.H. Plummer, a 46 year old Butcher, and George Grey age 62 as members. Membership in the I.O.O.F. Lodge grew rapidly as the town expanded.

Prior to construction of the lodge I.O.O.F. meetings were held in the community hall above the blacksmith shop every Wednesday at 7pm and later over the Clements store where the Good Templars and Knights of Pythias also held meetings. In March of 1917, land in Clements was

⁴ Mike Carnes, “Iron John in the Gilded Age,” *American Heritage* (September 1993): 41; quoted in National Register of Historic Places nomination of Fullerton Odd Fellows Temple, prepared by Deborah Richey, August 30, 2001, available at the California Office of Historic Preservation.

⁵ National Register of Historic Places nomination of Fullerton Odd Fellows Temple, prepared by Deobrah Richey, August 30, 2001, Section 8 Page4.

⁶ Alvin J. Schmidt, *Fraternal Organizations* (Westport, Conn.: Greenwood Press, 1980), 16-17; quoted in National Register of Historic Places nomination of Fullerton Odd Fellows Temple.

⁷ Raymond W. Hillman and Leonard A. Covello, *Cities & Towns of San Joaquin County since 1847* (Fresno: Panorama West Books, 1985), 117.

**United States Department of the Interior
National Park Service**

**National Register of Historic Places
Continuation Sheet**

Section number 8 Page 3 IOOF Lodge #355 San Joaquin County, CA

purchased from the Stillman L. Magee Estate and the two story brick building was built and finished in September of the same year. The lodge served as the social hub for the town of Clements, holding meetings and social entertainment activities such as dances, dinners, and pageants.

Each year Clements held a festival called the May Day Picnic. This became a tradition that was enjoyed and attended by thousands of people from Stockton, Lodi, Lockeford, and all the surrounding areas. The picnic consisted of a "...baseball game, merry-go-round, racing and dancing in a covered pavilion, and an evening dance...with plenty of food."⁸ After the death of Thomas Clements (founder of Clements) in 1893, the May Day Picnic was continued by the I.O.O.F. The picnic continued the tradition and the picnic featured homemade pies and May Poles. In 1895-1896 the Lodge was able to buy new carpet for the Community Hall from the proceeds of the picnic. The lodge ran the picnic until 1925. The reason for discontinuing the picnic by the I.O.O.F members is unknown. According to authors Raymond W. Hillman and Leonard A. Covello, the Snowflake Rebekah Lodge #276 of the I.O.O.F. carried on the tradition.

During the 1950s the Odd Fellows continued to raise money for worthy causes such as the Red Cross, March of Dimes and the Heart Fund. The lodge also hosted fundraisers to support their organization. In November of 1957 the lodge held a spaghetti feed to help pay for the various bills of the lodge such as water, gas, and electricity. On October 11, 1958, the Odd Fellows held a potluck with the Rebeccas to obtain social networking. The Odd Fellows and the Rebekahs were closely associated with the lodges from the surrounding the communities of Lockeford, Woodbridge, and Lodi and the lodges would hold joint initiations and induction ceremonies. Throughout the years other organizations also held their meetings at the hall, including the Lone Star Encampment and the Ladies Encampment. The I.O.O.F. Lodge was the social focal point for the community, but due to declining membership for I.O.O.F. #355, the group was disbanded and merged with the Lockeford Lodges four miles to the west in 1976.⁹

In 1992 the I.O.O.F. Lodge was listed as a Point of Historical Interest in the State of California. As very little historic fabric is left in Clements, the lodge is such an example of its history and is a significant element to the identity of this town located on Highway 88 approaching the Mother Lodge Region.

⁸ Hillman and Covello, *Cities & Towns*, 119.

⁹ Records and minutes of the Clements Odd Fellows Lodge #355;

United States Department of the Interior
National Park Service

National Register of Historic Places
Continuation Sheet

Section number 9 Page 1

IOOF Lodge #355 San Joaquin County, CA

Bibliography

Mike Carnes. "Iron John in the Gilded Age," *American Heritage* (September 1993). In National Register of Historic Places nomination of Fullerton Odd Fellows Temple, prepared by Deborah Richey, August 30, 2001.

Clawson, Mary Ann. *Constructing Brotherhood: Class, Gender and Fraternalism*. Princeton: Princeton University Press, 1989.

Demango, Mrs. H.L. Notes from the Diary of the Late Mrs. D.J. Lockeford of Lockeford, CA. Dec. 29, 1936. Mrs. Demango, daughter of Mrs. D.J. Locke

Hillman, Raymond W. and Leonard A. Covello. *Cities & Towns and San Joaquin County sin 1847*. Fresno: Panorama West Books, 1985.

Lodi News Sentinel

Irwin, Pennel. *Lockeford, A Place and Time and Clements, a Town and a History Hi Neighbor, Welcome to the Clements- Lockeford Are*. Clements- Lockeford Chamber of Commerce, n.d.

Official Register of the Order of Odd Fellows Lodge #355, December 4, 1889, and July 1953-December 1974.

Schmidt, Alvin A. *Fraternal Organizations*. Westport: Greenwood Press, 1980.

Scott, Lee. *Clements, Field Continuity Report*. Filed in Library of Haggin Museum, Stockton, CA, January 5, 1937

Smith, Don R. and Wayne Roberts. *The Three Link Fraternity - Odd Fellowship in California, An Introduction to the Independent Order of Odd Fellows and Rebekas*. Linden, Calif.: Linden Publications, 1993.

Spencer, Horace A. *Guide to Historical Locations in San Joaquin County*, 1975

Stillson, Henry Leonard, ed. *The History and Literature of Odd Fellowship The Three Link Fraternity*. Boston: The Fraternity Publishing Company, 1897.

**United States Department of the Interior
National Park Service**

**National Register of Historic Places
Continuation Sheet**

Section number 9 Page 2

IOOF Lodge #355 San Joaquin County, CA

Thompson and West Reproductions. *History of San Joaquin County California with Illustrations*
Introduction by Robert Burns, President of the University of the Pacific. Berkley:
Howell- North Books, 1968.

Tinkham, George W. *History of San Joaquin County*, 1923

United States Department of the Interior
National Park Service

National Register of Historic Places

Continuation Sheet

Section number 10 Page 1

IOOF Lodge #355 San Joaquin County, CA

Boundary Description

The boundary description is based on the parcel number, 019-240-18.

Boundary Justification

The nominated property includes the parcel historically associated with the Clements Independent Order of Odd Fellows Lodge # 355.

IOOF Lodge #355
San Joaquin County, CA

Sketch Map

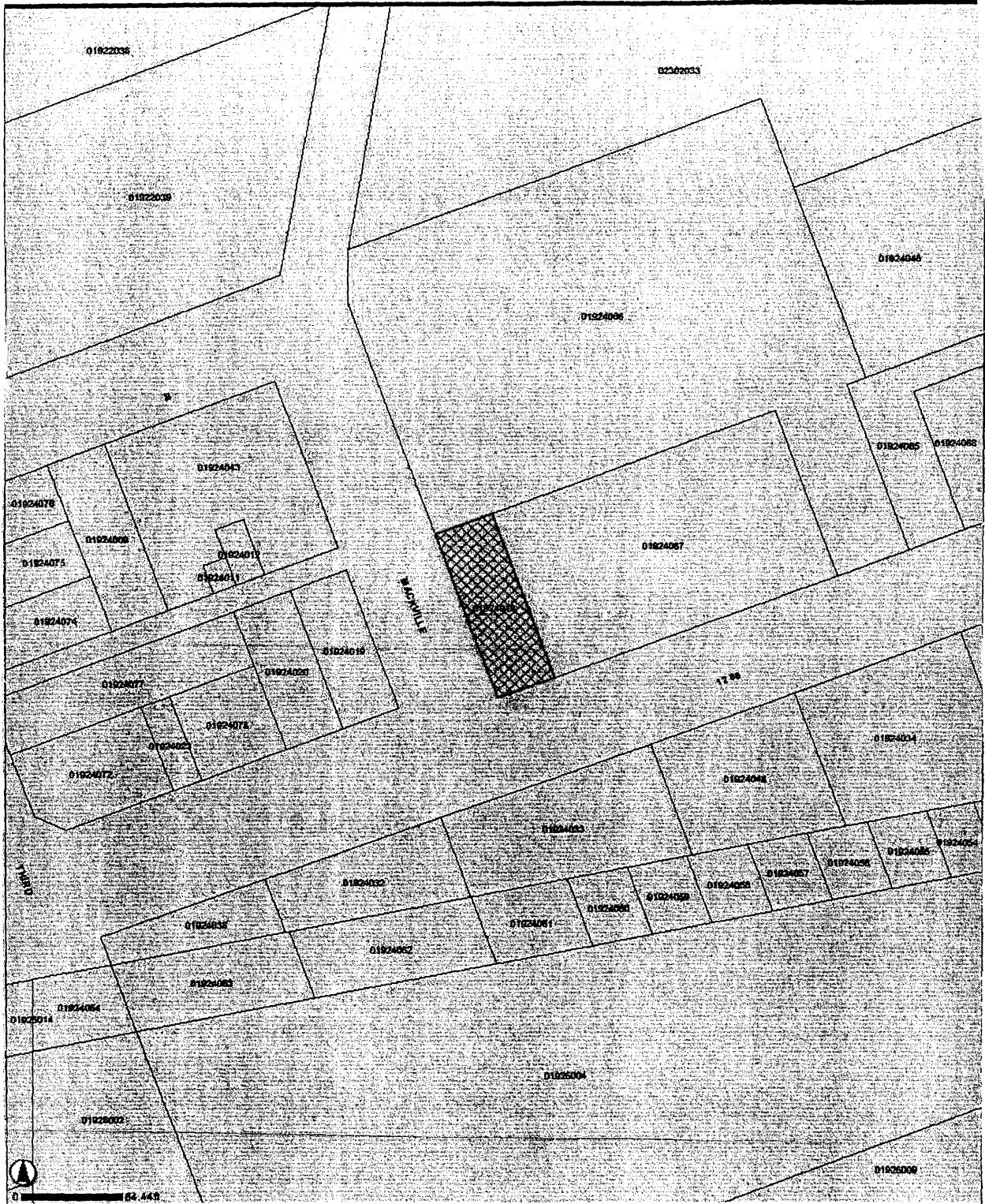

United States Department of the Interior
National Park Service

National Register of Historic Places
Continuation Sheet

Additional Documentation

IOOF Lodge #355, San Joaquin County, CA

Photograph A (copy)
Interior view of upstairs

Photograph B (copy)
Interior view of upstairs

Photograph C (copy)
Odd Fellows Hall (n.d.)

Photograph D (copy)
Clements May Day Picnic (n.d.)

Photograph E (copy)
Clements May Day Picnic (n.d.)