

PH0023540

NATIONAL REGISTER OF HISTORIC PLACES
INVENTORY - NOMINATION FORM

(Type all entries - complete applicable sections)

STATE: Georgia	
COUNTY: Thomas	
FOR NPS USE ONLY	
ENTRY NUMBER 70-8-10-0043	DATE 8/12/70

SEE INSTRUCTIONS

1. NAME			
COMMON: Sholar House			
AND/OR HISTORIC: Epraim Ponder House			
2. LOCATION			
STREET AND NUMBER: 324 North Dawson Street			
CITY OR TOWN: Thomasville			
STATE Georgia	CODE 10	COUNTY: Thomas	CODE 275
3. CLASSIFICATION			
CATEGORY (Check One)	OWNERSHIP	STATUS	ACCESSIBLE TO THE PUBLIC
District <input type="checkbox"/> Building <input checked="" type="checkbox"/> Site <input type="checkbox"/> Structure <input type="checkbox"/> Object <input type="checkbox"/>	Public <input type="checkbox"/> Private <input checked="" type="checkbox"/> Both <input type="checkbox"/>	Public Acquisition: In Process <input type="checkbox"/> Being Considered <input type="checkbox"/> Occupied <input checked="" type="checkbox"/> Unoccupied <input type="checkbox"/> Preservation work in progress <input type="checkbox"/>	Yes: Restricted <input type="checkbox"/> Unrestricted <input type="checkbox"/> No: <input checked="" type="checkbox"/>
PRESENT USE (Check One or More as Appropriate)			
Agricultural <input type="checkbox"/> Commercial <input type="checkbox"/> Educational <input type="checkbox"/> Entertainment <input type="checkbox"/>	Government <input type="checkbox"/> Industrial <input type="checkbox"/> Military <input type="checkbox"/> Museum <input type="checkbox"/>	Park <input type="checkbox"/> Private Residence <input checked="" type="checkbox"/> Religious <input type="checkbox"/> Scientific <input type="checkbox"/>	Transportation <input type="checkbox"/> Other (Specify) <input type="checkbox"/>
4. OWNER OF PROPERTY			
OWNERS NAME: Mr. and Mrs. John A. Sholar			
STREET AND NUMBER: 324 North Dawson Street			
CITY OR TOWN: Thomasville		STATE: Georgia	CODE 10
5. LOCATION OF LEGAL DESCRIPTION			
COURTHOUSE, REGISTRY OF DEEDS, ETC.: Thomas County Courthouse			
STREET AND NUMBER: North Broad Street			
CITY OR TOWN: Thomasville		STATE: Georgia	CODE 10
APPROXIMATE ACREAGE OF NOMINATED PROPERTY: .45 Acres			
6. REPRESENTATION IN EXISTING SURVEYS			
TITLE OF SURVEY: Thomasville Landmarks Architectural Inventory			
DATE OF SURVEY: Federal <input type="checkbox"/> State <input type="checkbox"/> County <input type="checkbox"/> Local <input checked="" type="checkbox"/>			
DEPOSITORY FOR SURVEY RECORDS: Thomasville Landmarks, Inc.			
STREET AND NUMBER: Box 44			
CITY OR TOWN: Thomasville		STATE: Georgia	CODE 10

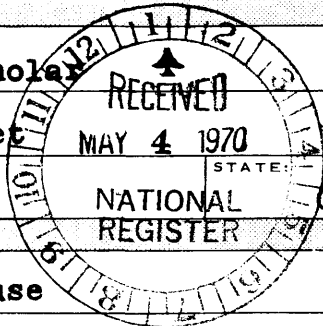

STATE: Georgia
COUNTY: Thomas
ENTRY NUMBER: 70-8-10-0043
DATE: 8/12/70
FOR NPS USE ONLY

7. DESCRIPTION

CONDITION	(Check One)				
	Excellent <input checked="" type="checkbox"/>	Good <input type="checkbox"/>	Fair <input type="checkbox"/>	Deteriorated <input type="checkbox"/>	Ruins <input type="checkbox"/>
INTEGRITY	(Check One)			(Check One)	
	Altered <input checked="" type="checkbox"/>	Unaltered <input type="checkbox"/>		Moved <input type="checkbox"/>	Original Site <input checked="" type="checkbox"/>

DESCRIBE THE PRESENT AND ORIGINAL (if known) PHYSICAL APPEARANCE

Two and one-half story house with a one story porch on the north facade and a second entrance on the south. House is hipped roof, clapboard siding, with panelled end pilasters. The cornice consists of a combination of dentils and pendant drop brackets. The excellent north doorway is flanked by leaded glass sidelights and fixed transom, all enclosed by a heavy doorframe of great detail, including dentils, acorn and lotus-leaf rosettes. Two double windows on the first floor are framed with the same detailing. Two double windows on the second floor flank a central triple window of good design.

The north porch has turned balusters with oval railings. The part of the north facade enclosed by the porch is flush siding, treated to look like stone. The south facade, facing the old Young's Female College property, is Greek Revival in detail and has an exceptional entrance. The entire first floor of this facade is flush siding, with clapboards above.

A wing has been added to the east facade, but does not detract from the appearance of the house or grounds, which are in excellent condition. The entire property, planted with evergreen shrubbery, magnolias and dogwood, is enclosed by a wrought iron fence with gate of great interest.

The notable interior includes rift pine floors, excellent millwork, door and window crowns and ceiling medallions, and is completely furnished with Chippendale and Victorian antiques.

The Sholar House was converted into two apartments in 1900, with no apparent harm, and has been reconverted into a single family residence by its present owners.

SEE INSTRUCTIONS

8. SIGNIFICANCE

PERIOD (Check One or More as Appropriate)

Pre-Columbian 16th Century 18th Century 20th Century
 15th Century 17th Century 19th Century

SPECIFIC DATE(S) (If Applicable and Known)

c.1854-56

AREAS OF SIGNIFICANCE (Check One or More as Appropriate)

Aboriginal	Education	Political	Urban Planning
Prehistoric <input type="checkbox"/>	Engineering <input type="checkbox"/>	Religion/Philosophy <input type="checkbox"/>	Other (Specify) <input type="checkbox"/>
Historic <input type="checkbox"/>	Industry <input type="checkbox"/>	Science <input type="checkbox"/>	_____
Agriculture <input type="checkbox"/>	Invention <input type="checkbox"/>	Sculpture <input type="checkbox"/>	_____
Art <input checked="" type="checkbox"/>	Landscape	Social/Humanitarian <input type="checkbox"/>	_____
Commerce <input type="checkbox"/>	Architecture <input type="checkbox"/>	Theater <input type="checkbox"/>	_____
Communications <input type="checkbox"/>	Literature <input type="checkbox"/>	Transportation <input type="checkbox"/>	_____
Conservation <input type="checkbox"/>	Military <input type="checkbox"/>		_____
	Music <input type="checkbox"/>		_____

STATEMENT OF SIGNIFICANCE (Include Personages, Dates, Events, Etc.)

The Sholar House was built in circa 1854-56 by Epraim Ponder. It was sold to Colonel William Young, who gave it to the Female College, and the house was used as a dormitory and finally as the residence of the president of the college. In 1900 it was purchased by Mrs. Blanche Merrill and Miss Ola Mallette, who remodeled the house into two separate apartments and called the property 'Greensquare', because of the exclusive use of evergreens for planting. The house was restored to its present condition and appearance by Mr. and Mrs. John Sholar, who own and live in it.

The Sholar House is an ante-bellum home of great dignity and quiet distinction.

SEE INSTRUCTIONS

9. MAJOR BIBLIOGRAPHICAL REFERENCES

Rogers, W.W. Ante-Bellum Thomas County, Tallahassee, 1963
pp.106
Perkerson, M.F. White Columns in Georgia, pp.306

10. GEOGRAPHICAL DATA

LATITUDE AND LONGITUDE COORDINATES DEFINING A RECTANGLE LOCATING THE PROPERTY				OR	LATITUDE AND LONGITUDE COORDINATES DEFINING THE CENTER POINT OF A PROPERTY OF LESS THAN ONE ACRE							
CORNER	LATITUDE				LONGITUDE							
	Degrees	Minutes	Seconds	Degrees	Minutes	Seconds	Degrees	Minutes	Seconds			
NW	°	'	"	°	'	"	30 °	50 '	33 "	83 °	58 '	48 "
NE	°	'	"	°	'	"						
SE	°	'	"	°	'	"						
SW	°	'	"	°	'	"						

NO UTM
CX

LIST ALL STATES AND COUNTIES FOR PROPERTIES OVERLAPPING STATE OR COUNTY BOUNDARIES

STATE:	CODE	COUNTY	CODE
STATE:	CODE	COUNTY:	CODE
STATE:	CODE	COUNTY:	CODE
STATE:	CODE	COUNTY:	CODE

SEE INSTRUCTIONS

11. FORM PREPARED BY

NAME AND TITLE: **Russell Wright, Consultant**

ORGANIZATION: **Thomasville Landmarks, Inc.**

STREET AND NUMBER: **Box 44**

CITY OR TOWN: **Thomasville**

STATE: **Georgia** CODE: **10**

DATE: **12/5/69**

NATIONAL REGISTER

RECEIVED MAY 4 1970

12. STATE LIAISON OFFICER CERTIFICATION

As the designated State Liaison Officer for the National Historic Preservation Act of 1966 (Public Law 89-665), I hereby nominate this property for inclusion in the National Register and certify that it has been evaluated according to the criteria and procedures set forth by the National Park Service. The recommended level of significance of this nomination is:

National State Local

Name Mary Gregory Jurett

Title State Liaison Officer - Ga.

Date Apr. 28, 1970

NATIONAL REGISTER VERIFICATION

I hereby certify that this property is included in the National Register.

Ernest Allen Connolly
Chief, Office of Archeology and Historic Preservation

AUG 12 1970

Date _____

ATTEST:

William J. Huntley
Keeper of The National Register

Date **JUN 26 1970**

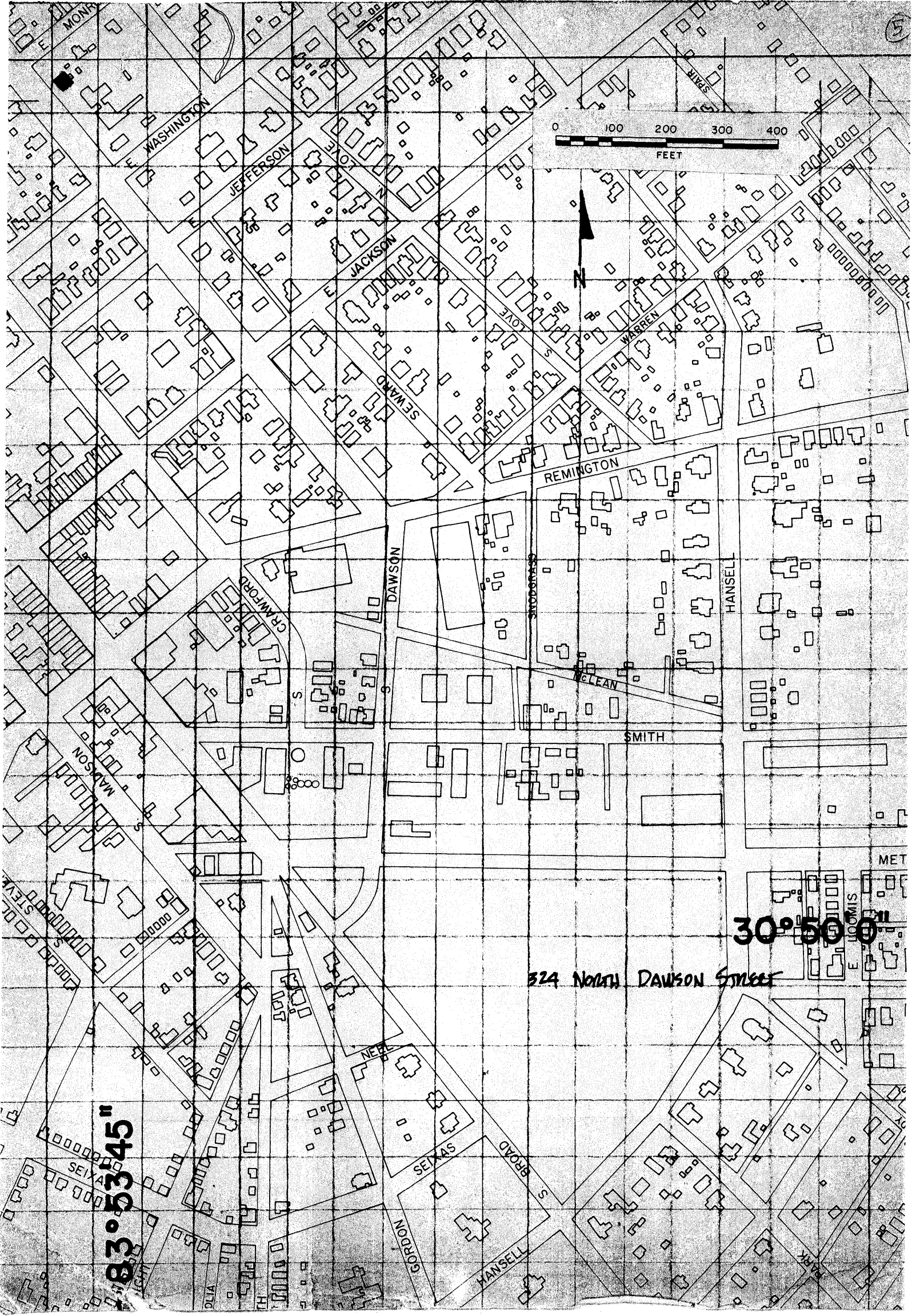

0 100 200 300 400
FEET



30° 50' 00"

324 NORTH DAWSON STREET

83° 53' 45"

MONROE
WASHINGTON
JEFFERSON
JACKSON
SEWARD
LOVE
WARREN
REMINGTON
DAWSON
HANSSELL
SMITH
MCKEAN
SEAFORD
MAYSON
SEAS
GORDON
HANSSELL
BROAD
SEIXA
DOLIA
TH
MET
E. LOOMIS

Form 10-301
(December 1968)

UNITED STATES DEPARTMENT OF THE INTERIOR
NATIONAL PARK SERVICE

NATIONAL REGISTER OF HISTORIC PLACES
PROPERTY MAP FORM

(Type all entries - attach to or enclose with map)

STATE	
Georgia	
COUNTY	
Thomas	
FOR NPS USE ONLY	
ENTRY NUMBER	DATE
70-8-10-0043	8/12/70

SEE INSTRUCTIONS

1. NAME	
COMMON:	Sholar House
AND/OR HISTORIC:	Ponder House
2. LOCATION	
STREET AND NUMBER:	
324 Dawson Street	
CITY OR TOWN:	
Thomasville	
STATE:	Georgia
MAY CODE:	10
COUNTY:	Thomas
CODE	275
3. MAP REFERENCE	
SOURCE:	
Thomasville Landmarks Architectural Inventory Base	
SCALE:	1"=200'
DATE:	July 1969
4. REQUIREMENTS	
TO BE INCLUDED ON ALL MAPS	
1. Property boundaries where required.	
2. North arrow.	
3. Latitude and longitude reference.	

