

United States Department of the Interior
National Park Service

National Register of Historic Places Continuation Sheet

Section number _____ Page _____

SUPPLEMENTARY LISTING RECORD

NRIS Reference Number: 91001795 **Date Listed:** 12/20/91

Gautier, Walter, House	Jackson	MISSISSIPPI
Property Name	County	State

Historic Resources of Pascagoula, MS
Multiple Name

This property is listed in the National Register of Historic Places in accordance with the attached nomination documentation subject to the following exceptions, exclusions, or amendments, notwithstanding the National Park Service certification included in the nomination documentation.

Mal M. ...
Signature of the Keeper

7/10/92
Date of Action

=====
Amended Items in Nomination:

Section No. 8

This nomination was amended to add Criterion C (architecture), as indicated in the text.

This change was confirmed by phone with the Mississippi SHPO (1/9/92).

DISTRIBUTION:

- National Register property file
- Nominating Authority (without nomination attachment)

1799

United States Department of the Interior
National Park Service

National Register of Historic Places Registration Form

This form is for use in nominating or requesting determinations of eligibility for individual properties or districts. See instructions in *Guidelines for Completing National Register Forms* (National Register Bulletin 16). Complete each item by marking "X" in the appropriate box or by entering the requested information. If an item does not apply to the property being documented, enter "N/A" for "not applicable." For functions, styles, materials, and areas of significance, enter only the categories and subcategories listed in the instructions. For additional space use continuation sheets (Form 10-900a). Type all entries.

1. Name of Property

historic name Gautier, Walter House
other names/site number Seely, Warren B. House

2. Location

street & number 3012 Canty Street N/A not for publication
city, town Pascagoula N/A vicinity
state Mississippi code MS county Jackson code 59 zip code 39567

3. Classification

Ownership of Property	Category of Property	Number of Resources within Property	
<input checked="" type="checkbox"/> private	<input checked="" type="checkbox"/> building(s)	Contributing	Noncontributing
<input type="checkbox"/> public-local	<input type="checkbox"/> district	<u>1</u>	<u>3</u> buildings
<input type="checkbox"/> public-State	<input type="checkbox"/> site	<u> </u>	<u> </u> sites
<input type="checkbox"/> public-Federal	<input type="checkbox"/> structure	<u> </u>	<u> </u> structures
	<input type="checkbox"/> object	<u>1</u>	<u>3</u> objects
		<u>1</u>	<u>3</u> Total

Name of related multiple property listing:
Historic Resources of Pascagoula, MS

Number of contributing resources previously listed in the National Register 0

4. State/Federal Agency Certification

As the designated authority under the National Historic Preservation Act of 1966, as amended, I hereby certify that this nomination request for determination of eligibility meets the documentation standards for registering properties in the National Register of Historic Places and meets the procedural and professional requirements set forth in 36 CFR Part 60. In my opinion, the property meets does not meet the National Register criteria. See continuation sheet.

Kenneth H. P. Pearl OCT. 24, 1991
Signature of certifying official Date
Deputy State Historic Preservation Officer
State or Federal agency and bureau

In my opinion, the property meets does not meet the National Register criteria. See continuation sheet.

Signature of commenting or other official Date

State or Federal agency and bureau

5. National Park Service Certification

I, hereby, certify that this property is:

entered in the National Register. Cora Shuey 12-20-91
 See continuation sheet. _____
 determined eligible for the National Register. See continuation sheet. _____
 determined not eligible for the National Register. _____
 removed from the National Register. _____
 other, (explain:) _____

Signature of the Keeper Date of Action

6. Function or Use

Historic Functions (enter categories from instructions)

Domestic/Single Dwelling

Current Functions (enter categories from instructions)

Domestic/Single Dwelling

7. Description

Architectural Classification

(enter categories from instructions)

Queen Anne

Materials (enter categories from instructions)

foundation Brick

walls Weatherboard

Asphalt

roof _____

other N/A

Describe present and historic physical appearance.

The Walter Gautier house faces west towards Canty Street. It sits, cocked slightly to the north, in the northeast corner of a deep lot. Close to the south side are three separate residential structures of very poor construction, dating likely from the 1940s. They are all different, but each has a shallow asphalt gable roof, six-over-six double-hung windows, and an entrance on its north side. These buildings do not appear to contribute, unless they could be shown to have been housing for the Gautier employees. Just in back, a stream runs from about two-fifths at the length of the south side from the southeast corner to a point just north of the northeast corner of the lot. Set with a small front lawn with concrete walk, there are large shrubs at the porch foundation. The lot is otherwise essentially unlandscaped.

The house is L-shaped, with its ridge parallel to Canty. A gabled back wing, whose north wall continues the north wall of the house, is about half the size of the front mass, has a lower ridge than the front, has a porch the length of its south side, and a gable in its east end.

The modern asphalt-shingled roof is over a weatherboarded and corner boarded structure, with a water table and skirt fascia below, and brick piers. The site slopes to the southeast.

The main gable ends of south and west have a rather deep projecting verge behind a bead molding, the verge ornamented at the peak by jigsaw with a horizontal saw-tooth pattern and other ornamental details, and projecting out over a fascia. Across the front of the building, a thin boxed eave projects out over a fascia board at the top of the wall, the eave and fascia turning the corner to receive the verge, and then returning on themselves.

At the center of the front roof is a clipped dormer with a low-pitched gable roof. The verge is boxed and projects a foot or so over the wall plane, and turns and runs angled along the dormer eaves. The peak of the dormer has jigsaw ornamentation at the verge similar to that of the end gables, but smaller in size. The gable wall is clad with shingles, and below, a fascia board runs horizontally and returns at right angles to meet the side walls of the dormers; the soffit surface created by the clipped dormer walls is clad in flat boards. The center bay of the dormer is in the plane of the shingled gable end wall; the frame of a two-over-two double-hung sash is in the same plane as the fascia above. The frames of another identical sash to each side miter into the frame of the central one, but on their inner sides meet a section of weatherboarded wall which completes the clipped area. This small wall area is bound on its inner side by corner boards, which receive the weatherboards of the dormer sides. One continuous sill runs

United States Department of the Interior
National Park ServiceNational Register of Historic Places
Continuation SheetSection number 7 Page 2

below all three openings, and below it at the center a wood piece goes down to the roof. At the inner corners of the side sash, the roof falls just below the window sill.

A porch with dutch-lap asbestos shingles runs the full length of the front wall; its low-pitched roof hips at the ends, eaves being simply boxed and falling about an inch or so inside the right angle corners of the corner boards. The eave projects out about ten inches from a soffit beam supported by six turned posts. The posts are square sectioned, and receive a railing with turned balusters at the bottom and rather rococo patterned open-work jigsaw ornamental brackets at each side at the top. The posts are turned in their length between rail and brackets, the turned part tapering in as it rises to a kind of cap molding where it meets the top square-sectioned area. The masonry steps leading to the low porch run the width of the center bay and butt masonry buttresses on each end.

In the center of the front wall is a single-acting door with a top panel of colored glass and lower wood panels with a single light transom above. Placed symmetrically on each side of the entry frame are pairs of two-over-one double-hung sash in one frame, separated by a mullion. On the south gable end, two six-over-six small double-hung windows are set symmetrically about the gable peak, and below two two-over-two double-hung sash are set symmetrically also, but farther apart. At the southeast corner of the south gable end is a one-story infill with a three-over-one double-hung sash. It suggests being an infill of a porch across the east side of the house here.

The north wall of the house extends east to form one side of a one-and-a-half-story back wing, which gable ends at the east end. The typical eave continues along the north and south sides of this wing, turning the corners of the back east wall about three feet to receive a projecting boxed verge which dies on a deep fascia. A six-over-six double-hung sash at second floor level is centered in the gable, and two two-over-two sash in one frame centered below. To the south of this mass is the end of the Eastlake porch, which runs along the south side of the back wing. It is hipped, clad with asbestos shingles in a dutch-lap pattern, and its thin eave dies at the corner board, the soffit beam falling west of the corner. The details of this porch follow those of the front porch.

The Walter Gautier house is a center-hall cottage. The center hall has a wainscot with vertical boards topped by horizontal panels of curly pine and a picture molding. Doors have well-detailed late Victorian trim with bull's-eye corner blocks projecting above the head casing, two-light transoms and five-panel doors. The stairs rise from the front to the rear of the hall, and have a turned wood newel and banisters and a closed stringer.

The pair of parlors to the north side of the hall are connected by a pair of sliding pocket doors, adjacent to which is a corner fireplace. The mantels have paired brackets over paired columns on each side of the fire box. The baseboard has corner finials. On the south side of the hall are a pair of rooms with a corner fireplace on the common wall, backed by an added bathroom. Behind the north pair of rooms is a wainscoted dining room, to the rear of which is the kitchen, which opens onto a porch. Upstairs was originally a single room whose walls sloped with the roof; it was cut up into smaller rooms during the 1920s.

United States Department of the Interior
National Park Service

National Register of Historic Places Continuation Sheet

Section number 7 Page 3

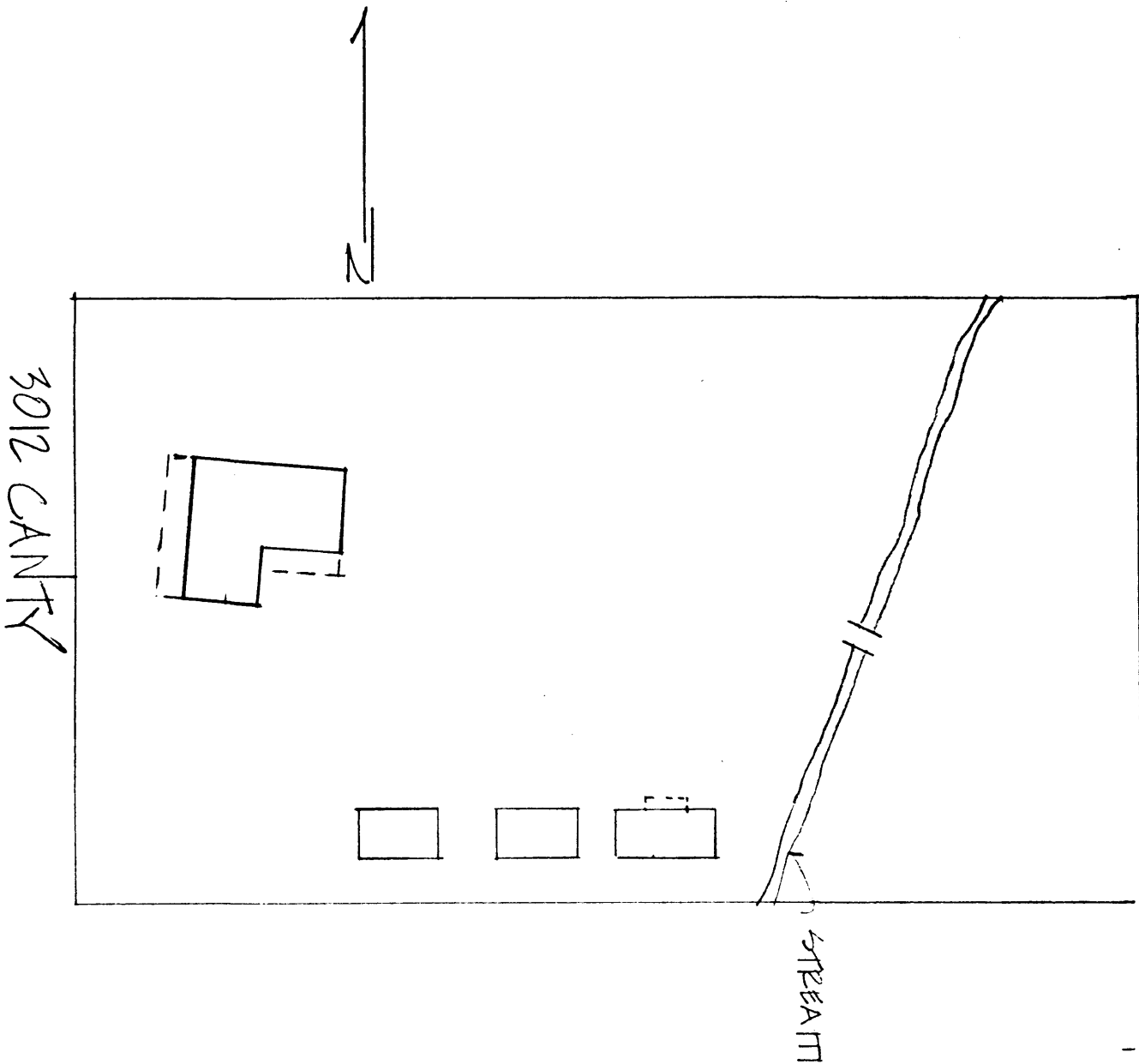

8. Statement of Significance

Certifying official has considered the significance of this property in relation to other properties:

nationally statewide locally

Applicable National Register Criteria A B C D

Criteria Considerations (Exceptions) N/A A B C D E F G

Areas of Significance (enter categories from instructions)

Architecture

Commerce

Period of Significance

1882

1882-1940

Significant Dates

1882

Cultural Affiliation

N/A

Significant Person
Walter Gautier

Architect/Builder
unknown

State significance of property, and justify criteria, criteria considerations, and areas and periods of significance noted above.

The Walter Gautier house is architecturally and historically significant within the context of Pascagoula's residential elements. It is the oldest extant example of a Queen Anne-influenced cottage in Pascagoula, and a tangible link to the old railroad town of Scranton and to one of the county's prominent lumbermen, Walter Gautier (see cover nomination).

The house is a variation of the center-hall cottage in which the front porch is independent of the main gable rather than being undercut (see cover nomination). This variation is an attempt to modernize the house type, adapting it to the picturesqueness of the Queen Anne. The decorative gable cutouts, porch columns and brackets, siding and shingles, and decorative front door combine to distinguish this cottage, and relate it to Scranton of the 1880s and the area's flourishing lumber industry.

Walter Gautier built the house in 1882. He was a part-owner, along with his father and brother Henry, of Jackson County's largest lumberyard, F. Gautier and Sons, in Gautier (West Pascagoula), Mississippi. The company was founded by Walter's father, Ferando, who erected a small sawmill near Biloxi which he operated until after the Civil War when in 1865 he sold it and moved with his family to West Pascagoula. There he established, with a small amount of capital, a mill capable of producing 10,000 board feet per day. By 1896, per day production had increased to 30,000 board feet, and the mill had twenty-two employees. In 1904 Walter Gautier was appointed postmaster of Gautier. He was described in a Works Progress Administration book as "a leader in civic affairs in his county throughout his residence here, where he has lived fifty-five years." Gautier was commodore of the Pascagoula Yacht Club, officer of the Scranton Wing & Target Club, and an officer of the M&M bank and other important industries in the county in later years.

The house remained in the Gautier family until 1940 when the Seely family acquired it.

9. Major Bibliographical References

For Bibliography See Context Statement.

Previous documentation on file (NPS):

- preliminary determination of individual listing (36 CFR 67) has been requested
- previously listed in the National Register
- previously determined eligible by the National Register
- designated a National Historic Landmark
- recorded by Historic American Buildings Survey # _____
- recorded by Historic American Engineering Record # _____

N/A See continuation sheet

Primary location of additional data:

- State historic preservation office
- Other State agency
- Federal agency
- Local government
- University
- Other

Specify repository: _____

10. Geographical Data

Acreeage of property Less than one acre.

UTM References

A

1	6	3	5	0	9	0	0	3	3	5	8	0	5	0
Zone		Easting				Northing								

C

--	--	--	--	--	--	--	--	--	--	--	--	--	--	--

B

Zone		Easting				Northing								

D

--	--	--	--	--	--	--	--	--	--	--	--	--	--	--

N/A See continuation sheet

Verbal Boundary Description

BK 4, Lot 47, Share 8 w/Side Buena Vista St., E Baptiste TR S/D DB-126-190&191
47 M866.9 SEC 8-8-6

N/A See continuation sheet

Boundary Justification

The boundary includes the entire city lot that has historically been associated with the property.

N/A See continuation sheet

11. Form Prepared By

name/title Robert J. Cangelosi, Jr., Architect

organization Koch and Wilson Architects, A Prof. Corp. date 3 June 1991

street & number 1100 Jackson Avenue telephone 504/581-7023

city or town New Orleans state LA zip code 70130