

AUG 07 1989

1517  
AREA

FORM NO.

	116
--	-----

MASSACHUSETTS HISTORICAL COMMISSION  
BOYLSTON STREET  
QUINCY, MA 02116

Town Quincy, MA / MRA

Address 32 Bayview Avenue

Historic Name na

Use: Present single family residence

Original single family residence

Photo (3"x3" or 3"x5", black and white) Indicate address of property on back of photo. Staple to left side of form.

DESCRIPTION

Date 1880s

Source Map and directory research

Style Queen Anne

Architect unknown

Exterior Wall Fabric wood shingles

Outbuildings none

Major Alterations (with dates) repairs after 1941 fire--see reverse

Condition good

Moved no Date \_\_\_\_\_

Acreage Less than one acre: 15,299 sq.ft.

Setting The house is located on a large corner lot in Hough's Neck with a view of Quincy Bay.

Recorded by Fannin and Lehner / J. Johnson

Organization Quincy Historical Commission

Date July 1, 1986 / May 1987

Sketch Map: Draw map showing property's location in relation to nearest cross streets and/or geographical features. Indicate all buildings between inventoried property and nearest intersection(s). Indicate north

SEE ATTACHED MAP

TM REFERENCE 19/339,130 E/4,681,550 N

SGS QUADRANGLE Hull, Massachusetts

SCALE 1: 24,000 sq. ft.

**NATIONAL REGISTER CRITERIA STATEMENT (if applicable)**

Associated with the late nineteenth century development of Quincy's resort communities, the house at 34 Bayview Avenue possesses integrity of association, design, location, materials, feeling, and setting. The only well-preserved example of a Queen Anne-style summer house in Quincy, the house fulfills Criteria A and C of the National Register of Historic Places on the local level.

**ARCHITECTURAL SIGNIFICANCE** Describe important architectural features and evaluate in terms of other buildings within the community.

SEE INVENTORY FORM CONTINUATION SHEET

**HISTORICAL SIGNIFICANCE** Explain the role owners played in local or state history and how the building relates to the development of the community.

SEE INVENTORY FORM CONTINUATION SHEET

**BIBLIOGRAPHY and/or REFERENCES**

Assessors Records

H. Hobart Holly, Quincy Historical Society.

Dorothy T. Laing and Ruth A. Wainwright. "The Houghs Neck Story and Atherton Hough, A Puritan's Progress," 1981.

Quincy City Directories, 1868, 1896, 1915, 1927.

Richard T. LaBrecque. "Houghs Neck of Gay Nineties Era Colorful Resort for Summer Fun." Quincy Patriot Ledger, ca. 1930.

INVENTORY FORM CONTINUATION SHEET

MASSACHUSETTS HISTORICAL COMMISSION  
Office of the Secretary, Boston

Community: Quincy, MA	Form No: 116
Property Name: 32 BAYVIEW AVE	

Indicate each item on inventory form which is being continued below.

ARCHITECTURAL SIGNIFICANCE -- 32 BAYVIEW AVENUE

Beautifully sited to take full advantage of the water view, this simple Queen Anne house was built in the 1880s as a summer residence. Although the house does not have the usual complex roof structure of the period, its projecting gables and solid bargeboards all act to give it a picturesque and comfortable look. The fenestration is almost regular, composed of a few double sash windows and the rest single sash windows. The dominant element of the house is the large balustraded porch which wraps around three sides of the house; the porch is supported by square posts and simple brackets. Although the house was reshingled and several windows were replaced after a fire in 1941, these changes have not disturbed the building's architectural integrity.

Staple to Inventory form at bottom

INVENTORY FORM CONTINUATION SHEET

MASSACHUSETTS HISTORICAL COMMISSION  
Office of the Secretary, Boston

Community:

Form No:

QUINCY, MA

116

Property Name: 32 BAYVIEW AVE

Indicate each item on inventory form which is being continued below.

**HISTORICAL SIGNIFICANCE -- 32 BAYVIEW AVENUE**

The house at 32 Bayview Avenue is the best preserved of a handful of late 19th century houses to survive from the period when Hough's Neck was a prosperous summer resort. James Mears, who in 1881 began development of the "Great Hill" section of Hough's Neck peninsula for summer homes, was the probable builder of this house erected in the 1880s. By 1907, it was the summer residence for Pastor Peter Ronan. In 1923 the house was owned by James P. Quinn.

The Hough's Neck peninsula is the area granted to Atherton Hough in 1636. The peninsula was predominantly a farming community through the Civil War. The building of hotels and summer houses at Hough's Neck in the 1870s with the arrival of steamers from Boston and the horse car railway. Development was greatly advanced by the extension of the electrified street railway in 1888. By the late nineteenth century summer houses were being converted to year-round use.

Staple to Inventory form at bottom

United States Department of the Interior  
National Park Service

AUG 7 1989

National Register of Historic Places  
Continuation Sheet

Section number \_\_\_\_\_ Page \_\_\_\_\_

Multiple Resource Area  
Thematic Group

Name Quincy MRA  
State Norfolk County, MASSACHUSETTS

Nomination/Type of Review	Date/Signature
41. House at 32 Bayview Avenue <i>Entered in the National Register</i>	<del>Keeper</del> <u>Shelores Byers 9/20/89</u> Attest _____
42. House at 92 Willard Street <i>Entered in the National Register</i>	<del>Keeper</del> <u>Shelores Byers 9/20/89</u> Attest _____
43. House at 94 Grandview Avenue <i>Entered in the National Register</i>	<del>Keeper</del> <u>Shelores Byers 9/20/89</u> Attest _____
44. Jewell, David L., House <i>Entered in the National Register</i>	<del>Keeper</del> <u>Shelores Byers 9/20/89</u> Attest _____
45. Lennon, Edward J., House <i>Entered in the National Register</i>	<del>Keeper</del> <u>Shelores Byers 9/20/89</u> Attest _____
46. Marsh, Charles, House <i>Entered in the National Register</i>	<del>Keeper</del> <u>Shelores Byers 9/20/89</u> Attest _____
47. Marsh, Edwin W., House <i>Entered in the National Register</i>	<del>Keeper</del> <u>Shelores Byers 9/20/89</u> Attest _____
48. McIntire, Herman, House <i>Entered in the National Register</i>	<del>Keeper</del> <u>Shelores Byers 9/20/89</u> Attest _____
49. Miller, Edward, House Substantive Review	<del>Keeper</del> <u>Bobby Savage 3/8/90</u> Attest _____
50. Munroe Building <i>Entered in the National Register</i>	<del>Keeper</del> <u>Shelores Byers 9/20/89</u> Attest _____

UNITED STATES DEPARTMENT OF THE INTERIOR  
NATIONAL PARK SERVICE

NATIONAL REGISTER OF HISTORIC PLACES  
EVALUATION/RETURN SHEET

REQUESTED ACTION: NOMINATION

PROPERTY House at 32 Bayview Avenue  
NAME:

MULTIPLE Quincy MRA  
NAME:

STATE & COUNTY: MASSACHUSETTS, Norfolk

DATE RECEIVED: 8/07/89 DATE OF PENDING LIST: 8/22/89  
DATE OF 16TH DAY: 9/07/89 DATE OF 45TH DAY: 9/21/89  
DATE OF WEEKLY LIST:

REFERENCE NUMBER: 89001314

NOMINATOR: STATE

REASONS FOR REVIEW:

APPEAL: N DATA PROBLEM: N LANDSCAPE: N LESS THAN 50 YEARS: N  
OTHER: N PDIL: N PERIOD: N PROGRAM UNAPPROVED: N  
REQUEST: N SAMPLE: N SLR DRAFT: N NATIONAL: N

COMMENT WAIVER: N

ACCEPT  RETURN  REJECT 9/20/89 DATE

Entered in the  
National Register

ABSTRACT/SUMMARY COMMENTS:

RECOM./CRITERIA \_\_\_\_\_  
REVIEWER \_\_\_\_\_  
DISCIPLINE \_\_\_\_\_  
DATE \_\_\_\_\_

DOCUMENTATION see attached comments Y/N see attached SLR Y/N

---

CLASSIFICATION

count       resource type

---

STATE/FEDERAL AGENCY CERTIFICATION

---

FUNCTION

historic       current

---

DESCRIPTION

architectural classification  
 materials  
 descriptive text

---

SIGNIFICANCE

Period      Areas of Significance--Check and justify below

Specific dates      Builder/Architect  
Statement of Significance (in one paragraph)

summary paragraph  
 completeness  
 clarity  
 applicable criteria  
 justification of areas checked  
 relating significance to the resource  
 context  
 relationship of integrity to significance  
 justification of exception  
 other

---

BIBLIOGRAPHY

---

GEOGRAPHICAL DATA

acreage       verbal boundary description  
 UTM's       boundary justification

---

ACCOMPANYING DOCUMENTATION/PRESENTATION

sketch maps       USGS maps       photographs       presentation

---

OTHER COMMENTS

Questions concerning this nomination may be directed to

\_\_\_\_\_ Phone \_\_\_\_\_

Signed \_\_\_\_\_ Date \_\_\_\_\_



32 Bayview Ave Quincy, Ma

Fannin Lehner Spring 1986

Planning Dept. Quincy

Room East-

116

JUL 1987

JUL 1987

QUINCY BAY

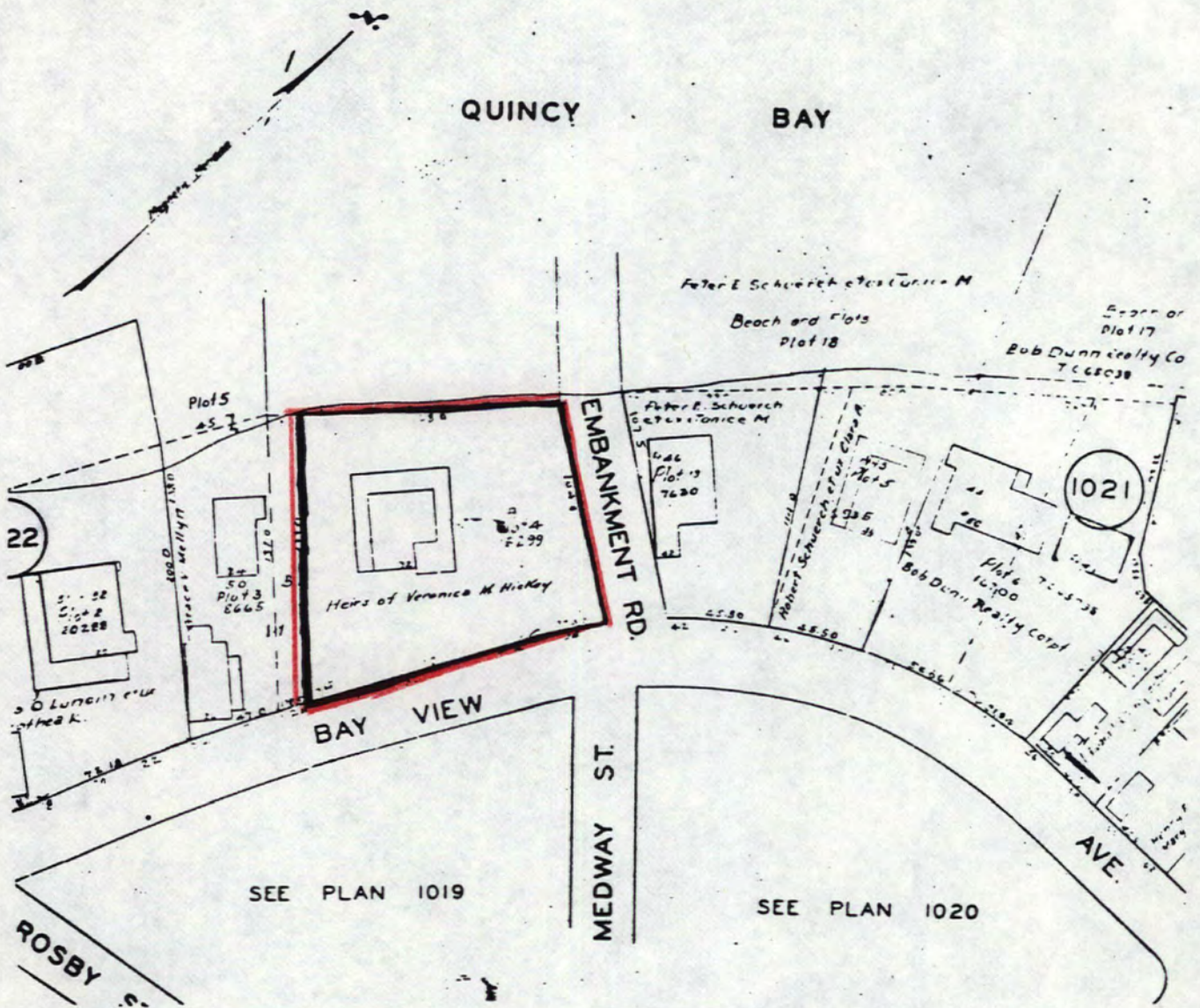

Address 32 Bayview Avenue

QUINCY, MASSACHUSETTS / MRA

Assessors Map # 1021-22

1979

Scale: 1 inch equals 80 feet

Please refer to the map in the  
Multiple Property Cover Sheet  
for this property

Multiple Property Cover Sheet Reference Number: 64000289