

UNITED STATES DEPARTMENT OF THE INTERIOR
NATIONAL PARK SERVICE

FOR NPS USE ONLY

RECEIVED JAN 29 1980

DATE ENTERED

APR 10 1980

**NATIONAL REGISTER OF HISTORIC PLACES
INVENTORY -- NOMINATION FORM**

SEE INSTRUCTIONS IN *HOW TO COMPLETE NATIONAL REGISTER FORMS*
TYPE ALL ENTRIES -- COMPLETE APPLICABLE SECTIONS

1 NAME

HISTORIC

St. Mary's College Historic ~~Buildings~~

District (see continuation sheet 4/7/80)

AND/OR COMMON

2 LOCATION

STREET & NUMBER

S of St. Mary

— NOT FOR PUBLICATION

CITY, TOWN

St. Mary *nc.*

VICINITY OF

CONGRESSIONAL DISTRICT

2

STATE

Kentucky

CODE

021

COUNTY

Marion

CODE

155

3 CLASSIFICATION

CATEGORY

- DISTRICT
- BUILDING(S)
- STRUCTURE
- SITE
- OBJECT

OWNERSHIP

- PUBLIC
- PRIVATE
- BOTH
- PUBLIC ACQUISITION**
- IN PROCESS
- BEING CONSIDERED

STATUS

- OCCUPIED
- UNOCCUPIED
- WORK IN PROGRESS
- ACCESSIBLE**
- YES: RESTRICTED
- YES: UNRESTRICTED
- NO

PRESENT USE

- AGRICULTURE
- COMMERCIAL
- EDUCATIONAL
- ENTERTAINMENT
- GOVERNMENT
- INDUSTRIAL
- MILITARY
- MUSEUM
- PARK
- PRIVATE RESIDENCE
- RELIGIOUS
- SCIENTIFIC
- TRANSPORTATION
- OTHER:

4 OWNER OF PROPERTY

NAME

Cornucopia Incorporated

STREET & NUMBER

CITY, TOWN

St. Mary

— VICINITY OF

STATE

Kentucky

5 LOCATION OF LEGAL DESCRIPTION

COURTHOUSE,
REGISTRY OF DEEDS, ETC.

Marion County Courthouse

STREET & NUMBER

CITY, TOWN

Lebanon

STATE

Kentucky

6 REPRESENTATION IN EXISTING SURVEYS

TITLE

Survey of Historic Sites in Kentucky

DATE

1977

— FEDERAL STATE — COUNTY — LOCAL

DEPOSITORY FOR
SURVEY RECORDS

Kentucky Heritage Commission

CITY, TOWN

Frankfort

STATE

Kentucky

7 DESCRIPTION

CONDITION

CHECK ONE

CHECK ONE

EXCELLENT

DETERIORATED

UNALTERED

ORIGINAL SITE

GOOD

RUINS

ALTERED

MOVED DATE _____

FAIR

UNEXPOSED

DESCRIBE THE PRESENT AND ORIGINAL (IF KNOWN) PHYSICAL APPEARANCE

St. Mary's College is located in the center of Marion County, in southcentral Kentucky, near the small community of St. Mary. This complex of buildings is situated away from the main road in a verdant area of the county. Nine buildings comprise the St. Mary campus.

At the northwest end of the complex sits the one-story, 1904 Gymnasium Building. A high, cut-stone foundation supports the brick structure and hipped, standing seam roof shelters it. Hipped roof dormers project from each end of the building. The gym is seven bays deep and four bays wide, with each bay recessed and topped by a segmental arch. All window openings are segmentally arched also. (See photo 1).

Just to the south of the gym is an L-shaped 1830s classroom building, Columbia. It is a three-story, Flemish bond brick structure with jack arches and a dormered, mansard roof. The main entrance is located in the angle of the ell. The interior was remodelled in the 1930s for use as modern classrooms (See photo 2).

The east side of the campus is made up of a three-building complex. The southernmost structure is a classroom building built in the 1830s, Refectory. Three stories in height, it has Flemish bond brickwork and jack arches. The main south facade has a fanlight, columned entrance with sidelights. As with the other two main building, a mansard roof with dormers and fish-scale shingling tops the structure. A two-story, brick maintenance structure extends from the east side of this building (See photos 3-5).

The Chapel is connected, in an ell formation, to the north side of the previously mentioned structure. It is a one-story, Flemish bond brick structure. Gothic windows with leaded glass motifs grace each side. A standing seam roof covers this apse-form building (See photos 6-8).

A third structure in this three-building complex is an 1830s dormitory, Shamrock. Similar in scale and design to the others, it is a three-story, Flemish bond brick structure, with jack arches. A mansard roof with dormers tops this building also (See photo 9-10).

Northeast of Shamrock is a brothers residence that was constructed in 1916. It is a two-story, pyramidal roofed frame structure. A one-story Victorian style porch graces the front of the building (See photo 11).

Southeast of the main complex is a small, one-story photo laboratory. Constructed of brick, it has segmental arches, and a pyramidal standing seam roof. A pyramidal roofed monitor tops the structure (See photo 12).

Directly south of the photo lab is a two-sectioned, one-story utility building. The structure has common bond brick pattern, segmental arched openings and a standing seam roof. A small, brick pyramidal roofed building, sitting at the southeast corner of the complex, is also included in the historic campus. Two other 20th century buildings were constructed for use by the college (See photo 13).

8 SIGNIFICANCE

PERIOD	AREAS OF SIGNIFICANCE -- CHECK AND JUSTIFY BELOW				
<input type="checkbox"/> PREHISTORIC	<input type="checkbox"/> ARCHEOLOGY-PREHISTORIC	<input type="checkbox"/> COMMUNITY PLANNING	<input type="checkbox"/> LANDSCAPE ARCHITECTURE	<input checked="" type="checkbox"/> RELIGION	
<input type="checkbox"/> 1400-1499	<input type="checkbox"/> ARCHEOLOGY-HISTORIC	<input type="checkbox"/> CONSERVATION	<input type="checkbox"/> LAW	<input type="checkbox"/> SCIENCE	
<input type="checkbox"/> 1500-1599	<input type="checkbox"/> AGRICULTURE	<input type="checkbox"/> ECONOMICS	<input type="checkbox"/> LITERATURE	<input type="checkbox"/> SCULPTURE	
<input type="checkbox"/> 1600-1699	<input checked="" type="checkbox"/> ARCHITECTURE	<input checked="" type="checkbox"/> EDUCATION	<input type="checkbox"/> MILITARY	<input type="checkbox"/> SOCIAL/HUMANITARIAN	
<input type="checkbox"/> 1700-1799	<input type="checkbox"/> ART	<input type="checkbox"/> ENGINEERING	<input type="checkbox"/> MUSIC	<input type="checkbox"/> THEATER	
<input checked="" type="checkbox"/> 1800-1899	<input type="checkbox"/> COMMERCE	<input type="checkbox"/> EXPLORATION/SETTLEMENT	<input type="checkbox"/> PHILOSOPHY	<input type="checkbox"/> TRANSPORTATION	
<input checked="" type="checkbox"/> 1900-	<input type="checkbox"/> COMMUNICATIONS	<input type="checkbox"/> INDUSTRY	<input type="checkbox"/> POLITICS/GOVERNMENT	<input type="checkbox"/> OTHER (SPECIFY)	
		<input type="checkbox"/> INVENTION			

SPECIFIC DATES 1830s

BUILDER/ARCHITECT

STATEMENT OF SIGNIFICANCE

Before it closed in 1976, St. Mary's College was the third oldest operating Catholic college for boys in the nation and was a leader in Catholic education in the state. Established in 1821, St. Mary's was in operation thirteen years before Marion County was formed. The extant main college buildings on St. Mary's campus are of a style and composition that reflect the early character of the complex.

Present-day Marion and Nelson counties have one of the oldest and largest Catholic populations in the state of Kentucky. There were many Catholic families in this area as early as 1787. At that time, four American Sees were created: Boston, New York, Philadelphia and Bardstown, Kentucky. Father Benedict Joseph Flaget was appointed bishop of the Bardstown See.

Reverend Charles Nerinckx, a native of Belgium, came to Kentucky in 1805 as Flaget's assistant and remained in the state for 19 years. After he established a sisterhood to educate the girls in the area in 1812, Reverend Nerinckx had plans to begin a school for boys. He purchased a farm of 311 acres, naming the area Mount Mary. His plan was based on the school at Loretto which he helped start in 1812 (see National Register form for Loretto Motherhouse.) In 1819 Father Nerinckx traveled to Europe and in his absence the land was purchased by Reverend William Byrne. He opened St. Mary's College in 1821 using an abandoned distillery on the farm as a classroom building. Two previously established Catholic colleges included: Georgetown College in Washington, D.C., established in 1789 and Mount St. Mary's College in Maryland, established in 1808. Although funds were scarce, and the school experienced several fires, Father Byrne managed to keep St. Mary's running for over 12 years. During that time over 1,000 students received degrees.¹ In 1833, the school was turned over to the Society of Jesuits and Father Byrne passed away the same year.

St. Mary's continued under the administration of the Jesuits from 1833 to 1846. This period was marked by prosperity and the school earned a reputation for its scholarly and wholesome atmosphere. By 1837, the school had grown considerably and was chartered by the state legislature.

Most of the older structures on St. Mary's campus date to the Jesuit period. The Columbia, Shamrock, Old Chapel, and Refectory buildings were all constructed in the 1830s at a cost of \$50,000.

Some of the well-known alumni of St. Mary's include: The Honorable J. Proctor Knott (1830-1911, later Governor of Kentucky), Theodore O'Hara (1820-1851, journalist and author) and The Honorable Elisha Standiford (President of the Louisville and Nashville Railroad from 1875 to 1880).

9 MAJOR BIBLIOGRAPHICAL REFERENCES

Memorare--St. Mary's College 150 Years 1821-1971. College yearbook compiled from volumes of the Sentinel, the official college publication. No publisher given.

Webb, Ben J. The Centenary of Catholicity in Kentucky. Louisville: Charles A. Rogers, 1884.

UTM NOT VERIFIED

Information received from Cornucopia, Incorporated.

10 GEOGRAPHICAL DATA

ACREAGE OF NOMINATED PROPERTY approx. 7 1/2 acres.

ACREAGE NOT VERIFIED

QUADRANGLE NAME Lebanon West

QUADRANGLE SCALE 1:24000

UTM REFERENCES

A 16 | 64 | 63 | 010 | 41 | 59 | 28 | 010

B 16 | 64 | 62 | 810 | 41 | 59 | 08 | 010

ZONE EASTING NORTHING

ZONE EASTING NORTHING

C 16 | 64 | 60 | 610 | 41 | 59 | 08 | 010

D 16 | 64 | 61 | 410 | 41 | 59 | 30 | 010

E [] | [] | [] | [] | [] | [] | [] | []

F [] | [] | [] | [] | [] | [] | [] | []

G [] | [] | [] | [] | [] | [] | [] | []

H [] | [] | [] | [] | [] | [] | [] | []

I [] | [] | [] | [] | [] | [] | [] | []

J [] | [] | [] | [] | [] | [] | [] | []

K [] | [] | [] | [] | [] | [] | [] | []

L [] | [] | [] | [] | [] | [] | [] | []

VERBAL BOUNDARY DESCRIPTION

Beginning at a point A at the northeast corner of the campus, the boundary extends south approximately 700' to point B. The boundary turns west approximately 800' to point C. The boundary line between C and D runs northeast approximately 800'. (Cont.)

LIST ALL STATES AND COUNTIES FOR PROPERTIES OVERLAPPING STATE OR COUNTY BOUNDARIES

STATE CODE COUNTY CODE

STATE CODE COUNTY CODE

11 FORM PREPARED BY

NAME / TITLE

Jayne C. Henderson/Historian

ORGANIZATION

Kentucky Heritage Commission

DATE

November 1979

STREET & NUMBER

104 Bridge Street

TELEPHONE

502/564-3741

CITY OR TOWN

Frankfort.

STATE

Kentucky

12 STATE HISTORIC PRESERVATION OFFICER CERTIFICATION

THE EVALUATED SIGNIFICANCE OF THIS PROPERTY WITHIN THE STATE IS:

NATIONAL

STATE

LOCAL

As the designated State Historic Preservation Officer for the National Historic Preservation Act of 1966 (Public Law 89-665), I hereby nominate this property for inclusion in the National Register and certify that it has been evaluated according to the criteria and procedures set forth by the National Park Service.

STATE HISTORIC PRESERVATION OFFICER SIGNATURE

Edred W. Mutton

TITLE

State Historic Preservation Officer

DATE

1-10-80

FOR NPS USE ONLY

I HEREBY CERTIFY THAT THIS PROPERTY IS INCLUDED IN THE NATIONAL REGISTER

W. Ray Luce
KEEPER OF THE NATIONAL REGISTER

DATE

4/10/80

ATTEST: *Kristin O'Connell*
CHIEF OF REGISTRATION

DATE

4/10/80

UNITED STATES DEPARTMENT OF THE INTERIOR
NATIONAL PARK SERVICE

**NATIONAL REGISTER OF HISTORIC PLACES
INVENTORY -- NOMINATION FORM**

St. Mary's College Historic District
Marion County, Kentucky

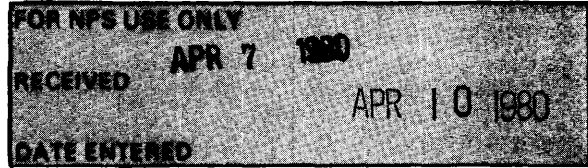

CONTINUATION SHEET

ITEM NUMBER 1 PAGE 2

ADDENDUM

Historic Name

Change to:

St. Mary's College Historic District

UNITED STATES DEPARTMENT OF THE INTERIOR
NATIONAL PARK SERVICE

**NATIONAL REGISTER OF HISTORIC PLACES
INVENTORY -- NOMINATION FORM**

FOR NPS USE ONLY	
RECEIVED	JAN 29 1980
DATE ENTERED	APR 10 1980

St. Mary's College
Marion County, Kentucky

CONTINUATION SHEET

ITEM NUMBER

7

PAGE

2

In 1906 Eden Villa, a two-story, three-bay brick administration building was erected. It has a pyramidal roof, denticulated cornice, and keystones over the window openings. A two-bay dormer with pyramidal roof graces the roof. A brick garage with a standing seam roof sits to the east of Eden Villa. Eden Villa is situated north of the main campus. It is separated from the older structures by a 1960s brick administration building (See photos 14- 15).

Non-Contributing Structures

The three-story brick administration building, constructed in the 1960s and located between Eden Villa (L) and the rest of the campus, is not a contributing element (See photo 16).

The nominated area includes all historic buildings which comprise the campus, and which contribute to the visual integrity of the site.

UNITED STATES DEPARTMENT OF THE INTERIOR
NATIONAL PARK SERVICE

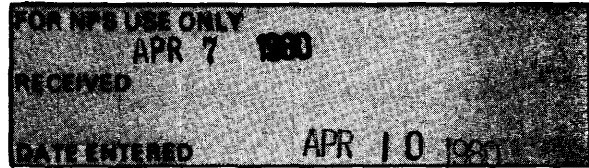

**NATIONAL REGISTER OF HISTORIC PLACES
INVENTORY -- NOMINATION FORM**

St. Mary's College Historic District
Marion County, Kentucky

CONTINUATION SHEET

ITEM NUMBER 7

PAGE 2

ADDENDUM

Boundary Justification

The boundary of the St. Mary's College Historic District nomination was drawn so as to encompass all historic structures which comprise the campus area. The campus buildings include the following: classroom buildings, dormitories, chapel, utility buildings, and faculty residences.

The farm buildings shown on the 1953 USGS map outside the boundary are no longer extant.

Located within the district is a 1960s college administration building which, because of its association with the college and its unobtrusive architecture, is not considered an intrusion, but a contributing element to the district.

UNITED STATES DEPARTMENT OF THE INTERIOR
NATIONAL PARK SERVICE

**NATIONAL REGISTER OF HISTORIC PLACES
INVENTORY -- NOMINATION FORM**

FOR NPS USE ONLY
RECEIVED JAN 29 1980
APR 10 1980
DATE ENTERED

St. Mary's College
Marion County, Kentucky

CONTINUATION SHEET

ITEM NUMBER 8

PAGE 2

After 1846, the Jesuits relinquished control of St. Mary's to take over Fordham University in New York and the Diocesans assumed authority over the school. This period at St. Mary's proved uneventful until the outbreak of the Civil War. Many students left to enlist, and their departure financially drained the institution. St. Mary's was forced to close her doors from 1869 to 1871.

The Resurrectionist fathers took over St. Mary's in 1870 and spent \$7,000 and one year repairing the structures. In 1884 a new administration building was erected at a cost of \$20,000.² Ten years later all of the buildings were renovated, a water and steam heating system installed, and some additional farmland was purchased.³ Another building period occurred in 1904 when the new brick gymnasium was constructed at a cost of \$15,000. "Eden Villa," a brick house built in 1906, and a brothers residence, built in 1916, were the last two historic buildings constructed at St. Mary's. The last improvements were made in 1938 on the Columbia building when it was renovated inside and out for use as modern classrooms.

St. Mary's reached its peak enrollment with 339 students in 1965-66 but the school experienced a decline shortly after. Student enrollment was down to 37 by 1976, when St. Mary's closed.

Most of St. Mary's building were constructed in the 1830s in the Federal style. Although they were Victorianized in 1894 the alterations were tasteful and well executed. The fine brickwork and the Federal scale and massing remain. Of particular note is the finely proportioned fanned entrance on the Refectory building. The remaining structures can be said to reflect the good basic design and construction evident in the original 19th century buildings.

¹They were from all parts of the state and many of them returned to their respective communitites and established private schools where they endeavored to emulate their alma mater. Thus, the benefits of education were not confined to those who had been students at St. Mary's, but were wide-ranging in their effect.

²This structure was known as Byrne Hall and was destroyed by fire in the mid-1970s.

³Originally the main buildings on campus faced south. Both Columbia and the Refectory were three stories in height, with gabled roofs, and fan lit entrances.

UNITED STATES DEPARTMENT OF THE INTERIOR
NATIONAL PARK SERVICE

**NATIONAL REGISTER OF HISTORIC PLACES
INVENTORY -- NOMINATION FORM**

FOR NPS USE ONLY	
RECEIVED	JAN 29 1980
DATE ENTERED	APR 10 1980

St. Mary's College
Marion County, Kentucky

CONTINUATION SHEET

ITEM NUMBER

9

PAGE

2

Verbal Boundary Description

The closing boundary line between point D and A runs due east approximately 600'.

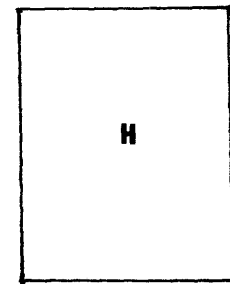
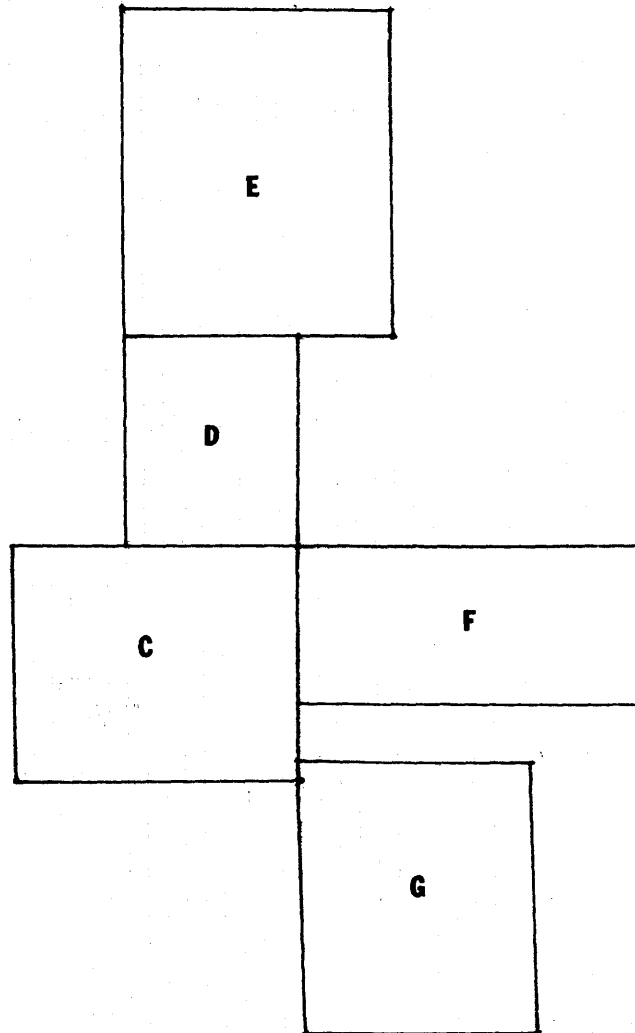
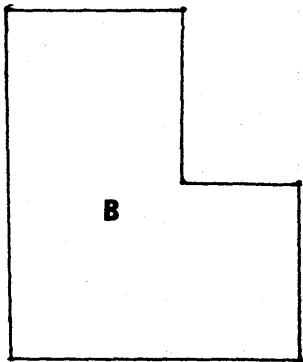
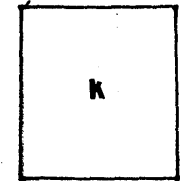
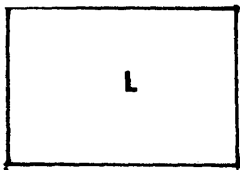
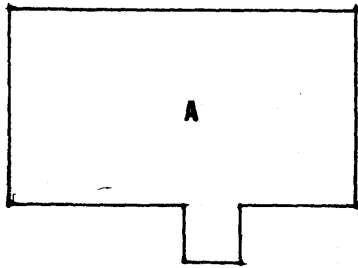

St. Mary's College, St. Mary,
 Marion, County, Kentucky
 Jayne C. Henderson Nov. 1979
 Kentucky Heritage Commission
 Frankfort, Kentucky

- E. The Shamrock
- F. Maintenance building
- G. Campus heating plant
- H. Photo laboratory
- I. Utility building
- J. Pyramidal roofed utility building
- K. Brothers residence
- L. Eden Villa

Diagram 1--not to scale.
 Historic Structures only

- A. Gymnasium
- B. The Columbia
- C. Refectory
- D. Chapel

APR 10 1980

JAN 29 1980

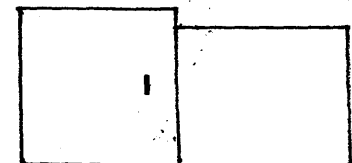

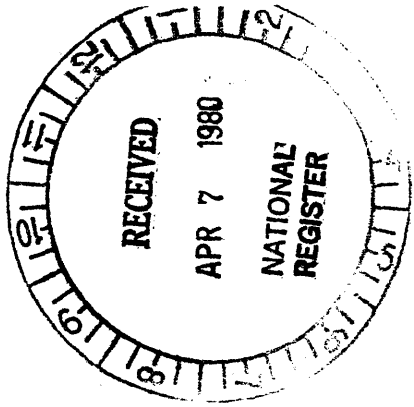

St. Mary's College
 St Mary, Marion County, Kentucky
 Jayne C. Henderson March 1980
 Kentucky Heritage Commission
 Frankfort, Kentucky

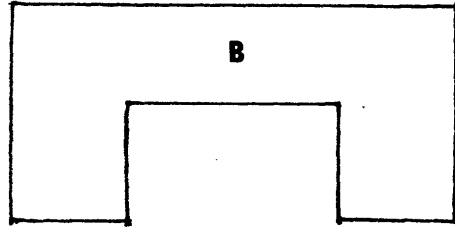

- A. Eden Villa
- B. Administration building(1960)
- C. Gymnasium
- D. The Columbia
- E. The Shamrock

- F. Chapel
- G. Refectory
- H. Maintenance building
- I. Campus heating plant
- J. Brothers residence



- K. Photo laboratory
- L. Utility building
- M. Pyramidal-roofed utility building

