

**United States Department of the Interior
National Park Service**

RECEIVED

**National Register of Historic Places
Continuation Sheet**

MAY 27 1987

NATIONAL
REGISTER

Section number CZ 10-a Page 1 Herman House

Site # CZ 10-a

1. Joseph Herman Chalkrock House.

2. Tabor Township
Tabor Vicinity
South Dakota Code: 046

First Congr. District
Bon Homme County Code: 009

3. Building; Privately owned; NA acquisition; Occupied; Restricted access;
Agricultural.

4. Monte and Ruth Smith
RR 1, Box 243
Tabor, SD 57063

5. Register of Deeds
Bon Homme County Courthouse
Tyndall, SD 57066

7. Deteriorated; Unaltered; Original site.

The Joseph Herman House is a three-bay L-shaped chalkrock masonry structure sited on a working farm and is complimented by two other historic folk buildings on the farmstead. It rests on a stone masonry foundation that is mortared with clay. A small rectangular cellar is located under the easternmost bay. Storm damage to the exterior walls reveals that they are constructed of irregularly-sized dressed chalkrock blocks mortared with clay and covered with a plaster veneer. Tapered window openings and the single entry door include jack arches and hand-cut pediment-shaped wooden lintels. A knee wall of stone and clay is evident in the loft. The intersecting gable roof is constructed of 31 common rafters, horizontal rough boards and wooden shingles. There are two brick chimneys, each located next to an interior partition wall. An open cupboard is built-in below the chimney in the east, entry bay.

The earliest interior wall color visible is a whitewash, followed by light blue, medium blue, pink, and green hues. Woodwork, mop boards, and floors were painted in dark blue and green hues until covered with a more recent white paint.

8. 1869-1899; Architecture, Exploration/Settlement, Czech Ethnic.

Specific date unknown. Attributed to Joseph Herman.

United States Department of the Interior
National Park Service

**National Register of Historic Places
Continuation Sheet**

Section number CZ 10-a Page 2 Herman House

Significant in architecture, the Joseph Herman House is one of the best specimens for the study of the L-shaped house form common to Czechs in the area around Tabor, SD. It not only conforms to the model form, it also offers good examples of special features of Czech folk buildings such as masonry jack arches, tapered window openings, and a knee wall. The state of disrepair of this building make such characteristics quite visible. Yet, this structure is not beyond the reach of restoration. It is a compliment to two other folk buildings located at this site.

The Herman House is also significant in the history of Czech settlement in the state. Joseph Herman was born in Teletin, Bohemia in 1833. He brought his family to Dakota in 1870 and started a brewery in Tabor. His sons Joseph, Frank, Anton, and Charles all moved north to Hutchinson County and established farms there. Major biographical source: Dvorak (1980), 116.

10. Acreage: less than one acre. Scale: 1/24,000.
Quad.: Tabor. UTM: 14/ 604370/ 4757750.

This site consists of an L-shaped house. The western boundary is an imaginary line lying 10 feet from the westernmost wall of the house and running parallel to that wall. The northern boundary is an imaginary line lying 10 feet from the northernmost wall of the house and running parallel to that wall. The eastern boundary is an imaginary line lying 10 feet from the easternmost wall of the house and running parallel to that wall. The southern boundary is an imaginary line lying 10 feet from the southernmost wall of the house and running parallel to that wall. The site is located in the Southwest Quarter of the Southeast Quarter of Seciton 8, Township 94 North, Range 58 West, in Bon Homme County.

**United States Department of the Interior
National Park Service**

National Register of Historic Places Continuation Sheet

Section number CZ 10-a Page 3 Herman Site

SITE PLAN OF FARMSTEAD CONTAINING CZ 10-a, CZ 10-b, & CZ 10-c

ON REVERSE SIDE

SITE PLAN (Complete inventory of all structures, their function, dates & details of construction, and surrounding vegetation) WITH NORTH ARROW

SITE NAME: John Herman
CZ SURVEY #: 10a, b, & c

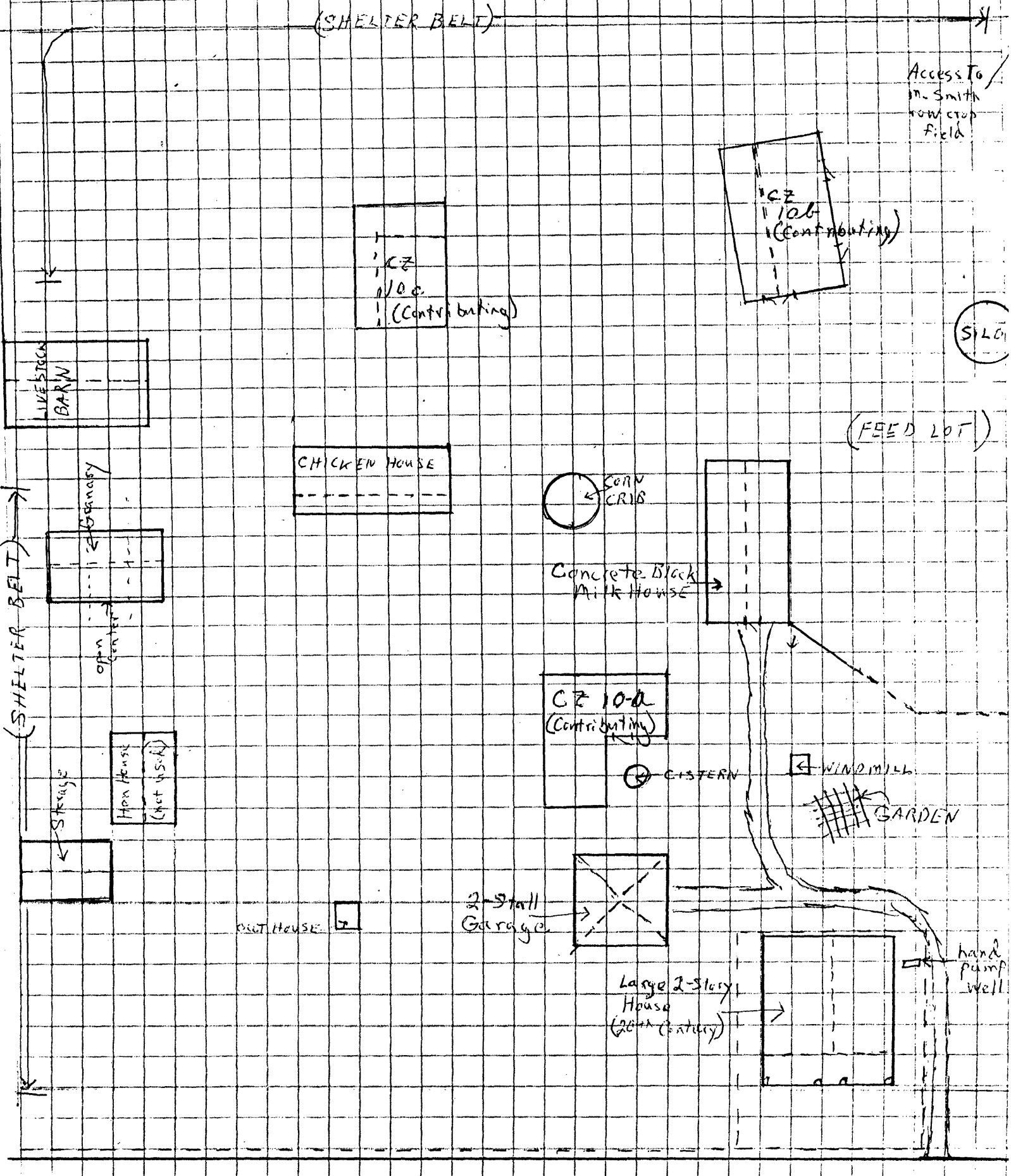

(SHELTER BELT)

Access to
m. Smith
row crop
field

CZ
100
(Contributing)

CZ
100
(Contributing)

LIVESTOCK
BARN

SILO

CHICKEN HOUSE

(FEED LOT)

(SHELTER BELT)

CORN
CRIB

Concrete Block
Milk House

CZ 100
(Contributing)

CISTERN

WINDMILL

GARDEN

HEN HOUSE
(hot & cold)

Storage

OUT HOUSE

2-STALL
Garage

Large 2-Story
House
(20th Century)

hand
pump
well