

**United States Department of the Interior
National Park Service**

RECEIVED

**National Register of Historic Places
Registration Form**

FEB 18 1993

NATIONAL
REGISTER

This form is for use in nominating or requesting determinations for individual properties and districts. See instructions in *How to Complete the National Register of Historic Places Registration Form* (National Register Bulletin 16A). Complete each item by marking "x" in the appropriate box or by entering the information requested. If an item does not apply to the property being documented, enter "N/A" for "not applicable." For functions, architectural classification, materials, and areas of significance, enter only categories and subcategories from the instructions. Place additional entries and narrative items on continuation sheets (NPS Form 10-900a). Use a typewriter, word processor, or computer, to complete all items.

1. Name of Property

historic name Senour, Frank, Round Barn

other names/site number Crandell Barn, 167-353-6000S

2. Location

street & number 6400 East Organ Church Road N/A not for publication

city or town Blackhawk vicinity

state Indiana code IN county Vigo code 167 zip code 47802

3. State/Federal Agency Certification

As the designated authority under the National Historic Preservation Act, as amended, I hereby certify that this nomination request for determination of eligibility meets the documentation standards for registering properties in the National Register of Historic Places and meets the procedural and professional requirements set forth in 36 CFR Part 60. In my opinion, the property meets does not meet the National Register criteria. I recommend that this property be considered significant nationally statewide locally. (See continuation sheet for additional comments.)

Patrick R. Latta 2/3/93
Signature of certifying official/Title Date

Indiana Department of Natural Resources

State of Federal agency and bureau

In my opinion, the property meets does not meet the National Register criteria. (See continuation sheet for additional comments.)

Signature of certifying official/Title Date

State or Federal agency and bureau

4. National Park Service Certification

I hereby certify that the property is:

- entered in the National Register. See continuation sheet.
- determined eligible for the National Register See continuation sheet.
- determined not eligible for the National Register.
- removed from the National Register.
- other, (explain:)

Signature of the Keeper

Date of Action

Patrick Andrews 4/2/93

Senour Round Barn
Name of Property

Vigo Co., IN
County and State

5. Classification

Ownership of Property
(Check as many boxes as apply)

- private
- public-local
- public-State
- public-Federal

Category of Property
(Check only one box)

- building(s)
- district
- site
- structure
- object

Number of Resources within Property
(Do not include previously listed resources in the count.)

| Contributing | Noncontributing | |
|--------------|-----------------|------------|
| 1 | 0 | buildings |
| 0 | 0 | sites |
| 0 | 0 | structures |
| 0 | 0 | objects |
| 1 | 0 | Total |

Name of related multiple property listing
(Enter "N/A" if property is not part of a multiple property listing.)

Number of contributing resources previously listed in the National Register

Round and Polygonal Barns of Indiana

0

6. Function or Use

Historic Functions
(Enter categories from instructions)

AGRICULTURE: animal facility

Current Functions
(Enter categories from instructions)

AGRICULTURE: animal facility

7. Description

Architectural Classification
(Enter categories from instructions)

OTHER: true-circular barn

Materials
(Enter categories from instructions)

foundation CONCRETE
walls WOOD: weatherboard

roof ASPHALT
other WOOD: shingle

Narrative Description

(Describe the historic and current condition of the property on one or more continuation sheets.)

Senour Round Barn

Name of Property

Vigo Co., IN

County and State

8. Statement of Significance

Applicable National Register Criteria

(Mark "x" in one or more boxes for the criteria qualifying the property for National Register listing.)

- A** Property is associated with events that have made a significant contribution to the broad patterns of our history.
- B** Property is associated with the lives of persons significant in our past.
- C** Property embodies the distinctive characteristics of a type, period, or method of construction or represents the work of a master, or possesses high artistic values, or represents a significant and distinguishable entity whose components lack individual distinction.
- D** Property has yielded, or is likely to yield, information important in prehistory or history.

Criteria Considerations

(Mark "x" in all the boxes that apply.)

Property is:

- A** owned by a religious institution or used for religious purposes.
- B** removed from its original location.
- C** a birthplace or grave.
- D** a cemetery.
- E** a reconstructed building, object, or structure.
- F** a commemorative property.
- G** less than 50 years of age or achieved significance within the past 50 years.

Areas of Significance

(Enter categories from instructions)

AGRICULTURE

ARCHITECTURE

Period of Significance

1905 - 1936

Significant Dates

1905

Significant Person

(Complete if Criterion B is marked above)

NA

Cultural Affiliation

NA

Architect/Builder

Senour, Frank

Narrative Statement of Significance

(Explain the significance of the property on one or more continuation sheets.)

9. Major Bibliographical References

Bibliography

(Cite the books, articles, and other sources used in preparing this form on one or more continuation sheets.)

Previous documentation on file (NPS):

- preliminary determination of individual listing (36 CFR 67) has been requested
- previously listed in the National Register
- previously determined eligible by the National Register
- designated a National Historic Landmark
- recorded by Historic American Buildings Survey # _____
- recorded by Historic American Engineering Record # _____

Primary location of additional data:

- State Historic Preservation Office
- Other State agency
- Federal agency
- Local government
- University
- Other

Name of repository:

Historic Landmarks Foundation
of Indiana

Senour Round Barn
Name of Property

Vigo Co., IN
County and State

10. Geographical Data

Acreage of Property Less than one acre

UTM References

(Place additional UTM references on a continuation sheet.)

| | | | |
|---|-----------|---------------|----------------|
| 1 | <u>16</u> | <u>472470</u> | <u>4353820</u> |
| | Zone | Easting | Northing |
| 2 | | | |

| | | | |
|---|------|---------|----------|
| 3 | | | |
| | Zone | Easting | Northing |
| 4 | | | |

See continuation sheet

Verbal Boundary Description

(Describe the boundaries of the property on a continuation sheet.)

Boundary Justification

(Explain why the boundaries were selected on a continuation sheet.)

11. Form Prepared By

name/title Jerry McMahan Indiana
organization Historic Landmarks Foundation of date November 11, 1991
street & number 340 W. Michigan Street telephone 317/639-4534
city or town Indianapolis state IN zip code 46202

Additional Documentation

Submit the following items with the completed form:

Continuation Sheets

Maps

A **USGS map** (7.5 or 15 minute series) indicating the property's location.

A **Sketch map** for historic districts and properties having large acreage or numerous resources.

Photographs

Representative **black and white photographs** of the property.

Additional items

(Check with the SHPO or FPO for any additional items)

Property Owner

(Complete this item at the request of SHPO or FPO.)

name Courtney and Rose Crandell
street & number Rt. 24, Box 162 telephone _____
city or town Terre Haute state IN zip code 47802

Paperwork Reduction Act Statement: This information is being collected for applications to the National Register of Historic Places to nominate properties for listing or determine eligibility for listing, to list properties, and to amend existing listings. Response to this request is required to obtain a benefit in accordance with the National Historic Preservation Act, as amended (16 U.S.C. 470 *et seq.*).

Estimated Burden Statement: Public reporting burden for this form is estimated to average 18.1 hours per response including time for reviewing instructions, gathering and maintaining data, and completing and reviewing the form. Direct comments regarding this burden estimate or any aspect of this form to the Chief, Administrative Services Division, National Park Service, P.O. Box 37127, Washington, DC 20013-7127; and the Office of Management and Budget, Paperwork Reductions Projects (1024-0018), Washington, DC 20503.

**United States Department of the Interior
National Park Service**

**National Register of Historic Places
Continuation Sheet**

Section number 7 Page 1 Senour Barn
Vigo Co., IN

Rural Vigo County just south of Terre Haute, Indiana, is the home of the Senour Round Barn, a true circle built in 1905 by owner Frank Senour. Located west of Indiana 159, the site is reached off of the county road by a long drive that runs to the north past the house and then turns west, passing the garage and ending with a shed on the west. The drive makes another turn to the south just past the garage with this fork revealing the true circular structure. To the southeast of the round barn is a rectangular chicken coop and to the west is a modern pole barn. The entire site is surrounded by mature trees and cultivated fields to the south, west and north. This simple true circular barn retains its integrity in regard to location, design, setting, materials, workmanship, feeling and association, meeting all of the standards set forth in the registration requirements for multiple property nominations.

The true circular, roughly 50 foot diameter, two-storied structure is capped by a conical roof with four dormers on the north, south, east and west. These dormers contain louvered vents to allow ventilation to the upper level. Dormer walls are composed of wood shingles. On the east and west, the main doors are housed in projections that are shielded by shed-type roofs that are curved to mimic the shape of the barn. Finally, the balloon frame wall construction is anchored firmly to the poured concrete foundation.

The roof surfaces are now covered in asphalt replacement shingles, a modern alteration that minimally affects the historic integrity of the structure. The rafters and roof decking are exposed in the soffit which is created by the slight overhang to the eaves. The wall surfaces are sheathed in the original vertical wood siding that is still well-maintained.

The main facade on the east (Photo 1) reveals the large entrance projection that fills the space between the eave of the main roof and the ground (Photo 2). The doors are large sliding doors mounted on overhead tracks, one and one-half story in height and composed of vertical planks. There is an identical door on the west and a smaller sliding door on the north to allow passage of humans and animals. Continuing around the barn from the east to the north, there are two evenly spaced four light windows,

United States Department of the Interior
National Park Service

National Register of Historic Places
Continuation Sheet

Section number 7 Page 2 Senour Barn
Vigo Co, IN

followed by the small north door and then two more evenly spaced windows (Photo 3). The south half of the barn between the west and east doors is comprised of a series of four, four light windows. The rhythm established by their placement would indicate five windows evenly spaced around the south half but there is no opening on the southwest (also visible in Photo 1). The upper level has the entrance projection roof occupy the east and west faces of the barn. The north and south halves of the structure have five evenly spaced louvered vents.

The interior of the structure (see floor plan) is very spacious and well designed with a central drive running from east to west and pens located on the north and south sides. On the north side of the central drive is a large pen that is broken only by a centrally located, rectangular corn crib. Sliding gates on both sides of the corn crib allow access to the pen. Further, on the east end is a permanent ladder that ascends to the upper level. South of the drive is a narrow walkway/manger that runs parallel to the drive. Off the walkway is a centrally located storage bin. Completing the lower level around the barn's perimeter, moving from west to east, are three milk stanchions followed by four pens, all of which have feed troughs toward the barn's center. The floor joists of the upper level can be seen from the lower level with the area north and south of the drive containing inwardly radiating joists braced by a laminated beam and support posts buried in the walls of the corn crib and storage bin. The joists over the central drive run north to south and are supported by beams and posts along the line of the central drive. Finally, the foundation and flooring are composed of concrete. The simple yet efficient lay out is used today for the housing of horses on the south and pigs on the north.

The upper level, reached via the ladder, is an open area for the storage of hay and straw. There is a central area that corresponds to the drive that is raised on the west and open to below on the east. This open area accommodates the delivery and handling of hay and straw and the raised portion takes advantage what could be wasted space if the entire length of the drive were left open. Finally, there is a centralized grain bin that has a drop chute to the central drive below.

**United States Department of the Interior
National Park Service**

**National Register of Historic Places
Continuation Sheet**

Section number 7 Page 3 Senour Barn
Vigo Co., IN

The roof system is a study in engineering and planning with the stick trusses being supported by an intricate system of braces, cross-braces and laminated beams (Photo 4). Located about one-third of the way down the roof from the apex and at the base of the dormer windows is a large laminated beam that supports the top portion of the roof. This beam is braced and cross-braced against itself by a network of timbers that divide the resulting circle into eight pieces (Photo 4). Located at intervals around the upper circle are additional braces that attach to the roof trusses and the inward web of timbers. Furthermore, near each dormer is another brace that links the laminated beam to the upper roof section, thus offering much needed intermediate support close to the extra weight of the dormer units. The remainder of the roof transfers its load to the outer walls where the weight is then transferred to the poured concrete foundation.

The Senour Round Barn, standing now for almost ninety years, has been extremely well-maintained and cared for by its current owners.

United States Department of the Interior
National Park Service

National Register of Historic Places Continuation Sheet

Section number 7 Page 4 Senour Barn
Vigo Co., IN

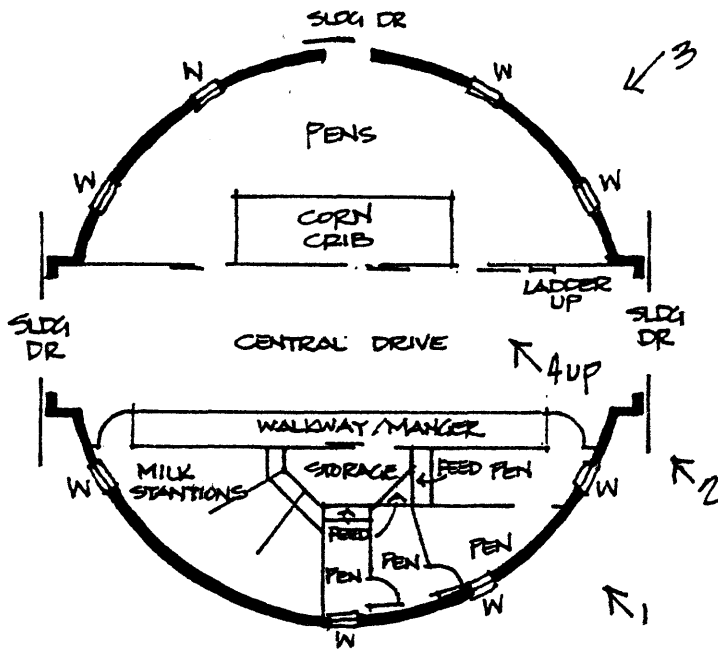

LOWER LEVEL no scale

Note: W = Window
V = Vent

UPPER LEVEL no scale

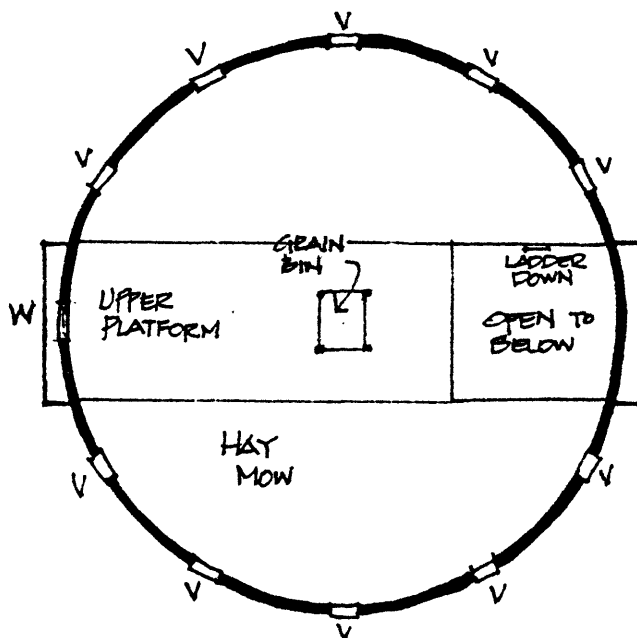

SENOUR (GRANDELL) BARN

1905 TRUE CIRCLE
VIGO COUNTY, INDIANA
PIERSON TOWNSHIP

↑ = Photographic Key

United States Department of the Interior
National Park Service

National Register of Historic Places
Continuation Sheet

Section number 8 Page 5

Senour Barn
Vigo Co., IN

The Senour Round Barn, located in Pierson Township of Vigo County, Indiana, is significant for its association with the development of round and polygonal barns in Indiana (see historic context, "Round and Polygonal Barns of Indiana."). The Senour Round Barn illustrates how agricultural literature helped to foster the round barn idea, since Mr. Senour used such a journal as the source for his barn design. The barn is an important and direct link to the agricultural development that occurred in the state from 1850 to 1936 (and beyond) and has changed very little since its completion in 1905, with the exception of the cupola, which was lost to a tornado in 1922. The period of greatest significance of the barn was from 1905 to 1936 when round and polygonal barns lost their popularity. By 1936, round and polygonal barns were considered obsolete and the last round structure was built in the state to replace a 1915 round barn that had burned (Grant County, Richland Township, extant).

The original owner of the barn was Frank Senour, a local farmer who got the idea for the barn from the Indiana Farmer. Quite industrious and wishing to build the state-of-the-art barn that would put his farm at the forefront of agricultural technology, Senour built the barn in 1905 with wood shingles, siding and frame atop a poured concrete foundation. Other improvements to the property included a chicken coop, frame farmhouse, garage and shed. When finished, Mr. Senour had a large true circular structure with projecting entries on the north and south with animals housed on the lower level on either side of the central drive. The upper level hay mow was obviously designed to store hay and straw.¹

The Senour family owned the farm for a number of years until they sold the property to the Baker family. The Baker family owned it for a few years before selling to Jim and Catherine Hughes in 1954. The Hughes sold to Courtney and Rose Crandell in 1972, the current owners. The Crandells maintain the barn and financed the new asphalt roof in the early 1980s, an improvement that was needed to save the roof system from the deterioration of leaks. Today, the Crandells use the barn to house their Belgian horses on the south and hogs are penned on the north. Additionally, the barn stores tack, buggies, tractors along with the upper level's hay and straw.²

**United States Department of the Interior
National Park Service**

**National Register of Historic Places
Continuation Sheet**

Section number 8 Page 6 Senour Barn
Vigo Co., IN

One of the unique design elements of the barn is the use of four dormers to add light and ventilation to the upper level. A cupola was a part of the original design but a 1922 tornado destroyed the cupola and it has not been replaced. Only six extant Indiana barns have dormers such as these, which differ from hay dormers that allowed access to the hay mow with large doors or windows. These barns were built in Boone County (Jefferson Township), Clinton County (Michigan Township), Jay County (Wayne Township), Madison County (Boone Township), Montgomery County (Union Township) and the Senour (Crandell) barn. The barn that most closely resembles the Senour barn's dormer configuration is the one in Jay County, located on the grounds of the Jay County Fairgrounds. This barn, although octagonal, has the four upper level dormers like the Senour Barn, in addition to eight dormers located closer to the eave line. All in all, the dormer arrangement and occurrence on the Senour Round Barn is quite unusual and aesthetically pleasing.

The Senour Barn is an unusual and interesting example of a true circular barn, being one of the six extant examples with this dormer arrangement. There were 219 round and polygonal barns built in Indiana between 1850 and 1936 and of these, 151 were true circles, with only 77 remaining today. The Senour Barn has all of the essential physical characteristics that it possessed at the time of its period of significance from 1905 to the mid 1930s and has not been significantly altered through time. The only real changes have been the loss of the cupola to natural disaster (1922) and the new asphalt shingles, both changes that do not affect the historic integrity of the barn. Finally, although the building has aged, it is still in very good condition and well-preserved so that it serves as a direct link to the agricultural development and refinement in Indiana.

United States Department of the Interior
National Park Service

National Register of Historic Places Continuation Sheet

Section number 8 Page 7 Senour Barn
Vigo Co., IN

ENDNOTES

1. Rose Crandell, owner of the Senour (Crandell) barn, Terra Haute, Indiana. Information based on letter from one of Mr. Sencur's daughters, sent to the Crandells in the early 1980s. Interviewed by Jerry McMahan, 27 October 1991.
2. Ibid.

National Register of Historic Places Continuation Sheet

Section number 9 Page 8 Senour Barn
Vigo Co., IN

BIBLIOGRAPHY

- Crandell, Rose. Owner of the Senour (Crandell) barn, Terra Haute, Indiana. Information based on a letter from one of Mr. Senour's daughters, sent to the Crandells in the early 1980s. Interviewed by Jerry McMahan, 27 October 1991.
- Hanou, John. Research compiled on Indiana's round and polygonal barns from 1986 to present. Archived at Historic Landmarks Foundation of Indiana, 340 West Michigan Street, Indianapolis, IN 46202.
- Intensive architectural survey of Indiana's round and polygonal barns. Conducted June to August 1991, conducted by Jerry McMahan, areawide survey of round and polygonal architectural and historical resources.
- Soike, Lowell J. Without Right Angles, The Round Barns of Iowa. Des Moines, IA: Iowa State Historical Department, Office of Historic Preservation, 1983.

United States Department of the Interior
National Park Service

National Register of Historic Places
Continuation Sheet

Section number 10 Page 9

Senour Barn
Vigo Co., IN

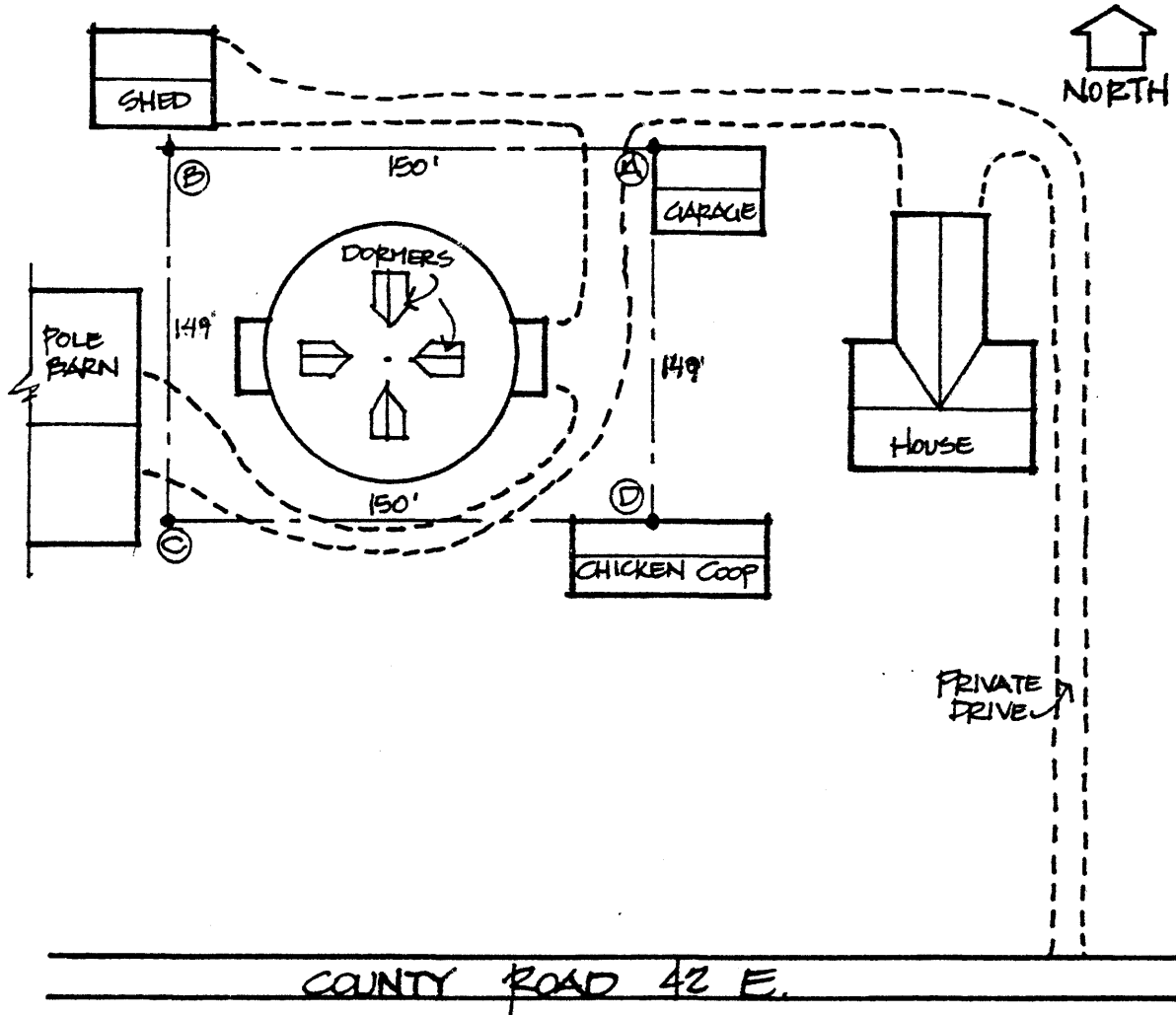

SENOUR (CRANDELL) BARN

SITE PLAN
NO SCALE

1905 TRUE CIRCLE
VIGO COUNTY, INDIANA
PIERSON TOWNSHIP

**United States Department of the Interior
National Park Service**

**National Register of Historic Places
Continuation Sheet**

Section number 10 Page 10 Senour Round Barn
Vigo Co., IN

Verbal Boundary Description

The Senour Round Barn is located in the NWSW of Section 4, T10N-R8W of Pierson Township, Vigo County, Indiana. Referring to the site plan, beginning at a point one foot west of the northwest corner of the garage (Point A), proceed 150 feet west to Point B, then proceed 149 feet south to Point C, then proceed 150 feet east to Point D, Point D being one foot north of the north wall of the chicken coop, then proceed 149 feet north to Point A.

Boundary Justification

The boundary includes only the nominated resource, using other existing buildings as reference points.