

MAY 22 1988

FORM B - BUILDING

654

AREA

FORM NO.

MASSACHUSETTS HISTORICAL COMMISSION  
80 BOYLSTON STREET  
BOSTON, MA 02116

399

Winchester, Mass. MRA

Town WINCHESTER

Address 22 Ginn Road

Historic Name Ginn Gardener's House

Photo (3"x3" or 3"x5", black and white) Indicate address of property on back of photo. Staple to left side of form.

Use: Present dwelling

Original dwelling

DESCRIPTION

Date 1900

Source tax records

Style Georgian Revival

Architect unknown

Exterior Wall Fabric brick

Outbuildings none

Major Alterations (with dates) none

Condition excellent

Moved no Date n/a

Acreage 10,585sq.ft. / .24A / 16-0030

Setting residential neighborhood of

mixed date

Recorded by Carl Hage, Carol Ely

Organization Winchester Historical Comm.

Date 12/78; 10/87 revised by C. Jenkins

Sketch Map: Draw map showing property's location in relation to nearest cross streets and/or geographical features. Indicate all buildings between inventoried property and nearest intersection(s). Indicate north

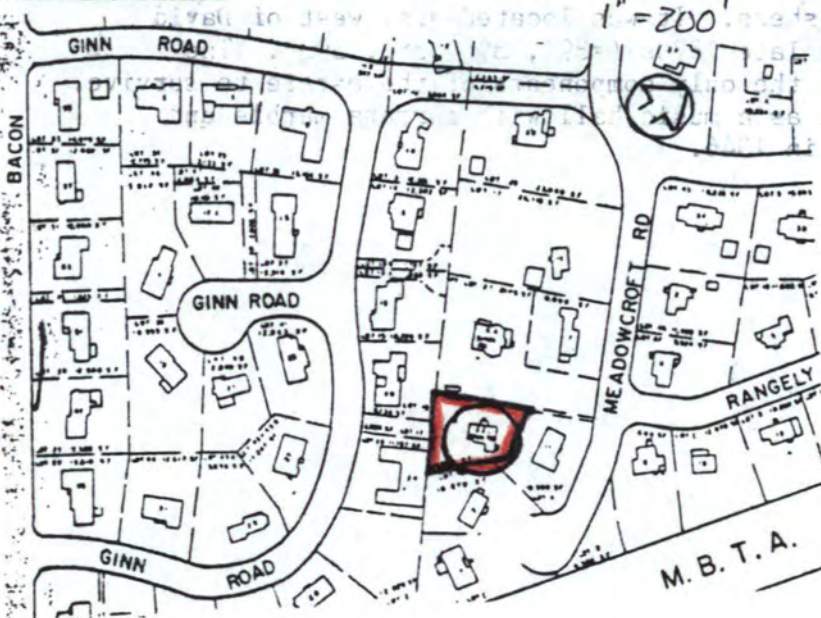

UTM REFERENCE 19.3 23960. 4701350

USGS QUADRANGLE LEXINGTON, MASS.

SCALE 1:25,000

**NATIONAL REGISTER CRITERIA STATEMENT (if applicable)**

The Edwin Ginn Gardener's House possesses integrity of location, design, materials, workmanship, feeling and associations. It is significant as one of two remaining outbuildings from Winchester's most ambitious Georgian Revival estate. The estate, known as "Terrace of Oaks", was developed in 1900 by wealthy textbook publisher, Edwin Ginn; the main house was unfortunately demolished in 1946. Even this outbuilding, however, reflects the architectural quality of the estate with its slate hip roof, brickwork laid up in Flemish bond, and pedimented central pavilion with arched window above the entry. It meets criterion C of the National Register of Historic Places.

**ARCHITECTURAL SIGNIFICANCE Describe important architectural features and evaluate in terms of other buildings within the community.**

The Ginn Gardener's House is a well detailed example of the Georgian Revival style that reflects the quality of the estate house that was demolished in 1946. It is a two story structure enclosed by a slate hip roof. It is constructed of brick laid up in Flemish bond and is trimmed with a marble water table, lintels and sills. It has a symmetrical five bay facade that is organized around a pedimented central pavilion defined by pilasters. A simply detailed entry with Tuscan porch and balustrade is headed by a large arched window at the second story. Two windows with heavy sills and lintels and 6/6 sash, flank the central bay at each story; those at the second story are substantially smaller, in imitation of high style Georgian and Federal period houses. It is located directly behind the Ginn Carriage House (#400).

**HISTORICAL SIGNIFICANCE Explain the role owners played in local or state history and how the building relates to the development of the community.**

The Ginn Gardener's House was constructed in 1900 as a dependency of the Ginn Estate. Known as "Terrace of Oaks", the estate was built by Edwin Ginn, a wealthy textbook publisher and founder of Ginn & Company, publishers. It was located just west of David Skilling's estate, Rangely, dating from the late 1870s (#394, 398, 387, 393). The Gardener's House and the Carriage House are the only components of the estate to survive. The main house and other dependencies, such as a music hall with carrara marble and walnut paneled auditorium, were demolished in 1946.

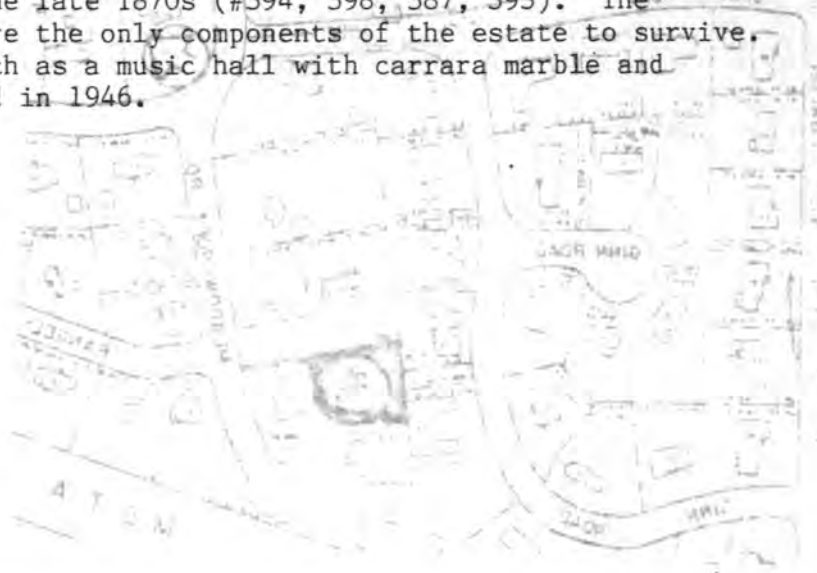

**BIBLIOGRAPHY and/or REFERENCES**

Winchester Archival Center resources: files.  
Chapman, Henry Smith. History of Winchester, Mass. 1936. Vol. II. p. 14.

MAY 22 1989

United States Department of the Interior  
National Park Service

National Register of Historic Places  
Continuation Sheet

Section number \_\_\_\_\_ Page \_\_\_\_\_

Multiple Resource Area  
Thematic Group

Name Winchester MRA  
State Middlesex County, MASSACHUSETTS

Nomination/Type of Review

Date/Signature

- |                               |                                     |  |
|-------------------------------|-------------------------------------|--|
| 21. Gardner, O.W. House       | Entered in the<br>National Register | f Keeper <u>Delores Byers 7/5/89</u><br>Attest _____ |
| 22. Ginn Gardener's House     | Entered in the<br>National Register | ✓ Keeper <u>Delores Byers 7/5/89</u><br>Attest _____ |
| 23. Grover, Henry, House      | Entered in the<br>National Register | ✓ Keeper <u>Delores Byers 7/5/89</u><br>Attest _____ |
| 24. Hovey--Winn House         | Entered in the<br>National Register | f Keeper <u>Delores Byers 7/5/89</u><br>Attest _____ |
| 25. Hutchinson--Blood House   | Entered in the<br>National Register | f Keeper <u>Delores Byers 7/5/89</u><br>Attest _____ |
| 26. Johnson--Thompson House   | Entered in the<br>National Register | ✓ Keeper <u>Delores Byers 7/5/89</u><br>Attest _____ |
| 27. Jones, Marshall W., House | Entered in the<br>National Register | ✓ Keeper <u>Delores Byers 7/5/89</u><br>Attest _____ |
| 28. Locke, Asa, House         | Entered in the<br>National Register | ✓ Keeper <u>Delores Byers 7/5/89</u><br>Attest _____ |
| 29. Mann, James H., House     | Entered in the<br>National Register | ✓ Keeper <u>Delores Byers 7/5/89</u><br>Attest _____ |
| 30. Mason, John, House        | Entered in the<br>National Register | f Keeper <u>Delores Byers 7/5/89</u><br>Attest _____ |

UNITED STATES DEPARTMENT OF THE INTERIOR  
NATIONAL PARK SERVICE

NATIONAL REGISTER OF HISTORIC PLACES  
EVALUATION/RETURN SHEET

REQUESTED ACTION: NOMINATION

PROPERTY Ginn Gardener's House  
NAME:

MULTIPLE Winchester MRA  
NAME:

STATE & COUNTY: MASSACHUSETTS, Middlesex

DATE RECEIVED: 5/22/89 DATE OF PENDING LIST: 6/06/89  
DATE OF 16TH DAY: 6/22/89 DATE OF 45TH DAY: 7/06/89  
DATE OF WEEKLY LIST:

REFERENCE NUMBER: 89000654

NOMINATOR: STATE

REASONS FOR REVIEW:

APPEAL: N DATA PROBLEM: N LANDSCAPE: N LESS THAN 50 YEARS: N  
OTHER: N PDIL: N PERIOD: N PROGRAM UNAPPROVED: N  
REQUEST: N SAMPLE: N SLR DRAFT: N NATIONAL: N

COMMENT WAIVER: N

ACCEPT  RETURN  REJECT 7/5/89 DATE Entered in the  
National Register

ABSTRACT/SUMMARY COMMENTS:

RECOM./CRITERIA \_\_\_\_\_  
REVIEWER \_\_\_\_\_  
DISCIPLINE \_\_\_\_\_  
DATE \_\_\_\_\_

DOCUMENTATION see attached comments Y/N see attached SLR Y/N

---

CLASSIFICATION

count       resource type

---

STATE/FEDERAL AGENCY CERTIFICATION

---

FUNCTION

historic       current

---

DESCRIPTION

architectural classification  
 materials  
 descriptive text

---

SIGNIFICANCE

Period      Areas of Significance--Check and justify below

Specific dates      Builder/Architect  
Statement of Significance (in one paragraph)

summary paragraph  
 completeness  
 clarity  
 applicable criteria  
 justification of areas checked  
 relating significance to the resource  
 context  
 relationship of integrity to significance  
 justification of exception  
 other

---

BIBLIOGRAPHY

---

GEOGRAPHICAL DATA

acreage       verbal boundary description  
 UTM's       boundary justification

---

ACCOMPANYING DOCUMENTATION/PRESENTATION

sketch maps     USGS maps     photographs     presentation

---

OTHER COMMENTS

Questions concerning this nomination may be directed to

\_\_\_\_\_ Phone \_\_\_\_\_

Signed \_\_\_\_\_

Date \_\_\_\_\_



Ginn Gardeners House

22 Ginn Rd

Winchester MA MA

1/38

MHC Inv # 399

Please refer to the map in the  
Multiple Property Cover Sheet  
for this property

Multiple Property Cover Sheet Reference Number: 64000303