

HISTORIC PRESERVATION UNIT
DEPARTMENT OF CULTURE & HISTORY
SCIENCE & CULTURE CENTER
CHARLESTON, WEST VIRGINIA 25305

File No: 12
Theme(s):
Neg No(s):
USGS Quad:
UTM Ref: 17/451580/4346160

DISTRICT . SITE . BUILDING . STRUCTURE . OBJECT

- 1. NAME(S), historic/common: Citizens National Bank
(Downtown Parkersburg, WV)
- 2. LOCATION, street/road: ^{4th} 219 Fourth St. (W corner of 4th & Market Sts.)
TAX MAP- LOT # 92-61 city/town: Parkersburg, WV 26101
(Incorporated/~~unincorporated~~)

3. USE/FUNCTION, present: offices/ vacant (public/private, restricted)
original: bank

4. OWNER/ADDRESS, present: William Jacobs (public/private)
Box 185 Parkersburg, WV 26101
original: Citizens National Bank

- 5. PHOTO/SKETCH OF: 8112-R1-F23,25
8201-R1-F33
8201-R2-F31
- 7. PLAN (include approx. dimensions): *51 x 117*



6. LOCALE/ENVIRONMENT (map):

8. ACREAGE (approx):

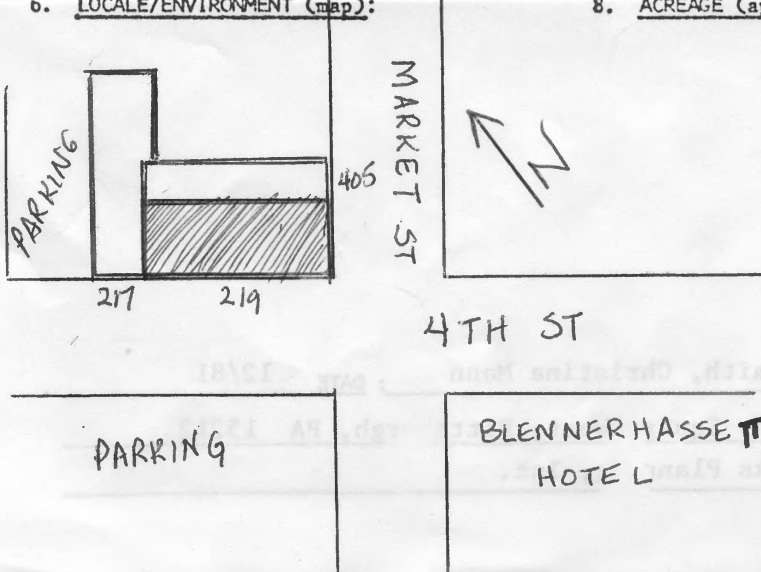

COUNTY: Wood
Survey Region: _____
Planning District: _____

BLENNERHASSET HOTEL

9. DESCRIPTION (clarify as appropriate): See attached

a. Exterior Fabric

stone X
 brick mostly
 concrete _____
 stucco _____
 weatherboard _____
 clapboard _____
 board & batten _____
 shingle _____
 other _____

b. Structural System

masonry X
 frame _____
 log _____
 metal _____
 other _____
 foundation stone

c. Roofing Material

wood _____
 metal _____
 slate _____
 tile _____
 asphalt X
 composition _____
 other _____

d. Associated Structures (use/type):

outbuildings _____
 dependencies _____
 other _____

e. Integrity (include dates):

original site/relocated
 alterations glass block infill on 1st story (SW);
entirely reworked facade on 1st story (SE);
removal of arched pediments above central
arched bays.
 additions _____

f. Condition:

excellent _____
 good X
 fair _____
 deteriorated _____
 abandoned _____

g. Threats:

Unsympathetic alterations.

10. SIGNIFICANCE (use additional sheet if necessary):

a. Architect/Builder/Engineer:

unknown

This grand Classical building acts as a crucial cornerstone for the eroding downtown streetscape.

b. Style/Period: Classical

c. Date(s): 1898 (datestone)

One of the finest professionally designed buildings of the downtown, the old Citizens National Bank forms a strong visual link along Market Street between the B&O underpass and Court Square. While the architect is presently unknown, the building remains a handsome statement of sensitive detail and proportion. Beaux Arts Classicism is here displayed in a combination of arches, applied pressed metal ornamentation, and in the shadows of now-missing hollow metal broken pediments. *pe*

11. BIBLIOGRAPHY:

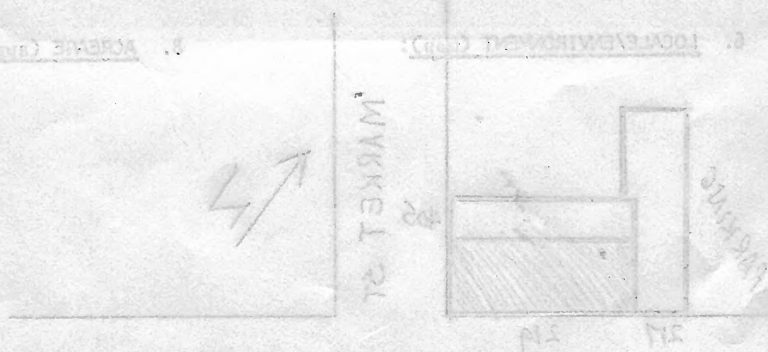

12. FORM PREPARED BY Eliza Smith, Christina Mann ; DATE 12/81

a. Address Allegheny Square West, Pittsburgh, PA 15212

b. Organization Landmarks Planning, Inc.

Citizens National Bank
219 Fourth St. (W corner of 4th & Market Sts.)
92-61

Sited on a commercial lot and flanked by 2 smaller commercial buildings, this 5 story Classical structure measures 3 bays by 1 (9 by 3). It is crowned by a metal rooftop balustrade and a modillion cornice. The 5th story windows, d/s, rest on a sill course/cornice and are separated by recessed panels. The 2nd through 4th stories read as a single colossal system, each bay containing a round arch flanked by two flat arches; the windows are d/s and the spandrels are recessed panels; swags drape above the 4th story windows. On the 1st story, brick pilasters with stone capitals support an entablature; the SW entranceway, the most intact 1st story feature, is arched with flanking engaged columns, banded stonework, and a large foliated cartouche. The corners and bays are defined by quoins; in addition, the central arch on each facade is banded.



Windsor National Bank
219 Fourth St. (W. corner of 4th & Market Sts.)
92-61

Sited on a commercial lot and flanked by 2 smaller commercial buildings.
This 5 story classical structure measures 7 bays by 3 1/2. It is
crowned with a metal roofed balustrade and a modillion cornice. The 5th
story windows, 4 1/2, rest on a sill course/corice and are separated by
recessed panels. The 4th through 4th stories rest on a single classical
capital, each bay containing a round arch flanked by two flat arches; the
windows are 4x6 and the panels are recessed panels; wide drapes above
the 4th story windows. On the 3rd story, brick pilasters with stone
capitals support an entablature; the 2nd story, the most intact for
story feature, is stiched with flanking engaged columns, banded at crown,
and a large foliated cartouche. The cornices and bays are defined by



8113- R1-F23