

HISTORIC PROPERTIES INVENTORY FORM

(Staff Use Only)

HISTORIC PRESERVATION UNIT  
DEPARTMENT of CULTURE & HISTORY  
SCIENCE & CULTURE CENTER  
CHARLESTON, WEST VIRGINIA 25305

File No: 10  
Theme(s):  
Neg No(s):  
USGS Quad: Charleston West, W. Va.  
URN Ref: 17/443620/4244210

DISTRICT, SITE, BUILDING, STRUCTURE, OBJECT

1. NAME(S), historic/common: Cox, Emma/Parks, Seigle House

2. LOCATION, street/road: 710 Myrtle Road

city/town: Charleston  
(~~incorporated~~) unincorporated)

3. USE/FUNCTION, present: residence

(public/private, restricted)

original: residence

4. OWNER/ADDRESS, present: Seigle W. Parks  
(address above)

(public/private)

original: Emma Cox

5. PHOTO/SKETCH OF:

7. PLAN (include approx. dimensions):

6. LOCALE/ENVIRONMENT (map):

8. ACREAGE (approx):

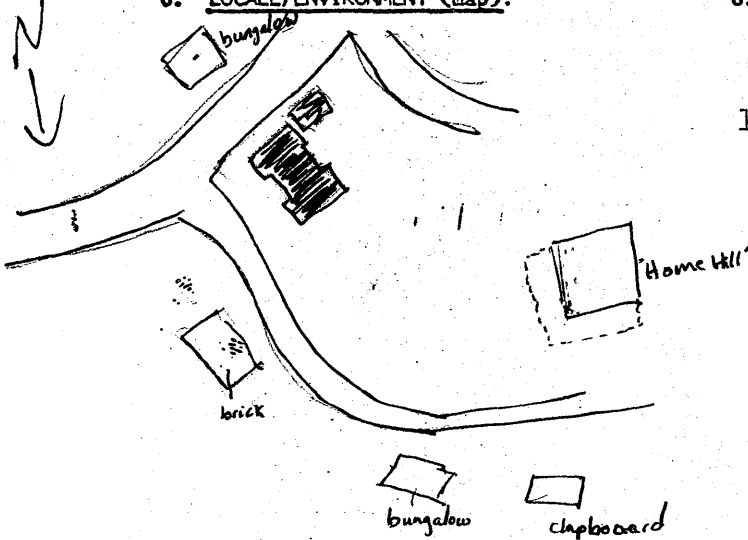

less than one acre  
(1/2 ACRE)

COUNTRY: Kanawha  
Survey Region: \_\_\_\_\_  
Planning District: \_\_\_\_\_

9. DESCRIPTION (clarify as appropriate):

a. Exterior Fabric

stone \_\_\_\_\_  
 brick \_\_\_\_\_  
 concrete \_\_\_\_\_  
 stucco X \_\_\_\_\_  
 weatherboard \_\_\_\_\_  
 clapboard \_\_\_\_\_  
 board & batten \_\_\_\_\_  
 shingle \_\_\_\_\_  
 other \_\_\_\_\_

b. Structural System

masonry X \_\_\_\_\_  
 frame \_\_\_\_\_  
 log \_\_\_\_\_  
 metal \_\_\_\_\_  
 other \_\_\_\_\_  
 foundation \_\_\_\_\_

c. Roofing Material

wood \_\_\_\_\_  
 metal \_\_\_\_\_  
 slate X \_\_\_\_\_  
 tile \_\_\_\_\_  
 asphalt \_\_\_\_\_  
 composition \_\_\_\_\_  
 other \_\_\_\_\_

d. Associated Structures (use/type):

outbuildings garage/carriage \_\_\_\_\_  
 \_\_\_\_\_ house \_\_\_\_\_  
 dependencies \_\_\_\_\_  
 \_\_\_\_\_  
 other \_\_\_\_\_  
 \_\_\_\_\_  
 \_\_\_\_\_

e. Integrity (include dates):

original site/relocated \_\_\_\_\_  
 alterations NONE \_\_\_\_\_  
 \_\_\_\_\_  
 additions NONE \_\_\_\_\_  
 \_\_\_\_\_  
 \_\_\_\_\_

f. Condition:

excellent X \_\_\_\_\_  
 good \_\_\_\_\_  
 fair \_\_\_\_\_  
 deteriorated \_\_\_\_\_  
 abandoned \_\_\_\_\_

g. Threats: NONE

10. SIGNIFICANCE (use additional sheet if necessary):

a. Architect/Builder/Engineer:

UNKNOWN

b. Style/Period: Bungalowoid

c. Date(s): c.1925

This home is significant not only for its fine design and structure but as a component of the old Cox/Morton estate on Holley Road.

Essentially an elaborated bungalowoid cottage with reference to the Prairie School, the house's clean white stucco and green tile make an interesting contrast and give it a more graceful appearance than the Cox's old "Home Hill". A double entrance and flanking double windows are housed by a recessed porch. The eyebrow ventor dormer breaks the expanse of the central low pitched hipped roof. The cornice extends beyond the wall and roof.

SEE CONTINUATION SHEET

11. BIBLIOGRAPHY:

Interview with Bill and Sarah Drennen, June 30, 1983.

Laidley, William S. History of Charleston and Kanawha County.  
 Chicago: Richmond-Arnold Publishing Co., 1911.

12. FORM PREPARED BY Alice Carter ; DATE Sept. 30, 1983

a. Address 4011 Kanawha Ave. Charleston, WV 25304

b. Organization \_\_\_\_\_

ATTACHMENT TO HISTORIC PROPERTIES INVENTORY FORM

HISTORIC PRESERVATION UNIT  
DEPARTMENT OF CULTURE & HISTORY  
THE CULTURAL CENTER  
CHARLESTON, WEST VIRGINIA 25305

1. Name(s) Historic/Common: Cox-Parks House  
(South Hills Multiple Resource Area)  
Kanawha County  
West Virginia

#7. The garage, an outbuilding of considerable architectural charm, is a contributing structure in the Cox-Parks House nomination. It, like the main house, is rectilinear and stuccoed in lightly textured, white-painted plaster. The roofing material matches the coloration (green) and profile (pantile) of the residence. The garage is located a few feet to the southwest of the house.

#8. The Cox-Parks House is of considerable importance in the South Hills Multiple Resource Area because it is unique with regard to architectural style in the entire survey area. Prairie School influences are clearly discernable in the low, horizontal profile of the house with characteristically deep eaves. The juxtaposition of rectilinear blocks, as in the relationship of the front-facing pavilions with their hipped roofs and the hip-roofed main block, (an anachronistic use of bracketing is a vernacular detail of some interest) is another strong Prairie School reference. The residence's excellent state of preservation (bracketing, balustrades, eye-brow dormers, crawl space lattice screens, etc., survive in original condition) and its generously terraced site between two city streets, lends the edifice particular distinction.

The Cox-Parks House was one of several historic Charleston residences chosen by West Virginia artist Diana Suttentfield-Abshire as watercolor subjects for her "Through the Eye of the Artist: Diana Suttentfield-Abshire Surveys Sunrise and Charleston", a show that ran from January 7 through February 26, 1984, at the Sunrise Museum, Charleston.

Cox/Parks House  
710 Myrtle Road

CONTINUATION SHEET

Emma Cox, the wife of Frank Cox, leader of several coal companies in the Kanawha Valley, had this home built for herself in the 1920's when she gave the old "Home Hill" to her daughter's family.

13. Verbal Boundary Description

The Cox/Parks House is situated on the corner lot, approximately 150' by 150', at the eastern junction of Holley Road and Myrtle Road.