

KENTUCKY HISTORIC RESOURCES INVENTORY

Site No. Bn-G-19

1. Historic Name(s) Original Owner		22. ADD/County BRADD/Barren	
2. Present Name Barren County Board of Education		23. U.S.G.S. Quadrant (15'/75') Glasgow South	
3. Location 202 West Washington Street		24. UTM Reference Zone Easting Northing	
4. Owner's Name Eugene Johnson /Chairman		25. Coordinate Accuracy	
5. Owner's Address 202 West Washington St.		26. Prehistoric Site Object Historic Site Structure Building Other	
6. Open to Public Yes <input checked="" type="checkbox"/> No <input type="checkbox"/>	7. Visible from road Yes <input checked="" type="checkbox"/> No <input type="checkbox"/>	8. Ownership Private <input type="checkbox"/> Local <input type="checkbox"/> State <input type="checkbox"/> Federal <input checked="" type="checkbox"/>	
9. Local Contact/Organization		27. National Register District Name:	
10. Site Plan with North Arrow		11. Architect	
		12. Builder	
		13. Date 1918 A. <input type="checkbox"/> B. <input type="checkbox"/>	
		14. Style A. Colonial Revival <input type="checkbox"/> B. <input type="checkbox"/>	
		15. Original Use Post Office <input type="checkbox"/>	
16. Present use		28. Significance Evaluation National Register	
17. Condition Excellent <input type="checkbox"/>		29. Status National Landmark <input type="checkbox"/> Date _____ National Register <input type="checkbox"/> Landmark Certificate <input type="checkbox"/> Kentucky Survey <input type="checkbox"/> Local Landmark <input type="checkbox"/> HABS/HAER <input type="checkbox"/>	
18. Description The building has a cornice with balustrade-above and window openings set in recessed round arched bays. The main entrance is pedimented with lentils and flanked by pilasters		30. Historic Theme Primary <input type="checkbox"/> Secondary <input type="checkbox"/> Other <input type="checkbox"/>	
		31. Endangered Yes <input type="checkbox"/> No <input type="checkbox"/>	
		32. Preservation Project Status Actual Cost in \$1,000s	
		33. ATTACH PHOTO Roll No. <u>41</u> Picture No. <u>photos 4 & 5</u> Direction _____	
		34. Prepared by: Jayne C. Henderson	
19. History Constructed in 1918 as the United States Post Office. The Building now houses the Barren County Board of Education.		35. Organization SCKHS	
20. Significance This is one of few intact, and architecturally significant commercial structures in Glasgow. It also is important as the best example of the Colonial Revival style in the city.		36. Date Fall, 1981	
21. Source		37. Revision Dates 38. Staff Review	

(Continue on Back)

Pyramidal

KENTUCKY HISTORIC RESOURCE INVENTORY SUPPLEMENT
BOUNDARY AND LOCATION INFORMATION

Historic Property Name Barren County Post Office Site # BN-G-19
Multiple Resource/Thematic Nomination Title Barren County Multiple Resource

U.T.M. Coordinates - List multiple UTM's if property is ten or more acres.

A. 16 596 660 4094 720 D. _____
B. _____ E. _____
C. _____ F. _____

Verbal Boundary Description _____ Acreage less than one acre
See Map 2 - block 15 - lot 6 - see USGS map 4

The nominated area is the foundation of the building which measures 125 feet by 150 feet. Nominated area in red.

Sketch of Site Plan (Showing outbuildings, structures, landscape features and the site boundary as described above.)

Site location map only - Not to scale

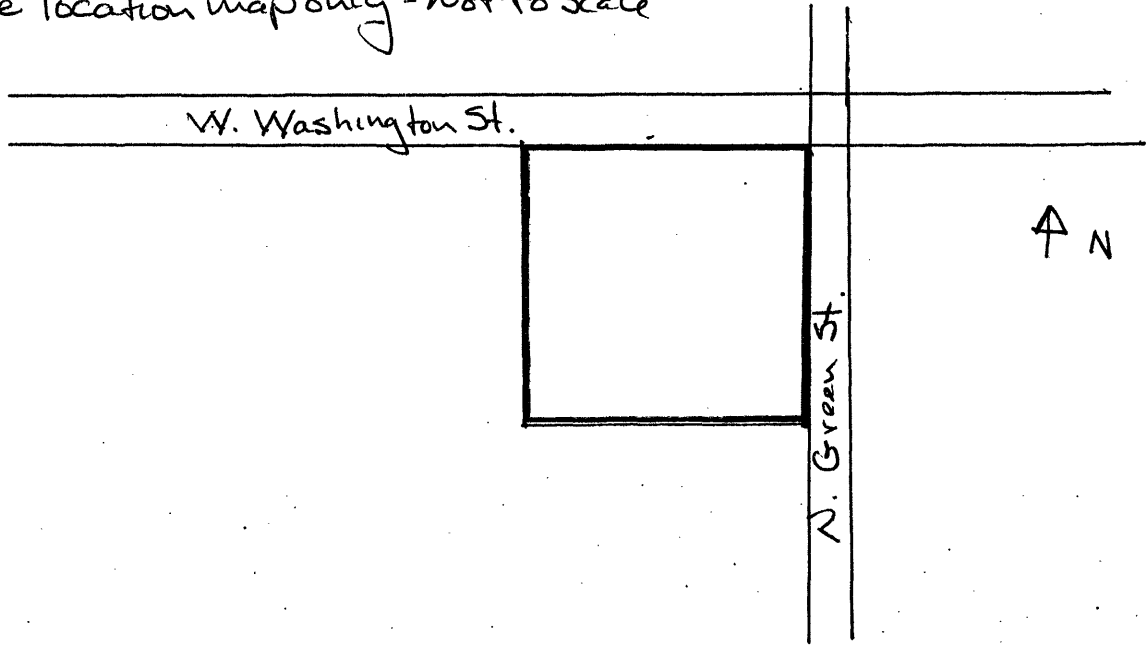

Official Courthouse Property Reference:

KENTUCKY HISTORIC RESOURCES INVENTORY

Site No. Bn-G-19

1. Historic Name(s) Original Owner		22. ADD/County BRADD/Barren	
2. Present Name Barren County Board of Education		23. U.S.G.S. Quadrant (15'/75') Glasgow South	
3. Location 202 West Washington Street		24. UTM Reference Zone Easting Northing	
4. Owner's Name Eugene Johnson /Chairman		25. Coordinate Accuracy	
5. Owner's Address 202 West Washington St.		26. Prehistoric Site Object Historic Site Structure Building Other	
6. Open to Public Yes <input checked="" type="checkbox"/> No <input type="checkbox"/>	7. Visible from road Yes <input checked="" type="checkbox"/> No <input type="checkbox"/>	8. Ownership Private <input type="checkbox"/> Local <input type="checkbox"/> State <input type="checkbox"/> Federal <input checked="" type="checkbox"/>	
9. Local Contact/Organization		27. National Register District Name:	
10. Site Plan with North Arrow		11. Architect	
		12. Builder	
		13. Date 1918 A. <input type="checkbox"/> B. <input type="checkbox"/>	
		14. Style A. Colonial Revival <input type="checkbox"/> B. <input type="checkbox"/>	
		15. Original Use Post Office <input type="checkbox"/>	
16. Present use		28. Significance Evaluation National Register	
17. Condition Excellent <input type="checkbox"/>		29. Status National Landmark <input type="checkbox"/> National Register <input type="checkbox"/> Landmark Certificate <input type="checkbox"/> Kentucky Survey <input type="checkbox"/> Local Landmark <input type="checkbox"/> HABS/HAER <input type="checkbox"/>	
18. Description The building has a cornice with balustrade-above and window openings set in recessed round arched bays. The main entrance is pedimented with lentils and flanked by pilasters		30. Historic Theme Primary <input type="checkbox"/> Secondary <input type="checkbox"/> Other <input type="checkbox"/>	
		31. Endangered Yes <input type="checkbox"/> No <input type="checkbox"/>	
		32. Preservation Project Status Actual Cost in \$1,000s	
		33. ATTACH PHOTO Roll No. <u>41</u> Picture No. <u>photos 4 & 5</u> Direction _____	
		34. Prepared by: Jayne C. Henderson	
19. History Constructed in 1918 as the United States Post Office. The Building now houses the Barren County Board of Education.		35. Organization SCKHS	
20. Significance This is one of few intact, and architecturally significant commercial structures in Glasgow. It also is important as the best example of the Colonial Revival style in the city.		36. Date Fall, 1981	
21. Source		37. Revision Dates 38. Staff Review	

(Continue on Back)

Pyramidal

KENTUCKY HISTORIC RESOURCE INVENTORY SUPPLEMENT
BOUNDARY AND LOCATION INFORMATION

Historic Property Name Barren County Post Office Site # BN-G-19
Multiple Resource/Thematic Nomination Title Barren County Multiple Resource

U.T.M. Coordinates - List multiple UTM's if property is ten or more acres.

A. 16 596 660 4094 720 D. _____
B. _____ E. _____
C. _____ F. _____

Verbal Boundary Description _____ Acreage less than one acre
See Map 2 - block 15 - lot 6 - see USGS map 4

The nominated area is the foundation of the building which measures 125 feet by 150 feet. Nominated area in red.

Sketch of Site Plan (Showing outbuildings, structures, landscape features and the site boundary as described above.)

Site location map only - Not to scale

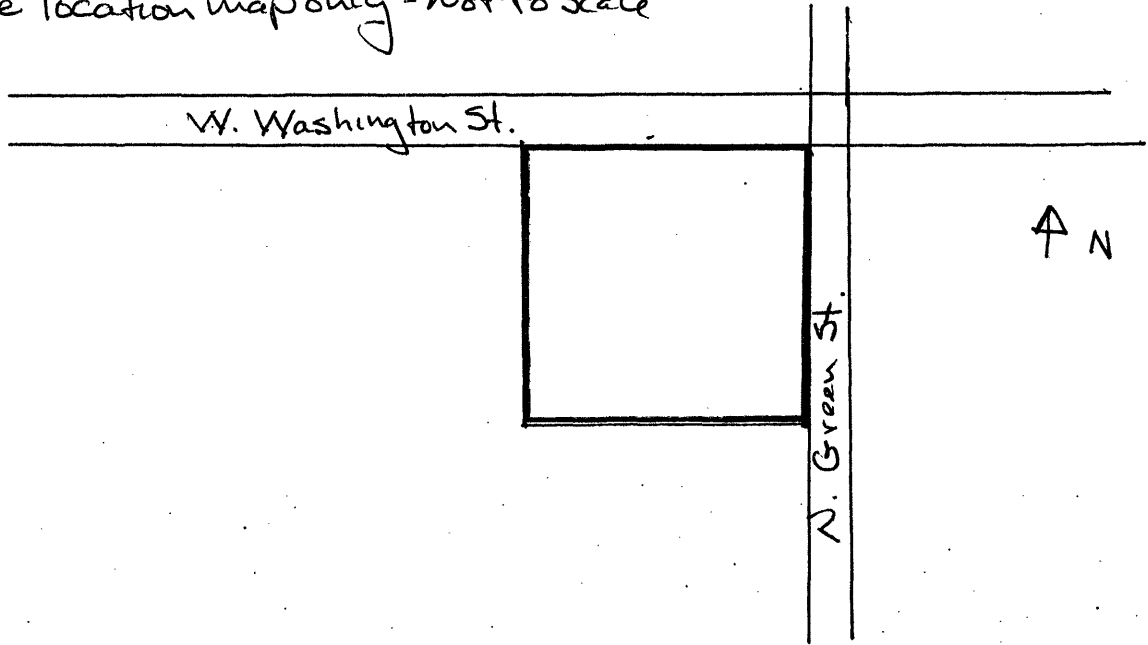

Official Courthouse Property Reference: