

KENTUCKY HISTORIC RESOURCES INVENTORY

Js-157

1. Historic Name (s) Pleasant Grove Original Owner Whitfield Hayden Present Name		22. ADD/County Bluegrass/Jessamine [][] 23. Zoning Classification Magisterial District 24. U.S.G. S. Quadrant (15'/75') Keene 25. UTM Reference 1.6 708460 4203420 Zone Easting Northing	
3. Owner's Name J. R. Wilson, Jr.		26. Prehistoric Site Historic Site Building Object Structure	
4. Owner's Address Keene, 40339		27. District Name: Yes No	
5. Location W. side Keene-Troy Road; 1 1/4 mile north of Keene		28. Significance Evaluation National Register	
6. Open to Public Yes No		29. Status National Landmark National Register Landmark Certificate Kentucky Survey x 11/18/71 Local Landmark HABS/HAER	
7. Visible from road Yes No		30. Theme Primary <u>architecture</u> [][] Secondary Other	
8. Ownership Private X Local State Federal		31. Endangered Yes No	
9. Local Contact/Organization		32. * photo on 1971 survey form ATTACH PHOTO	
10. Site Plan with North Arrow		Roll No. <u>29</u> Picture No. _____ Direction _____	
11. Architect		33. Tape No. _____ Negative No. _____	
12. Builder Ephraim J. and Andrew Young		34. Prepared by: NCP - KTG	
13. Date 1846*		35. Organization KHC	
14. Style Greek Revival [][]		36. Date <u>summer 1977</u>	
15. Original Use house		37. Revision Dates 38. Staff Review	
16. Present Use house			
17. Condition [][] Interior good Exterior good			
18. Description Boundary contains house, smoke house and spring, site of original dwelling. Barns later See Attached Sheet			
19. History 1877 atlas - W. Hayden - Pleasant Grove - 350 acres.			
20. Significance Architecture: one of few remaining structures in Jessamine County known to have been designated by the local architect-builder A. M. Young, Pleasant Grove is well preserved and one of the best examples of local Greek Revival architecture in the county.			
21. Source of Information * 1971 survey form; 1887 History on Kentucky, p. 798 (Willaim H. Perrin); *signed and dated plan in possession of owner.			

KENTUCKY HISTORIC RESOURCE INVENTORY SUPPLEMENT
BOUNDARY AND LOCATION INFORMATION

Historic Property Name Pleasant Grove Site # JR 157
Multiple Resource/Thematic Nomination Title M R of Julianne Co.

U.T.M. Coordinates - List multiple UTM's if property is ten or more acres.

A. 16 708330 4202890 D. 16 708550 4203650
B. 16 708000 4203000 E. 16 708610 4203560
C. 16 708290 4203690 F. _____

Verbal Boundary Description _____ Acreage 50.59 acres

Beginning at A, NE of the house at the property line and the road, thence SW with road to B, NW with fence to C, NE to D at a fence, E to E and SE to the beginning, containing the house, smoke house and spring (location of original dwelling), being the road frontage portion of the 150 acre farm.

Sketch of Site Plan (Showing outbuildings, structures, landscape features and the site boundary as described above.)

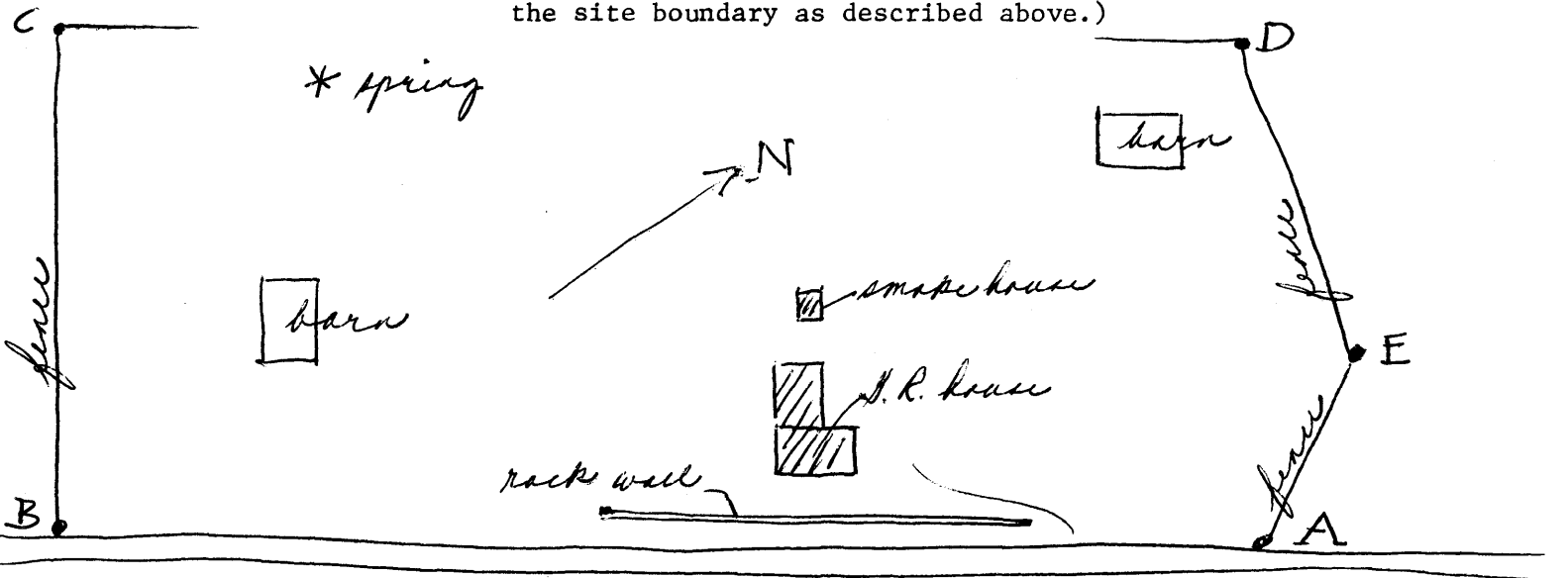

Official Courthouse Property Reference: