

2982

**United States Department of the Interior
National Park Service**

For NPS use only
received NOV 21 1988
date entered

**National Register of Historic Places
Inventory—Nomination Form**

See instructions in *How to Complete National Register Forms*
Type all entries—complete applicable sections

1. Name

historic Walgreen Drug Store

and or common Walgreen's

2. Location

street & number 200 East Flagler Street

not for publication

city, town Miami

vicinity of

state Florida 33132 code FL

county Dade

code FL 025

3. Classification

Category

- district
- building(s)
- structure
- site
- object

Ownership

- public
- private
- both

Public Acquisition

- in process
- being considered

Status

- occupied
- unoccupied
- work in progress

Accessible

- yes: restricted
- yes: unrestricted
- no

Present Use

- agriculture
- commercial
- educational
- entertainment
- government
- industrial
- military

- museum
- park
- private residence
- religious
- scientific
- transportation
- other:

4. Owner of Property

name Antanarivo Corp. N.V., et al c/o J. Bozzuto

street & number 7220 N. W. 36th Street #105

city, town Miami

vicinity of

state Florida 33166

5. Location of Legal Description

courthouse, registry of deeds, etc. Dade County Courthouse

street & number 75 W. Flagler Street

city, town Miami

state Florida 33130

6. Representation in Existing Surveys

title FMSF-Miami Multiple Resource
Historic Preservation Survey

has this property been determined eligible? yes no

date June, 1985

federal state county local

depository for survey records Bureau of Historic Preservation

city, town Tallahassee

state Florida 32399-0250

7. Description

Condition

excellent
 good
 fair

deteriorated
 ruins
 unexposed

Check one

unaltered
 altered

Check one

original site
 moved date _____

Describe the present and original (if known) physical appearance

SEE CONTINUATION SHEET

8. Significance

Period	Areas of Significance—Check and justify below			
<input type="checkbox"/> prehistoric	<input type="checkbox"/> archeology-prehistoric	<input type="checkbox"/> community planning	<input type="checkbox"/> landscape architecture	<input type="checkbox"/> religion
<input type="checkbox"/> 1400–1499	<input type="checkbox"/> archeology-historic	<input type="checkbox"/> conservation	<input type="checkbox"/> law	<input type="checkbox"/> science
<input type="checkbox"/> 1500–1599	<input type="checkbox"/> agriculture	<input type="checkbox"/> economics	<input type="checkbox"/> literature	<input type="checkbox"/> sculpture
<input type="checkbox"/> 1600–1699	<input checked="" type="checkbox"/> architecture	<input type="checkbox"/> education	<input type="checkbox"/> military	<input type="checkbox"/> social/
<input type="checkbox"/> 1700–1799	<input checked="" type="checkbox"/> art	<input type="checkbox"/> engineering	<input type="checkbox"/> music	<input type="checkbox"/> humanitarian
<input type="checkbox"/> 1800–1899	<input checked="" type="checkbox"/> commerce	<input type="checkbox"/> exploration/settlement	<input type="checkbox"/> philosophy	<input type="checkbox"/> theater
<input checked="" type="checkbox"/> 1900–1938	<input type="checkbox"/> communications	<input type="checkbox"/> industry	<input type="checkbox"/> politics/government	<input type="checkbox"/> transportation
		<input type="checkbox"/> invention		<input type="checkbox"/> other (specify)

Specific dates 1936 **Builder/Architect** Zimmerman/Saxe/MacBride; E.A. Ehmann

Statement of Significance (in one paragraph)

SEE CONTINUATION SHEET

9. Major Bibliographical References

Please see Bibliography for Cover Nomination

10. Geographical Data

Acreeage of nominated property less than 1 acre

Quadrangle name Miami

Quadrangle scale 1:24000

UTM References

A

1	7	5	8	1	2	1	0	1	0	2	1	8	5	1	0	8	1	1	0
Zone			Easting						Northing										

B

Zone			Easting						Northing										

C

Zone			Easting						Northing										

D

Zone			Easting						Northing										

E

Zone			Easting						Northing										

F

Zone			Easting						Northing										

G

Zone			Easting						Northing										

H

Zone			Easting						Northing										

Verbal boundary description and justification

Miami, Beginning at the northwest corner of Block 120, thence easterly 152 feet, thence southerly 60 feet, thence westerly 152 feet, thence northerly 60 feet to point of beginning, of the plat of MIAMI NORTH (PB B-41)-follows legal/historic boundary

List all states and counties for properties overlapping state or county boundaries

state N/A code county code

state code county code

11. Form Prepared By

name/title Sarah Eaton / Vicki L. Welcher, Historic Sites Specialist

organization Bureau of Historic Preservation date October, 1988

street & number 500 South Bronough Street telephone (904) 487-2333

city or town Tallahassee state Florida 32399-0250

12. State Historic Preservation Officer Certification

The evaluated significance of this property within the state is:

national state local

As the designated State Historic Preservation Officer for the National Historic Preservation Act of 1966 (Public Law 89-665), I hereby nominate this property for inclusion in the National Register and certify that it has been evaluated according to the criteria and procedures set forth by the National Park Service.

State Historic Preservation Officer signature 

title State Historic Preservation Officer date October 17, 1988

For NPS use only

I hereby certify that this property is included in the National Register

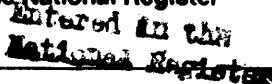

date 1/4/89

Keeper of the National Register

Attest: _____ date _____

Chief of Registration

United States Department of the Interior
National Park Service

National Register of Historic Places
Continuation Sheet

Section number 7 Page 1 The Walgreen Drug Store

DESCRIPTION:

Condition: Good

The Walgreen Drug Store building is a five-story masonry structure executed in the Streamline Moderne style of architecture. The building is a rectangular plan structure commissioned by the Walgreen Company in 1936 and designed by Zimmerman, Saxe and MacBride, Architects, with E. A. Ehmann as Associates Architect.1

Situated at the intersection of East Flagler Street and S. E. 2nd Avenue, the building's mass features a curved corner facing the intersection. The structure of the Walgreen Drug Store is a "fireproof" masonry frame sitting atop a concrete foundation.2 The principal elevations of the building feature horizontal bands of metal awning type windows separated by stone spandrels. The main entrance to the building is situated at the first floor level of the curved corner and is recessed into the wall. Three pairs of glass and metal frame doors provided access to the interior.

The fenestration pattern of the building's elevation features a combination of glass sizes to allow maximum light to the interior and also provide for maximum natural ventilation when desired. The fenestration found within the curved corner of the building features metal casement windows set within multi-pane fixed glass. The bands of horizontal windows are the same for the upper stories, and large fixed panes of glass originally comprised the storefront windows at the sidewalk level. Over the years, some of these windows have been boarded up.

The building's roofline is characterized by a tall parapet wall featuring scored masonry bands, which serves to conceal a flat roof behind. A tall elevator enclosure, clad in masonry, is situated on the northeast corner of the building. Over the years, many alterations have modified the interior of the store where no significant interior spaces remain.

United States Department of the Interior
National Park Service

National Register of Historic Places
Continuation Sheet

Section number 8 Page 1 The Walgreen Drug Store

STATEMENT OF SIGNIFICANCE:

Specific Date: 1936

Architects: Zimmerman, Saxe and MacBride,
Architects

E. A. Ehmann, Associate Architect

The Walgreen Drug Store is architecturally significant because it represents one of the earliest and most representative Streamline Moderne structures in Miami. The building also possesses historical associations with the commercial development of downtown Miami during the period between the World Wars.

The Walgreen Drug Store is architecturally noteworthy because its visual composition makes it one of the most unique commercial buildings in downtown Miami. The use of the ribbon windows and curved corner entrance represents an attempt to adapt an emerging architectural style to the peculiarities of the area's climate and the building's siting. The building's scale, massing, and repetitive fenestration pattern make it one of the finest examples of the Streamline Moderne style in South Florida.

The construction of the Walgreen Drug Store also represents the efforts undertaken by the Chicago-based Walgreen Company to establish a major commercial presence in downtown Miami. The construction of such a large store and the use of such an innovative architectural style served to emphasize that the Walgreen Company had acknowledged "a vote of confidence in the city."³

Upon its completion, the construction of the building represented a \$1.5 million investment for the Walgreen Company.⁴ After its opening, the Walgreen Drug Store was hailed as the "largest in the chain and one of the largest and most complete in the country."⁵ Among the features noted at the time of its opening were "an old-fashioned candy kitchen, restaurant space for several hundred people at the mezzanine and balcony levels, and an all-electric, 88-foot soda fountain with glass-enclosed fruit displays and separate ice cream plant."⁶

**United States Department of the Interior
National Park Service**

**National Register of Historic Places
Continuation Sheet**

Section number 8 Page 2 The Walgreen Drug Store

Since its completion, the building has been continuously used by the Walgreen Company, although its food operations were shut down in 1983.

NOTES

1. City of Miami, Building and Zoning Department, Building Permit applied for 7 October 1936; and Florida Architecture and Allied Arts, 1938, p. 7.
2. "Walgreens: 45 Years of Memories," Miami Herald, 25 January 1983, p. 1-C.
3. See note 2 above.
4. See note 2 above.
5. City of Miami, Building and Zoning Department, Building Permit applied for 7 October 1936.
6. See note 2 above.

WALGREEN DRUG STORE

200 EAST FLAGLER STREET

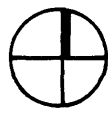
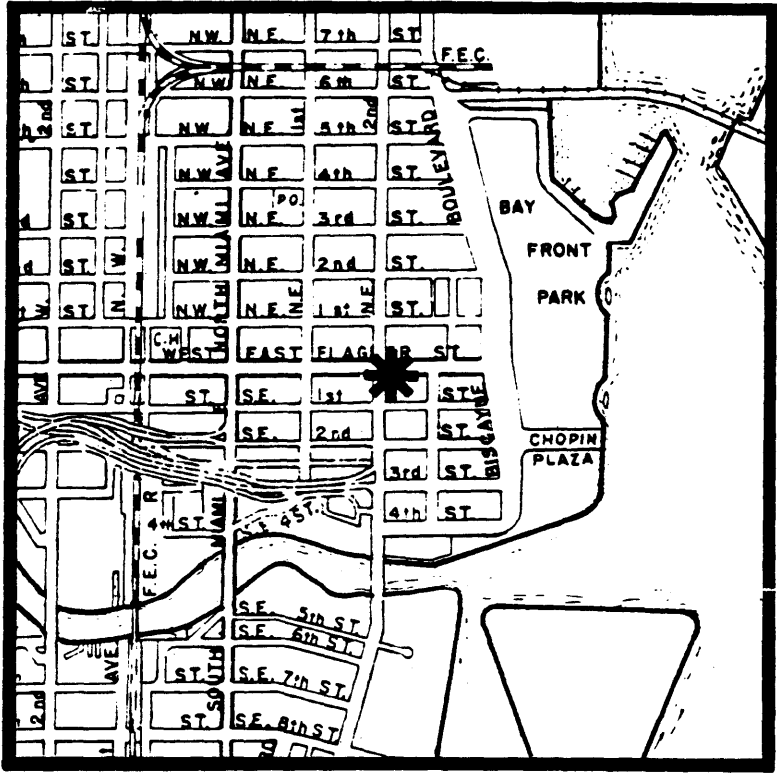

location

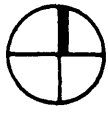
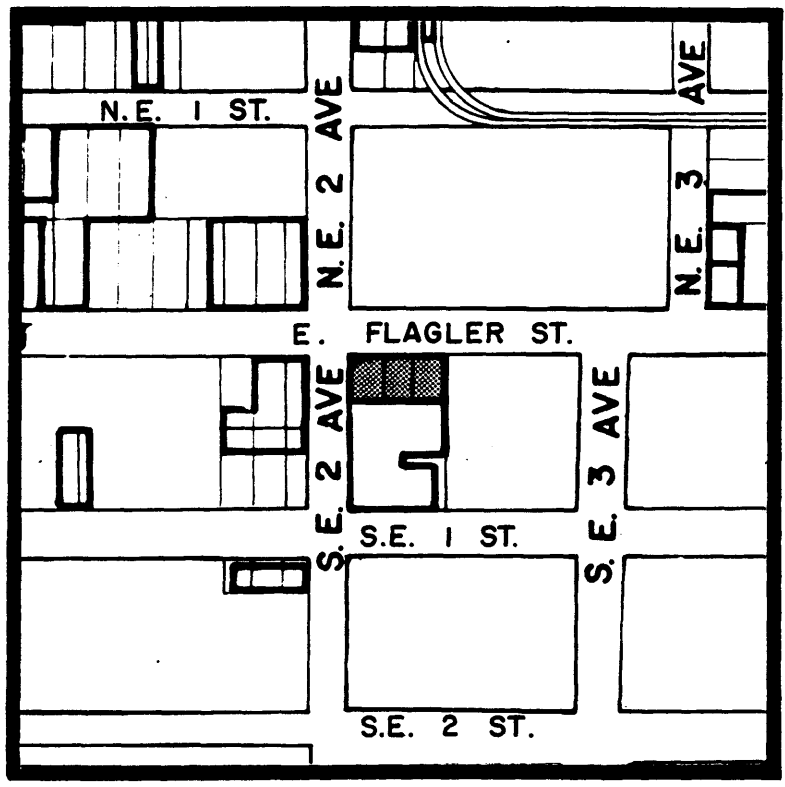

site plan