

FR 0150011

DATA SHEET

Form 10-300 (Rev. 6-72)

UNITED STATES DEPARTMENT OF THE INTERIOR NATIONAL PARK SERVICE

NATIONAL REGISTER OF HISTORIC PLACES INVENTORY - NOMINATION FORM

(Type all entries - complete applicable sections)

STATE: Colorado
COUNTY: Pitkin
FOR NPS USE ONLY
ENTRY DATE: MAY 30 1975

1. NAME

COMMON: ASPEN HISTORICAL SOCIETY MUSEUM
AND/OR HISTORIC: STALLARD HOUSE WHEELER HOUSE

2. LOCATION

STREET AND NUMBER: 620 W. Bleeker St.
CITY OR TOWN: ASPEN
CONGRESSIONAL DISTRICT: 4th
STATE: COLORADO
CODE: 08
COUNTY: PITKIN
CODE: 051

3. CLASSIFICATION

CATEGORY: Building
OWNERSHIP: Private
STATUS: Occupied
ACCESSIBLE TO THE PUBLIC: Yes
PRESENT USE: Educational, Museum

4. OWNER OF PROPERTY

OWNER'S NAME: ASPEN HISTORICAL SOCIETY, a non-profit corporation.
STREET AND NUMBER: 620 W. Bleeker St. P.O. Box 1323
CITY OR TOWN: Aspen, Colorado
STATE: Colorado
CODE: 08

5. LOCATION OF LEGAL DESCRIPTION

COURTHOUSE, REGISTRY OF DEEDS, ETC.: Clerk and Recorder, Pitkin County
STREET AND NUMBER: 506 E. Main St.
CITY OR TOWN: Aspen
STATE: Colo.
CODE: 08

6. REPRESENTATION IN EXISTING SURVEYS

TITLE OF SURVEY: CITY AND TOWNSITE OF ASPEN, COLORADO
DATE OF SURVEY: 1880
DEPOSITORY FOR SURVEY RECORDS: CITY ENGINEER'S OFFICE
STREET AND NUMBER: 130 S. Galena St.
CITY OR TOWN: Aspen
STATE: Colorado
CODE: 08

SEE INSTRUCTIONS

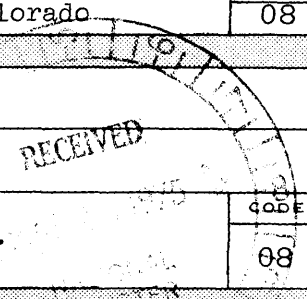

STATE: Colorado
COUNTY: Pitkin
FOR NPS USE ONLY
ENTRY NUMBER: MAY 30 1975
DATE:

7. DESCRIPTION

CONDITION	(Check One)					
	<input type="checkbox"/> Excellent	<input checked="" type="checkbox"/> Good	<input type="checkbox"/> Fair	<input type="checkbox"/> Deteriorated	<input type="checkbox"/> Ruins	<input type="checkbox"/> Unexposed
	(Check One)			(Check One)		
	<input type="checkbox"/> Altered	<input checked="" type="checkbox"/> Unaltered	<input type="checkbox"/> Moved	<input checked="" type="checkbox"/> Original Site		

DESCRIBE THE PRESENT AND ORIGINAL (if known) PHYSICAL APPEARANCE

This structure's significance as a historic building is due to its Victorian character. It is the most richly articulated Victorian home remaining in the Original Aspen Townsite.

The building is freestanding, is irregular in plan, and has two and one-half stories and a basement. The exterior material is common bond brick with wood trim. The roof form is bell-cast with variations on hip and gable. The overall outside dimensions of the house are 40 feet by 55 feet. The attached garage on the back is 23 feet by 26 feet.

The front facade sports a varied non-symmetrical but very dynamic and visually pleasing combination of building forms, including a hip roof over the front porch, a front elevation of a hipped gable and various depth changes.

The three chimney stacks are of the joined variety with articulated brickwork stepping up to form a capitol effect.

The eaves are unarticulated with the exception of occasional decorative brackets. Windows are with arched headers and wooden sills. A front sunroom extends out from the building facade and is crowned by a stepped flair detail in the brick work, creating a 4" to 5" eave over the three windows below.

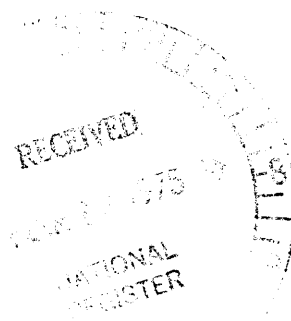

SEE INSTRUCTIONS

9. SIGNIFICANCE

PERIOD (Check One or More as Appropriate)

- | | | | |
|--|---------------------------------------|--|---------------------------------------|
| <input type="checkbox"/> Pre-Columbian | <input type="checkbox"/> 16th Century | <input type="checkbox"/> 18th Century | <input type="checkbox"/> 20th Century |
| <input type="checkbox"/> 15th Century | <input type="checkbox"/> 17th Century | <input checked="" type="checkbox"/> 19th Century | |

SPECIFIC DATE(S) (If Applicable and Known)

AREAS OF SIGNIFICANCE (Check One or More as Appropriate)

- | | | | |
|--|---|---|--|
| <input type="checkbox"/> Aboriginal | <input type="checkbox"/> Education | <input type="checkbox"/> Political | <input type="checkbox"/> Urban Planning |
| <input type="checkbox"/> Prehistoric | <input type="checkbox"/> Engineering | <input type="checkbox"/> Religion/Philosophy | <input type="checkbox"/> Other (Specify) _____ |
| <input type="checkbox"/> Historic | <input type="checkbox"/> Industry | <input type="checkbox"/> Science | _____ |
| <input type="checkbox"/> Agriculture | <input type="checkbox"/> Invention | <input type="checkbox"/> Sculpture | _____ |
| <input checked="" type="checkbox"/> Architecture | <input type="checkbox"/> Landscape Architecture | <input checked="" type="checkbox"/> Social/Humanitarian | _____ |
| <input type="checkbox"/> Art | <input type="checkbox"/> Literature | <input type="checkbox"/> Theater | _____ |
| <input type="checkbox"/> Commerce | <input type="checkbox"/> Military | <input type="checkbox"/> Transportation | _____ |
| <input type="checkbox"/> Communications | <input type="checkbox"/> Music | | |
| <input type="checkbox"/> Conservation | | | |

STATEMENT OF SIGNIFICANCE

On April 2, 1885 the Aspen Town and Land Company sold all of Block 23, Aspen Townsite, to James Downing for \$3600. The Aspen Smelting Company owned by the New York investor, Jerome B. Wheeler, bought Block 23 on October 15, 1885, and on May 20, 1886 it became Wheeler's personal property through a quit claim deed. Lots N and O of Block 23 became the site of a three-story, brick and frame Victorian house built by Wheeler and first placed on the tax rolls in 1888. Wheeler's business affairs manager, H. R. Woodward, lived in the house, and on August 24, 1892 it was sold to C. Valentine for \$20,000. The property was subsequently sold on June 30, 1896 to C. Bell for only \$5,000. Then in February of 1917, Fred Light purchased the house for taxes and sold it in the same year to Mary Stallard. Mrs. Stallard owned the property until 1945 during which time it became known as the Stallard House. It was brought by W. C. Tagert and sold again in 1945 to Walter Paepcke. The property was conveyed by him to the Aspen Company and during this period Lots H and I were sold. The alley in Block 23 was never opened or used as a public right of way. Later the property was re-conveyed to Paepcke and became part of his trust at his death. In 1967 it was leased by the Aspen Historical Society. Since 1969 the Stallard House has been the property of the Aspen Historical Society and is used as a museum housing many significant items and displays relating to the early mining and skiing days of Aspen.

The outstanding significance of the Stallard House is that it is one of only three remaining brick Victorian three-story residences in Aspen. The structure itself has been altered very little except for the addition of a garage and an open porch encircling the north-east corner. It stands as a fine and rare example of the economic and cultural progress made in the Aspen area in the 1880's.

The Stallard House was built by a wealthy man who constructed a beautiful residence befitting his own economic status and his confidence in the cultural potential of the area. It is a classic example of Victorian architecture enhanced by the significant amount of open space surrounding it. This impressive site consists of all but two lots of an entire block and the house itself is situated magnificently in the center

continued on page 2

SEE INSTRUCTIONS

9. MAJOR BIBLIOGRAPHICAL REFERENCES

The Aspen Times, 1881 to date

10. GEOGRAPHICAL DATA

LATITUDE AND LONGITUDE COORDINATES DEFINING A RECTANGLE LOCATING THE PROPERTY				O R	LATITUDE AND LONGITUDE COORDINATES DEFINING THE CENTER POINT OF A PROPERTY OF LESS THAN TEN ACRES				
CORNER	LATITUDE		LONGITUDE		LATITUDE		LONGITUDE		
	Degrees	Minutes	Seconds	Degrees	Minutes	Seconds	Degrees	Minutes	Seconds
NW	°	'	"	°	'	"	39°	11'	38"
NE	°	'	"	°	'	"	106°	49'	42"
SE	°	'	"	°	'	"			
SW	°	'	"	°	'	"			

APPROXIMATE ACREAGE OF NOMINATED PROPERTY: **1 acre**

LIST ALL STATES AND COUNTIES FOR PROPERTIES OVERLAPPING STATE OR COUNTY BOUNDARIES

STATE:	CODE	COUNTY	CODE
COLORADO	08	PITKIN	051
STATE:	CODE	COUNTY:	CODE
STATE:	CODE	COUNTY:	CODE
STATE:	CODE	COUNTY:	CODE

11. FORM PREPARED BY

NAME AND TITLE: **RAMONA MARKALUNAS, President**

ORGANIZATION: **ASPEN HISTORICAL SOCIETY** DATE: **8-26-74**

STREET AND NUMBER: **620 W. Bleeker St. P.O. Box 1323**

CITY OR TOWN: **ASPEN** STATE: **COLORADO 81611** CODE: **08**

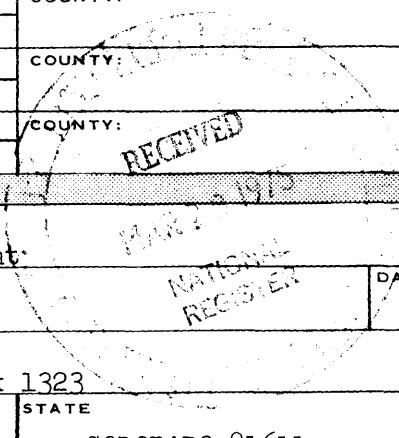

12. STATE LIAISON OFFICER CERTIFICATION

NATIONAL REGISTER VERIFICATION

As the designated State Liaison Officer for the National Historic Preservation Act of 1966 (Public Law 89-665), I hereby nominate this property for inclusion in the National Register and certify that it has been evaluated according to the criteria and procedures set forth by the National Park Service. The recommended level of significance of this nomination is:

National State Local

Name: Cynthia Emack

Title: Asst. State Historical Preservation Officer

Date: February 28, 1975

I hereby certify that this property is included in the National Register.

A. K. Morkensen
Director, Office of Archeology and Historic Preservation

Date: 5/30/75

ATTEST:
Charles A. Herring
Keeper of The National Register

Date: 5.30.75

UTM
13134208
4339660
HL

SEE INSTRUCTIONS

Colorado

Pitkin

surrounded by beautiful trees and lawn. Among its interesting details are three large chimneys with superimposed brick corbeled piers and unusual decorative fascia boards facing south. The house, with its detailed craftsmanship, withstood the aging effects of time extremely well.

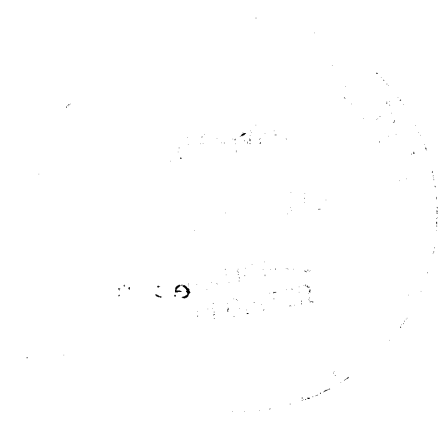

United States Department of the Interior
National Park Service

National Register of Historic Places Continuation Sheet

Section number _____ Page _____

Name change request from Stallard-Wheeler House to
Wheeler-Stallard House

Pitkin County, COLORADO

APPROVED

for Keeper Druce Noble 1/11/89

United States Department of the Interior
National Park Service

National Register of Historic Places
Continuation Sheet

DEC 09 1988

NATIONAL
REGISTER

Section number _____ Page _____

Name correction: .

The correct name for the Stallard House-Wheeler House, listed in 1975, is the Wheeler-Stallard House.

The property is located at 620 West Bleeker Street, Aspen, Pitkin County, Colorado.

Barbara Sudler

State Historic Preservation Officer

11-28-88

Date

W HALLAM ST

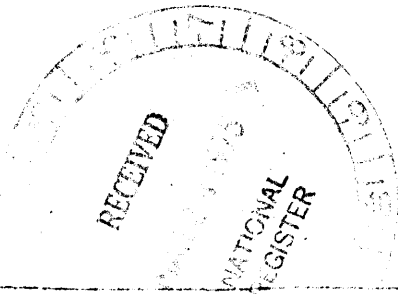

25 49 11

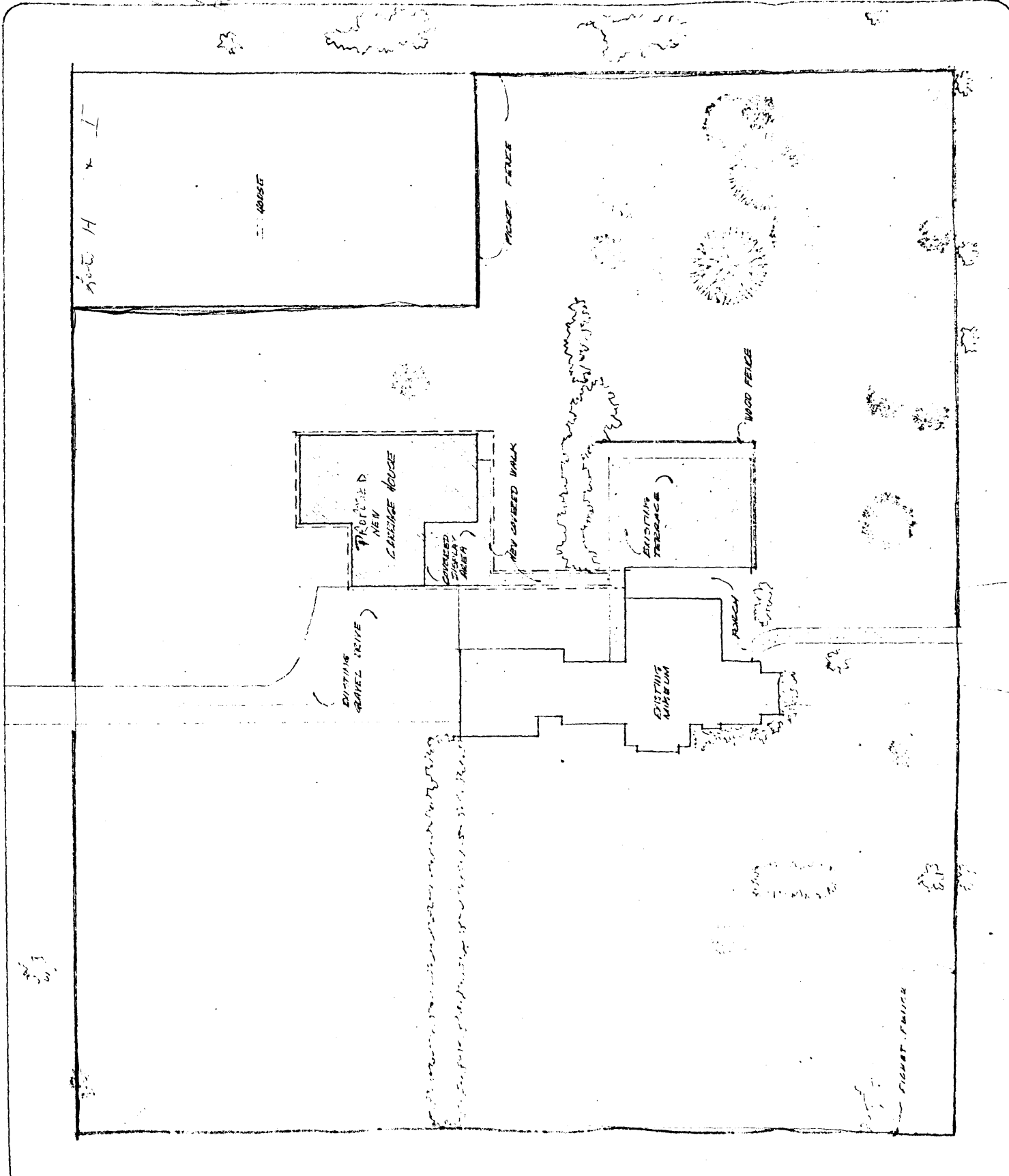
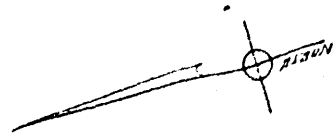

20' 0" x 11'

EXISTING HOUSE

METAL FENCE

PROPOSED NEW CARRIAGE HOUSE

COVERED DRIVEWAY AREA

NEW COVERED WALK

EXISTING TERRACE

WOOD FENCE

EXISTING GRAVEL DRIVE

EXISTING MUSEUM

PERGOLA

RIGHT SWICK