

UNITED STATES DEPARTMENT OF THE INTERIOR
NATIONAL PARK SERVICE

FOR NPS USE ONLY

RECEIVED AUG 9 1977
DATE ENTERED JAN 30 1978

**NATIONAL REGISTER OF HISTORIC PLACES
INVENTORY -- NOMINATION FORM**

SEE INSTRUCTIONS IN *HOW TO COMPLETE NATIONAL REGISTER FORMS*
TYPE ALL ENTRIES -- COMPLETE APPLICABLE SECTIONS

1 NAME

HISTORIC

Colby Hall

AND/OR COMMON

Same

2 LOCATION

STREET & NUMBER

141 Herrick Road

NOT FOR PUBLICATION

CITY, TOWN

Newton Centre

CONGRESSIONAL DISTRICT
4th

STATE

Massachusetts

VICINITY OF
CODE
025

COUNTY
Middlesex

CODE
017

3 CLASSIFICATION

CATEGORY

- DISTRICT
- BUILDING(S)
- STRUCTURE
- SITE
- OBJECT

OWNERSHIP

- PUBLIC
- PRIVATE
- BOTH
- PUBLIC ACQUISITION**
- IN PROCESS
- BEING CONSIDERED

STATUS

- OCCUPIED
- UNOCCUPIED
- WORK IN PROGRESS
- ACCESSIBLE**
- YES: RESTRICTED
- YES: UNRESTRICTED
- NO

PRESENT USE

- AGRICULTURE
- MUSEUM
- COMMERCIAL
- PARK
- EDUCATIONAL
- PRIVATE RESIDENCE
- ENTERTAINMENT
- RELIGIOUS
- GOVERNMENT
- SCIENTIFIC
- INDUSTRIAL
- TRANSPORTATION
- MILITARY
- OTHER

4 OWNER OF PROPERTY

NAME

Andover Newton Theological School

STREET & NUMBER

210 Herrick Road

CITY, TOWN

Newton Centre

VICINITY OF

STATE

Massachusetts 02159

5 LOCATION OF LEGAL DESCRIPTION

COURTHOUSE,
REGISTRY OF DEEDS, ETC.

Middlesex County Registry of Deeds

STREET & NUMBER

40 Thorndike Street

CITY, TOWN

Cambridge

STATE

Massachusetts 02141

6 REPRESENTATION IN EXISTING SURVEYS

TITLE

Inventory of the Historic Assets of the Commonwealth

DATE

1977

FEDERAL STATE COUNTY LOCAL

DEPOSITORY FOR
SURVEY RECORDS

Massachusetts Historical Commission

CITY, TOWN

Boston

STATE

Massachusetts 02108

7 DESCRIPTION

CONDITION

EXCELLENT DETERIORATED
 GOOD RUINS
 FAIR UNEXPOSED

CHECK ONE

UNALTERED
 ALTERED

CHECK ONE

ORIGINAL SITE
 MOVED DATE _____

DESCRIBE THE PRESENT AND ORIGINAL (IF KNOWN) PHYSICAL APPEARANCE

1 1/2 sheet 1/12/78

Colby Hall is located on Herrick Road in Newton near the commercial/civic village of Newton Centre. The building and attached Chapel comprise approximately ~~1 1/3~~ ^{1 1/2} acres of nominated property surrounded by approximately 40 acres of open land. This hilltop land is on the campus of the Andover-Newton Theological School. There is a long sloping lawn in front of the building, and landscaping around the building. A driveway encircles the Hall and the Chapel.

Colby Hall was constructed in 1886 for the Newton Theological Institution, now Andover Newton Theological School, the oldest Protestant graduate theological school in the nation. The designer of this unique structure is unknown. The chapel is believed to have been built in 1866 and was dedicated in 1897. In the intervening years it may have been used for storage, work room, meeting room, or the library before its conversion to a formal place of worship.

Colby Hall is an unusual mixture of the Second Empire and Romanesque Revival styles; its shallow plan and Mansard roof with pedimented dormers are characteristic of the second empire style but architectural detailing is derived from the Romanesque style. The three story structure is of a light buff, rough cut stone with sandstone trim. The Mansard roof is covered with scalloped and rectangular shaped slate tiles, and has four stone end chimneys. Triangularly pedimented single and double window dormers occupy much of the roof space. Large modillions support the widely overhanging eaves. The corners of the building are quoined. A sandstone watertable encircles the building. A sandstone stringcourse links the sills of the first story windows. Another belt course defines the second story floor level. Fenestration is round and semi-elliptical arched and of contrasting scales. All windows, except dormers, are framed by sandstone block architraves.

The five bay wide facade faces north. It is dominated by an imposing 4 1/2 story tower at the eastern end. The tower is in five stages, each stage defined by a sandstone band. The first three stages reflect the floor levels of the main body of the building. The first stage has triple arched 4/4 windows. The second has double arched windows. The third stage has a stepped chamber stop that forms a hexagon. The facade and the east and west sides of this stage each have an oculus framed by a Greek cross shaped architrave. The fourth stage has a paired louvered openings framed by columns and set within a circular arched window. A bracketed table gives rise to the conical slate roof above. This is crowned by a cross. The western end of the facade is a two bay wide projecting section with two symmetrically placed 8 light arched windows on the first and second stories. There are two dormers directly above. The recessed entrance section is at the center of the facade. Three stone steps lead to the double wooden doors headed by a semi-circular fan. This is headed by paired arched windows separated by an engaged column at its center. A double window dormer with triangular pediment occupies the roof space overhead.

To the west of the tower on the east elevation is the main body of the building. It is two bays deep with two 4/4 arched windows on the first and second stories, and two dormers above. The west elevation is four bays deep with 4/4 round arched fenestration. The partially exposed basement has four three light windows.

The south (rear) elevation has six dormers. The chapel is connected at the building's south elevation. It is a two story, gable and enclosed porch connected to the main building by a one bay deep, one story section. The east gable end has a small gabled

UNITED STATES DEPARTMENT OF THE INTERIOR
NATIONAL PARK SERVICE

**NATIONAL REGISTER OF HISTORIC PLACES
INVENTORY -- NOMINATION FORM**

FOR NPS USE ONLY

RECEIVED AUG 9 1977

DATE ENTERED JAN 30 1978

CONTINUATION SHEET

ITEM NUMBER 7 PAGE 1

one story enclosed entrance porch containing an arched wooden door. Above this is a triple round arched stained glass window. In the gable peak are two small narrow, leaded glass casements. The west gable end has a full two story three part window. The center portion of the window has four large panes. The lower portion is blind as are the two flanking openings.

The south elevation of the chapel has five sided, one story apse. Each side has a single round arched window with leaded glass casement. There is a three story fire escape on the south elevation of the building.

Colby Hall contains seven large, well lit classrooms, a small robing room on the first floor, four offices on the upper floors, and storage and rest rooms in the basement.

The structure has not been altered, and is in good condition. The chapel is used daily by the seminary. The larger hall is unused since 1960.

8 SIGNIFICANCE

PERIOD	AREAS OF SIGNIFICANCE -- CHECK AND JUSTIFY BELOW			
<input type="checkbox"/> PREHISTORIC	<input type="checkbox"/> ARCHEOLOGY-PREHISTORIC	<input type="checkbox"/> COMMUNITY PLANNING	<input type="checkbox"/> LANDSCAPE ARCHITECTURE	<input checked="" type="checkbox"/> RELIGION
<input type="checkbox"/> 1400-1499	<input type="checkbox"/> ARCHEOLOGY-HISTORIC	<input type="checkbox"/> CONSERVATION	<input type="checkbox"/> LAW	<input type="checkbox"/> SCIENCE
<input type="checkbox"/> 1500-1599	<input type="checkbox"/> AGRICULTURE	<input type="checkbox"/> ECONOMICS	<input type="checkbox"/> LITERATURE	<input type="checkbox"/> SCULPTURE
<input type="checkbox"/> 1600-1699	<input checked="" type="checkbox"/> ARCHITECTURE	<input checked="" type="checkbox"/> EDUCATION	<input type="checkbox"/> MILITARY	<input checked="" type="checkbox"/> SOCIAL/HUMANITARIAN
<input type="checkbox"/> 1700-1799	<input type="checkbox"/> ART	<input type="checkbox"/> ENGINEERING	<input type="checkbox"/> MUSIC	<input type="checkbox"/> THEATER
<input checked="" type="checkbox"/> 1800-1899	<input type="checkbox"/> COMMERCE	<input type="checkbox"/> EXPLORATION/SETTLEMENT	<input type="checkbox"/> PHILOSOPHY	<input type="checkbox"/> TRANSPORTATION
<input type="checkbox"/> 1900-	<input type="checkbox"/> COMMUNICATIONS	<input type="checkbox"/> INDUSTRY	<input type="checkbox"/> POLITICS/GOVERNMENT	<input type="checkbox"/> OTHER (SPECIFY)
		<input type="checkbox"/> INVENTION		

SPECIFIC DATES 1866

BUILDER/ARCHITECT

STATEMENT OF SIGNIFICANCE

Colby Hall is architecturally unique, and historically significant to both the community & to the Baptist denomination nation wide. Andover-Newton is the result of the union of Andover Theological Seminary, founded in Andover, Mass. in 1807, and the Newton Theological Institution established in Newton Centre at the Colby Hall site in 1825. The school is the oldest Protestant graduate theological school in America. It is dedicated to the education of men and women for the parish ministry for the Baptist Church, the United Church of Christ, and all Christians the world over. The vast majority of living graduates of this institution received their seminary education in Colby Hall.

The building pre-dates many structures in Newton Centre. Because of its hillside location, overlooking Newton Centre, there is a visual impact for the city residents as well as for the students, faculty, trustees and friends who come to the school regularly.

Samuel Francis Smith wrote the words to "America" in 1832 while attending the seminary. Following his graduation and ordination, Dr. Smith served the First Baptist Church in Newton Centre for many years. A plaque marking the location of his home in the Centre was placed on that site some years ago by the Newton Centre Women's Club. The club meets regularly at Colby Hall for its business and social events.

Students, faculty, trustees and friends of the school are concerned about the restoration and maintance of the property for future use as well as for the architectural beauty and historical value represented.

NO
LEBOVICH
1/13/78

Colby Hall
 Newton Centre, Massachusetts
 Scale: 1"=160'
 Taken From City Engineers Map, June 1965

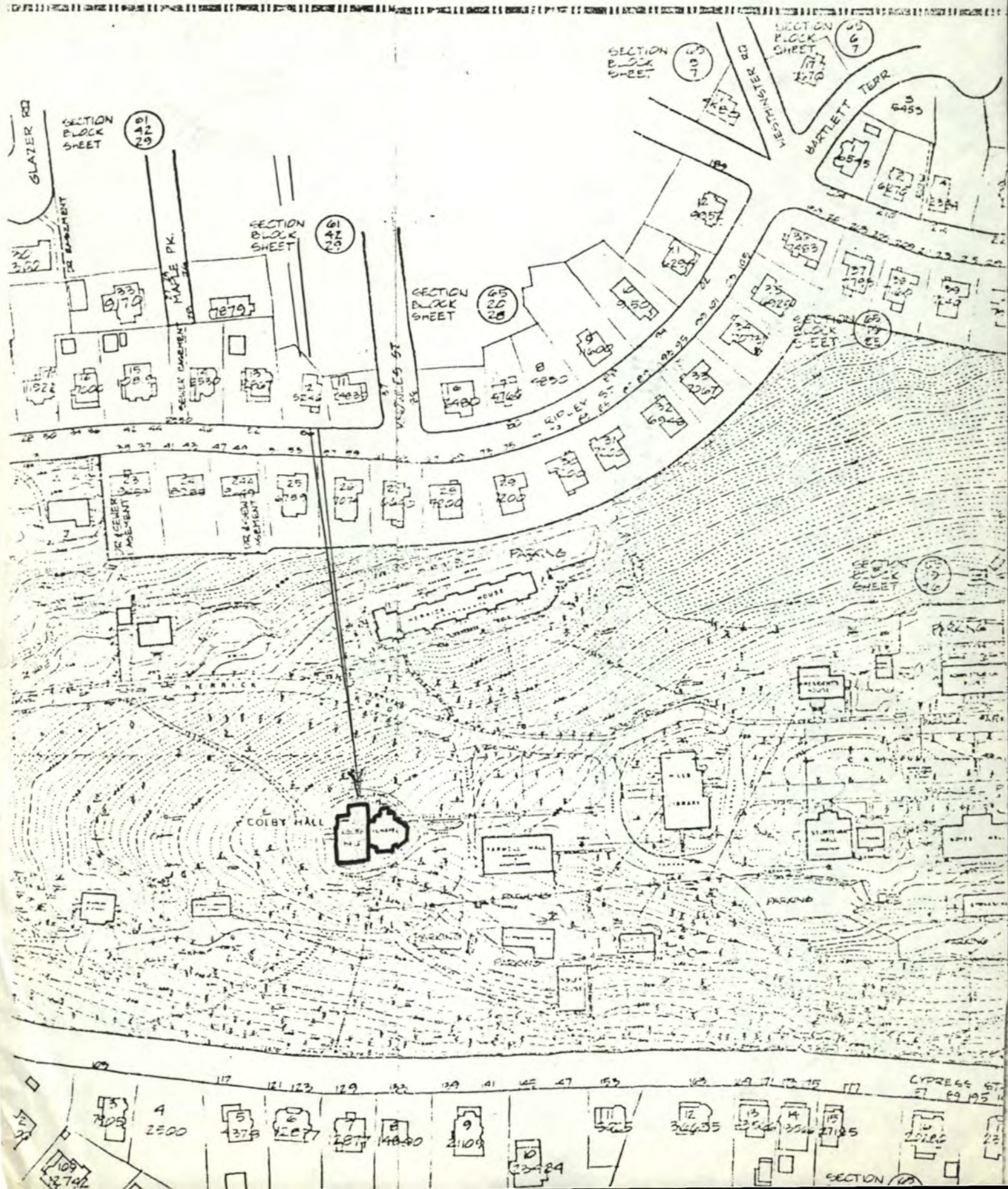

4

RECEIVED
AUG 9 1977
NATIONAL REGISTER

JAN 30 1978

RECEIVED
NATIONAL REGISTER

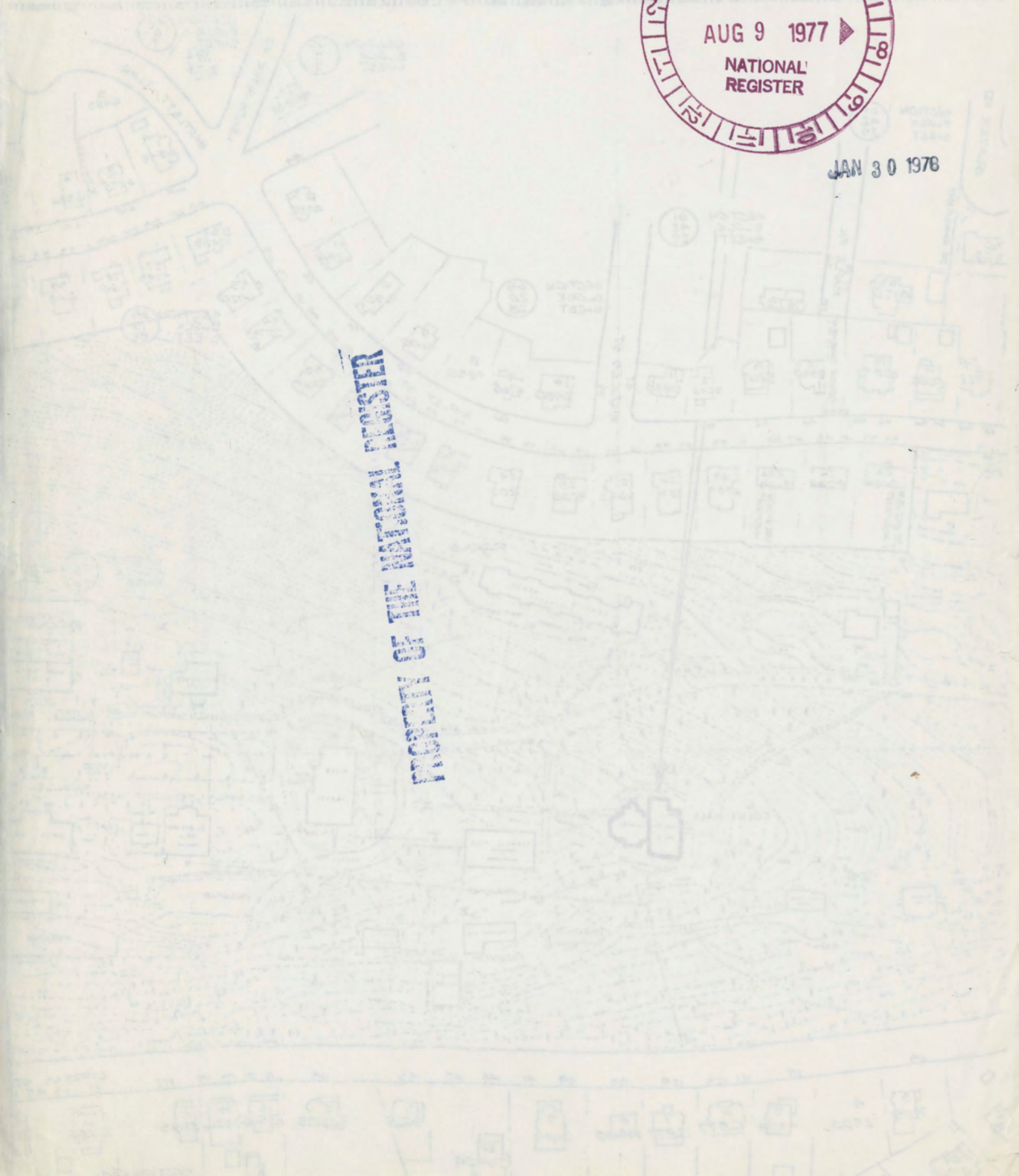

Property Colby Hall

State Mass.

Working Number 8.9.77.1263

Middlesex

TECHNICAL

Photos 5

Maps 1, sketch

CONTROL

OK pl
8.10.77

HISTORIAN 2

I AGREE W/ JANN. THERE IS VERY LITTLE ARCHITECTURAL JUSTIFICATION FOR AREAS OF SIGNIFICANCE CHECKED. ARCHITECTURALLY, IT POSSESSES GREAT VALUE AS BEING A COMPOSITION OF BOTH ROMANESQUE REVIVAL & SECOND EMPIRE STYLES.

ACCEPT
HBrit 12/9/77

1/2 ACRES IS CORRECT ——— CALL TO JOE ORRANT 1/19/78.

Would probably be ineligible unless significance is architectural. Not a persuasive statement on this. Question religion/social significance. I think this property is more of local than state significance. Need VBD. Probably require call.

ARCHITECTURAL HISTORIAN

Jann Gilmore 10.25.77

Accept..

ARCHEOLOGIST

Appears to be eligible for architecture and a very real possibility that it may ~~also~~ be eligible for history - but would need a better statement of significance. - But eligible as is -

OTHER

Accept
W.R. Luce
1/18/78

HAER

Inventory _____

Review _____

REVIEW UNIT CHIEF

I agree with Ray, but I am also from Newton.

Accept
Lebanich
1/19/78

BRANCH CHIEF

Hunt
1-24-78

KEEPER

Wm
1 30 78

National Register Write-up _____

Send-back _____

Entered JAN 30 1978

Federal Register Entry 3.7.78

Re-submit _____

INT:2106-74



Middlesex County

Colby Hall
Newton Centre, Mass.
1964

Photography Incorporated
125 Kingston Street
Boston, MA 02111

#1 *075*
North facade and east elevation

JAN 30 1978

AUG 9 1977

PROPERTY OF THE NATIONAL REGISTER

PHOTOGRAPHY INCORPORATED
125 KINGSTON STREET
BOSTON, MASS. 02111
TEL. 426-8581

*Colby Hall
Newton Centre, Mass.
North facade
1964*

1. facade - outside.

77-333



1977 PHOTO By BOB BALDWIN
Middlesex County

Colby Hall
Newton Centre, Mass.

1977
Bob Baldwin

Andover Newton Theological School
210 Herrick Road, Newton Centre 02159

#2 of 5
North facade

JAN 30 1978

AUG 9 1977

PROPERTY OF THE NATIONAL REGISTER



Middlesex Co.

Colby Hall
Newton Centre, Mass.
1977

Bob Baldwin
Andover Newton Theological School
210 Herrick Road, Newton Centre 02159

#3 of 5

West elevation

AUG 9 1977

JAN 30 1978

PROPERTY OF THE NATIONAL REGISTER

1977

Photo by Bob Baldwin



Middlesex Co.

Colby Hall
Newton Centre, Mass.

1977

Bob Baldwin

Andover Newton Theological School
210 Herrick Road, Newton Centre 02159

#4 of 5

South elevation

AUG 9 1977 JAN 30 1978

PROPERTY OF THE NATIONAL REGISTER

1977

Photos by

Bob Baldwin



Middlesex Co.

Colby Hall
Newton Centre, Mass.
1977

Bob Baldwin
Andover Newton Theological School
210 Herrick Road, Newton Centre 02159

#5 *175*

East elevation

AUG 9 1977

JAN 30 1978

PROPERTY OF THE NATIONAL REGISTER

1977

Photos by Bob Baldwin

Checked in support of National Register of Historic Places Inventory - Nominations from Beverly Map Form
COLBY HALL - ANDOVER MIDDLESEX JUNIOR HIGH SCHOOL
5/23/77

Colby Hall
Newton Centre, Massachusetts
UTM Coordinates:
19/319 380/4688 070



Mapped, edited, and published by the Geological Survey Control by USGS, USC&GS, and Massachusetts Geodetic Survey
Planimetry by photogrammetric methods from aerial photographs taken 1939. Topography by planimetric surveys 1943. Revised from aerial photographs taken 1969. Field checked 1970
Polyconic projection. 1927 North American datum
10,000-foot grid based on Massachusetts coordinate system, mainland zone
1000-meter Universal Transverse Mercator grid ticks, zone 19, shown in blue
Red tint indicates areas in which only landmark buildings are shown

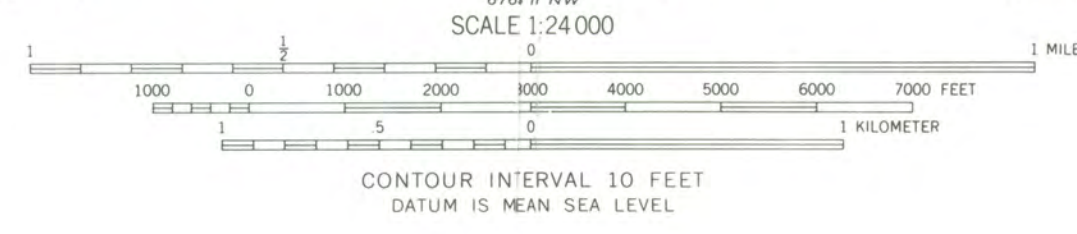
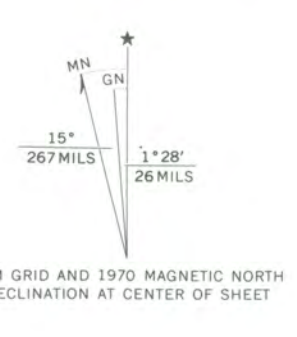

ROAD CLASSIFICATION	
Primary highway, hard surface	Light-duty road, hard or improved surface
Secondary highway, hard surface	Unimproved road
Interstate Route	U. S. Route
	State Route

NEWTON, MASS.
N4215-W7107.5/7.5
1970
AMS 6768 I SW-SERIES V814



THIS MAP COMPLIES WITH NATIONAL MAP ACCURACY STANDARDS
FOR SALE BY U. S. GEOLOGICAL SURVEY, WASHINGTON, D. C. 20242
A FOLDER DESCRIBING TOPOGRAPHIC MAPS AND SYMBOLS IS AVAILABLE ON REQUEST

ENTRIES IN THE NATIONAL REGISTER

STATE MASSACHUSETTS

Date Entered JAN 30 1978

Name

Location

Harvard Square Subway Kiosk

Cambridge
Middlesex County

Colby Hall

Newton
Middlesex County

Also Notified

Hon. Edward W. Brooke

Hon. Edward M. Kennedy

Hon. Thomas P. O'Neill, Jr.

Hon. Robert F. Drinan

Regional Director, North Atlantic Region

880

Mott/js

2/2/78

State Historic Preservation Officer
Mrs. Elizabeth R. Amadon
Executive Director, Massachusetts
Historical Commission
294 Washington Street
Boston, Massachusetts 02108

NATIONAL REGISTER DATA SHEET

① NAME as it appears on federal register: Colby Hall
 ② OTHER NAMES:
 ③ date of entry: JAN 30 1978
 ④ county code: 017

⑤ LOCATION street & number: 141 Herrick Rd.
 city / town: Newton Centre
 vicinity of:
 state: MA
 county: Middlesex
 ⑥ NPS REGION: North Atlantic

⑦ OWNER PRIVATE STATE MUNICIPAL COUNTY MULTIPLE FEDERAL (agency name)
 ⑧ ADMINISTRATOR:

⑨ EXISTING SURVEYS HABS HAER NHL
 ⑩ FUNDED? YES NO
 ⑪ CONGRESS. DISTRICT: 4th
 ⑫ SOURCE OF NOMINATION: STATE FEDERAL
 if state who prepared form?

⑬ WITHIN NATIONAL REGISTER HISTORIC DISTRICT? YES, NAME: NO
 ⑭ WITHIN NATIONAL HISTORIC LANDMARK? YES, NAME: NO
 ⑮ ACREAGE: 1.5
 LOCAL PRIVATE ORGANIZATION

⑯ CONDITION
 excellent deteriorated altered original site
 good ruins unaltered moved
 fair unexposed reconstructed unknown
 unexcavated excavated
 ⑰ features:
 INTERIOR SUBSTANTIALLY INTACT-1 SUBSTANTIALLY INTACT-2 SUBSTANTIALLY INTACT-3
 NOT INTACT-0 NOT INTACT-0 NOT INTACT-0
 UNKNOWN-4 UNKNOWN-5 UNKNOWN-6
 NOT APPLICABLE-7 NOT APPLICABLE-8 NOT APPLICABLE-9
 EXTERIOR NOT APPLICABLE-7 NOT APPLICABLE-8 NOT APPLICABLE-9
 ENVIRONS NOT APPLICABLE-9

⑱ ACCESS YES - Restricted YES - Unrestricted No Access Unknown
 ⑲ ADAPTIVE USE YES NO
 ⑳ SAVED? YES
 ㉑ IS PROPERTY A HISTORIC DISTRICT? yes no

㉒ AREAS OF SIGNIFICANCE:
 ARCHEOLOGY - prehistoric-2 COMMERCE-6 ENGINEERING-11 LANDSCAPE ARCH.-15 POLITICS / GOVT.-21 RECREATION-28
 ARCHEOLOGY - historic-1 COMMUNICATIONS-7 ENTERTAINMENT-26 LAW-16 RELIGION-22 SETTLEMENT-29
 AGRICULTURE-3 CONSERVATION-8 EXPLORATION-12 LITERATURE-17 SCIENCE-23 URBAN PLANNING-31
 ARCHITECTURE-4 ECONOMICS-9 HEALTH-27 MILITARY-18 SOCIAL / HUMANITARIAN-24 OTHER (SPECIFY)
 ART-5 EDUCATION-10 INDUSTRY-13 MUSIC-19 SOCIAL / CULTURAL-30
 INVENTION-14 PHILOSOPHY-20 TRANSPORTATION-25
 ㉓ CLAIMS: explain
 'first'
 'oldest'
 'only'

㉔ functions
 WHEN HISTORICALLY SIGNIFICANT:
 CURRENTLY:
 ㉕ dates of initial construction:
 major alterations:
 historic events:
 ㉖ ETHNIC GROUP ASSOCIATION

㉗ architectural style(s):
 ㉘ architect:
 ㉙ master builder:
 ㉚ engineer:

㉛ landscape architect / garden designer:
 ㉜ interior decorator:
 ㉝ artist:
 ㉞ artisan:
 ㉟ builder/contractor:

㊱ NAMES give role & date
 PERSONAL:
 EVENTS:
 INSTITUTIONAL:

㊲ NATIONAL REGISTER WRITE-UP