

United States Department of the Interior
National Park ServiceNational Register of Historic Places
Registration FormNATIONAL
REGISTER

This form is for use in nominating or requesting determinations of eligibility for individual properties or districts. See instructions in *Guidelines for Completing National Register Forms* (National Register Bulletin 16). Complete each item by marking "x" in the appropriate box or by entering the requested information. If an item does not apply to the property being documented, enter "N/A" for "not applicable." For functions, styles, materials, and areas of significance, enter only the categories and subcategories listed in the instructions. For additional space use continuation sheets (Form 10-900a). Type all entries.

1. Name of Property

historic name Weyanoke

other names/site number _____

2. Location

street & number Sligo Rd., 5 miles north of intersection with LA 66 ☒ N/A not for publicationcity, town Weyanoke ☒ vicinitystate Louisiana code LA county West Feliciana code 125 zip code 70787

3. Classification

Ownership of Property

- ☒ private
☐ public-local
☐ public-State
☐ public-Federal

Category of Property

- ☒ building(s)
☐ district
☐ site
☐ structure
☐ object

Number of Resources within Property

Contributing	Noncontributing
<u>1</u>	<u>0</u> buildings
	<u>0</u> sites
	<u>0</u> structures
	<u>0</u> objects
<u>1</u>	<u>0</u> Total

Name of related multiple property listing:
N/ANumber of contributing resources previously
listed in the National Register 0

4. State/Federal Agency Certification

As the designated authority under the National Historic Preservation Act of 1966, as amended, I hereby certify that this
☒ nomination ☐ request for determination of eligibility meets the documentation standards for registering properties in the
National Register of Historic Places and meets the procedural and professional requirements set forth in 36 CFR Part 60.
In my opinion, the property ☒ meets ☐ does not meet the National Register criteria. ☐ See continuation sheet.

Leslie Tassin Oct 11, 1990Signature of certifying official Leslie Tassin, LA State Historic Preservation
Officer, Dept of Culture, Recreation and Tourism

Date

State or Federal agency and bureau

In my opinion, the property ☐ meets ☐ does not meet the National Register criteria. ☐ See continuation sheet.

Signature of commenting or other official _____

Date _____

State or Federal agency and bureau _____

5. National Park Service Certification

I, hereby, certify that this property is:

- ☒ entered in the National Register.
☐ See continuation sheet.
☐ determined eligible for the National
Register. ☐ See continuation sheet.
☐ determined not eligible for the
National Register.

☐ removed from the National Register.☐ other, (explain:) _____Entered in the
National RegisterArlene Byers11/15/90

Signature of the Keeper

Date of Action

6. Function or Use

Historic Functions (enter categories from instructions)

DOMESTIC/single dwelling

Current Functions (enter categories from instructions)

DOMESTIC/single dwelling

7. Description

Architectural Classification

(enter categories from instructions)

Greek Revival

Federal

Materials (enter categories from instructions)

foundation brick

walls weatherboard

stucco

roof asphalt

other

Describe present and historic physical appearance.

Weyanoke is a two-and-one-half story frame house situated in the rolling, wooded countryside of West Feliciana Parish. Although the home is predominantly an example of the Greek Revival style, it also reflects the influence of the American Federal style. The house began life as a log cabin which was enlarged and remodeled in stages between 1838 and 1856. With only minor exceptions, it appears exactly as it did upon completion. Thus, it is the 1856 house which is being nominated to the National Register.

Weyanoke's exterior features are in the Greek Revival style. The home's symmetrical facade is distinguished by the following: 1) a five bay double gallery whose squared Doric columns support a full but simple entablature, 2) plastered upper and lower story walls with wide baseboards and decorative chair rails (the latter a feature showing Creole influence), and 3) similar upper and lower story entrances consisting of single leaf doors with Greek Revival transoms and sidelights. The first floor entrance is the more elaborate of the two. Its six-light transom and three-light sidelights are flanked by smooth pilasters whose molded capitals support an entablature with a projecting molded cornice. Another exterior feature of importance is the fact that the house stands high off the ground on brick piers. Other features of interest include clapboard siding and tall external chimneys, two located on each end of the house.

The interior is organized around a very wide central hall with two rooms on each side. The two front rooms are deeper than those at the rear, but all rooms share the same width. The plan of the second story is identical to that of the first. The ceilings of the lower floor are approximately twelve feet high; those on the second floor stand at ten feet. The interior is highlighted by plastered walls and woodwork which combines elements of the Federal and Greek Revival styles. This combination is seen most clearly in the mantels. Although those on the first floor are larger than those above, all are similar in decorative detail. They consist of molded Federal pilasters which support wide Greek Revival entablatures. The entablatures, in turn, support mantel shelves which are layered in the Federal style. The entablatures of the second floor mantels are subdivided by molding to create an architrave and frieze, a decorative element which is absent on the floor below. Lower floor door and window surrounds are molded and feature a simple Federal cornerblock motif. In addition, they display molded panels below the windows and sidelights. Other original features in the home include its two panel doors, wide wooden floorboards and, in the rear rooms, twelve over twelve windows.

**United States Department of the Interior
National Park Service**

**National Register of Historic Places
Continuation Sheet**

Weyanoke, Weyanoke vicinity, West Feliciana Parish, LA

Section number 7 Page 1

Changes to the 1856 house have been minimal. In the 1920s a kitchen was attached to the house as a rear ell. Between the 1930s and 1960s, the rear galleries were gradually enclosed for use as bathrooms and living space. These changes are minor and do not detract from Weyanoke's integrity, historic character, or National Register eligibility. The changes at the rear are not visible from the front, and the home's unchanged Greek Revival facade dominates the surrounding landscape just as it did in 1856. In addition, the interior woodwork is unchanged and the floorplan of the core structure is totally intact. Weyanoke is a fine example of a house combining elements of the two architectural influences most prevalent in West Feliciana Parish during the antebellum period. Therefore, it would make a most appropriate addition to the National Register of Historic Places.

8. Statement of Significance

Certifying official has considered the significance of this property in relation to other properties:

☐ nationally ☐ statewide ☒ locally

Applicable National Register Criteria ☐ A ☐ B ☒ C ☐ D

Criteria Considerations (Exceptions) ☐ A ☐ B ☐ C ☐ D ☐ E ☐ F ☐ G N/A

Areas of Significance (enter categories from instructions)

architecture

Period of Significance

c.1856

Significant Dates

c.1856

Cultural Affiliation

N/A

Significant Person

N/A

Architect/Builder

unknown

State significance of property, and justify criteria, criteria considerations, and areas and periods of significance noted above.

Weyanoke is locally significant in the area of architecture because it contributes to the distinctly Greek Revival architectural heritage of East and West Feliciana parishes. Its importance also stems from its successful combination of the Greek Revival with the Federal style in the home's interior woodwork.

Despite their proximity to the French Creole region of Louisiana, the Felicianas were settled primarily by Anglo-Americans from the eastern United States. These settlers brought with them the architectural styles popular in their former homes. During the early period of settlement, this style was the American Federal. Later, it was superceded by the extremely popular Greek Revival style which came to dominate the area. As a result of this settlement pattern and design preference, East and West Feliciana parishes stand as one of three rural areas considered to be major centers of Greek Revival architecture in the state. The collection consists of approximately twenty-six buildings, the majority of which are full two-story homes.

In the opinion of the State Historic Preservation Office, all surviving examples of the Greek Revival style in East and West Feliciana parishes are significant because they contribute to the region's architectural identity as a center of Greek Revival architecture. Except for a handful of the very finest homes such as Rosedown, it would be arbitrary to separate the other roughly comparable residences into gradations of significance. Weyanoke's importance stems from the following:

- 1) It is an until now largely unrecognized element in the cadre of antebellum Greek Revival architecture for which the region is known. Its notable Greek Revival characteristics include a full length five bay double gallery with squared Doric columns and a notable entrance featuring Greek Revival pilasters, entablature, cornice, transom and sidelights.
- 2) Weyanoke is a rare example of West Feliciana houses with transitional detailing combining Federal and Greek Revival elements. For example,

☒ See continuation sheet

9. Major Bibliographical References

Typescript History of Weyanoke in possession of property owner (copy in National Register file).

Historic Structures Survey, West Feliciana Parish.

Site inspection by National Register staff.

Previous documentation on file (NPS): N/A

- ☐ preliminary determination of individual listing (36 CFR 67) has been requested
- ☐ previously listed in the National Register
- ☐ previously determined eligible by the National Register
- ☐ designated a National Historic Landmark
- ☐ recorded by Historic American Buildings Survey # _____
- ☐ recorded by Historic American Engineering Record # _____

☐ See continuation sheet

Primary location of additional data:

- ☒ State historic preservation office
- ☐ Other State agency
- ☐ Federal agency
- ☐ Local government
- ☐ University
- ☐ Other

Specify repository: _____

10. Geographical Data

Acreage of property less than one acre

UTM References

A

1	5
---	---

6	5	1	1	8	0
---	---	---	---	---	---

3	4	2	3	5	2	0
---	---	---	---	---	---	---

Zone Easting Northing

B

--	--

--	--	--	--	--	--

--	--	--	--	--	--

Zone Easting Northing

C

--	--

--	--	--	--	--	--

--	--	--	--	--	--

D

--	--

--	--	--	--	--	--

--	--	--	--	--	--

☐ See continuation sheet

Verbal Boundary Description

Please refer to enclosed sketch map.

☐ See continuation sheet

Boundary Justification

The boundaries were drawn to encompass the significant resource and its immediate setting. They do not follow property lines because to have done so would have meant including extensive agricultural and timber acreage.

☐ See continuation sheet

11. Form Prepared By

name/title National Register staff

organization Division of Historic Preservation date August 1990

street & number P. O. Box 44247 telephone (504) 342-8160

city or town Baton Rouge state Louisiana zip code 70804

Owners: Ms. Nora Towles Marsh & Ms. Sonora Towles Marsh

General Delivery

2914 Esplanade

Weyanoke, LA 70787

New Orleans, LA 70119

**United States Department of the Interior
National Park Service**

**National Register of Historic Places
Continuation Sheet**

Weyanoke, Weyanoke vicinity, West Feliciana Parish, LA

Section number 8 Page 1

the home's mantels are special because they actually combine elements of both styles in single pieces of woodwork. Most transitional homes contain Federal mantels in what are otherwise Greek Revival residences. Although these mantels, panels, and other examples of interior woodwork are more understated than those found in some area homes, they are finely executed and reflect the long lasting popularity of the Federal style in this rural parish.

For these reasons, Weyanoke is a strong candidate for National Register listing.

Historical Note:

John Turnbull Towles, a relative of the family which built Rosedown, acquired the property upon which Weyanoke now stands in 1838. A successful planter with over 80 slaves in 1860, Towles served in the Louisiana legislature and as a major in the Confederate Army. Frances Peyton Eskridge Towles, wife of John, is said to have named the house for a plantation in her native Virginia. The Weyanoke property has remained in the hands of Towles' descendants since its 1838 purchase.

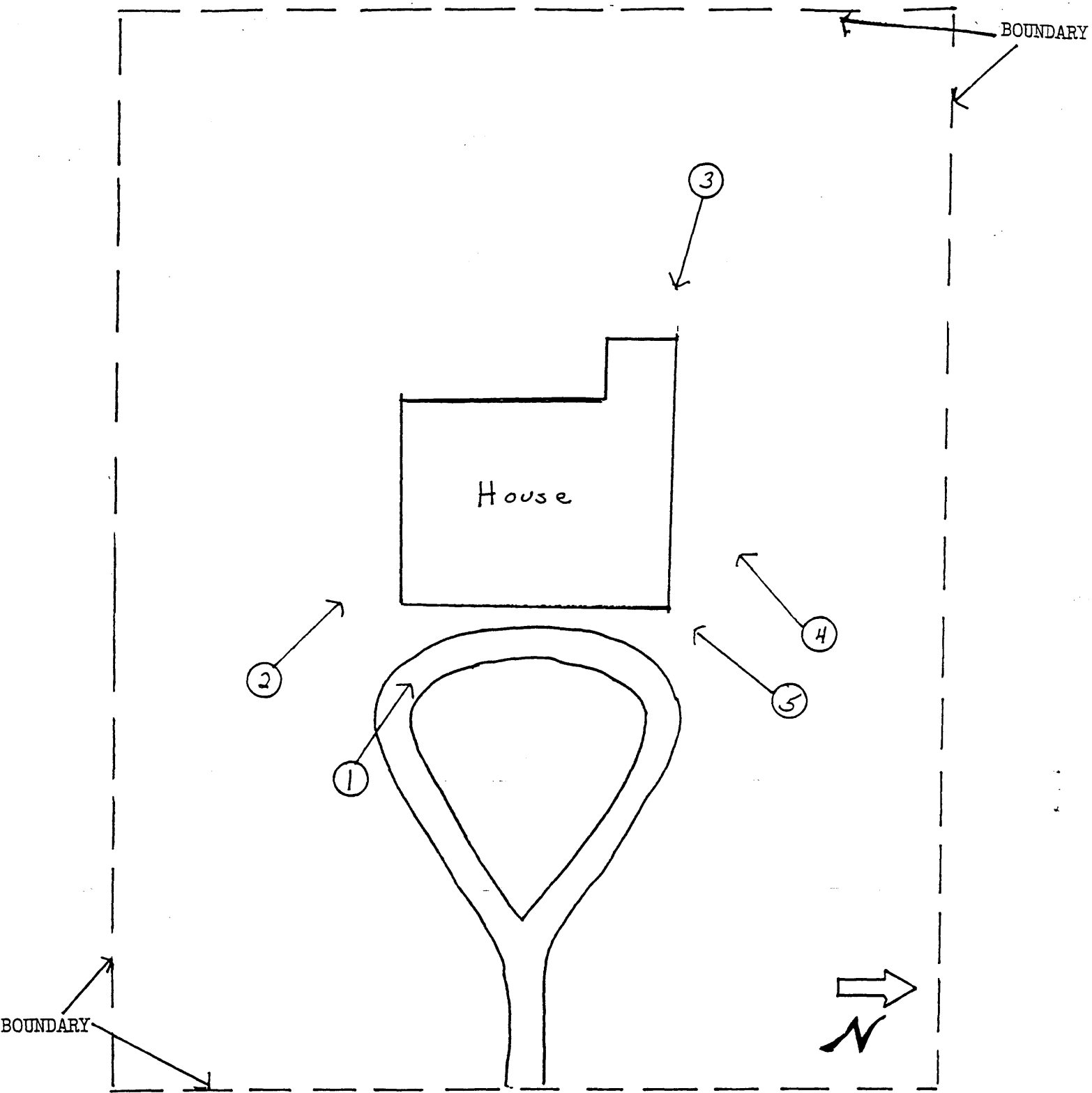

BOUNDARY: — — —

SCALE: 1" = 25'

WEYANOKE
WEYANOKE VICINITY
WEST FELICIANA PARISH, LA