

ARCHITECTURAL SURVEY FORM

Name of Structure: Glascok County Courthouse

Location: Main Street, Gibson, Georgia 30810

Cost: \_\_\_\_\_ Date of Construction: 1918, remodeled 1942 & recently.

Architect/builder: \_\_\_\_\_ Contractor: \_\_\_\_\_

Subsequent architects: \_\_\_\_\_

TAX MAP/PARCEL NUMBERS

Zone 17/E351390/N3678060  
UTM NO. \_\_\_\_\_

DESCRIPTION:

Style: Neoclassically derived

Boundary: The block upon which the courthouse sits as shown on the enclosed map.

Facade Material: Brick, with stone details

Acreage: approx. 2 acres

Condition: [ ] Excellent [X] Good [ ] Fair

The Glascok County Courthouse is a long, narrow, two-story brick-masonry building with a hipped roof and gabled pavilions. The front facade features a projecting central pavilion with a pilastered and broken-pedimented entry, a second-floor Georgian Revival window, and an oculous in the gable. This central bay is flanked by paired sash windows under a flat stone lintel at each floor level. Side elevations are similar, but broader, and have no entries or Georgian Revival windows. An addition across the rear of the building, dating from 1942, is similarly detailed.

The interior was thoroughly renovated in 1973.

*see 7/21/80 addendum + 7/28/80 phone slip for info on addition.*

*visited by state staff - addition is 2 bays wide across the rear of the building.*

ARCHITECTURAL SURVEY FORM



## SIGNIFICANCE:

As a repository for records of marriages, wills, land transactions, the courthouse chronicles the county and is a focal point in the life of every citizen.

The Glascock County Courthouse is one of the plainest early-twentieth-century Neoclassically-derived courthouses in the state. Along with its more elaborate contemporaries, it establishes the range of early-twentieth-century Neoclassical courthouses in Georgia. Its plain appearance, contrasted with others, also reflects the changing fortunes of the various counties in the state.



SEP 18 1980

## MAILING ADDRESS:

Chairman  
Glascock County Commission  
Glascock County Courthouse  
Gibson, Ga. 30810

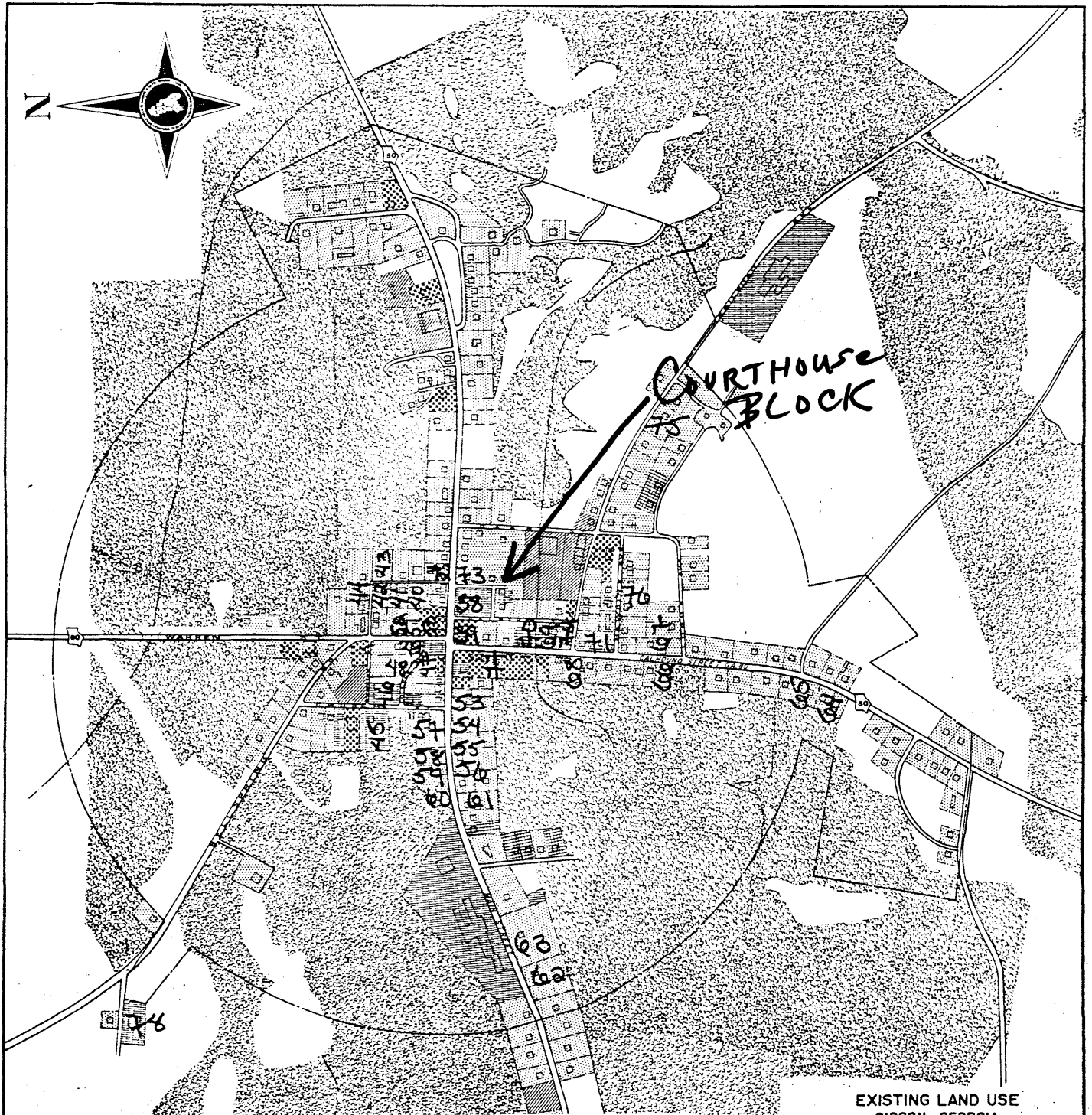

SKETCH MAP

FEB 29 1980

GLASCOCK COUNTY COURTHOUSE

Gibson, Glascock County, Georgia

Scale: map has been reduced, not to scale







Source: Land Use Map

Date : August, 1966

Key: The entire block with the number "38"  
on it in the center of the map

EXISTING LAND USE  
GIBSON, GEORGIA  
AUGUST 1966

LEGEND

-  SINGLE FAMILY RESIDENTIAL
-  TWO OR MORE FAMILY RESIDENTIAL
-  COMMERCIAL
-  INDUSTRIAL
-  PUBLIC AND SEMI-PUBLIC
-  FORESTRY
-  VACANT OR AGRICULTURAL

SCALE IN FEET  
330 660 0 330 660

Glascock  
38-78