

BUILDING-STRUCTURE INVENTORY FORM

DIVISION FOR HISTORIC PRESERVATION
NEW YORK STATE PARKS AND RECREATION
ALBANY, NEW YORK (518) 474-0479

FOR OFFICE USE ONLY

UNIQUE SITE NO. _____
QUAD _____
SERIES _____
NEG. NO. _____

YOUR NAME: Townley McEhliney Sharp DATE: August 7, 1980

YOUR ADDRESS: Box 274, Hurley, N.Y. TELEPHONE: 914-331-8944

ORGANIZATION (if any): Historic Architecture & Decorative Arts Consultants

IDENTIFICATION

- 1. BUILDING NAME(S): Ethol House (P.M.A.A.)
- 2. COUNTY: Dutchess TOWN: CITY VILLAGE: Poughkeepsie
- 3. STREET LOCATION: 171 Hooker Avenue UTM: 18/590180/4615530
- 4. OWNERSHIP: a. public b. private
- 5. PRESENT OWNER: Edith V. O. Mewkill ADDRESS: 171 Hooker Avenue
- 6. USE: Original: residence Present: residence
- 7. ACCESSIBILITY TO PUBLIC: Exterior visible from public road: Yes No
Interior accessible: Explain No

DESCRIPTION

- 8. BUILDING MATERIAL: a. clapboard b. stone c. brick d. board and batten
e. cobblestone f. shingles g. stucco other: _____
- 9. STRUCTURAL SYSTEM: a. wood frame with interlocking joints
(if known) b. wood frame with light members
c. masonry load bearing walls
d. metal (explain) _____
e. other _____
- 10. CONDITION: a. excellent b. good c. fair d. deteriorated
- 11. INTEGRITY: a. original site b. moved if so, when? _____
c. list major alterations and dates (if known): None

12. PHOTO:



13. MAP:

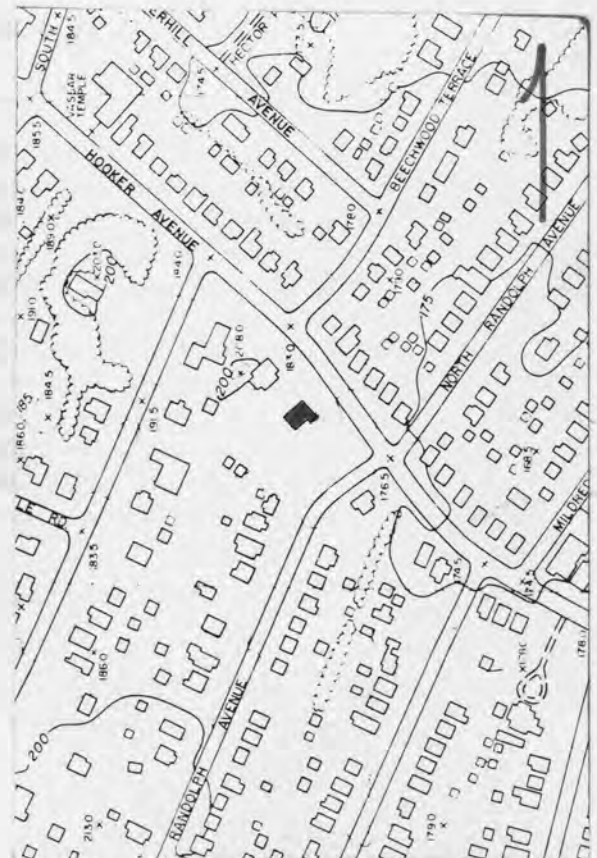

14. THREATS TO BUILDING: a. none known b. zoning c. roads
d. developers e. deterioration
f. other: _____
15. RELATED OUTBUILDINGS AND PROPERTY:
a. barn b. carriage house c. garage
d. privy e. shed f. greenhouse
g. shop h. gardens
i. landscape features: _____
j. other: Yard
16. SURROUNDINGS OF THE BUILDING (check more than one if necessary):
a. open land b. woodland
c. scattered buildings
d. densely built-up e. commercial
f. industrial g. residential
h. other: _____

17. INTERRELATIONSHIP OF BUILDING AND SURROUNDINGS:
(Indicate if building or structure is in an historic district)

Facade faces northeast on Hooker Avenue; residences surround.

18. OTHER NOTABLE FEATURES OF BUILDING AND SITE (including interior features if known):

Facade: 1-1/2 stories with raised basement; 3 bays; main section of the house has stone foundations with shingles above, large 28-light window; to right, glazed porch with recessed front entrance, roof projects slightly more here with 2 large stick-style struts on either side; large dormer above (center, with triple window, 6/1); large stone chimney to left; left section has glazed

(continued)

SIGNIFICANCE

19. DATE OF INITIAL CONSTRUCTION: c. 1910

ARCHITECT: André Reid of Poughkeepsie

BUILDER: _____

20. HISTORICAL AND ARCHITECTURAL IMPORTANCE:

Both this shingled and cobblestone bungalow and the one next to it on Hooker Avenue were designed by André Reid in 1910. They exemplify the most sophisticated Bungalow-style residences in Poughkeepsie, and are greatly enhanced by their park-like setting. This one was built on a more gentle slope of ground than #167, but the surrounding fir trees also give it a rustic feeling. Numerous plantings were made by a local nurseryman, Mr. Valina, in 1916; these, with the weeping cherry tree, give this yard a more formal appearance than #167. Both driveways entwine in the back yard, circling trees and terminating at period garages. The interior is simple, with boxed beams and a field stone fireplace. Although the first owner is not known, an important one, who moved there in 1924, was Harry J. Ethol, President of the Pioneer Button Company.

21. SOURCES:

Mrs. Edith Mewkill (owner); City Directories: 1909 to 1924.

(continued)

22. THEME:

Early-20th-century residential architecture.

HISTORIC RESOURCES OF
THE CITY OF POUGHKEEPSIE

DUTCHESS COUNTY, NEW YORK

Ethel House (#26)

BUILDING # 26 , continued 171 Hooker Avenue

18. OTHER NOTABLE FEATURES OF BUILDING AND SITE, CONTINUED

porch with stone foundations up to window ledge; roof slopes opposite direction from main one; all roofs supported with straight brackets; stone wall in front; west side: 2nd story has 2 windows either side central triple 4-light window, with sloping roof above. The interior is intact with original oak woodwork and a fieldstone fireplace.

20. HISTORICAL AND ARCHITECTURAL IMPORTANCE, CONTINUED

This intact bungalow, with its neighbor, is one of the most significant residences of its period in Poughkeepsie, and provides an interesting contrast to the other bungalows in the area.

United States Department of the Interior
National Park Service

National Register of Historic Places
Inventory—Nomination Form

For NPS use only
received
date entered

Continuation sheet

Item number

Page 4 of 6

Multiple Resource Area
Thematic Group

Name Poughkeepsie Multiple Resource Area
State NY

Nomination/Type of Review

Date/Signature

31. Ethol House

Entered in the
National Register

for
Keeper

Melissa Byers 11/26/82

Attest

32. Poughkeepsie Trust Company

Entered in the
National Register

for
Keeper

Melissa Byers 11/26/82

Attest

33. Luckey, Platt & Company
Department Store

Entered in the
National Register

for
Keeper

Melissa Byers 11/26/82

Attest

34. Church Building

Substantive Review

DOE/OWNER OBJECTION

Keeper

Not eligible
owner/owner 11/26/82

Attest

35. Upper-Mill Street Historic
District

Substantive Review

Keeper

eligible 11/22/82 Patrick Andrews
owner/owner 11/26/82

Attest

36. Balding Avenue Historic
District

Entered in the
National Register

for
Keeper

Melissa Byers 11/26/82

Attest

37. Booth, O. H., Hose Company

Entered in the
National Register

for
Keeper

Melissa Byers 11/26/82

Attest

38. Clinton House

Entered in the
National Register

for
Keeper

Melissa Byers 11/26/82

Attest

39. Glebe House

Entered in the
National Register

for
Keeper

Melissa Byers 11/26/82

Attest

40. St. Paul's Episcopal Church

Substantive Review

Keeper

owner/owner 11/26/82

Attest

accept 11/23/82 Patrick Andrews

HISTORIC RESOURCES OF
THE CITY OF POUGHKEEPSIE

DUTCHESS COUNTY, NEW YORK

Ethol House (#26)

BUILDING # 26 , continued 171 Hooker Avenue



Historic Resources of the City of Poughkeepsie
Dutchess County, New York
Etho1 House
171 Hooker Avenue
Tax Map #616148.364531 Scale 1" = 50'
Less than 1 acre
USGS - Poughkeepsie Quadrangle, New York
Scale 1:24,000
UTM #18/590180/4615530





Historic Resources of the City of Poughkeepsie
Dutchess County, New York

Ethol House
171 Hooker Avenue
Tax Map #616148.364531 Scale 1" = 50'
Less than 1 acre

USGS - Poughkeepsie Quadrangle, New York
Scale 1:24,000
UTM #18/590180/4615530

Dutchess
Golf and Country Club



United States Department of the Interior

NATIONAL PARK SERVICE
1849 C Street, N.W.
Washington, DC 20240

UNITED STATES DEPARTMENT OF THE INTERIOR
NATIONAL PARK SERVICE
NATIONAL REGISTER OF HISTORIC PLACES
EVALUATION/RETURN SHEET

Requested Action: Additional Documentation
Property Name: Ethal House
Multiple Name: Poughkeepsie MRA
State & County: NEW YORK, Dutchess

Date Received: 5/5/2017 Date of Pending List: Date of 16th Day: Date of 45th Day: 6/19/2017 Date of Weekly List:

Reference number: AD82001134
Nominator: State
Reason For Review:

Accept Return Reject 6/19/2017 Date

Abstract/Summary The SHPO requested the name change to Ethal from Ethol. Name has been changed,
Comments:

Recommendation/
Criteria

Reviewer Alexis Abernathy

Discipline Historian

Telephone (202)354-2236

Date 6/19/2017

DOCUMENTATION: see attached comments : No see attached SLR : No

If a nomination is returned to the nomination authority, the nomination is no longer under consideration by the National Park Service.

United States Department of the Interior
National Park Service

Ethol House (Poughkeepsie MRA)
Dutchess County
NEW YORK

Working No. 10/12/82-2867
Fed. Reg. Date: 2.1.83
Date Due: 11/11/82 — 11/26/82
Action: ACCEPT 11/26/82
 RETURN
 REJECT
Entered in the
National Register
Federal Agency: _____

- resubmission
- nomination by person or local government
- owner objection
- appeal

Substantive Review: sample request appeal NR decision

Reviewer's comments:

Recom./Criteria _____
Reviewer _____
Discipline _____
Date _____
 see continuation sheet

Nomination returned for: technical corrections cited below
 substantive reasons discussed below

1. Name

2. Location

3. Classification

Category	Ownership	Status	Present Use
	Public Acquisition	Accessible	

4. Owner of Property

5. Location of Legal Description

6. Representation in Existing Surveys

Has this property been determined eligible? yes no

7. Description

Condition		Check one	Check one
<input type="checkbox"/> excellent	<input type="checkbox"/> deteriorated	<input type="checkbox"/> unaltered	<input type="checkbox"/> original site
<input type="checkbox"/> good	<input type="checkbox"/> ruins	<input type="checkbox"/> altered	<input type="checkbox"/> moved date _____
<input type="checkbox"/> fair	<input type="checkbox"/> unexposed		

Describe the present and original (if known) physical appearance

- summary paragraph
- completeness
- clarity
- alterations/integrity
- dates
- boundary selection

8. Significance

Period _____ Area of Significance—Check and justify below

Specific dates _____ Builder/Architect _____

Statement of Significance (in one paragraph)

- summary paragraph
- completeness
- clarity
- applicable criteria
- justification of areas checked
- relating significance to the resource
- context
- relationship of integrity to significance
- justification of exception
- other

9. Major Bibliographical References

10. Geographical Data

Address of nominated property _____

Geographic name _____

USIT References _____

Verbal boundary description and justification _____

11. Form Prepared By

12. State Historic Preservation Officer Certification

The evaluated significance of this property within the state is:

national state local

State Historic Preservation Officer signature _____

title _____ date _____

13. Other

- Maps
- Photographs
- Other

Questions concerning this nomination may be directed to _____

Signed _____ Date _____ Phone: 202 272-3504

Comments for any item may be continued on an attached sheet



**Parks, Recreation
and Historic Preservation**

ANDREW M. CUOMO
Governor

ROSE HARVEY
Commissioner

AD 8 200 1134



1 February 2017

Alexis Abernathy
National Park Service
National Register of Historic Places
1201 Eye St. NW, 8th Floor
Washington, D.C. 20005

Re: John Green House
Rockland County

Dear Ms. Abernathy:

I am writing to request a correction to a nomination listed on November 26, 1982 as part of the Poughkeepsie MRA, Dutchess County, New York. The property was incorrectly listed as the "Ethol House." Just the week, we were informed that the correct spelling is "Ethal House." We would appreciate it if you would correct the spelling in the official record. Please call Kathleen LaFrank at 518.268.2165 if you have any questions.

Sincerely:

Michael F. Lynch, P.E., AIA
Division Director, Division for Historic Preservation
Deputy State Historic Preservation Officer