

ARCHITECTURAL / HISTORICAL SURVEY

DAVENPORT, IOWA

The Architects Office

Wehner, Nowysz, Pottschiull and Pfiffner
201 city building iowa city iowa 52240

DAVENPORT COMMUNITY DEVELOPMENT DEPARTMENT
IOWA DIVISION OF HISTORIC PRESERVATION

SITE # 82-10- LE 621 MAP # 4

HIST. DIST. _____

NAME Isaac Glaspell House (H) C

ADDRESS 621 LeClaire St.

LEGAL DES. LeClaire's 6th 79 6 9 S. 80' of Lots
SUB-DIVISION BLOCK PARCEL SUB-PARCEL

UTM / 15 710,292,014,519,918,201 ACREAGE -1 ZONE R-6M
EASTING NORTHING

OWNER John R. Dombek
8122 54th St. Ct., Coal Valley, IL 61240

TITLE H. _____
(IF DIFF) _____

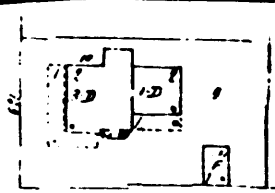

DESCRIPTION

FORM 2 stories, front-gable, 3-bay front, 1-bay side wing CONST. DATE c 1875
MATERIALS brick, stone trim, wood ARCH STYLE Vernac. Greek Revival
FENESTRATION Flat arches (main facade), segmental arches - all w/keystones
DIST. FEATURES Bracketted eaves
ALTERATIONS Porch later (c. 1900?), may have replaced earlier porch
SITE & RELATED STR. Elevated Lot.

STATEMENT

The Glaspell House is one example of the many treatments given a distinctive Davenport house type. Here, bracketted eaves, and flat-arched window heads accentuated by keystone brick hoods are the notable features. The relatively shallow roof pitch and broad dimensions derive from the Greek Revival.

John Whitaker, Builder

SOURCES

Oszuscik, Phillippe, "A History of the Architecture and Urbanization of Nineteenth Century Davenport, Iowa," Ph.D. Dissertation, University of Iowa, 1979, p. 303.

SITE SHEET ARCHITECTURE

SIGNIFICANCE

HISTORY

DESCRIPTION

Isaac Glaspell was a local grocer during the 1870's and 80's in partnership with his son as "Glasspell and Son." Glasspell probably built into this house in 1876.

SOURCES

City Directory, 1880, 1873, 1874-75, 1882-83

ARCHITECTURAL HISTORIAN: Martha Bowers | HISTORIAN: MARLYS SVENDSEN - ROESLER | SURVEY COMP 1981

EVALUATION

ARCHITECTURAL

- I. ARCH. EVALUATION Fair
- II. ENVIR. STATURE Incident
- III. INT. OF CONTEXT Excellent
- IV. INT. OF FABRIC Excellent

LEVEL OF SIGNIFICANCE:

- NAT. STATE LOCAL N. ELIG.

HISTORICAL

I. THEME(S) OF SIGNIFICANCE:

- A. PRIMARY _____
- B. SECONDARY _____

II. LEVEL OF SIGNIFICANCE:

- NAT. STATE LOCAL

III. N.R.H.P.

- ELIGIBLE NOT ELIGIBLE

HISTORIC DISTRICT CLASSIFICATION

- A. B. C

FOR DIVISION OF HISTORIC PRESERVATION USE ONLY

1. DATE RECEIVED _____

2. DATE OF STAFF EVALUATION _____

- | | | |
|---------------------------|--------------------------|--------------------------|
| | A. ARCHITECTURAL | B. HISTORICAL |
| ELIGIBLE FOR N.R.H.P. | <input type="checkbox"/> | <input type="checkbox"/> |
| NOT ELIGIBLE FOR N.R.H.P. | <input type="checkbox"/> | <input type="checkbox"/> |

3. N.R.H.P. ACTION

- A. STATE REVIEW COMM. APP. DISAPP. TABLED DATE _____
- B. FEDERAL REVIEW APP. DISAPP. TABLED DATE _____

4. D.H.P. SOURCES

- COUNTY RESOURCES
- W'SHIELD SURVEY
- N.R.H.P.
- GRANT _____

DET. OF ELIGIBILITY

- R. B. C. _____
- DAVENPORT A/H SURVEY
- _____
- _____

5. SUBJECT TRACES

6. PHOTO
82-10-1690,7

