

United States Department of the Interior
Heritage Conservation and Recreation Service

National Register of Historic Places
Inventory—Nomination Form

See instructions in *How to Complete National Register Forms*
Type all entries—complete applicable sections

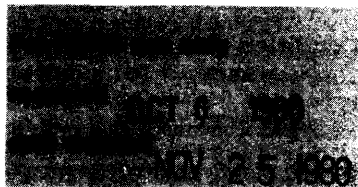

1. Name

historic FIRST PRESBYTERIAN CHURCH OF ALAMEDA (SANCTUARY BUILDING)

and/or common Same

2. Location

street & number 2001 Santa Clara Avenue not for publication

city, town Alameda vicinity of congressional district 9

state California code 06 county Alameda code 001

3. Classification

Category	Ownership	Status	Present Use
<input checked="" type="checkbox"/> district	<input type="checkbox"/> public	<input checked="" type="checkbox"/> occupied	<input type="checkbox"/> agriculture
<input checked="" type="checkbox"/> building(s)	<input checked="" type="checkbox"/> private	<input type="checkbox"/> unoccupied	<input type="checkbox"/> commercial
<input type="checkbox"/> structure	<input type="checkbox"/> both	<input type="checkbox"/> work in progress	<input type="checkbox"/> educational
<input type="checkbox"/> site	Public Acquisition	Accessible	<input type="checkbox"/> entertainment
<input type="checkbox"/> object	<input type="checkbox"/> in process	<input type="checkbox"/> yes: restricted	<input type="checkbox"/> government
	<input type="checkbox"/> being considered	<input checked="" type="checkbox"/> yes: unrestricted	<input type="checkbox"/> industrial
		<input type="checkbox"/> no	<input type="checkbox"/> military
			<input type="checkbox"/> museum
			<input type="checkbox"/> park
			<input type="checkbox"/> private residence
			<input checked="" type="checkbox"/> religious
			<input type="checkbox"/> scientific
			<input type="checkbox"/> transportation
			<input type="checkbox"/> other:

4. Owner of Property

name Presbytery of San Francisco

street & number 2024 Durant Avenue

city, town Berkeley vicinity of state California 94704

5. Location of Legal Description

courthouse, registry of deeds, etc. Alameda County Courthouse

street & number 1225 Fallon Street

city, town Oakland state California

6. Representation in Existing Surveys

title has this property been determined eligible? ___ yes ___ no

date ___ federal ___ state ___ county ___ local

depository for survey records

city, town state

7. Description

Condition		Check one	Check one
<input checked="" type="checkbox"/> excellent	<input type="checkbox"/> deteriorated	<input checked="" type="checkbox"/> unaltered	<input checked="" type="checkbox"/> original site
<input type="checkbox"/> good	<input type="checkbox"/> ruins	<input type="checkbox"/> altered	<input type="checkbox"/> moved
<input type="checkbox"/> fair	<input type="checkbox"/> unexposed		date _____

Describe the present and original (if known) physical appearance

The Sanctuary Building of the First Presbyterian Church of Alameda is situated on the northeast corner of Chestnut Street and Santa Clara Avenue. It is of rectangular plan and two stories high, of wood frame construction and sheathed in flush horizontal siding.

The building is modeled on Greek and Roman temples of the Corinthian order. This is evidenced by pedimented portico with modillions and dentil coursings, columns and pilasters with Corinthian capitals, and the shape of cornice and plan. The building also borrows from Renaissance motifs, such as simulated rustication, rows of arched windows, and windows with pedimented and cornice window heads.

The front (south, on Santa Clara) elevation is formed of a shallow pedimented portico flanked by solid wall surfaces with incised horizontal banding simulating rustication. The portico is framed by smooth pilasters; the capitals are flat with abstract geometric pattern with egg-and-dart echini. The portico has three bays framed by four fluted columns with capitals embellished in the acanthus leaves and caulicoli of the Corinthian order. The portico is reached by a flight of five steps. The three entry bays are identical, composed of single-panel double doors topped by a semi-circular (or fan) windows of stained glass. The window is "tied" by a scroll-shaped keystone to a projecting astragal. This supports a framed horizontal wood panel, atop which is a rectangular window of stained glass. The whole is recessed, and thus framed, in the wall surface.

The entablature, which extends in a band around the building, is enriched with a dentil coursing and, beneath the front cornice, modillions. The projecting triangular cornice also has dentils and modillions. An unadorned parapet extends from either side of the cornice atop the entablature, and wraps around the building.

The words "First Presbyterian Church", in relief, adorn the front frieze, which is otherwise plain.

The side elevation is dominated by fenestration. Seven windows measuring five by fifteen feet are topped by round-arched transoms, all in stained glass. These sit atop spandrels. The whole is recessed and framed by wood molding, giving the effect of large arched windows. The windows are "tied" to the entablature by scroll-shaped keystones. Eight smooth pilasters with Corinthian capitals flank the seven windows.

Projecting bays are to the left and right of the windows, with simulated rustication, each containing rectangular windows of stained glass. The windows at ground level have cornice window heads; those at the second-story level have pedimented window heads.

The overall effect of this building is that of a Classical temple with substantial Renaissance elements. The front and side elevations are gracefully unified by the similar treatment of windows and entries. The continuous entablature and cornice also unify the building.

The interior of the Sanctuary is clearly organized. The three front doors open into a narrow vestibule, or narthex, that runs along the entire front of the building. At either end of this entry hall is a stairwell leading to a balcony open to the Sanctuary. Leaded glass windows with diamond panes punctuate the wall between the vestibule and the Sanctuary. Doors open onto two aisles which extend to either side of the pulpit at the altar end of the Sanctuary room. Three tiers of pews, displaying fine woodwork, flank the center aisles. The pulpit and choir loft are on elevated platforms, and the organ fills an arched recess behind the choir loft. Extending down both sides are outer aisles with groin vault ceilings, separated from the pews by rows of arches

**NATIONAL REGISTER OF HISTORIC PLACES
INVENTORY -- NOMINATION FORM**

FOR HCRS USE ONLY
RECEIVED OCT 6 1980
DATE ENTERED NOV 25 1980

CONTINUATION SHEET

ITEM NUMBER 7 PAGE 2

supported by fifteen-foot pillars with Corinthian capitals. These arches frame the stained glass windows which grace the walls of the Sanctuary. The windows are flanked by pilasters with Corinthian columns. The ceiling is of crossed beams forming a square lattice pattern. At each intersection in the ceiling is a floral socket for an incandescent bulb. The bulbs can be lit in any pattern desired. (Interestingly, the building was constructed in a time of transition between gas and electric lighting; original fixtures had both gas outlets and bulb sockets.) The interior is painted beige. Pews have a natural finish.

The stained glass windows deserve special mention. Fourteen windows, constructed of American "art glass", line the Sanctuary walls. Ten are figured: four purely decorative. The ten figured windows all depict Christ. The windows in the stairwell, and in the narthex, are also of stained glass of comparable quality.

The Sanctuary building, which measures sixty (60) feet by one hundred (100) feet, sits on a corner lot measuring 153 feet long by 264 feet. The other buildings on the lot, lie to the north and east of the Sanctuary building. These buildings, containing office, meeting, and school space, were constructed in 1967. The scale, massing, and coloring of this new set of buildings sensitively complement the Sanctuary building. There is minimal physical contact between the old and the new in the form of a covered walkway and a hallway. Only the Sanctuary Building is nominated.

8. Significance

Period	Areas of Significance—Check and justify below					
<input type="checkbox"/> prehistoric	<input type="checkbox"/> archeology-prehistoric	<input type="checkbox"/> community planning	<input type="checkbox"/> landscape architecture	<input checked="" type="checkbox"/> religion		
<input type="checkbox"/> 1400-1499	<input type="checkbox"/> archeology-historic	<input type="checkbox"/> conservation	<input type="checkbox"/> law	<input type="checkbox"/> science		
<input type="checkbox"/> 1500-1599	<input type="checkbox"/> agriculture	<input type="checkbox"/> economics	<input type="checkbox"/> literature	<input type="checkbox"/> sculpture		
<input type="checkbox"/> 1600-1699	<input type="checkbox"/> architecture	<input type="checkbox"/> education	<input type="checkbox"/> military	<input type="checkbox"/> social/		
<input type="checkbox"/> 1700-1799	<input type="checkbox"/> art	<input type="checkbox"/> engineering	<input type="checkbox"/> music	<input type="checkbox"/> humanitarian		
<input type="checkbox"/> 1800-1899	<input type="checkbox"/> commerce	<input type="checkbox"/> exploration/settlement	<input type="checkbox"/> philosophy	<input type="checkbox"/> theater		
<input checked="" type="checkbox"/> 1900-	<input type="checkbox"/> communications	<input type="checkbox"/> industry	<input type="checkbox"/> politics/government	<input type="checkbox"/> transportation		
		<input type="checkbox"/> invention		<input type="checkbox"/> other (specify)		

Cornerstone laid: September, 1903. Building dedicated: April, 1904

Specific dates _____ **Builder/Architect** Henry H. Meyers

Statement of Significance (in one paragraph)

The Sanctuary Building of the First Presbyterian Church of Alameda is an excellent example from the San Francisco Bay Region of the neo-classical tendencies in early twentieth century American architecture. Based upon Classical temples of the Corinthian order, the structure exhibits the restraint of Classical ordering. It is in the tradition of utilizing temple forms for schools, banks, and churches, a tradition which extended largely from the 1890s to the 1930s. However, other aspects of the building derive their inspiration from Renaissance Revival sources. The side elevations are dominated by rows of arched windows flanked by pilasters. The two sets of two rectangular windows, with pedimented and cornice window heads that complete the side elevation, have a distinct Renaissance Revival feeling. Viewed in this light, the Sanctuary exterior is an interesting composite of different design sources; the architect took the temple as his primary form, and into it incorporated Renaissance elements. The front elevation is essentially a Classical temple; the side elevations are Renaissance Revival walls.

The designer of the Sanctuary Building was Henry H. Meyers, an important regional architect with office in San Francisco and residence in Alameda. Meyers received his training as an apprentice in the 1890s in the San Francisco firm of Percy and Hamilton, inherited that practice upon the deaths of those two architects in 1899 and 1900, and maintained a successful practice in San Francisco. His firm contributed important buildings in the reconstruction of San Francisco after the earthquake.

Joined soon after the earthquake of 1906 by Clarence Ward, the firm practiced under the name of Meyers and Ward. Located on the roof of the Kohl Building, their office was a large one, at one time employing 14 draftsmen. They designed many commercial buildings for the devastated south-of-Market area, as well as many homes and commercial and institutional buildings throughout the Bay Area. They also designed commercial buildings in Stockton, Sacramento, and Honolulu. One of their buildings was the celebrated Alaska Commercial Building at the corner of California and Sansome (now demolished). Another was the Twin Towers Methodist Church (1908) on the corner of Central and Oak in Alameda. By 1915, Ward had established his own practice, and Meyers continued with his own.

From the early 1920s until his retirement in 1936, Henry H. Meyers was the principal architect for Alameda County. Some of his designs from this time include Highland Hospital in Oakland, portions of Fairmont Hospital in San Leandro, Arroyo Sanitarium in Livermore, and the Caldecott Tunnel entrances. He also designed the Veterans' Buildings in several Alameda County cities, including Alameda.

Meyers designed a number of buildings in Alameda. In addition to the Twin Towers Methodist Church, and Veterans' Buildings already mentioned, he designed several houses in this city, as well as the Posey Tube portal and superstructure. Furthermore, Meyers was a member of the Alameda Planning Commission in the 1920s. It can be said that few other architects have had as significant a hand in forming the townscape of Alameda as Henry H. Meyers.

9. Major Bibliographical References

First Presbyterian Church, "A Report Prepared for the Historical Advisory Commission,"
 City of Alameda, September 26, 1977.
 Alameda Daily Argus, April, 1904.
 Blumeson, Identifying American Architecture, 1977..

10. Geographical Data

UTM NOT VERIFIED

Acreeage of nominated property .14
 Quadrangle name Oakland West

ACREAGE NOT VERIFIED
 Quadrangle scale 1:24000

UMT References

A	<u>1,0</u>	<u>56,60,5,0</u>	<u>4,18,03,3,0</u>
	Zone	Easting	Northing
C			
E			
G			

B			
	Zone	Easting	Northing
D			
F			
H			

Verbal boundary description and justification

SEE CONTINUATION SHEET

List all states and counties for properties overlapping state or county boundaries

state	code	county	code

11. Form Prepared By

name/title Woody Minor, Staff

organization Historical Advisory Commission date May 1, 1980

street & number City Hall, Oak and Santa Clara telephone (415) 522-4100

city or town Alameda state California 94501

12. State Historic Preservation Officer Certification

The evaluated significance of this property within the state is:

national state local

As the designated State Historic Preservation Officer for the National Historic Preservation Act of 1966 (Public Law 89-665), I hereby nominate this property for inclusion in the National Register and certify that it has been evaluated according to the criteria and procedures set forth by the Heritage Conservation and Recreation Service.

State Historic Preservation Officer signature *Kenny Miller*

title _____ date 9/19/86

For HCRS use only

I hereby certify that this property is eligible for the National Register.

Frank W. Raymond date 11/25/86
 Keeper of the National Register

Attest: *Patricia* date 1/25/80
 Chief of the National Register

FHR-8-300A
(11/78)

UNITED STATES DEPARTMENT OF THE INTERIOR
HERITAGE CONSERVATION AND RECREATION SERVICE

**NATIONAL REGISTER OF HISTORIC PLACES
INVENTORY -- NOMINATION FORM**

FOR HCRS USE ONLY
RECEIVED OCT 6 1980
DATE ENTERED NOV 25 1980

CONTINUATION SHEET

ITEM NUMBER 8 PAGE 2

Early members of the Church included Governor of California, Henry H. Haight, Joseph Knowland (U.S. Senator, publisher of the Oakland Tribune, and father of U.S. Senator William Knowland), and A. A. Cohen, an attorney with close ties with the railroad "Big Four", who was instrumental in the development of the railroad system in the Bay Area in the 1860s. The First Presbyterian Church of Alameda has thus played a role in the development of the community, region, and State of California.

FHR-8-300A
(11/78)

UNITED STATES DEPARTMENT OF THE INTERIOR
HERITAGE CONSERVATION AND RECREATION SERVICE

**NATIONAL REGISTER OF HISTORIC PLACES
INVENTORY -- NOMINATION FORM**

FOR HCRS USE ONLY
RECEIVED OCT 6 1980
DATE ENTERED NOV 25 1980

CONTINUATION SHEET

ITEM NUMBER 10 PAGE 2

VERBAL BOUNDARY DESCRIPTION

Beginning at the intersection of the east line of Santa Clara Avenue and the south line of Chestnut Street, continue 100 feet east along said line of Chestnut Street, then, at right angles, continue 60 feet south, 100 feet west, and 60 feet north along said line of Santa Clara Avenue to the point of beginning. The boundary is determined by the original limits of the historical resource; adjacent modern structures are separate physical entities which are not structurally connected to the Sanctuary Building and are not included in this nomination.

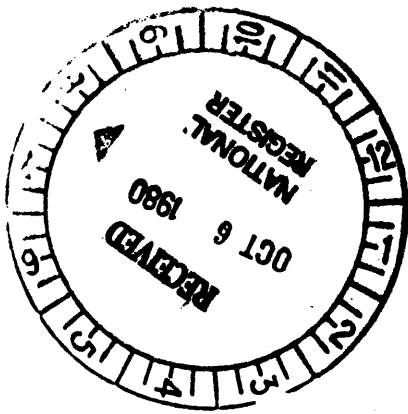

RECEIVED
MAY 27 1980

OHP

MAY 25 1980

SANTA CLARA AVE.

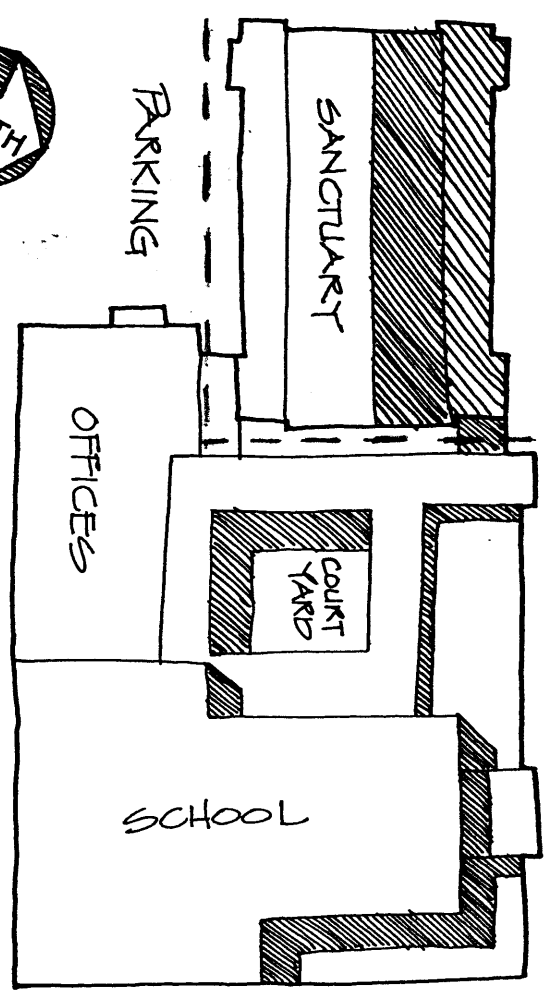

CHESTNUT STREET

SITE PLAN
FIRST PRESBYTERIAN CHURCH
2001 SANTA CLARA AVE.
ALAMEDA, CA 94501
Alameda, County