

1156

United States Department of the Interior
National Park Service

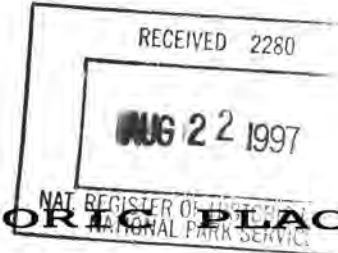

NATIONAL REGISTER OF HISTORIC PLACES
REGISTRATION FORM

This form is for use in nominating or requesting determinations for individual properties and districts. See instructions in How to Complete the National Register of Historic Places Registration Form (National Register Bulletin 16A). Complete each item by marking "x" in the appropriate box or by entering the information requested. If any item does not apply to the property being documented, enter "N/A" for "not applicable." For functions, architectural classification, materials, and areas of significance, enter only categories and subcategories from the instructions. Place additional entries and narrative items on continuation sheets (NPS Form 10-900a). Use a typewriter, word processor, or computer, to complete all items.

1. Name of Property

historic name Greer Downtown Historic District

other names/site number _____

2. Location

street & number Trade, East Poinsett, Randall, Victoria, & N. Main Sts. not for publication
city or town Greer vicinity _____
state South Carolina code SC county Greenville code SC zip code 29651

3. State/Federal Agency Certification

As the designated authority under the National Historic Preservation Act of 1986, as amended, I hereby certify that this nomination _____ request for determination of eligibility meets the documentation standards for registering properties in the National Register of Historic Places and meets the procedural and professional requirements set forth in 36 CFR Part 60. In my opinion, the property meets _____ does not meet the National Register Criteria. I recommend that this property be considered significant _____ nationally _____ statewide locally.
(____ See continuation sheet for additional comments.)

Mary W. Edmonds 8/13/97
Signature of certifying official Date

Mary W. Edmonds, Deputy SHPO, S.C. Department of Archives & History, Columbia, S.C.
State or Federal agency and bureau

In my opinion, the property _____ meets _____ does not meet the National Register criteria.
(____ See continuation sheet for additional comments.)

Signature of commenting or other official Date

State or Federal agency and bureau

4. National Park Service Certification

I, hereby certify that this property is:

- entered in the National Register _____
See continuation sheet.
- determined eligible for the National Register _____
See continuation sheet.
- determined not eligible for the National Register _____
- removed from the National Register _____
- other (explain): _____

Elson F. Beall 9/18/97

For _____
Signature of Keeper Date of Action

5. Classification

Ownership of Property (Check as many boxes as apply) <input checked="" type="checkbox"/> private <input checked="" type="checkbox"/> public-local <input type="checkbox"/> public-State <input type="checkbox"/> public-Federal	Category of Property (Check only one box) <input type="checkbox"/> building(s) <input checked="" type="checkbox"/> district <input type="checkbox"/> site <input type="checkbox"/> structure <input type="checkbox"/> object	Number of Resources within Property <table border="0"> <tr> <td style="text-align: center;">Contributing</td> <td style="text-align: center;">Noncontributing</td> <td></td> </tr> <tr> <td style="text-align: center;"><u>40</u></td> <td style="text-align: center;"><u>6</u></td> <td>buildings</td> </tr> <tr> <td style="text-align: center;"><u> </u></td> <td style="text-align: center;"><u> </u></td> <td>sites</td> </tr> <tr> <td style="text-align: center;"><u> </u></td> <td style="text-align: center;"><u> </u></td> <td>structures</td> </tr> <tr> <td style="text-align: center;"><u> </u></td> <td style="text-align: center;"><u> </u></td> <td>objects</td> </tr> <tr> <td style="text-align: center;"><u>40</u></td> <td style="text-align: center;"><u>6</u></td> <td>Total</td> </tr> </table>	Contributing	Noncontributing		<u>40</u>	<u>6</u>	buildings	<u> </u>	<u> </u>	sites	<u> </u>	<u> </u>	structures	<u> </u>	<u> </u>	objects	<u>40</u>	<u>6</u>	Total
Contributing	Noncontributing																			
<u>40</u>	<u>6</u>	buildings																		
<u> </u>	<u> </u>	sites																		
<u> </u>	<u> </u>	structures																		
<u> </u>	<u> </u>	objects																		
<u>40</u>	<u>6</u>	Total																		
Name of related multiple property listing Enter "N/A" if property is not part of a multiple property listing.		Number of contributing resources previously listed in the National Register <u>0</u>																		

6. Function or Use

Historic Functions (Enter categories from instructions)

Cat: <u>Commerce/Trade</u>	Sub: <u>Business</u>
<u>Commerce/Trade</u>	<u>Specialty Store</u>

Current Functions (Enter categories from instructions)

Cat: <u>Commerce/Trade</u>	Sub: <u>Business</u>
<u>Commerce/Trade</u>	<u>Specialty Store</u>

7. Description

Architectural Classification (Enter categories from instructions) <u>Neo-Classical; Late 19th and</u> <u>Early 20th Century American</u> <u>Movements</u>	Materials (Enter categories from instructions) foundation <u>Brick</u> roof <u>Asphalt</u> walls <u>Brick</u> other <u>Stone</u> <u>Wood</u>
Narrative Description (Describe the historic and current condition of the property on one or more continuation sheets.)	

8. Statement of Significance

Applicable National Register Criteria
 (Mark "x" in one or more boxes for the criteria qualifying the property for National Register listing)

A Property is associated with events that have made a significant contribution to the broad patterns of our history.

B Property is associated with the lives of persons significant in our past.

C Property embodies the distinctive characteristics of a type, period, or method of construction or represents the work of a master, or possesses high artistic values, or represents a significant and distinguishable entity whose components lack individual distinction.

D Property has yielded, or is likely to yield information important prehistory or history.

Criteria Considerations

(Mark "X" in all the boxes that apply.)

- A owned by a religious institution or used for religious purposes.
- B removed from its original location.
- C a birthplace or a grave.
- D a cemetery.
- E a reconstructed building, object, or structure.
- F a commemorative property.
- G less than 50 years of age or achieved significance within the past 50 years.

Areas of Significance

(Enter categories from instructions)

ARCHITECTURE

Significant Dates

Significant Person

(Complete if Criterion B is marked above)

N/A

Cultural Affiliation

N/A

Period of Significance

1900-1940

Architect/Builder

Keating, Thomas

Beacham, James Douthit

LeGrand, Leon

Narrative Statement of Significance

(Explain the significance of the property on one or more continuation sheets.)

9. Major Bibliographical References

Bibliography

(Cite the books, articles, and other sources used in preparing this form on one or more continuation sheets.)

Previous documentation on file (NPS)

- preliminary determination of individual listing (36 CFR 67) has been requested.
- previously listed in the National Register
- previously determined eligible by the National Register
- designated a National Historic Landmark
- recorded by Historic American Buildings Survey # _____
- recorded by Historic American Engineering Record # _____

Primary Location of Additional Data

- State Historic Preservation Office
- Other State agency
- Federal agency
- Local government
- University
- Other

Name of repository: S.C. Department of Archives & History, Columbia, S.C.

10. Geographical Data

Acreege of Property Approximately 7.8 acres

UTM References

(Place additional UTM references on a continuation sheet)

	Zone	Easting	Northing	Zone	Easting	Northing	
1	17	388100	3866780	3	17	387860	3866340
2	17	388080	3866420	4	17	387900	3866820
		See continuation sheet.					

Verbal Boundary Description

(Describe the boundaries of the property on a continuation sheet.)

Boundary Justification

(Explain why the boundaries were selected on a continuation sheet.)

United States Department of the Interior
National Park Service

**NATIONAL REGISTER OF HISTORIC PLACES
CONTINUATION SHEET**

Section 7 Page 1

Greer Downtown Historic District
name of property
Greenville County, South Carolina
county and State

The Greer Downtown Historic District is a collection of forty-six commercial buildings in the downtown area of the city of Greer, South Carolina. The district is centered along Trade Street with additional properties on East Poinsett, Randall, Victoria, and North Main streets. Forty buildings contribute to the character of the historic district, while six buildings are noncontributing. The contributing properties represent the development of the downtown as the center of commerce in Greer, and were constructed from ca. 1900 to ca. 1940, with the majority constructed between 1910 and 1930.

The following properties contribute to the character of the Greer Downtown Historic District:

TRADE STREET

- 1) 100 Trade Street (ca. 1920), corner of Trade and East Poinsett streets: A two-story irregular-plan brick building, with built-up roof, wide concrete string course, and wood and glass storefront; in 1997 it houses Camco.
- 2) Planters Savings Bank, 101 Trade Street (1921), corner of Trade and East Poinsett Streets: A two-story wedge-shaped brick building designed by Greenville architects James Douthit Beacham & Leon LeGrand in the Neoclassical Revival style with eight arched windows with keystones, stone water table, built-up roof with cornice and balustrade, and Flemish bond brick pattern.¹ In 1997 it houses B.A. Bennett and Company.
- 3) 102 Trade Street (ca. 1915): A two-story brick building featuring a cornice and stringcourses, with four windows on the second floor. Originally a tire store; in 1997 it houses a loan service.
- 4) 109 Trade Street (ca. 1905): A two-story brick building with seven round arch windows on the second story and a decorative corbeled cornice and stepped parapet. Built originally as a hardware store; in 1997 it houses the Book Exchange and the Greater Greer Chamber of Commerce.
- 5) 112 Trade Street (ca. 1920): A two-story brick building with a built-up roof with parapet and cornice. There are four pairs of windows with glazed terra cotta surrounds, entablature, and coping. Glass block marks a sidewalk entrance to the upstairs, which is an annex to the United Carolina Bank at 116 Trade Street.

¹John E. Wells and Robert E. Dalton, The South Carolina Architects 1885-1935: A Bibliographical Dictionary, (Richmond, VA: New South Architectural Press, 1992), 9.

United States Department of the Interior
National Park Service

**NATIONAL REGISTER OF HISTORIC PLACES
CONTINUATION SHEET**

Section 7 Page 2

Greer Downtown Historic District
name of property
Greenville County, South Carolina
county and State

-
- 6) **Bank of Greer, 116 Trade Street (ca. 1920):** A one-story brick building in the Neoclassical Revival style with Roman (Diocletian) arch windows, stone water table, brick pilasters, and stringcourse. This was the Bank of Greer, with B. A. Bennett as its first president; in 1997 it houses the United Carolina Bank.
 - 7) **R. L. Marchant Building, Marchant's Drug Store, 200 Trade Street (ca. 1910):** This three-story brick building is one of three buildings on Trade Street attributed to local contractor and architect Thomas Keating.² The only three-story building in Greer, it has a built-up roof, stepped parapet, string courses and brick pillars, flat and segmentally arched windows on the lower floor, and rounded arched windows on the third floor; in 1997 it houses the Lighthouse Christian Bookstore.
 - 8) **Bailey Building, 201 Trade Street (ca. 1915),** corner of Trade and Victoria Streets. A two-story brick building with stepped parapet wall with brick caps, brick corner pilasters, and concrete stringcourse. This was built by Mayor T.E. Smith and named for his wife Fannie Bailey; in 1997 it houses Stewart's Furniture Outlet.
 - 9) **204 Trade Street (ca. 1926):** A one-story brick building with a built-up roof and plate glass and metal front; in 1997 it houses Greer Furniture.
 - 10) **206 Trade Street (ca. 1926):** A one-story L-plan brick building with a built-up roof and plate glass and metal front. It was once an A & P Grocery, and retains the original pressed-metal ceiling; in 1997 it houses Southern Finance Loans.
 - 11) **207 Trade Street (ca. 1920):** A one-story brick building, one of four constructed for T. E. Smith and rented as grocery, feed, shoe, and clothing stores; in 1997 it houses A & M Wholesale Florist.
 - 12) **Bailes-Collins Department Store, 208-210 Trade Street (ca. 1929):** A two-story brick building with a built-up roof and second-floor ABA window arrangement; in 1997 it houses the Greer Heritage Museum.
 - 13) **209-211 Trade Street (ca. 1920):** A one-story brick building, one of four constructed for T. E. Smith. It has a parapet wall and concrete caps and an original pressed-metal ceiling; in 1997 it houses A & M Wholesale Florist.

²Ibid., 91.

United States Department of the Interior
National Park Service

**NATIONAL REGISTER OF HISTORIC PLACES
CONTINUATION SHEET**

Section 7 Page 3

Greer Downtown Historic District
name of property
Greenville County, South Carolina
county and State

-
- 14) 212-214 Trade Street (ca. 1915): A two-story brick building with a built-up roof, stepped parapet, entablature over a row of 1-over-1 windows; in 1997 it houses Cooper Furniture.
- 15) 215 Trade Street (ca. 1915): A two-story brick building, with a built-up roof with parapet, corner pilasters, corbelled brick, four rectangular windows on the upper floor, and the original pressed-metal ceiling. It appears in a 1916 photograph advertising "BUGGIES, . . . FARM IMPLEMENTS . . . STUDEBAKER WAGONS," and still has the freight elevator in the center of the building; in 1997 it houses the Magnolia Gallery.
- 16) Reese Building, 217 Trade Street (ca. 1915): A two-story brick building designed by Thomas Keating with three upper-level rectangular 1-over-1 windows with wide concrete lintels and concrete string course at sill level. The concrete panel near the top of the building reads "Reese."³ In 1997 it houses the Greer office of the Spartanburg Herald-Journal.
- 17) 218 Trade Street (ca. 1911): A two-story brick building with a built-up roof, corbelled brick, second-story brick pilasters, ribbon windows, and stringcourse; it was gutted by fire before 1927, then rebuilt and reopened as McLellan's in November 1927; in 1997 it houses Trade Street West.
- 18) 219 Trade Street (ca. 1935): A one-story brick building featuring a built-up roof with concrete caps; B.A. Bennett was an early owner; in 1997 it houses the New Dixie Cafe.
- 19) 221-223 Trade Street (ca. 1935): A one-story brick building with a built-up roof with parapet, a metal and plate glass front with two awnings, and the original pressed-metal ceiling; in 1997 it houses the Shamrock Hair Salon.
- 20) Smith & James Building, 222 Trade Street (ca. 1916): A one-story brick building with corbelled details on the upper facade; Smith & James Clothiers have occupied this building since its construction.

³Ibid., 91.

United States Department of the Interior
National Park Service

**NATIONAL REGISTER OF HISTORIC PLACES
CONTINUATION SHEET**

Section 7 Page 4

Greer Downtown Historic District
name of property
Greenville County, South Carolina
county and State

-
- 21) 224 Trade Street (ca. 1940): A two-story brick building, formerly a department store, featuring fluted Art Deco details, second-floor square windows, and an awning over the entrance; in 1997 it houses Trade Street Place.
- 22) 225 Trade Street (ca. 1935): A one-story brick building with built-up roof and parapet. The store front is of metal and plate glass protected by an awning; in 1997 it houses Bullock's Barber Shop.
- 23) Davenport Building, 230 Trade Street, corner of Trade and Randall Streets (ca. 1900): A two-story brick building with double gable roof, parapet wall, plaque at top inscribed "Davenport", and a combination of single and paired windows (boarded over); in 1997 it is vacant.
- 24) 300-302 Trade Street, southwest corner of Trade and Randall Streets (ca. 1900): A two-story brick building with hip and gable roof, parapet wall with inset balustrade atop an entablature, four second-story windows with keyed cast stone jack arches and wide sills, cast stone archivolt around arching entrance with keystone, blind arch with escutcheon/cartouche, and flanking decorative cast stone panels. 300 Trade is in 1997 Foothills Glass; 302 Trade Street was once the Rialto Theatre and is in 1997 vacant.
- 25) 304-308 Trade Street (ca. 1920): A one-story brick building with built up roof, corbeled brick cornice, and parapet, quoined pilasters; featuring wooden floors and original pressed metal ceilings; 308 Trade once housed a post office; in 1997 304-308 houses Price's Feed Store.

EAST POINSETT STREET

- 26) First National Bank of Greer, 100 East Poinsett Street, corner of South Main and East Poinsett Street (ca. 1910): This two-story brick building, originally the First National Bank of Greer, also had a school upstairs; in 1997 it houses the Mims Law Firm. It has segmental arched, one-over-one sash windows on the second story; windows on the first story were once identical to those on the second, but some have been filled with brick. Two former doorways have been partially filled and had six-over-six sash replacement windows added. The

United States Department of the Interior
National Park Service

NATIONAL REGISTER OF HISTORIC PLACES
CONTINUATION SHEET

Section 7 Page 5

Greer Downtown Historic District
name of property
Greenville County, South Carolina
county and State

brick around the current entrance is more recent and has been applied to the original facade. On the upper story, the original metal cornice survives with dentils and wraps onto the canted portion of the building. The East Poinsett Street facade features a corbeled brick cornice.

- 27) 102 East Poinsett Street (ca. 1930): A one-story brick building with a built-up roof with parapet, corbeled brick, and plate glass display front. Two small buildings have been demolished between 102 and 108 Trade Street. The bricked-in arches on the exterior wall mark the existence of past passageway between this building and its demolished neighbor, formerly at 104 East Poinsett.
- 28) 107 East Poinsett Street: A one-story brick building, with corbeled courses; in 1997 it houses Greer Florist.
- 29) 108 East Poinsett Street (ca. 1915): A one-story brick building with built-up roof with parapet, corbeled brick cornice, and plate glass and metal store front; in 1997 it houses a church.
- 30) 110 East Poinsett Street: (ca. 1920): A one-story brick building with a built-up roof, parapet facade with elaborate corbeled brick and brick panel, and a metal and plate glass store front. This building adjoins the building at 100 Trade Street; in 1997 it is vacant.
- 31) 109-113 East Poinsett Street (ca. 1915): A one-story brick building with three individual store components unified in design by corbeled cornice and parapet; once a post office.
- 32) 115-117 East Poinsett Street (ca. 1920): A two-story brick building with built-up roof with parapet wall and six bays on the second floor; once the Elmore Hotel and Cafe.
- 33) 119 East Poinsett Street (ca. 1920): A one-story brick building with a built-up roof and a pressed-metal ceiling; in 1997 it houses the Dixie Shoe Shop.
- 34) 127 East Poinsett Street: A two-story brick building with three boarded windows, with simple sills and lintels, on the second story and wood panels over the entrance; corbeled stringcourse and three inset brick panels at parapet level.

United States Department of the Interior
National Park Service

**NATIONAL REGISTER OF HISTORIC PLACES
CONTINUATION SHEET**

Section 7 Page 6

Greer Downtown Historic District
name of property
Greenville County, South Carolina
county and State

- 35) 129 East Poinsett Street: A one-story brick building with three bays on the first floor, three corbeled brick courses, and stepped parapet with paneled pedestals and stone coping; in 1997 it houses the Mutual Home Store Warehouse.

RANDALL STREET

- 36) 214 Randall Street (ca. 1900): A two-story brick building with brick course below second floor windows; four segmental arched windows at second level, corbeled cornice; first a livery stable, then Tom Duncan Buick, then Greer Fire Department, and Greer EMS; in 1997 it houses Threatt Galleries.
- 37) 219 Randall Street: (ca. 1900): A one-story brick building with corbeled brick cornice, segmental arched entrance and two flanking segmental arched windows; in 1997 it houses the John M. Rollins Law Office.
- 38) 221-23 Randall Street: A one-story brick building with corbeled brick cornice and drip molding, a stringcourse, two segmental arched entrances with flanking segmental arched windows, upper portions of bay openings altered with raised wood panels; in 1997 it houses the Utility Sales Company.

VICTORIA STREET

- 39) 120 Victoria Street (ca. 1930): A two-story brick building featuring two storefronts with division, left side contains decorative prismatic glass and two entrances with transoms, right side has one left-sided entrance and Carrera glass; three 1 over 1 windows over each storefront; lozenge-shaped brick and stucco panels, with stone coping on paired peaked parapet; in 1997 it is vacant.

NORTH MAIN STREET

- 40) 104 North Main Street (ca. 1900): A two-story brick building with segmental arched windows, originally a warehouse; in 1997 it houses the Greer Tire Exchange.

United States Department of the Interior
National Park Service

**NATIONAL REGISTER OF HISTORIC PLACES
CONTINUATION SHEET**

Section 7 Page 7

Greer Downtown Historic District
name of property
Greenville County, South Carolina
county and State

The following properties do not contribute to the character of the Greer Downtown Historic District:

- 41) 104-106 Trade Street: A two-story brick building with cast stone front designed by Thomas Keating, featuring cast stone eagle-shielded capitals atop large pilasters, dentiled and modilioned cornice, and balustraded and pedistaled parapet, but presently with a large metal awning covering most of the facade from the storefront to the entablature; in 1997 it is vacant.
- 42) 108 Trade Street: A two-story brick building with faux marble facade at storefront, flat metal awning; four paired, horizontal 2 over 2 windows at second level; in 1997 it is vacant.
- 43) 117 Trade Street, corner of Trade and Victoria Streets: A ca. 1950 one-story brick building with ca. 1990 entrance and bank drive-through window; in 1997 it houses an office of the Duke Power Company.
- 44) 202 Trade Street: A one-story brick building with faux marble facade, flat metal awning, and plate glass storefront with deeply-recessed entrance; in 1997 it houses the Ace Finance Company.
- 45) 213 Trade Street: A one-story brick building, one of four constructed for T. E. Smith, with a built-up roof and stuccoed exterior; in 1997 it houses On Track Racing.
- 46) 125 East Poinsett Street: A one-story brick building with modern vertical wood enclosure at storefront and non-historic windows, rectangular wood panels above storefront.

United States Department of the Interior
National Park Service

NATIONAL REGISTER OF HISTORIC PLACES
CONTINUATION SHEET

Section 8 Page 8

Greer Downtown Historic District
name of property
Greenville County, South Carolina
county and State

The Greer Downtown Historic District is significant under Criterion C for its high concentration of intact examples of early twentieth-century commercial architecture. The commercial buildings in the district signify Greer's expansion from an agricultural market place to include an industrial and manufacturing economy.

Greer was first established as Greer's Station in 1873 as a flag station along the Atlanta Charlotte Air Line Railroad.⁴ The town was officially incorporated as Greer's in 1876, but later became known simply as Greer.⁵ From the late 1870s through the 1890s, downtown Greer prospered in the cotton trade and the streets were lined with a wide variety of businesses such as general stores, physicians, and other essential services. These and many early businesses in Greer were grouped in wood frame buildings around the Public Square and along Trade Street, the main business avenue leading from the rail depot.⁶ By about 1906, two new railroads, Southern Railway and Piedmont and Northern, constructed competing rail lines through Greer. Commercial activity eventually focused between the two tracks as businesses sought to have easy access to transportation for their products.⁷

In the early twentieth century, the economic character of Greer changed. The textile industry, which traced its humble beginnings back to the early nineteenth century, began to expand rapidly, especially in the Carolinas and Greenville County. Within one hundred miles of the county seat of Greenville there were over 400 mills by 1930. In Greenville County alone there were 35 mills.⁸ Several mills began operation just outside of Greer between about 1896 and 1908, including Apalachee Mill, Victor Cotton Mill, Franklin Mill, and Greer Mill, but their presence nearby had a significant effect on the economy and appearance of downtown Greer.⁹

⁴Pendleton Design Group and Zach Watson Rice, "City of Greer Historic Preservation Planning Project," (1996), 14.

⁵Ibid., 15.

⁶Ibid., 17.

⁷Ibid., 22.

⁸James M. Richardson, History of Greenville County South Carolina: Narrative and Biographical (Atlanta: A. H. Cawston, 1930), 119-120.

⁹"City of Greer Historic Preservation Planning Project," 19-20.

United States Department of the Interior
National Park Service

**NATIONAL REGISTER OF HISTORIC PLACES
CONTINUATION SHEET**

Section 8 Page 9

Greer Downtown Historic District
name of property
Greenville County, South Carolina
county and State

With the expansion of the textile mills, downtown Greer also expanded in the form of new industry and commerce focused on supporting textiles. Warehouses, lumber and fuel production, and the manufacture of cotton byproducts (such as cotton seed oil and fertilizer) downtown were the outgrowth of the textile mills. These new businesses and industries changed the face of downtown Greer as they replaced older wood frame buildings with brick commercial structures, some as tall as two or three stories.¹⁰

Greer's downtown commercial architecture reflects the prosperity of the town's economy between 1900 and 1930 when textiles and related industries flourished.

A number of the significant buildings in Downtown Greer were designed by Thomas Keating, an upcountry contractor and builder who designed many buildings in Greenville and Spartanburg Counties between 1903 and 1915. The R. L. Marchant Building (200 Trade Street), the Reese Building (217 Trade Street), and the Belk-Kirkpatrick building (104-106 Trade Street, noncontributing) were all designed by Keating, as well as several residences (including his own at 213 North Main) in Greer.¹¹

¹⁰Ibid., 22, 24.

¹¹Wells and Dalton, 91; Schader et al.

United States Department of the Interior
National Park Service

NATIONAL REGISTER OF HISTORIC PLACES
CONTINUATION SHEET

Section 9 Page 10

Greer Downtown Historic District
name of property
Greenville County, South Carolina
county and State

WORKS CITED

- Pendleton Design Group and Zach Watson Rice. City of Greer
Historic Preservation Planning Project. 1996.
- Richardson, James M. History of Greenville County South Carolina:
Narrative and Biographical. Atlanta: A.W. Cawston, 1930.
- Schader, Mark, et al., "City of Greer Survey," 1979. State Historic
Preservation Office, S.C. Dept. of Archives and History,
Columbia, S.C.
- Wells, John E., and Robert E. Dalton. The South Carolina Architects
1885-1935: A Biographical Dictionary. Richmond, Virginia: New
South Architectural Press, 1992.
- Additional documentation:
- Greer City Directories, 1915 & 1949. Jean M. Smith Library of
Greer, 505 Pennsylvania Avenue, Greer, South Carolina 29651.
(864) 877-8722
- Property owners, City of Greer Tax Maps No. G20 & G21

United States Department of the Interior
National Park Service

**NATIONAL REGISTER OF HISTORIC PLACES
CONTINUATION SHEET**

Section 10 Page 11

Greer Downtown Historic District
name of property
Greenville County, South Carolina
county and State

Verbal Boundary Description

The boundary of the nominated property is shown as the black line on the accompanying sketch map "Greer Downtown Historic District," scaled at 1" = 90', adapted from City of Greer Tax Maps G20 and G21, originally drawn at a scale of 1" = 50'.

Verbal Boundary Justification

The nominated property includes significant and intact properties comprising the historic core of Greer's downtown and centered along the Trade Street corridor, and regains integrity of location, design, setting, materials, workmanship, feeling, and association.

11. Form Prepared By

name/title Dr. Rose Marie Cooper Jordan, with the assistance of the SHPO staff
and Brad Sauls, SHPO Intern

organization Volunteer, City Planning date 1 June 1997

street & number 303 North Main Street telephone (864) 877-5529

city or town Greer state SC zip code 29650-1635

Additional Documentation

Submit the following items with the completed form:

Continuation Sheets

Maps

- A **USGS map** (7.5 or 15 minute series) indicating the property's location.
- A **Sketch map** for historic districts and properties having large acreage or numerous resources.

Photographs

Representative **black and white photographs** of the property.

Additional items (Check with the SHPO or FPO for any additional items)

Property Owner

(Complete this item at the request of the SHPO or FPO.)

name _____

street & number _____ telephone _____

city or town _____ state _____ zip code _____

United States Department of the Interior
National Park Service

**NATIONAL REGISTER OF HISTORIC PLACES
CONTINUATION SHEET**

Section PHOTOGRAPHS Page 12 Greer Downtown Historic District
name of property
Greenville County, South Carolina
county and State

The following information is the same for each of the photographs:

Name of Property: Greer Downtown Historic District
Location of Property: Trade, E. Poinsett, Randall, Victoria,
and N. Main Streets,
Greer, Greenville County, S.C.

Location of Original
Negatives: S.C. Department of Archives & History,
Columbia, S.C.

1. 100 Trade St. and Streetscape, E. Poinsett St.
Name of Photographer: Rose Marie Cooper Jordan
Date of Photographs: March 1996
2. Planters Savings Bank, 101 Trade St.
Name of Photographer: Rose Marie Cooper Jordan
Date of Photographs: March 1996
3. Bank of Greer, 116 Trade St.; 112 Trade St.; 108 Trade St.
(NONCONTRIBUTING); 104-106 Trade St. (NONCONTRIBUTING)
Name of Photographer: Rose Marie Cooper Jordan
Date of Photographs: March 1996
4. 109 Trade St.
Name of Photographer: J. Tracy Power, S.C. Dept. of
Archives & History
Date of Photographs: June 1997
5. Bank of Greer, 116 Trade St., and Streetscape, Trade St.
Name of Photographer: J. Tracy Power, S.C. Dept. of
Archives & History
Date of Photographs: June 1997
6. Bank of Greer, 116 Trade St.
Name of Photographer: J. Tracy Power, S.C. Dept. of
Archives & History
Date of Photographs: June 1997
7. R.L. Marchant Building, 200 Trade St.; 202 Trade St.
(NONCONTRIBUTING); 204 Trade St.
Name of Photographer: Rose Marie Cooper Jordan
Date of Photographs: March 1996

United States Department of the Interior
National Park Service

**NATIONAL REGISTER OF HISTORIC PLACES
CONTINUATION SHEET**

Section PHOTOGRAPHS Page 13 Greer Downtown Historic District
name of property
Greenville County, South Carolina
county and State

8. R.L. Marchant Building, 200 Trade St., Second and Third Story
Detail
Name of Photographer: J. Tracy Power, S.C. Dept. of
Archives & History
Date of Photographs: June 1997
9. Bailey Building, 201 Trade St.
Name of Photographer: Rose Marie Cooper Jordan
Date of Photographs: March 1996
10. 206 Trade St. and 204 Trade St.
Name of Photographer: J. Tracy Power, S.C. Dept. of
Archives & History
Date of Photographs: June 1997
11. 207 Trade St., 209-211 Trade St.
Name of Photographer: J. Tracy Power, S.C. Dept. of
Archives & History
Date of Photographs: June 1997
12. Bailes-Collins Department Store, 208-210 Trade St.
Name of Photographer: J. Tracy Power, S.C. Dept. of
Archives & History
Date of Photographs: June 1997
13. 212-214 Trade St.
Name of Photographer: J. Tracy Power, S.C. Dept. of
Archives & History
Date of Photographs: June 1997
14. 215 Trade St.; Reese Building, 217 Trade St.; 219 Trade St.
Name of Photographer: J. Tracy Power, S.C. Dept. of
Archives & History
Date of Photographs: June 1997
15. Smith & James Building, 222 Trade St.; 218 Trade St.
Name of Photographer: J. Tracy Power, S.C. Dept. of
Archives & History
Date of Photographs: June 1997
16. 224 Trade St.; Smith & James Building, 222 Trade St; 218 Trade
St.
Name of Photographer: Rose Marie Cooper Jordan
Date of Photographs: March 1996

United States Department of the Interior
National Park Service

**NATIONAL REGISTER OF HISTORIC PLACES
CONTINUATION SHEET**

Section PHOTOGRAPHS Page 14 Greer Downtown Historic District
name of property
Greenville County, South Carolina
county and State

17. 219 Trade St.; 221-23 Trade St.; 225 Trade St.
Name of Photographer: Rose Marie Cooper Jordan
Date of Photographs: March 1996
18. Davenport Building, 230 Trade St.; 224 Trade St.
Name of Photographer: Rose Marie Cooper Jordan
Date of Photographs: March 1996
19. 300-302 Trade St.
Name of Photographer: Rose Marie Cooper Jordan
Date of Photographs: March 1996
20. 304-308 Trade St.
Name of Photographer: Rose Marie Cooper Jordan
Date of Photographs: March 1996
21. First National Bank of Greer, 100 E. Poinsett St.
Name of Photographer: Rose Marie Cooper Jordan
Date of Photographs: March 1996
22. First National Bank of Greer, 100 E. Poinsett St.; N. Main St.
elevation
Name of Photographer: Rose Marie Cooper Jordan
Date of Photographs: March 1996
23. 108 E. Poinsett St.; 110 E. Poinsett St.
Name of Photographer: Rose Marie Cooper Jordan
Date of Photographs: March 1996
24. 109-113 E. Poinsett St.
Name of Photographer: J. Tracy Power, S.C. Dept. of
Archives & History
Date of Photographs: June 1997
25. 109-113 E. Poinsett St.; 115-117 E. Poinsett St.
Name of Photographer: Rose Marie Cooper Jordan
Date of Photographs: March 1996
26. 109-113 E. Poinsett St.; 115-117 E. Poinsett St.; 119 E.
Poinsett St.
Name of Photographer: J. Tracy Power, S.C. Dept. of
Archives & History
Date of Photographs: June 1997

United States Department of the Interior
National Park Service

**NATIONAL REGISTER OF HISTORIC PLACES
CONTINUATION SHEET**

Section PHOTOGRAPHS Page 15 Greer Downtown Historic District
name of property
Greenville County, South Carolina
county and State

27. 129 E. Poinsett St.
Name of Photographer: J. Tracy Power, S.C. Dept. of
Archives & History
Date of Photographs: June 1997
28. Streetscape, E. Poinsett St.
Name of Photographer: J. Tracy Power, S.C. Dept. of
Archives & History
Date of Photographs: June 1997
29. 214 Randall St.
Name of Photographer: J. Tracy Power, S.C. Dept. of
Archives & History
Date of Photographs: June 1997
30. 219 Randall St.; 221-23 Randall St.
Name of Photographer: J. Tracy Power, S.C. Dept. of
Archives & History
Date of Photographs: June 1997
31. 120 Victoria St.
Name of Photographer: J. Tracy Power, S.C. Dept. of
Archives & History
Date of Photographs: June 1997
32. 104 N. Main St.
Name of Photographer: J. Tracy Power, S.C. Dept. of
Archives & History
Date of Photographs: June 1997
33. 104 N. Main St., right facade oblique
Name of Photographer: J. Tracy Power, S.C. Dept. of
Archives & History
Date of Photographs: June 1997
34. 104-106 Trade St. (NONCONTRIBUTING)
Name of Photographer: J. Tracy Power, S.C. Dept. of
Archives & History
Date of Photographs: June 1997
35. 108 Trade St. (NONCONTRIBUTING)
Name of Photographer: J. Tracy Power, S.C. Dept. of
Archives & History
Date of Photographs: June 1997

United States Department of the Interior
National Park Service

**NATIONAL REGISTER OF HISTORIC PLACES
CONTINUATION SHEET**

Section PHOTOGRAPHS Page 16 Greer Downtown Historic District
name of property
Greenville County, South Carolina
county and State

36. 117 Trade St. (NONCONTRIBUTING)
Name of Photographer: J. Tracy Power, S.C. Dept. of
Archives & History
Date of Photographs: June 1997
37. 202 Trade St. (NONCONTRIBUTING)
Name of Photographer: J. Tracy Power, S.C. Dept. of
Archives & History
Date of Photographs: June 1997
38. 213 Trade St. (NONCONTRIBUTING)
Name of Photographer: J. Tracy Power, S.C. Dept. of
Archives & History
Date of Photographs: June 1997
39. 119 E. Poinsett St.; 125 E. Poinsett St. (NONCONTRIBUTING);
127 E. Poinsett St.
Name of Photographer: J. Tracy Power, S.C. Dept. of
Archives & History
Date of Photographs: June 1997

**GREEN DOWNTOWN HISTORIC DISTRICT
Greer, Greenville County, S.C.**

This map is keyed to the inventory of district properties in Section 7.

-  District Boundaries
-  Noncontributing Properties

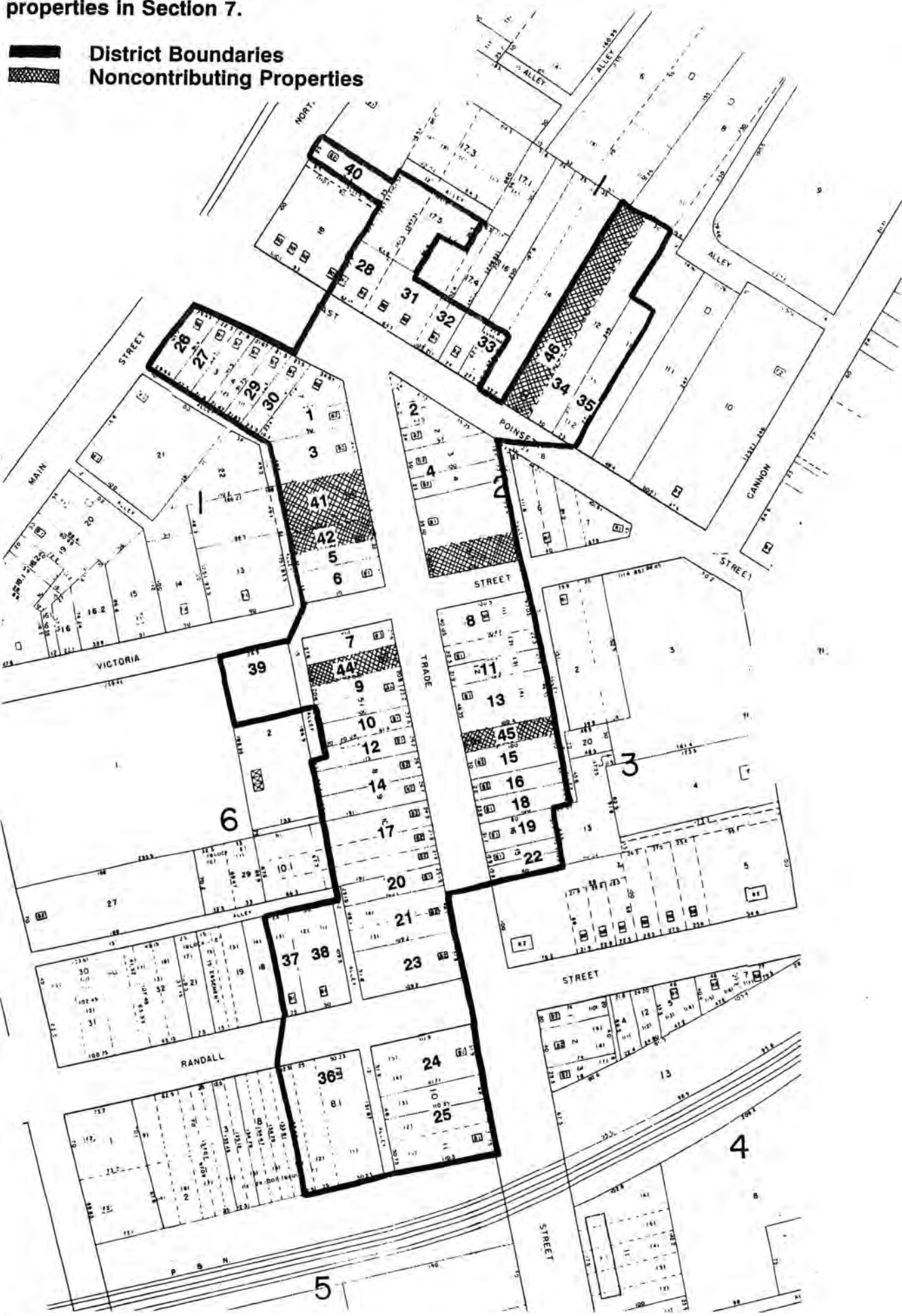











UNITED
CAROLINA
BANK

BAILES-COLLINS
DEPARTMENT STORE INC.

ICE PALACE CO.

LAW TRADE STR.

VICTORIA ST



UNITED
CAROLINA
BANK

ucb

ONE WAY



ACE FINANCE CO.

TRADE ST

TRADE STREET

BOOK STORE





Southern Finance **LOANS**

GREER FURNITURE

Southern Finance

WE
FINANCE
OUR OWN

WE
FINANCE
OUR OWN





BAILES-COLLINS
DEPARTMENT STORE INC.

So

Heritage Store







NEW DITCH
Cafe

World Bank Corp
LOANS

WALKER

WALKER



















HISTORIC
GREER

ORIST

PHOTO
LOCKSMITHS

PAINT
RENT

S.C.
101
S.C.
290



EL NOSTAL
TIENDA MEXICANA
MEXICAN FOOD MARKET

vigo

LOANS

5





Coca-Cola
DIXIE
SHOE SHOP

No Left Turn

101
290



Mutual Sales Co.

PAVIA
MAGNAVOK

PAVIA
MAGNAVOK

MUTUAL
HOME
STORE

MUTUAL
HOME
STORE





GREYSBURG MUNICIPAL COURT







THE TIRE EXCHANGE
GEORGE W. GREEN, INC.
INC. 1912
217 N. 5th St.

REPAIRS TIRES
ALL TYPE TIRES
REPAIRS & SIZES
REPAIRS OF ALL TYPES
REPAIRS OF ALL TYPES
REPAIRS OF ALL TYPES
REPAIRS OF ALL TYPES
REPAIRS OF ALL TYPES
REPAIRS OF ALL TYPES







MAINTENANCE

Star Line
BALLROOM

26-8

ALTA
Cunningham

Duke Power The Appliance Store

ONE WAY

WRONG WAY

123
ELECTRICAL



ACE FINANCE CO.









PRODUCED BY THE UNITED STATES GEOLOGICAL SURVEY
CONTROL BY USGS, NOS-NOAA, AND SOUTH CAROLINA GEODETIC SURVEY
COMPILED FROM AERIAL PHOTOGRAPHS TAKEN 1976
FIELD CHECKED 1977. MAP EDITED 1983
PROJECTION LAMBERT CONFORMAL CONIC
GRID: 1000-METER UNIVERSAL TRANSVERSE MERCATOR ZONE 17
10,000-FOOT STATE GRID TICKS SOUTH CAROLINA, NORTH ZONE
UTM GRID DECLINATION 0°41' WEST
1983 MAGNETIC NORTH DECLINATION 9°30' WEST
VERTICAL DATUM NATIONAL GEODETIC VERTICAL DATUM OF 1989
HORIZONTAL DATUM 1927 NORTH AMERICAN DATUM
To place on the predicted North American Datum of 1983, move
the projection lines as shown by dashed corner ticks (9 meters
south and 14 meters west).
There may be private inholdings within the boundaries of any
Federal and State Reservations shown on this map.
Gray tint indicates area in which selected buildings are shown.

PROVISIONAL MAP
Produced from original
manuscript drawings. Infor-
mation shown as of date of
field check.

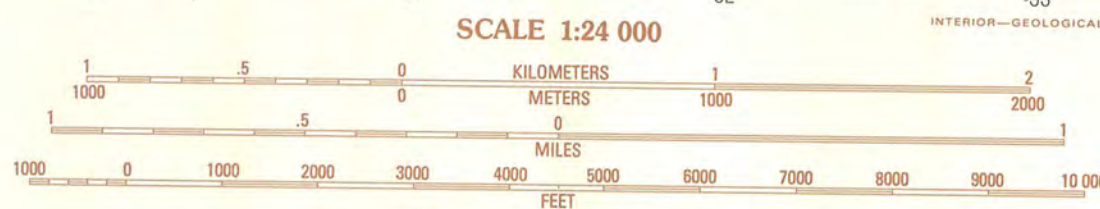

CONTOUR INTERVAL 3 METERS
CONTROL ELEVATIONS SHOWN TO THE NEAREST 0.1 METER
OTHER ELEVATIONS SHOWN TO THE NEAREST METER
To convert meters to feet multiply by 3.2808
To convert feet to meters multiply by .3048

THIS MAP COMPLIES WITH NATIONAL MAP ACCURACY STANDARDS
FOR SALE BY U. S. GEOLOGICAL SURVEY, RESTON, VIRGINIA 22092



1	2	3	1	Tigerville
2	3	4	2	Campobello
3	4	5	3	Inman
4	5	6	4	Taylor
5	6	7	5	Wellford
6	7	8	6	Mauldin
7	8		7	Pelham
8			8	Reidville

ADJOINING 7.5' QUADRANGLE NAMES

CONTOURS AND ELEVATIONS IN METERS
ROAD LEGEND

- Improved Road
- Unimproved Road
- Trail
- Interstate Route
- U. S. Route
- State Route

GREER, S. C.
PROVISIONAL EDITION 1983

34082-H2-TM-024

GREER DOWNTOWN HISTORIC DISTRICT Greer, Greenville County, S.C.

This map is keyed to the inventory of district properties in Section 7.

-  District Boundaries
-  Noncontributing Properties

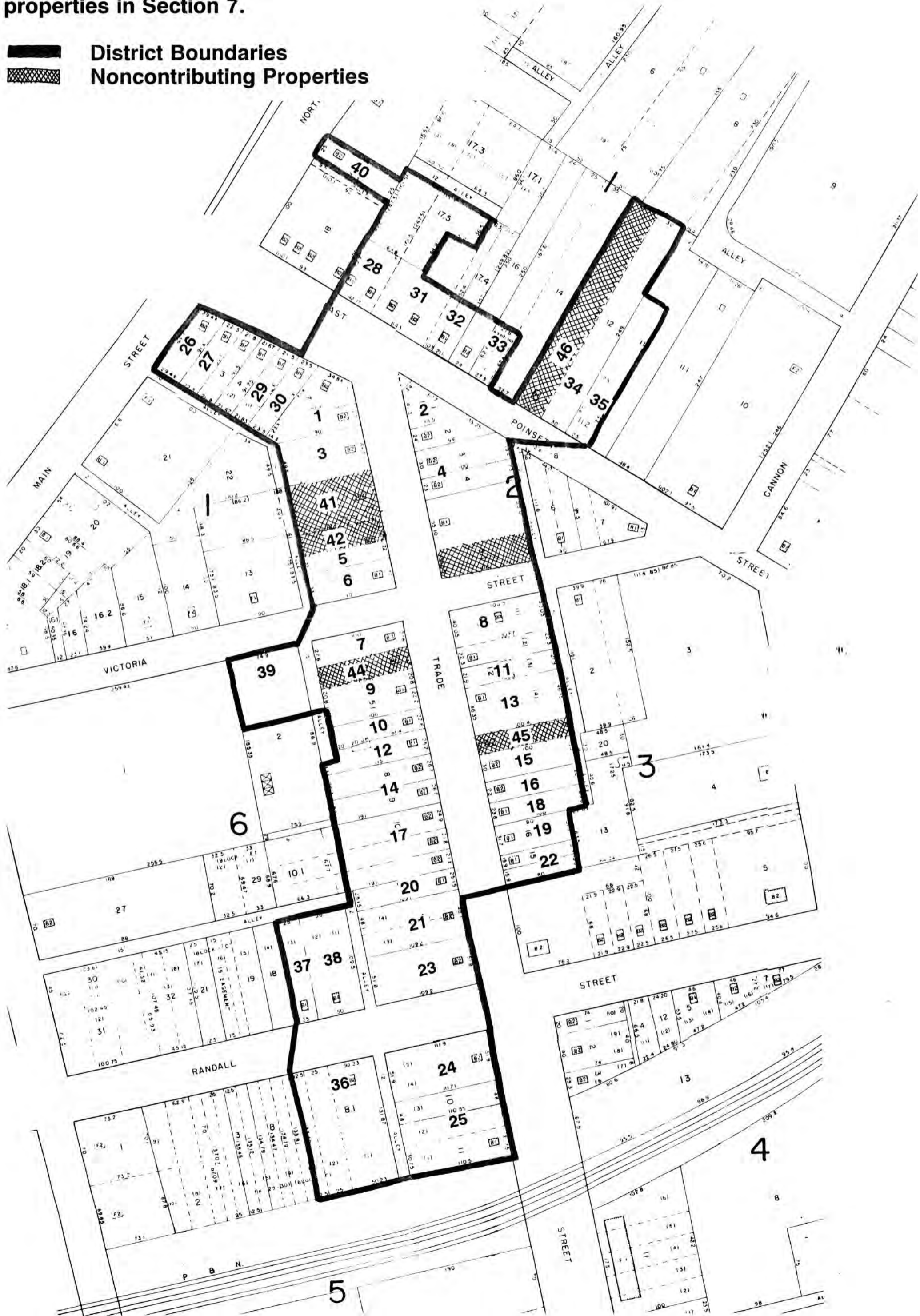

National Register of Historic Places

Note to the record

Additional Documentation: 2004

97001156



**United States Department of the Interior
National Park Service**

**National Register of Historic Places
Continuation Sheet**

Section number 7 Page 7a

Alta Cunningham Building, 104-106 Trade Street
Name of Property
Greenville County, South Carolina
County and State

The Greer Downtown Historic District was listed in the National Register of Historic Places on September 18, 1997. The Alta Cunningham Building, at 104-106 Trade Street, in the city of Greer, Greenville County, South Carolina, is located within the boundaries of the Greer Downtown Historic District, but was categorized as noncontributing when the National Register nomination was prepared in 1997. A large portion of its façade had been covered with a metal awning in the 1950s. In early 2003, the current owner removed the metal awning to reveal an essentially intact façade above the storefront or street level.

A two-story brick building with a cast stone façade, the storefront consists of two inset entrances with white marble veneered bulkhead, plate glass windows in metal frames, above all of which is a large transom of colored prismatic glass panels. On either end of the building's façade is a paneled cast stone pilaster with eagle-shielded capital. The building's second floor contains seven deeply-set window bays with eight-light casement windows. Beneath these windows is a continuous, bracketed cast stone sill and three cast stone panels with urn and festoon motif placed at the center of the façade and above each inset entrance on the first floor. The building's façade is finished with a full entablature that features a denticulated and modillioned cornice, and is capped by a pedestaled and balustraded parapet.

Known as the Alta Cunningham Building, the property was constructed ca. 1920 by local businessman, William M. Thompson. Designed by Thompson's brother-in-law and well-known local architect, Thomas Keating, the building was first occupied by the Belk-Kirkpatrick Department Store. Known as Belk-Simpson from 1924 until the mid-1930s, the building then became home to the Alta Cunningham Department Store, a women's clothier specializing in high-line fashions. "Miss Alta's," as it was known locally, remained in business in this building until Miss Cunningham's death in the late 1970s.

The building is an excellent example of commercial architecture of the early twentieth century, as well as the work of prominent Greer architect Thomas Keating. It should be re-categorized as a contributing property in the Greer Downtown Historic District.

As the designated authority under the National Historic Preservation Act of 1986, as amended, I hereby certify that this nomination request for determination of eligibility meets the documentation standards for registering properties in the National Register of Historic Places and meets the procedural and professional requirements set forth in 36 CFR Part 60. In my opinion, the property meets does not meet the National Register Criteria. I recommend that this property be considered significant nationally statewide locally. (See continuation sheet for additional comments.)

Mary W. Edmonds 5/3/04
Signature of certifying official Date



Mary W. Edmonds, Deputy State Historic Preservation Officer, S.C. Dept. of Archives and History, Columbia, S.C.
State or Federal agency and bureau

In my opinion, the property meets does not meet the National Register criteria. (See continuation sheet for additional comments.)

Signature of commenting or other official Date

State or Federal agency and bureau

This map is keyed to the inventory of district
properties in Section 7.

-  District Boundaries
-  Noncontributing Properties

#41 - Alta Cunningham
Building, 104-106
Trade Street

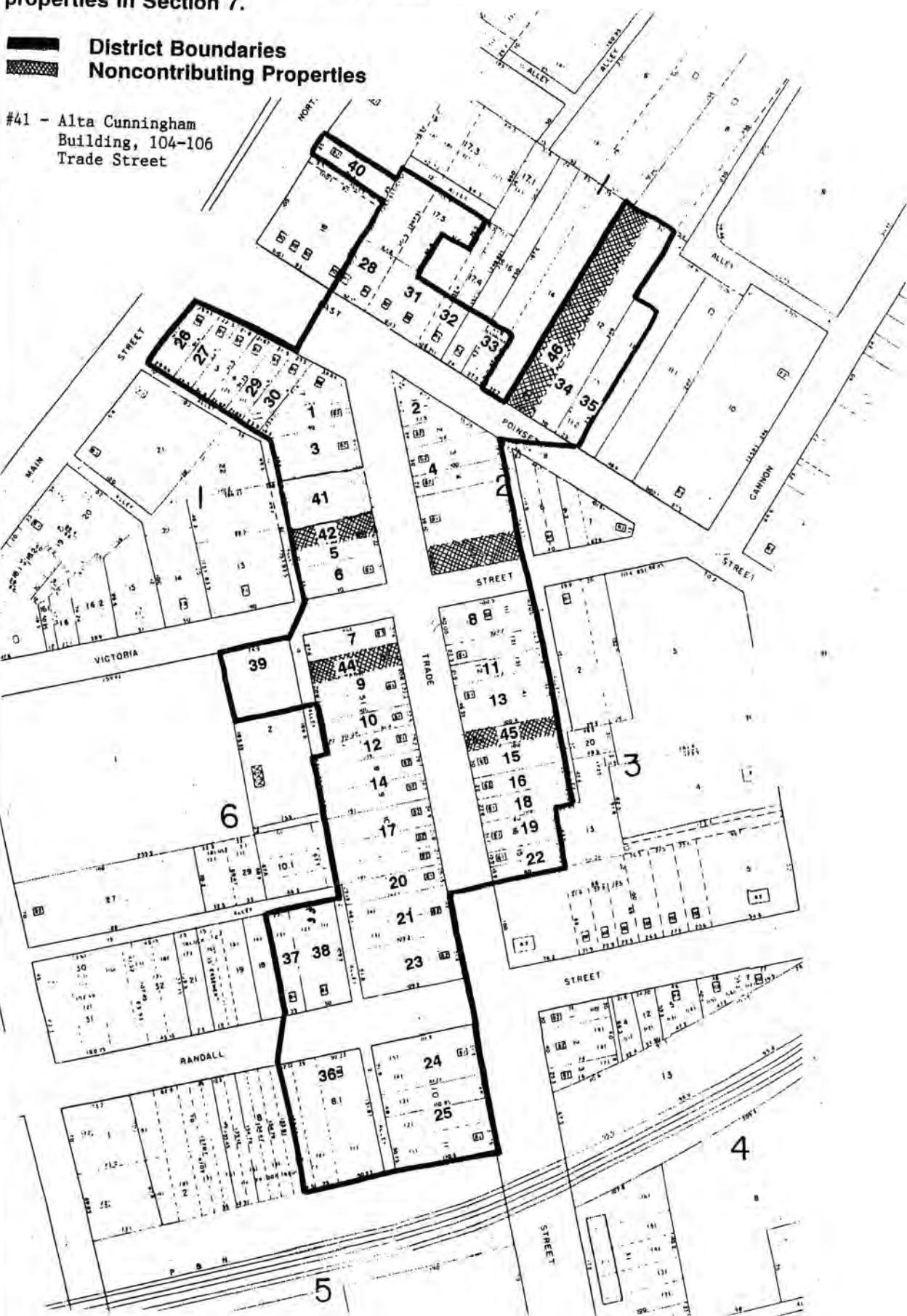

GREER DOWNTOWN HISTORIC DISTRICT
Greer, Greenville County, S.C.

Revised 4/30/04

This map is keyed to the inventory of district properties in Section 7.

-  District Boundaries
-  Noncontributing Properties

#41 - Alta Cunningham Building, 104-106 Trade Street

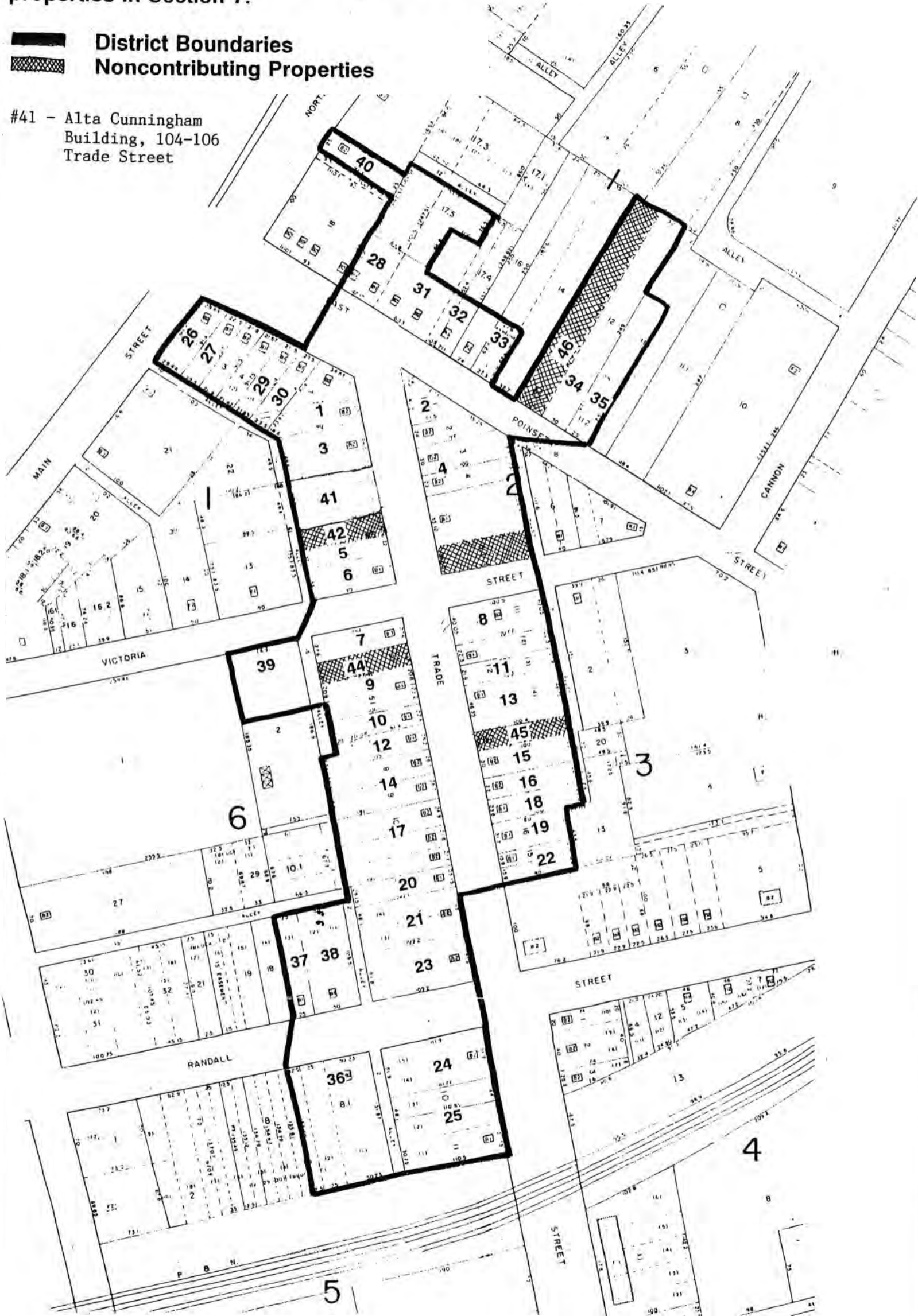



① Alta Cunningham Building
104-106 Trade Street
Greer Downtown Historic District
Greenville County, SC



② Alta Cunningham Building
104-106 Trade Street
Greer Downtown Historic District
Greenville County, SC



③ Alta Cunningham Building
104-106 Trade Street
Greer Downtown Historic District
Greenville County, SC

UNITED STATES DEPARTMENT OF THE INTERIOR
NATIONAL PARK SERVICE

NATIONAL REGISTER OF HISTORIC PLACES
EVALUATION/RETURN SHEET

REQUESTED ACTION: ~~NOMINATION~~

PROPERTY Greer Downtown Historic District
NAME:

MULTIPLE
NAME:

STATE & COUNTY: SOUTH CAROLINA, Greenville

DATE RECEIVED: 5/05/04 DATE OF PENDING LIST:
DATE OF 16TH DAY: DATE OF 45TH DAY: 6/18/04
DATE OF WEEKLY LIST:

REFERENCE NUMBER: 97001156

NOMINATOR: STATE

REASONS FOR REVIEW:

APPEAL: N DATA PROBLEM: N LANDSCAPE: N LESS THAN 50 YEARS: N
OTHER: N PDIL: N PERIOD: N PROGRAM UNAPPROVED: N
REQUEST: N SAMPLE: N SLR DRAFT: N NATIONAL: N

COMMENT WAIVER: N

ACCEPT RETURN REJECT _____ DATE

ABSTRACT/SUMMARY COMMENTS:

Additional Documentation Accepted

RECOM./CRITERIA Accept
REVIEWER Edson Beall DISCIPLINE History
TELEPHONE _____ DATE 6/22/04

DOCUMENTATION see attached comments Y/N see attached SLR Y/N

If a nomination is returned to the nominating authority, the nomination is no longer under consideration by the NPS.

National Register of Historic Places
Memo to File

Correspondence

The Correspondence consists of communications from (and possibly to) the nominating authority, notes from the staff of the National Register of Historic Places, and/or other material the National Register of Historic Places received associated with the property.

Correspondence may also include information from other sources, drafts of the nomination, letters of support or objection, memorandums, and ephemera which document the efforts to recognize the property.

UNITED STATES DEPARTMENT OF THE INTERIOR
NATIONAL PARK SERVICE

NATIONAL REGISTER OF HISTORIC PLACES
EVALUATION/RETURN SHEET

REQUESTED ACTION: NOMINATION

PROPERTY Greer Downtown Historic District
NAME:

MULTIPLE
NAME:

STATE & COUNTY: SOUTH CAROLINA, Greenville

DATE RECEIVED: 8/22/97 DATE OF PENDING LIST: 9/02/97
DATE OF 16TH DAY: 9/18/97 DATE OF 45TH DAY: 10/06/97
DATE OF WEEKLY LIST:

REFERENCE NUMBER: 97001156

NOMINATOR: STATE

REASONS FOR REVIEW:

APPEAL: N DATA PROBLEM: N LANDSCAPE: N LESS THAN 50 YEARS: N
OTHER: N PDIL: N PERIOD: N PROGRAM UNAPPROVED: N
REQUEST: N SAMPLE: N SLR DRAFT: N NATIONAL: N

COMMENT WAIVER: N

ACCEPT RETURN REJECT 9/18/97 DATE

ABSTRACT/SUMMARY COMMENTS:

RECOM./CRITERIA _____

REVIEWER _____ DISCIPLINE _____

TELEPHONE _____ DATE _____

DOCUMENTATION see attached comments Y/N see attached SLR Y/N



Monday, 3 May 2004

Ms. Carol D. Shull
Keeper, National Register of Historic Places
U.S. Department of the Interior
National Park Service
1201 Eye (I) Street, NW, 8th Floor
Washington, DC 20005

Dear Carol:

Enclosed is an amendment to the National Register nomination for the Greer Downtown Historic District, in Greenville County, South Carolina. This amendment, for the Alta Cunningham Building at 104-106 Trade Street, is being submitted as additional information to change the status of the building from noncontributing to contributing.

If I may be of further assistance, please do not hesitate to contact me at the address below, call me at (803) 896-6179, fax me at (803) 896-6167, or e-mail me at CHANDLER@scdah.state.sc.us. I hope to hear from you soon.

Sincerely,

Andrew W. Chandler
Architectural Historian
State Historic Preservation Office

enclosure