

UNITED STATES DEPARTMENT OF THE INTERIOR
NATIONAL PARK SERVICE

**NATIONAL REGISTER OF HISTORIC PLACES
INVENTORY -- NOMINATION FORM**

FOR NPS USE ONLY
RECEIVED **JUL 23 1980**
DATE ENTERED **SEP 17 1980**

SEE INSTRUCTIONS IN *HOW TO COMPLETE NATIONAL REGISTER FORMS*
TYPE ALL ENTRIES -- COMPLETE APPLICABLE SECTIONS

1 NAME

HISTORIC *The New Asbury Methodist Episcopal Meeting House*
AND/OR COMMON *Asbury Meeting House*

2 LOCATION

STREET & NUMBER *Shore Road (Route 9)* __NOT FOR PUBLICATION
CITY, TOWN *Cape May Court House v.c.* CONGRESSIONAL DISTRICT
Middle Township VICINITY OF *2nd*
STATE *New Jersey* CODE *034* COUNTY *Cape May* CODE *009*

3 CLASSIFICATION

CATEGORY	OWNERSHIP	STATUS	PRESENT USE
<input type="checkbox"/> DISTRICT	<input type="checkbox"/> PUBLIC	<input checked="" type="checkbox"/> OCCUPIED	<input type="checkbox"/> AGRICULTURE <input type="checkbox"/> MUSEUM
<input type="checkbox"/> BUILDING(S)	<input checked="" type="checkbox"/> PRIVATE	<input type="checkbox"/> UNOCCUPIED	<input type="checkbox"/> COMMERCIAL <input type="checkbox"/> PARK
<input checked="" type="checkbox"/> STRUCTURE	<input type="checkbox"/> BOTH	<input type="checkbox"/> WORK IN PROGRESS	<input type="checkbox"/> EDUCATIONAL <input type="checkbox"/> PRIVATE RESIDENCE
<input type="checkbox"/> SITE	PUBLIC ACQUISITION	ACCESSIBLE	<input type="checkbox"/> ENTERTAINMENT <input checked="" type="checkbox"/> RELIGIOUS
<input type="checkbox"/> OBJECT	<input type="checkbox"/> IN PROCESS	<input type="checkbox"/> YES: RESTRICTED	<input type="checkbox"/> GOVERNMENT <input type="checkbox"/> SCIENTIFIC
	<input type="checkbox"/> BEING CONSIDERED	<input checked="" type="checkbox"/> YES: UNRESTRICTED	<input type="checkbox"/> INDUSTRIAL <input type="checkbox"/> TRANSPORTATION
		<input type="checkbox"/> NO	<input type="checkbox"/> MILITARY <input type="checkbox"/> OTHER:

4 OWNER OF PROPERTY

NAME *Asbury Meeting House, Trustees and Membership*
STREET & NUMBER *Shore Road (Route 9) Swainton R.D. #1*
CITY, TOWN *Cape May Court House* VICINITY OF STATE *New Jersey*

5 LOCATION OF LEGAL DESCRIPTION

COURTHOUSE, REGISTRY OF DEEDS, ETC. *County Building, County Clerk's Office*
STREET & NUMBER *North Main Street*
CITY, TOWN *Cape May Court House* STATE *New Jersey*

6 REPRESENTATION IN EXISTING SURVEYS

TITLE *New Jersey Historic Sites Inventory*
DATE *August 28, 1979* __FEDERAL STATE COUNTY LOCAL
DEPOSITORY FOR SURVEY RECORDS *Office of Historic Preservation*
CITY, TOWN *Trenton* STATE *New Jersey*

7 DESCRIPTION

CONDITION		CHECK ONE	CHECK ONE
<input type="checkbox"/> EXCELLENT	<input type="checkbox"/> DETERIORATED	<input type="checkbox"/> UNALTERED	<input checked="" type="checkbox"/> ORIGINAL SITE
<input checked="" type="checkbox"/> GOOD	<input type="checkbox"/> RUINS	<input checked="" type="checkbox"/> ALTERED	<input type="checkbox"/> MOVED DATE _____
<input type="checkbox"/> FAIR	<input type="checkbox"/> UNEXPOSED		

DESCRIBE THE PRESENT AND ORIGINAL (IF KNOWN) PHYSICAL APPEARANCE

The Asbury Meeting House is a rectangular shape building two stories high with a loft. It has a medium gable roof covered with native cedar shingles, boxed cornice with plain return. A recessed semicircular window is under roof cornice.

The foundation is brick and stone. Siding is native cedar weather-boarding with carved pilasters on four corners of the building. There is one outside brick chimney on back of building. There are sixteen windows in the church building, all with six over six lights, with moulded window frames and a sill at each window. The original louvered shutters will be replaced on the building after they are painted. There is a double-leaf door on either side of the first floor front window, and door has two panels.

The auditorium is very pleasing to the eye. Walls are plastered above the chair rail, with side paneling below. There is random width flooring in the auditorium. The Meeting House has a center aisle. There are paneled posts in the auditorium. Two rows of pews are in the gallery. There is a panel carving on wooden enclosure in front of gallery.

Gothic style chairs upholstered in red, are on the one step raised pulpit. An altar rail is around the pulpit which has a large marble top table, serving as a Communion table. The pews are closed in on the ends and the top of the ends are carved. A chandelier hangs from the ceiling in the center of the auditorium. The light fixtures are on the side walls of the auditorium.

Entering the Meeting House via the vestibule, you will see two 4 panel doors which enter into the Church auditorium. On either end of the vestibule is a 4 panel door opening onto a stairway leading to the gallery.

There is an oil burner and pump in the basement. A wooden white picket fence with gate is in front of building. Steel access doors for the basement are at the back of building.

A cemetery surrounds the Meeting House. The cemetery has a number of aesthetic features including fine carved stones, iron enclosures and a cedar trees line in the rear.

The first church was to the northeast of the present building, within the nominated area, although the foundation has not been located.

8 SIGNIFICANCE

PERIOD	AREAS OF SIGNIFICANCE -- CHECK AND JUSTIFY BELOW			
PREHISTORIC	<input type="checkbox"/> ARCHEOLOGY-PREHISTORIC	<input type="checkbox"/> COMMUNITY PLANNING	<input type="checkbox"/> LANDSCAPE ARCHITECTURE	<input checked="" type="checkbox"/> RELIGION
.1400-1499	<input type="checkbox"/> ARCHEOLOGY-HISTORIC	<input type="checkbox"/> CONSERVATION	<input type="checkbox"/> LAW	<input type="checkbox"/> SCIENCE
.1500-1599	<input type="checkbox"/> AGRICULTURE	<input type="checkbox"/> ECONOMICS	<input type="checkbox"/> LITERATURE	<input type="checkbox"/> SCULPTURE
.1600-1699	<input checked="" type="checkbox"/> ARCHITECTURE	<input type="checkbox"/> EDUCATION	<input type="checkbox"/> MILITARY	<input type="checkbox"/> SOCIAL/HUMANITARIAN
.1700-1799	<input type="checkbox"/> ART	<input type="checkbox"/> ENGINEERING	<input type="checkbox"/> MUSIC	<input type="checkbox"/> THEATER
X .1800-1899	<input type="checkbox"/> COMMERCE	<input type="checkbox"/> EXPLORATION/SETTLEMENT	<input type="checkbox"/> PHILOSOPHY	<input type="checkbox"/> TRANSPORTATION
.1900-	<input type="checkbox"/> COMMUNICATIONS	<input type="checkbox"/> INDUSTRY	<input type="checkbox"/> POLITICS/GOVERNMENT	<input type="checkbox"/> OTHER (SPECIFY)
		<input type="checkbox"/> INVENTION		

SPECIFIC DATES

BUILDER/ARCHITECT

STATEMENT OF SIGNIFICANCE

The Asbury Meeting House architecturally is a fine surviving example of the builder vernacular architecture of the period. The structure was constructed in 1852 for \$1,700 by Daniel Hand who also built the Old Court House Building in Cape May Court House, New Jersey.

Architecture

Asbury Meeting House, built by Daniel Hand with the help of ship-builders, has the typical characteristics of a Greek Revival structure: gable roof with boxed cornice with plain return; recessed semicircular fanlight under roof cornice; carved pilasters on four corners of structure. The two double leaf front doors have an architrave.

Paneled posts in the high ceilinged auditorium. Horizontal paneling below chair rail and oyster shell walls. Molding and carving on posts below gallery shows the work of a fine craftsman.

Religion

Prior to the erection of the first church built in 1832, the Asbury congregation met in private homes for twenty years. From its beginning it had been Methodist in orientation, supplied with ministers by the Conference. Asbury today shares a minister with the United Methodist Church in Seaville and South Seaville. Asbury was first organized in 1812 and continues to function.

9 MAJOR BIBLIOGRAPHICAL REFERENCES

Dickinson, Karl A., Magazine of History & Genealogy, Cape May County Historical and Genealogical Society, 1976, Dorothea Press Printers, Wildwood, NJ 08260, Page 325.

Townsend, Everett B., Jr., The New Asbury Meeting House - History of the Church, September 15, 1977.

Post, Edward M., "Early Days of Asbury Church ...", Cape May County Gazette, October 21, 1932.

10 GEOGRAPHICAL DATA

ACREAGE NOT VERIFIED

ACREAGE OF NOMINATED PROPERTY 8

QUADRANGLE NAME Woodbine

UTM NOT VERIFIED

QUADRANGLE SCALE 1,24000

UTM REFERENCES

A 1,8 5,1,9,9,3,0 4,3,3,2,1,5,0
 ZONE EASTING NORTHING

B
 ZONE EASTING NORTHING

C

D

E

F

G

H

VERBAL BOUNDARY DESCRIPTION

Block 11, Lot 11 - Middle Township Tax Map (See Continuation Sheet)

LIST ALL STATES AND COUNTIES FOR PROPERTIES OVERLAPPING STATE OR COUNTY BOUNDARIES

STATE	CODE	COUNTY	CODE

11 FORM PREPARED BY

NAME/TITLE Elwood R. Jarmer, Director
Jane Dixon, Survey Coordinator

Edited by Terry Karschner,
 Office of Historic Preservation

ORGANIZATION Cape May County Planning Board

DATE 8/28/79

STREET & NUMBER County Library-Office Building, Mechanic Street

TELEPHONE (609) 465-7111

CITY OR TOWN Cape May Court House

STATE New Jersey

12 STATE HISTORIC PRESERVATION OFFICER CERTIFICATION

THE EVALUATED SIGNIFICANCE OF THIS PROPERTY WITHIN THE STATE IS:

NATIONAL STATE LOCAL X

As the designated State Historic Preservation Officer for the National Historic Preservation Act of 1966 (Public Law 89-665), I hereby nominate this property for inclusion in the National Register and certify that it has been evaluated according to the criteria and procedures set forth by the National Park Service.

Deputy [Signature]
 STATE HISTORIC PRESERVATION OFFICER SIGNATURE

4-18-80

TITLE Deputy Commissioner, Dept. of Environmental Protection

DATE

FOR NPS USE ONLY	
I HEREBY CERTIFY THAT THIS PROPERTY IS INCLUDED IN THE NATIONAL REGISTER	
<u>[Signature]</u> KEEPER OF THE NATIONAL REGISTER	DATE <u>9/17/80</u>
ATTEST: <u>[Signature]</u> CHIEF OF REGISTRATION	DATE <u>9/17/80</u>

UNITED STATES DEPARTMENT OF THE INTERIOR
HERITAGE CONSERVATION AND RECREATION SERVICE

**NATIONAL REGISTER OF HISTORIC PLACES
INVENTORY -- NOMINATION FORM**

FOR HCRS USE ONLY	
RECEIVED	JUL 23 1980
DATE ENTERED	SEP 17 1980

CONTINUATION SHEET Geographical Data ITEM NUMBER 10 PAGE 1

Verbal Boundary Description

BEGINNING at the Southeast corner of Block 11, Lot 11 proceed Northwest along said property to Block 11, Lot 13. Thence, proceed Northeast along the line of Block 11, Lot 13 to its Northeast corner and project a line to Block 11, Lot 9. Thence, proceed South along said property to the Southwest corner. Thence, proceed Southeast along Block 11, Lot 11 property line to Route 9. Thence, proceed Southwest along Route 9 to point of beginning.

TRUE NORTH
MAGNETIC NORTH

RECORDS DEPARTMENT OF THE TREASURY
APPROVED AS A TAX MAP PURSUANT TO
PROVISIONS OF CHAPTER 179 LAWS OF 1913
C. C. ...
DATE: NOV 10 1958

SHEET B-5

New Asbury Methodist Meetinghouse
Middle Township
Cape May County, New Jersey
JUL 23 1980

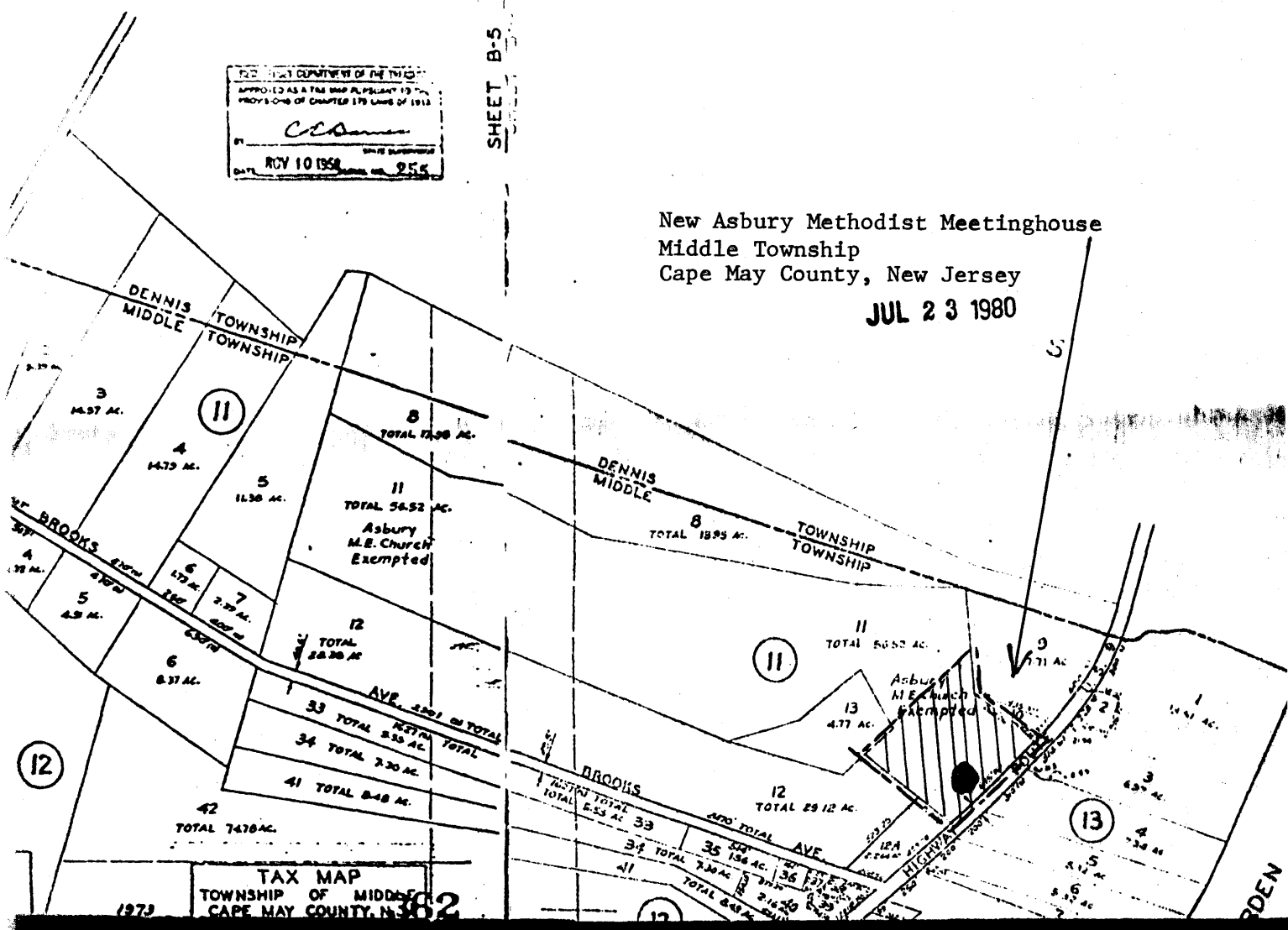

1973 TAX MAP TOWNSHIP OF MIDDLE CAPE MAY COUNTY, N.J. 382