

United States Department of the Interior
National Park Service

National Register of Historic Places
Inventory—Nomination Form

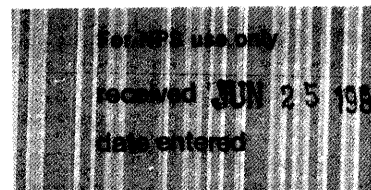

See instructions in *How to Complete National Register Forms*
Type all entries—complete applicable sections

1. Name

historic Calliham Plantation House

~~historic~~ common Callico

2. Location

street & number Old Highway 1 in Hamburg N/A not for publication

city, town Hamburg N/A vicinity of congressional district

state LA code 22 county Avoyelles Parish code 009

3. Classification

Category	Ownership	Status	Present Use
<input type="checkbox"/> district	<input type="checkbox"/> public	<input checked="" type="checkbox"/> occupied	<input type="checkbox"/> agriculture <input type="checkbox"/> museum
<input checked="" type="checkbox"/> building(s)	<input checked="" type="checkbox"/> private	<input type="checkbox"/> unoccupied	<input type="checkbox"/> commercial <input type="checkbox"/> park
<input type="checkbox"/> structure	<input type="checkbox"/> both	<input type="checkbox"/> work in progress	<input type="checkbox"/> educational <input checked="" type="checkbox"/> private residence
<input type="checkbox"/> site	Public Acquisition	Accessible	<input type="checkbox"/> entertainment <input type="checkbox"/> religious
<input type="checkbox"/> object	N/A in process	<input checked="" type="checkbox"/> yes: restricted	<input type="checkbox"/> government <input type="checkbox"/> scientific
	N/A being considered	<input type="checkbox"/> yes: unrestricted	<input type="checkbox"/> industrial <input type="checkbox"/> transportation
		<input type="checkbox"/> no	<input type="checkbox"/> military <input type="checkbox"/> other:

4. Owner of Property

name Mr. and Mrs. Herbert Simeon Coco

street & number P. O. Box 1

city, town Hamburg N/A vicinity of state LA 71339

5. Location of Legal Description

courthouse, registry of deeds, etc. Avoyelles Parish Courthouse

street & number Main Street (no specific address) no specific mailing address

city, town Marksville state LA 71351

6. Representation in Existing Surveys

title LA Historic Sites Survey has this property been determined eligible? yes no

date 1980 federal state county local

depository for survey records Louisiana State Historic Preservation Office

city, town Baton Rouge state LA

7. Description

Condition		Check one	Check one	
<input type="checkbox"/> excellent	<input type="checkbox"/> deteriorated	<input type="checkbox"/> unaltered	<input checked="" type="checkbox"/> original site	
<input checked="" type="checkbox"/> good	<input type="checkbox"/> ruins	<input checked="" type="checkbox"/> altered	<input type="checkbox"/> moved	date <u> N/A </u>
<input type="checkbox"/> fair	<input type="checkbox"/> unexposed			

Describe the present and original (if known) physical appearance

Calliham Plantation House (1841) is a relatively large, 1 1/2 story, Greek Revival residence. It is located between Bayou des Glaises and the Kansas City Southern Railroad tracks in the center of the tiny community of Hamburg. The surrounding land is flat, and the setting is essentially rural. The house has undergone a number of changes, but none of them is severe enough to jeopardize its architectural significance.

The house began in 1841 as a 1 1/2 story raised cottage with a central hall, double parlor plan. It is unusually large with a central hall as wide as the parlors. The wide roof permits a full three dormers rather than the usual 1 or 2. The two front rooms have massive exterior chimneys. The house is constructed with hewn sills with pit sawn joists and studs. Massive and simple, the house is articulated with six front gallery posts which have flat block capitals. The balustrade is composed of plain rails and the fenestration has plain bevel faced moldings. At the front and rear of the hall are sets of folding doors. The front set has a 12 foot wide transom and two sets of side lights. The original floor boards are still extant under the carpeting and two original aedicule mantels with denticular cornices still remain in the garret.

In the late nineteenth century the following changes were made:

- (1) A pair of small side galleries was built (one of which has been filled in).
- (2) Several of the old double panel doors were replaced with raised panel doors.
- (3) The 3 front doors were replaced with plate glass doors.
- (4) A two flight staircase, reflecting the Queen Anne influence, was installed at the side of the hall.

In the twentieth century a rear kitchen/dining room wing was built, two ground floor mantels were removed, bathrooms were installed on the side galleries, and two rooms were covered in plywood paneling.

Integrity:

Calliham is architecturally significant for its size and plan, its three dormer roofline, its wide transom, and its exterior Greek Revival details, all of which remain intact. The kitchen/dining room addition mentioned above was made unobtrusively to the rear. Moreover, the loss of the two ground story mantels, though unfortunate, is only minor when compared to the total scope of the house's architecture.

8. Significance

Period	Areas of Significance—Check and justify below			
<input type="checkbox"/> prehistoric	<input type="checkbox"/> archeology-prehistoric	<input type="checkbox"/> community planning	<input type="checkbox"/> landscape architecture	<input type="checkbox"/> religion
<input type="checkbox"/> 1400–1499	<input type="checkbox"/> archeology-historic	<input type="checkbox"/> conservation	<input type="checkbox"/> law	<input type="checkbox"/> science
<input type="checkbox"/> 1500–1599	<input type="checkbox"/> agriculture	<input type="checkbox"/> economics	<input type="checkbox"/> literature	<input type="checkbox"/> sculpture
<input type="checkbox"/> 1600–1699	<input checked="" type="checkbox"/> architecture	<input type="checkbox"/> education	<input type="checkbox"/> military	<input type="checkbox"/> social/
<input type="checkbox"/> 1700–1799	<input type="checkbox"/> art	<input type="checkbox"/> engineering	<input type="checkbox"/> music	<input type="checkbox"/> humanitarian
<input checked="" type="checkbox"/> 1800–1899	<input type="checkbox"/> commerce	<input type="checkbox"/> exploration/settlement	<input type="checkbox"/> philosophy	<input type="checkbox"/> theater
<input type="checkbox"/> 1900–	<input type="checkbox"/> communications	<input type="checkbox"/> industry	<input type="checkbox"/> politics/government	<input type="checkbox"/> transportation
		<input type="checkbox"/> invention		<input type="checkbox"/> other (specify)

Specific dates 1841 **Builder/Architect** Builder: James Calliham

Statement of Significance (in one paragraph) Criterion C

Calliham Plantation House ("Callico") is significant on the local level in the area of architecture as an important example of a Greek Revival raised plantation house. It is a superior example within the context of Avoyelles Parish and the only example within the context of the small village of Hamburg.

Despite the changes mentioned in Item 7, certain very significant features remain. Among these are the unusually wide hall, the 3 dormers, the roofline which is far more graceful than the customary roofline with 1 or 2 dormers, and the folding doors with what is easily the widest Greek Revival transom in Avoyelles Parish. In addition, the simple classical pillared facade exemplifies the provincial Greek Revival in Louisiana.

The 1 1/2 story Greek Revival raised plantation house is a type which was once common, but is now rapidly disappearing. The local historic value of even ordinary examples of this type is well established. However, Calliham Plantation House is more than just an ordinary example because of its hall, its wide transomed doorway, and its roofline. It stands, therefore, as one of the most important examples within the context of a large rural parish.

In addition to being significant on the parish level, Calliham Plantation House is the largest and grandest house in the small village of Hamburg (population of approximately 500). It is also Hamburg's only pre-Civil War raised cottage.

Relationship of Integrity to Significance: See Item 7 Also

9. Major Bibliographical References

Title Search, Avoyelles Parish Courthouse.

Research Report Prepared by Wayne L. Coco, Architect. Located in Calliham Plantation House National Register file, Louisiana State Historic Preservation Office.

10. Geographical Data

Acreeage of nominated property @1.7 acres

Quadrangle name Moreauville, LA

Quadrangle scale 1:62,500

UMT References

A 1 5 | 6 0 2 0 8 0 | 3 4 3 2 8 2 5
Zone Easting Northing

B | | | | | | | | | | | | | | | |
Zone Easting Northing

C | | | | | | | | | | | | | | | |

D | | | | | | | | | | | | | | | |

E | | | | | | | | | | | | | | | |

F | | | | | | | | | | | | | | | |

G | | | | | | | | | | | | | | | |

H | | | | | | | | | | | | | | | |

Verbal boundary description and justification

See attached sketch map.

List all states and counties for properties overlapping state or county boundaries

state N/A code county code

state code county code

11. Form Prepared By

name/title Mrs. Marilyn Coco (Mrs. Herbert S. Coco)

organization N/A

date December 1980

street & number P. O. Box 1

telephone 318-985-2525

city or town Hamburg

state LA 71339

12. State Historic Preservation Officer Certification

The evaluated significance of this property within the state is:

___ national ___ state X local

As the designated State Historic Preservation Officer for the National Historic Preservation Act of 1966 (Public Law 89-665), I hereby nominate this property for inclusion in the National Register and certify that it has been evaluated according to the criteria and procedures set forth by the National Park Service.

State Historic Preservation Officer signature

Robert B. DeBlieux
Robert B. DeBlieux

title State Historic Preservation Officer

date June 16, 1982

For NPS use only

I hereby certify that this property is included in the National Register

*Beth G...
Keeper of the National Register*

7/20/82
date

Attest:

Chief of Registration

Calliham Plantation House

Avoyelles Parish, LA

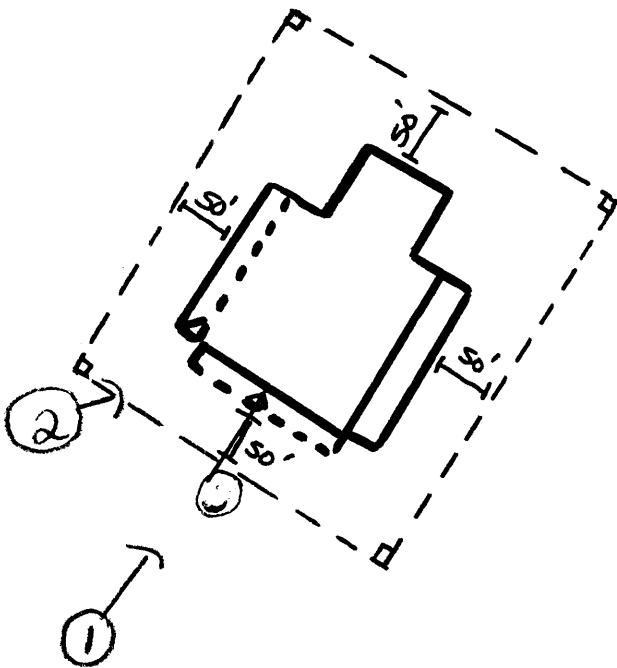
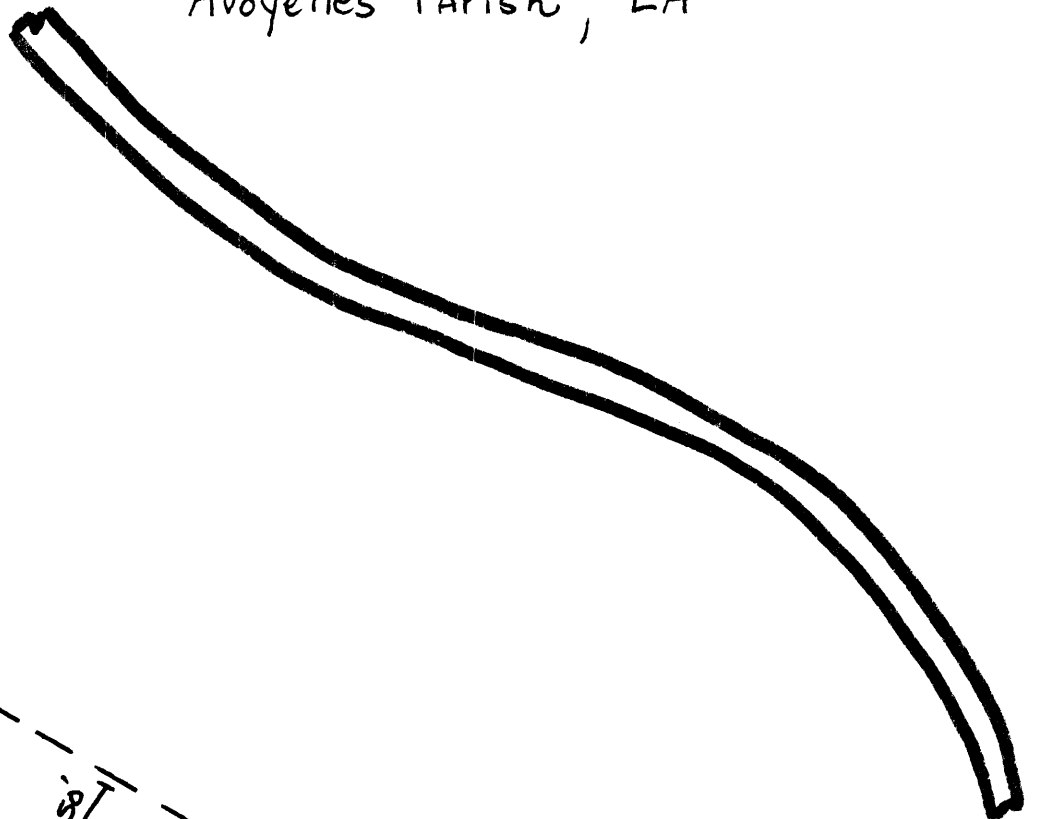

NOTE: SITE BOUNDARIES PARALLEL
BLDG. FALADES AT DISTANCES
SHOWN.



SCALE $\frac{3}{4}'' = 100'$ APPROX.

Old La. Highway 1