

1330

FORM B - BUILDING

AUG 07 1989

MASSACHUSETTS HISTORICAL COMMISSION
80 BOYLSTON STREET
BOSTON, MA 02116

<u>AREA</u>	<u>FORM NO.</u>
	287

Town Quincy, MA / MRA

Address 25 Elm Street

Historic Name Dr. Frank Davis House

Use: Present Two family dwelling

Original Single family dwelling

Photo (3"x3" or 3"x5", black and white) Indicate address of property on back of photo. Staple to left side of form.

DESCRIPTION

Date ca. 1890s

Source Map and directory research

Style Shingle Style

Architect unknown

Exterior Wall Fabric wood clapboards, shingle

Outbuildings Carriage house (1890s) converted to a garage (1950s) - C

Major Alterations (with dates) _____

House-none; Carriage House-see above (1950s)

Condition Good

Moved no Date na

Acreage less than one acre: 8090 sq. ft.

Setting The house is situated on a corner lot across from Christ Church on Elm Street near the central business district.

Sketch Map: Draw map showing property's location in relation to nearest cross streets and/or geographical features. Indicate all buildings between inventoried property and nearest intersection(s). Indicate north

UTM REFERENCE 19/335,070 E/4,678,880 N

USGS QUADRANGLE Weymouth, MA

SCALE 1: 25,000

Recorded by Fannin & Lehner/ J. Johnson

Organization Quincy Historical Commission

Date July 1, 1986/ May 1987

NATIONAL REGISTER CRITERIA STATEMENT (if applicable)

The Frank S. Davis House retains integrity of design, location, materials, feeling and association. A well-preserved example of a comfortable Shingle Style residence, the house fulfills Criteria A and C of the National Register of Historic Places on the local level.

ARCHITECTURAL SIGNIFICANCE Describe important architectural features and evaluate in terms of other buildings within the community.

SEE INVENTORY CONTINUATION SHEET

HISTORICAL SIGNIFICANCE Explain the role owners played in local or state history and how the building relates to the development of the community.

SEE INVENTORY FORM CONTINUATION SHEET

BIBLIOGRAPHY and/or REFERENCES

Assessors Records.
Building permits, alterations.
Quincy Patriot Ledger, Souvenir Edition, 1899, p. 78.

INVENTORY FORM CONTINUATION SHEET

MASSACHUSETTS HISTORICAL COMMISSION
Office of the Secretary, Boston

Community: QUINCY, MA	Form No: 287
Property Name: Dr. Frank Davis Hse.	

Indicate each item on inventory form which is being continued below.

HISTORICAL SIGNIFICANCE -- 25 ELM STREET
DR. FRANK DAVIS HOUSE

This fine Shingle Style house was built by Frank S. Davis in the 1890s. Frank S. Davis, a physician at the Quincy City Hospital, took advantage of the convenient proximity of the site to Quincy Center to establish both his office and residence in the house. Davis, who graduated from the medical school of Boston University, opened his practice in Quincy in 1879. In 1922, another physician, Cornelius Lynch, had purchased the property.

Staple to Inventory form at bottom

INVENTORY FORM CONTINUATION SHEET

MASSACHUSETTS HISTORICAL COMMISSION
Office of the Secretary, Boston

Community: Quincy, MA	Form No: 287
Property Name: Dr. Frank Davis Hse	

Indicate each item on inventory form which is being continued below.

ARCHITECTURAL SIGNIFICANCE -- 25 ELM STREET
DR. FRANK DAVIS HOUSE

25 Elm Street is among the best preserved examples of the Shingle Style in Quincy. Characteristic of the style is the continuous sheathing of decorative shingles which create an unbroken "skin" on the building's exterior. The dominant sweeping gable contains the recessed entrance and shallow bay window within it. Rare in Quincy, a clapboarded carriage house, original to the house, remains on the property. Although its door was altered to accommodate automobiles in the 1920, the building is essentially intact and contributes to the integrity of the site.

Staple to Inventory form at bottom

United States Department of the Interior
National Park Service

AUG 7 1989

National Register of Historic Places
Continuation Sheet

Section number _____ Page _____

Multiple Resource Area
Thematic Group

Name Quincy MRA
State Norfolk County, MASSACHUSETTS

Nomination/Type of Review		Date/Signature
21. Curtis, Noah, House	Entered in the National Register	for Keeper <u>Helene Byers</u> 9/20/89 Attest _____
22. Curtis, Thomas, House	Entered in the National Register	for Keeper <u>Helene Byers</u> 9/20/89 Attest _____
23. Davis, Dr. Frank, House	Entered in the National Register	for Keeper <u>Helene Byers</u> 9/20/89 Attest _____
24. Dicey, Russell M., House	Entered in the National Register	for Keeper <u>Helene Byers</u> 9/20/89 Attest _____
25. Dogget, Solon, House	Entered in the National Register	for Keeper <u>Helene Byers</u> 9/20/89 Attest _____
26. Dorothy Q Apartments	Entered in the National Register	for Keeper <u>Helene Byers</u> 9/20/89 Attest _____
27. Elks Building	Entered in the National Register	for Keeper <u>Helene Byers</u> 9/20/89 Attest _____
28. Faxon House	Entered in the National Register	for Keeper <u>Helene Byers</u> 9/20/89 Attest _____
29. First Baptist Church of Wollaston	Entered in the National Register	for Keeper <u>Helene Byers</u> 9/20/89 Attest _____
30. Fore River Club House	Entered in the National Register	for Keeper <u>Helene Byers</u> 9/20/89 Attest _____

UNITED STATES DEPARTMENT OF THE INTERIOR
NATIONAL PARK SERVICE

NATIONAL REGISTER OF HISTORIC PLACES
EVALUATION/RETURN SHEET

REQUESTED ACTION: NOMINATION

PROPERTY NAME: Davis, Dr. Frank, House

MULTIPLE NAME: Quincy MRA

STATE & COUNTY: MASSACHUSETTS, Norfolk

DATE RECEIVED: 8/07/89 DATE OF PENDING LIST: 8/22/89
DATE OF 16TH DAY: 9/07/89 DATE OF 45TH DAY: 9/21/89
DATE OF WEEKLY LIST:

REFERENCE NUMBER: 89001330

NOMINATOR: STATE

REASONS FOR REVIEW:

APPEAL: N DATA PROBLEM: N LANDSCAPE: N LESS THAN 50 YEARS: N
OTHER: N PDIL: N PERIOD: N PROGRAM UNAPPROVED: N
REQUEST: N SAMPLE: N SLR DRAFT: N NATIONAL: N

COMMENT WAIVER: N

ACCEPT RETURN REJECT 9/20/89 DATE Entered in the
National Register

ABSTRACT/SUMMARY COMMENTS:

RECOM./CRITERIA _____
REVIEWER _____
DISCIPLINE _____
DATE _____

DOCUMENTATION see attached comments Y/N see attached SLR Y/N

CLASSIFICATION

count resource type

STATE/FEDERAL AGENCY CERTIFICATION

FUNCTION

historic current

DESCRIPTION

architectural classification
 materials
 descriptive text

SIGNIFICANCE

Period Areas of Significance--Check and justify below

Specific dates Builder/Architect
Statement of Significance (in one paragraph)

summary paragraph
 completeness
 clarity
 applicable criteria
 justification of areas checked
 relating significance to the resource
 context
 relationship of integrity to significance
 justification of exception
 other

BIBLIOGRAPHY

GEOGRAPHICAL DATA

acreage verbal boundary description
 UTM's boundary justification

ACCOMPANYING DOCUMENTATION/PRESENTATION

sketch maps USGS maps photographs presentation

OTHER COMMENTS

Questions concerning this nomination may be directed to

_____ Phone _____

Signed _____ Date _____



25 Elm St. Street

Dr. Frank Davis House

by: Julie Johnson

at: Planning Dept. - Quincey

date: July 1987

view: South

pic#: 287

287
Quincey, Mass.
MA



25 Elm St. House/Garage

Dr. Frank Davis House

-CARRIAGE HOUSE / GARAGE

by: Julie Johnston

date: July 1987

at: Planning Dept.

view: south

pic #: 287

Quincy, Mass.

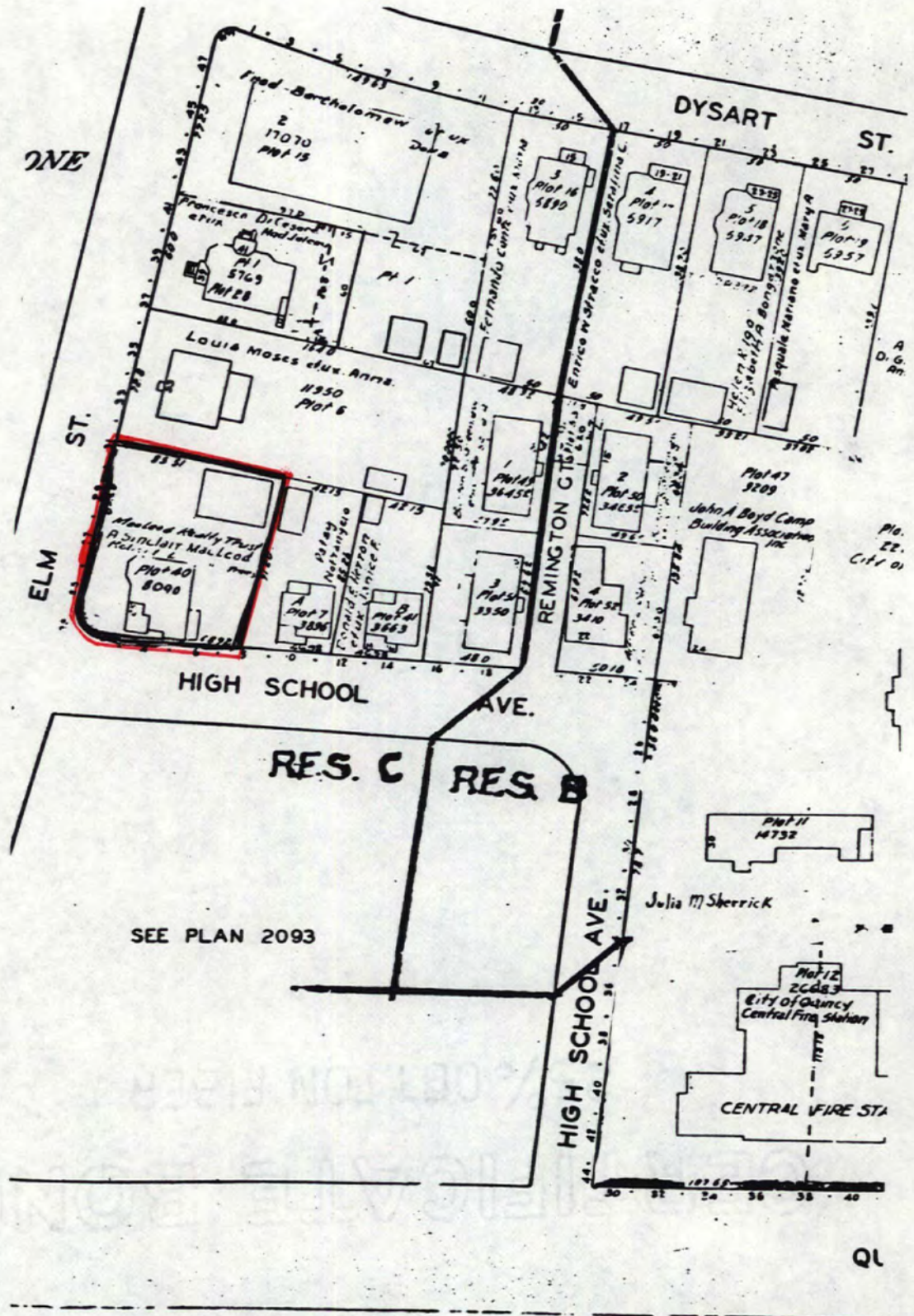

Address 25 Elm Street

QUINCY, MASSACHUSETTS / MRA

Assessors Map # 2092

1979

Scale: 1 inch equals 80 feet

QL

Please refer to the map in the
Multiple Property Cover Sheet
for this property

Multiple Property Cover Sheet Reference Number: 64000289