

410



United States Department of the Interior  
National Park Service

# National Register of Historic Places Registration Form

This form is for use in nominating or requesting determinations for individual properties and districts. See instructions in National Register Bulletin, How to Complete the National Register of Historic Places Registration Form. If any item does not apply to the property being documented, enter "N/A" for "not applicable." For functions, architectural classification, materials, and areas of significance, enter only categories and subcategories from the instructions. Place additional certification comments, entries, and narrative items on continuation sheets if needed (NPS Form 10-900a).

### 1. Name of Property

historic name Hilmoe, Hans J. Barn  
other names/site number Berg, Charles E. Barn

### 2. Location

street & number 47170 Homestead Street  not for publication  
city or town Baltic  vicinity  
state South Dakota code SD county Minnehaha code 099 zip code 57003

### 3. State/Federal Agency Certification

As the designated authority under the National Historic Preservation Act, as amended,

I hereby certify that this  nomination \_\_\_ request for determination of eligibility meets the documentation standards for registering properties in the National Register of Historic Places and meets the procedural and professional requirements set forth in 36 CFR Part 60.

In my opinion, the property  meets \_\_\_ does not meet the National Register Criteria. I recommend that this property be considered significant at the following level(s) of significance:

national  statewide  local

Jay D. Vogt 05-10-2010  
Signature of certifying official Date  
SD SHPO  
Title State or Federal agency/bureau or Tribal Government

In my opinion, the property \_\_\_ meets \_\_\_ does not meet the National Register criteria.

\_\_\_\_\_  
Signature of commenting official Date  
\_\_\_\_\_  
Title State or Federal agency/bureau or Tribal Government

### 4. National Park Service Certification

I, hereby, certify that this property is:

- entered in the National Register  determined eligible for the National Register
- determined not eligible for the National Register  removed from the National Register
- other (explain:)

for Eileen H. Beall 6-28-10  
Signature of the Keeper Date of Action

**5. Classification**

**Ownership of Property**  
(Check as many boxes as apply)

**Category of Property**  
(Check only **one** box)

**Number of Resources within Property**  
(Do not include previously listed resources in the count.)

- private
- public - Local
- public - State
- public - Federal

- building(s)
- district
- site
- structure
- object

Contributing	Noncontributing	
1	0	buildings
0	0	district
0	0	site
0	0	structure
0	0	object
1	0	<b>Total</b>

**Name of related multiple property listing**  
(Enter "N/A" if property is not part of a multiple property listing)

N/A

**Number of contributing resources previously listed in the National Register**

N/A

**6. Function or Use**

**Historic Functions**  
(Enter categories from instructions)

AGRICULTURAL/SUBSISTENCE: Animal Facility  
AGRICULTURAL/SUBSISTENCE: Storage

**Current Functions**  
(Enter categories from instructions)

AGRICULTURAL/SUBSISTENCE: Storage

**7. Description**

**Architectural Classification**  
(Enter categories from instructions)

OTHER: Bank Barn

**Materials**  
(Enter categories from instructions)

foundation: STONE: Quartzite

walls: WOOD: Weatherboard

roof: WOOD: Shake

other:

---

## **Narrative Description**

(Describe the historic and current physical appearance of the property. Explain contributing and noncontributing resources if necessary. Begin with a **summary paragraph** that briefly describes the general characteristics of the property, such as its location, setting, size, and significant features.)

### **Summary Paragraph**

The Hilmoe Barn is located approximately two and a half miles west of the town of Baltic, in northern Minnehaha County, South Dakota. The barn sits about a quarter mile from Interstate 29, and is clearly visible from that major thoroughfare. The barn was constructed in 1911 by the Hilmoe family, who immigrated from Norway in the early 1880s. The farm property consists of a farmhouse, located east of the barn, and a number of outbuildings, none of which retain sufficient integrity to be considered for listing on the National Register of Historic Places.

The barn has a rectangular plan measuring thirty-eight feet wide by fifty-six feet long at a height of twenty-eight feet from the foundation to the roof peak. It has a gambrel roof and lapped siding, and is framed with two by six timbers. The barn was constructed into a bank on the north side. The foundation is made of Sioux Quartzite stone hauled from a local quarry that is neatly cut and laid. The gambrel-roofed bank barn retains its historic cedar shake roof. A centrally located wooden cupola exists on the barn as well.

---

## **Narrative Description**

The Hilmoe Barn is located approximately two and a half miles west of the town of Baltic, in northern Minnehaha County, South Dakota. The barn sits about a quarter mile from Interstate 29, and is clearly visible from that major thoroughfare. The barn was constructed in 1911 by the Hilmoe family, who immigrated from Norway in the early 1880s. The larger farm property consists of a farmhouse, located east of the barn, a granary, a hog house, and two other outbuildings, none of which retain sufficient integrity to be considered for listing on the National Register of Historic Places. The thirty-five acre farm property extends to Interstate 29 to the west.

The barn has a rectangular plan measuring fifty-six feet long by thirty-eight feet wide. The barn is twenty-eight feet tall at its tallest point. It has a gambrel roof and is framed with two by six timbers. The barn was constructed into a bank on the north side. The foundation is made of Sioux quartzite stone hauled from a local quarry that is neatly cut and laid. The gambrel-roofed bank barn retains its historic cedar shake roof. A centrally located wooden cupola exists on the barn as well. The roof of the barn has modestly overhanging eaves. The barn has lapboard siding.

The most prominent feature on the east elevation of the barn is the large, sliding haymow door in the gambrel end. A triangular extension hay hood exists on the gambrel peak of the east side of the barn. This extension serves to protect the pulley mechanism, used to pull hay into the hayloft, from severe weather. The bank slopes downward from right to left when facing the east side of the barn. The south elevation of the barn features three openings, each framed in wood. Since this side of the

barn is at the bottom of the bank, these openings are the only entrances into the lower level of the barn. The west elevation of the barn features two symmetrical two over two double hung wood windows in the gambrel end, and two additional square window openings in the lower level. The bank slopes downward from north to south, and the north side of the barn is dug into the side of the bank. Two large sliding doors exist on the north side of the barn, providing access to the hayloft.

The interior lower level of the barn consists of two wooden stalls, each around ten feet wide by ten feet long. Each of these stalls has a wooden gate. Aside from these two stalls, the lower level of the barn remains open. A metal track on the ceiling used for transporting hay extends from one side of the barn to the other, and there is a trapdoor in the ceiling of the lower level that leads to the hayloft area. Workers would drop hay through the trapdoor into a canvas bag that was tied to a wheel and attached to the metal transport track. Hay could thus be easily transported to all areas of the lower level of the bank barn by moving the bag along the metal track.

The hayloft of the barn is primarily accessed from the large sliding door on the north side of the barn. The hayloft largely consists of open area, and the heavy timber bents are a prominent feature of the hayloft. This post and beam roof support system is necessary because of the height and size of the roof of the structure; a light truss system would not offer adequate stability for a structure of this size and height. The large gambrel roof is thus supported by heavy four by four vertical bents, spaced about eight feet apart. Principle rafters run horizontally across the barn, and knee braces that connect them to the primary bents provide additional support for the structure. Collar ties exist above the rafters, providing additional support and stability for the roof system. Knee braces also exist between the vertical bents and the roof ridge beam. An interior balcony exists on the west side gambrel end of the barn; one would control the large sliding haymow door on the east side of the barn from this balcony using a pulley system to raise or lower the door.

**8. Statement of Significance**

**Applicable National Register Criteria**

(Mark "x" in one or more boxes for the criteria qualifying the property for National Register listing)

- A Property is associated with events that have made a significant contribution to the broad patterns of our history.
- B Property is associated with the lives of persons significant in our past.
- C Property embodies the distinctive characteristics of a type, period, or method of construction or represents the work of a master, or possesses high artistic values, or represents a significant and distinguishable entity whose components lack individual distinction.
- D Property has yielded, or is likely to yield, information important in prehistory or history.

**Areas of Significance**

(Enter categories from instructions)

AGRICULTURE \_\_\_\_\_  
 ARCHITECTURE \_\_\_\_\_  
 \_\_\_\_\_  
 \_\_\_\_\_  
 \_\_\_\_\_

**Period of Significance**

1911 \_\_\_\_\_  
 \_\_\_\_\_

**Significant Dates**

1911 \_\_\_\_\_  
 \_\_\_\_\_  
 \_\_\_\_\_

**Significant Person**

(Complete only if Criterion B is marked above)

\_\_\_\_\_

**Cultural Affiliation**

\_\_\_\_\_  
 \_\_\_\_\_

**Architect/Builder**

Hans J. Hilmoe (builder) \_\_\_\_\_  
 \_\_\_\_\_  
 \_\_\_\_\_

**Criteria Considerations**

(Mark "x" in all the boxes that apply)

Property is:

- A Owned by a religious institution or used for religious purposes.
- B removed from its original location.
- C a birthplace or grave.
- D a cemetery.
- E a reconstructed building, object, or structure.
- F a commemorative property.
- G less than 50 years old or achieving significance within the past 50 years.

**Period of Significance (justification)**

The period of significance is the construction date of the barn.

**Criteria Considerations (explanation, if necessary)**

**Statement of Significance Summary Paragraph** (provide a summary paragraph that includes level of significance and applicable criteria)

The Hilmoe Barn is eligible for the National Register of Historic Places under Criterion A as a centerpiece of an early Minnehaha County farmstead, representing the important role of the barn on early farms in Southeastern South Dakota and Criterion C as a fine example of a bank barn constructed in rural Minnehaha County during the early twentieth century. The sidehill orientation, quartzite foundation, wood clapboard siding, wood shingles, and interior layout represent the distinctive characteristics of locally built bank barns in Minnehaha and neighboring counties.

---

**Narrative Statement of Significance** (provide at least **one** paragraph for each area of significance)

The Hilmoe Barn is eligible for the National Register of Historic Places under Criterion A as a centerpiece of an early Minnehaha County farmstead, representing the important role of the barn on early farms in Southeastern South Dakota and Criterion C as a fine example of a bank barn constructed in rural Minnehaha County during the early twentieth century. During the late nineteenth century and early twentieth century, farmers experimented with new barn forms and features, attempting to enclose the maximum amount of space at the lowest possible cost and attain the highest degree of efficiency. The bank feature was one method of construction some farmers used to increase efficiency by allowing them easy access to both levels of the barn.<sup>1</sup> Bank barns are thus identified by construction into the side of a hill allowing for access to both floors of the barn. The lower level of bank barns generally housed horses or cattle while the loft area of the upper level was used to store hay.<sup>2</sup>

While several other buildings do exist on the farm, only the barn is included in this nomination. Most of the other buildings on the farm are either of modern construction or are historic buildings that no longer retain their integrity. Only the barn retains sufficient integrity to convey its historic significance. Therefore, the barn is being nominated individually under Criteria A and C as a significant, distinctive example of bank barn architecture in South Dakota built during the early twentieth century.

---

<sup>1</sup> David Erpestad and David Wood, *Building South Dakota: A Historical Survey of the State's Architecture to 1945* (Pierre: South Dakota State Historical Society Press, 1997), 101.

<sup>2</sup> Allen G. Noble and Richard K. Cleek, *The Old Barn Book* (New Jersey: Rutgers University Press), 33-34, 79-80.

---

**Developmental history/additional historic context information** (if appropriate)

**Historical Background of Minnehaha County**

Minnehaha County is located north of Lincoln County, and just east of the Minnesota border. The majority of the county consists of undulating or rolling prairie, and deep, rich, fertile soil. The name "Minnehaha" is the Sioux word for "waterfall," fitting since Minnehaha County is the most watered county in South Dakota. The county consists of many small lakes that form creeks, which eventually enter into the Big Sioux River. There is a considerable amount of native timber in the area as well, including maple, box elder, cottonwood, elm, and many evergreens.<sup>3</sup>

One of the peculiarities of this region of South Dakota is that outcroppings of Sioux quartzite appear in large quantities, particularly along the Big Sioux River. This stone varies in color from light grey to all shades of pink and purple and is a fine building stone, because although it is a hard rock, it can be cut into blocks of any size. Because of its fine building properties and availability in large quantities, Sioux quartzite appears on many buildings in Minnehaha County.<sup>4</sup>

The land now within the boundaries of Minnehaha County was settled by whites in 1856, when Dr. J.M. Staples of Dubuque, Iowa obtained documentation that described some waterfalls on the Big Sioux River to the north. The doctor formed the Western Land Company, which promptly set out to find these fascinating falls and to lay claim to the area. In October of 1856, the party set out and soon found the falls, and laid claim to around 320 acres of land in the area.<sup>5</sup> Settlers soon realized that the soil was fertile, and by 1860, a number of farmers had begun staking their claims in the area. Agricultural production thus took hold early in the settlement history of the region.

**Agricultural Context**

Varying amounts of rainfall resulted in differing types of agriculture developing east of the Missouri River compared to the western part of the state. Large scale sheep and cattle ranches emerged in the dryer western region of South Dakota while smaller farms focused on crops like wheat, corn, and oats as well as dairying developed in eastern South Dakota. Diverse farming occurs in Minnehaha County, but the predominant crops are corn and wheat. Smaller scale stock raising and dairying are also common in the county. The types of resources constructed characterized these different types of agriculture, with the more diversified east-river farms needing more facilities for animal, grain, and equipment storage than the west-river ranches.<sup>6</sup>

From 1905 through World War I, agriculture in South Dakota thrived as a result of favorable economic and environmental conditions. Farmers took the opportunity during this period to expand their operations, including constructing new or adding to existing outbuildings. Many barns were subsequently constructed during this period, but new agricultural construction tailed off after World

---

<sup>3</sup> Donald Dean Parker, *History of Our County and State: Minnehaha County* (Brookings: South Dakota State College, 1960), 57-M.

<sup>4</sup> Robert C. Vogel, *Barns of Southeastern South Dakota Survey* (Pierre: South Dakota State Historic Preservation Office, 2005), 25.

<sup>5</sup> Parker, *History of Our County and State: Minnehaha County*, 63-M.

<sup>6</sup> Erpestad and Wood, *Building South Dakota*, 98.

War I, when the prices of agricultural commodities collapsed leading into the Great Depression. Thus, many of the historic barns that still exist in South Dakota were constructed between 1905 and 1921, reflective of that period of favorable agricultural conditions.<sup>7</sup>

Traditionally, farmers constructed post-and-beam barns using large timber bents. During the early 20<sup>th</sup> Century, however, this technique became less and less feasible due to diminishing lumber supplies and increasing costs to transport heavy timber. Thus, farmers began to use dimensional lumber rather than heavy timber for barn construction. Farmers had two basic options for acquiring the necessary dimensional lumber for their barns; they could visit the local lumber yard, and pay the going rate for whatever grade of lumber the mill had available, or they could purchase lumber from a catalogue, which allowed them to select the grade of lumber they wanted at a typically less expensive price and a money-back guarantee. Also critical in the increasing popularity of mail-order or kit barns was the railroad, since the lumber kits had to be delivered from out of town. Once a solid railroad network was established in South Dakota, mail-order barns could be delivered to farmers throughout the state at cost-effective rates.<sup>8</sup>

The development of the gambrel roofed barn in the late nineteenth century marked the advent of standardized construction systems and mass produced building materials. The new roof design incorporated standardized, light-weight, machine cut lumber into new, scientifically tested truss systems that offered more strength and stability than the traditional gable roof system.<sup>9</sup> This increased structural stability was of the utmost importance in South Dakota, where farmers sought to construct barns that could withstand harsh winds. The gambrel design also maximized storage space in the hayloft. The gambrel-roofed barn quickly became the new standard for American barns, a symbol of technological advancement and Americanization of these significant rural structures.

Foundation materials for barns varied regionally. For example, quartzite was commonly used in Minnehaha County, where it could be found in abundance. Fieldstone, the result of glaciation, was most commonly used in the northeast region of the state. The southeastern region of the state, including the counties of Yankton, Bon Homme, and Charles Mix, chalkstone was often the most readily available resource for foundation construction. The majority of bank barns in South Dakota are found in the east and northeast regions of the state, where there was fieldstone readily available due to glaciation.<sup>10</sup>

### **Bank Barn Context**

During the late nineteenth century and early twentieth century, farmers experimented with new barn forms and features, attempting to enclose the maximum amount of space at the lowest possible cost and attain the highest degree of efficiency. The bank feature was one method of construction some farmers used to increase efficiency by allowing them easy access to both levels of the barn.<sup>11</sup> Bank barns are thus identified by construction into the side of a hill allowing for access to both floors of the barn. The ridgeline of the barn often runs parallel to the slope with the hill meeting the barn on the long side. These types of barns are often wood frame structures upon stone foundations. The lower level of bank barns generally housed horses or cattle while the loft area of the upper level was used

<sup>7</sup> Erpestad and Wood, *Building South Dakota*, 98-102.

<sup>8</sup> Noble, Allen G. and Hubert G. H. Wilhelm, *Barns of the Midwest* (Athens, Ohio University Press), 228-232.

<sup>9</sup> Noble and Wilhelm, *Barns of the Midwest*, 155-160.

<sup>10</sup> Noble and Cleek, *The Old Barn Book*, 31-34.

<sup>11</sup> Erpestad and Wood, *Building South Dakota*, 101.

to store hay.<sup>12</sup> While some bank barns have manmade banks built along side them, most South Dakota bank barns are constructed into the side of an existing hill.<sup>13</sup>

Bank barns generally reflect the kinds of mixed grain and livestock farming practiced in the late 19<sup>th</sup> and early 20<sup>th</sup> centuries. Some farmers objected to the notion that bank barns were practical, asserting that the basements were too dark, damp, and generally unhealthy. This problem was solved by barn experts who realized that building the structure on a south-facing hillside and placing the north wall of the basement below the ground surface allowed sun into the lower area of the barn, keeping it dry, warm, and generally a good place to keep livestock such as milk cows.<sup>14</sup> This modification or addition to the bank barn plan shows how barn designs evolved over time to accommodate a better understanding of the climate in the state.

### **History of the Hilmoe Barn**

The John P. Hilmoe family immigrated from Norway to the United States in 1881, promptly settling in Minnehaha County. They lived in Minnehaha County for twelve years, and then moved to Lyman County, where they resided for two years. Around the mid-1890s, the family moved back to Minnehaha County, where they bought land in Burke Township. Hans J. Hilmoe built the barn in 1911, when the family's agricultural activities expanded and a structure to house animals and store supplies became an imperative. Local legend holds that Hilmoe carried the lumber for the structure on his back from the town of Baltic (approximately two and a half miles away).<sup>15</sup> The property was sold to Charles E. Berg in November, 1970. The barn has remained in the Berg family since that time.<sup>16</sup>

The bank barn served as a horse barn with a hay carriage system that still runs throughout the lower level ceiling and hay loft. The barn is the centerpiece of the farmstead property, and served as the most important, functional building on the farm. It was used for storage of equipment and hay, and to house livestock. The barn would have been involved in virtually all aspects of the farm operation. The building reflects the prominent and essential role that barns played on early South Dakota farms, designed to be a multi-purpose structure used both for sheltering livestock as well as storing hay and equipment.

### **Integrity Evaluation**

The Hilmoe Barn retains excellent integrity. It remains in its original location, and sits within its original context, surrounded by a number of other agricultural structures. The barn retains its original lap siding and quartzite foundation. This barn is also significantly constructed into a south-facing hill, following the design suggested by barn experts in the early 20<sup>th</sup> century to combat issues of moisture and cold temperatures on the lower level of the barn. Most significantly, the barn retains its cedar shake roof and wooden cupola. The original wooden cupola, cedar roof shakes, and quartzite foundation make this an exceptional example of a bank barn in South Dakota. On the interior, the

<sup>12</sup> Allen G. Noble and Richard K. Cleek, *The Old Barn Book* (New Jersey: Rutgers University Press), 33-34, 79-80.

<sup>13</sup> Allyson Brooks and Steph Jacon, *Homesteading and Agricultural Development Context* (Pierre: South Dakota State Historic Preservation Office), 49.

<sup>14</sup> Vogel, *Barns of Southeastern South Dakota Survey*, 31.

<sup>15</sup> Sara Berg phone conversation with Bud Scancke, 1/26/10 and Sara Berg phone conversation with Perl Oien, 11/10/09.

<sup>16</sup> Property abstract for 47170 Homestead Street, Minnehaha County Register of Deeds, 415 N. Dakota Ave., Sioux Falls, SD, 57104.

barn exhibits a common barn layout that demonstrates the importance of practicality and efficiency in the context of agricultural production. The hay carriage system serves as one example of a design that easily allows for the transportation of hay from the hayloft to all areas of the lower level of the barn. The openings on the lower level and the open floor plan on that level would also allow for the storage of smaller farm implements, and most importantly, offer a protected area for livestock. The two interior pens, along with the fenced area outside of the lower level of the barn on the south side indicate that the barn served the primary purpose of housing livestock. The open hayloft area, along with the gambrel roof design, allowed hay to be stacked very highly on the upper level. No space on the barn is wasted as a result of this open, efficient layout. Historically, this barn thus tells the observer something about farm operations in southeastern South Dakota in the early part of the 20<sup>th</sup> century, and it recalls the important agricultural history of the region and the state.

### **Conclusion**

The Hilmoe Barn is eligible under Criteria A and C as a fine example of a bank barn constructed in rural Minnehaha County during the early twentieth century and retains excellent integrity. In addition to its significant architecture, the building reflects the prominent and essential role that barns played on early South Dakota farms, designed to be a multi-purpose structure used both for sheltering livestock as well as storing hay and equipment. The barn stands out as a significant historical resource that recalls the important agricultural history of Minnehaha County and the state of South Dakota.

---

### **9. Major Bibliographical References**

**Bibliography** (Cite the books, articles, and other sources used in preparing this form)

Brooks, Allyson and Steph Jacon. *Homesteading and Agricultural Development Context*. Pierre, SD: South Dakota State Historic Preservation Office, 1994.

Erpestad, David and David Wood. *Building South Dakota: A Historical Survey of the State's Architecture to 1945*. Pierre, SD: South Dakota State Historical Society Press, 1997.

Noble, Allen G. and Hubert G. H. Wilhelm. *Barns of the Midwest*. Athens: Ohio University Press, 1995.

Noble, Allen G. and Richard K. Cleek. *The Old Barn Book*. New Jersey: Rutgers University Press, 1996.

Parker, Donald Dean. *History of Our County and State: Minnehaha County*. Brookings: South Dakota State College, 1960.

Vogel, Robert C. *Barns of Southeastern South Dakota Survey*. Pierre: South Dakota State Historic Preservation Office, 2005.

**Previous documentation on file (NPS):**

preliminary determination of individual listing (36 CFR 67 has been Requested)  
 previously listed in the National Register  
 previously determined eligible by the National Register  
 designated a National Historic Landmark  
 recorded by Historic American Buildings Survey # \_\_\_\_\_  
 recorded by Historic American Engineering Record # \_\_\_\_\_

**Primary location of additional data:**

State Historic Preservation Office  
 Other State agency  
 Federal agency  
 Local government  
 University  
 Other  
Name of repository: \_\_\_\_\_

Historic Resources Survey Number (if assigned):  
\_\_\_\_\_ MH00001806 \_\_\_\_\_

---

**10. Geographical Data**

---

**Acreage of Property** Less than one  
(Do not include previously listed resource acreage)

**UTM References**

(Place additional UTM references on a continuation sheet)

1 14 678885 4848720  
Zone Easting Northing

3 \_\_\_\_\_  
Zone Easting Northing

2 \_\_\_\_\_  
Zone Easting Northing

4 \_\_\_\_\_  
Zone Easting Northing

**Verbal Boundary Description** (describe the boundaries of the property)

The barn is located in the SW ¼ of the NE ¼ of Section 36, T104N, R50W. The boundary is an imaginary line that forms a rectangle encompassing the barn. Starting at a point 3 feet northeast of the northeast corner of the barn and running south to a point 3 feet southeast of the southeast corner of the barn, then running west to a point 3 feet southwest of the southwest corner of the barn, then running north to a point 3 feet northwest of the northwest corner of the barn, then running east to meet the original starting point at the northeast corner of the barn.

**Boundary Justification** (explain why the boundaries were selected)

The boundary only includes the immediate area surrounding the barn which has been historically associated with the Hilmoe Farm. The barn is the only significant building on the farm that retains historical integrity. The other farmstead buildings have been excluded based on dates of construction and loss of integrity.

---

**11. Form Prepared By**

name/title Jason Biggins/Historic Preservation Specialist  
organization South Dakota State Historic Preservation Office date January 26, 2010  
street & number 900 Governors Drive telephone (605) 773-6056  
city or town Pierre state SD zip code 57501  
e-mail Jason.biggins@state.sd.us

---

**Additional Documentation**

Submit the following items with the completed form:

- **Maps:** A **USGS map** (7.5 or 15 minute series) indicating the property's location.  
A **Sketch map** for historic districts and properties having large acreage or numerous resources. Key all photographs to this map.
- **Continuation Sheets**
- **Additional items:** (Check with the SHPO or FPO for any additional items)

---

**Photographs:**

Submit clear and descriptive photographs. The size of each image must be 1600x1200 pixels at 300 ppi (pixels per inch) or larger. Key all photographs to the sketch map.

**Name of Property:** Hilmoe, Hans J. Barn

**City or Vicinity:** Baltic

**County:** Minnehaha

**State:** South Dakota

**Photographer:** Jason Biggins

**Date Photographed:** March 4, 2010

**Description of Photograph(s) and number:**

- 1.) HilmoeBarn\_MinnehahaCounty\_SD\_0001.tif – Looking northwest at south and east sides of barn
- 2.) HilmoeBarn\_MinnehahaCounty\_SD\_0002.tif – Looking northwest at east side of barn
- 3.) HilmoeBarn\_MinnehahaCounty\_SD\_0003.tif – Looking north at south side of barn (lower level of bank barn)
- 4.) HilmoeBarn\_MinnehahaCounty\_SD\_0004.tif – Looking east at west side of barn
- 5.) HilmoeBarn\_MinnehahaCounty\_SD\_0005.tif – Looking northwest into lower level interior of barn
- 6.) HilmoeBarn\_MinnehahaCounty\_SD\_0006.tif – Looking southeast into upper level hayloft

---

**Property Owner:**

(complete this item at the request of the SHPO or FPO)

---

name Sara Berg  
street & number 720 13<sup>th</sup> Avenue, Apt. 3 telephone (605) 321-4224  
city or town Brookings state SD zip code 57006

**Paperwork Reduction Act Statement:** This information is being collected for applications to the National Register of Historic Places to nominate properties for listing or determine eligibility for listing, to list properties, and to amend existing listings. Response to this request is required to obtain a benefit in accordance with the National Historic Preservation Act, as amended (16 U.S.C.460 et seq.).

**Estimated Burden Statement:** Public reporting burden for this form is estimated to average 18 hours per response including time for reviewing instructions, gathering and maintaining data, and completing and reviewing the form. Direct comments regarding this burden estimate or any aspect of this form to the Office of Planning and Performance Management, U.S. Dept. of the Interior, 1849 C. Street, NW, Washington, DC.

# Hilmoe, Hans J. Farmstead

I-29

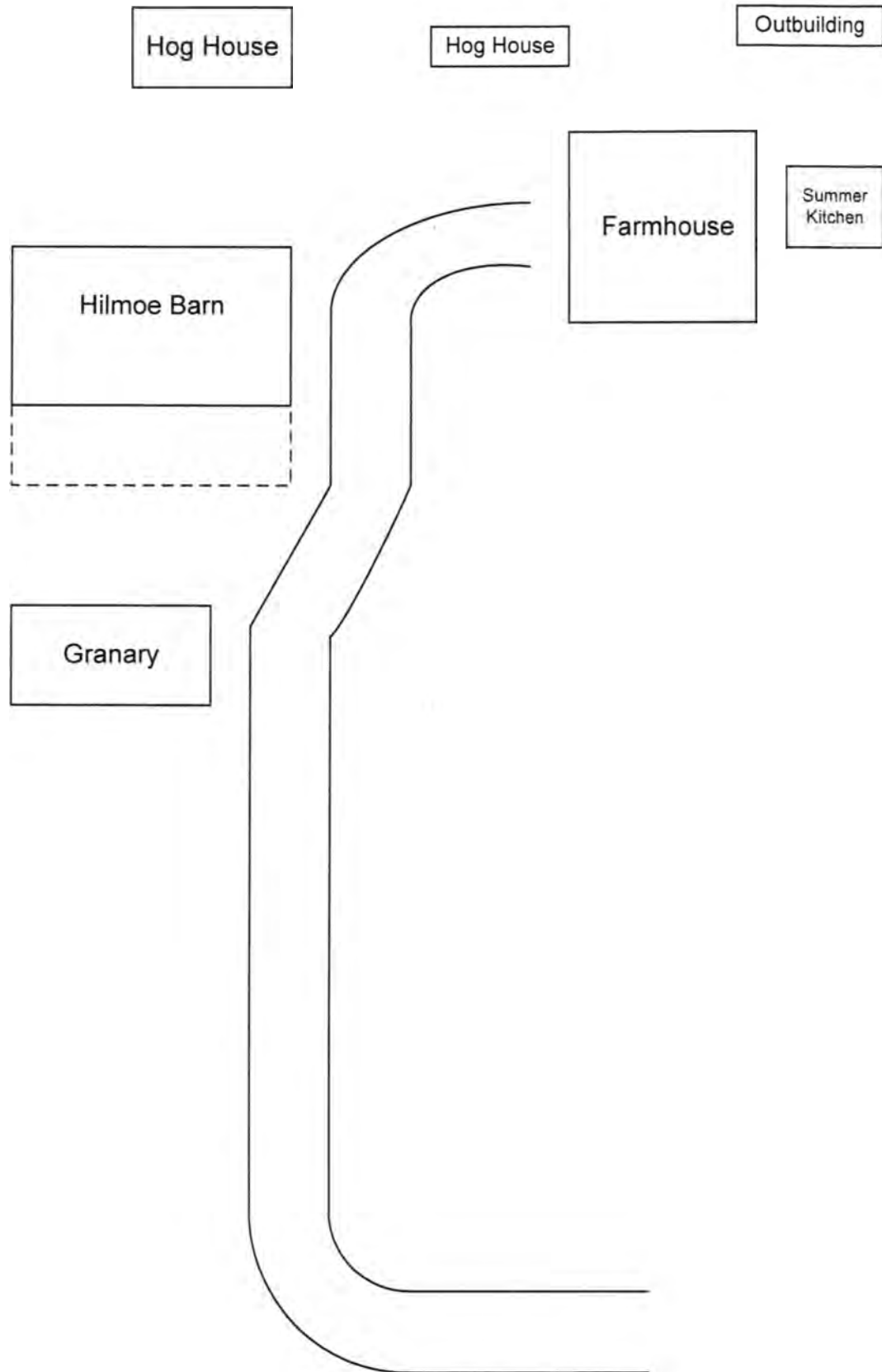

# Hilmoe, Hans J. Barn Lower Level Layout

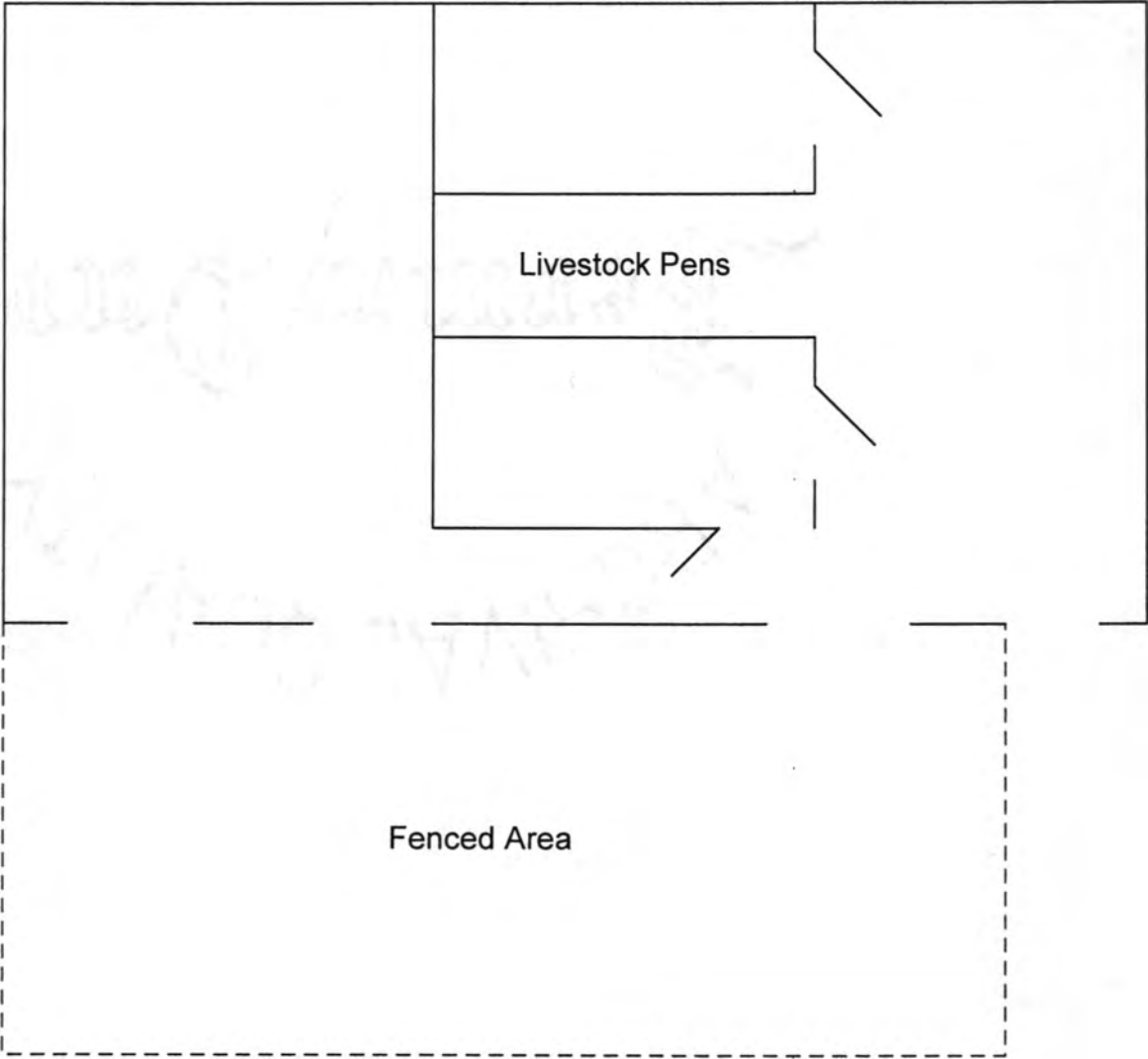

UNITED STATES DEPARTMENT OF THE INTERIOR  
NATIONAL PARK SERVICE

NATIONAL REGISTER OF HISTORIC PLACES  
EVALUATION/RETURN SHEET

REQUESTED ACTION: NOMINATION

PROPERTY NAME: Hilmo, Hans J., Barn

MULTIPLE NAME:

STATE & COUNTY: SOUTH DAKOTA, Minnehaha

DATE RECEIVED: 5/14/10      DATE OF PENDING LIST: 6/08/10  
DATE OF 16TH DAY: 6/23/10      DATE OF 45TH DAY: 6/28/10  
DATE OF WEEKLY LIST:

REFERENCE NUMBER: 10000410

REASONS FOR REVIEW:

APPEAL: N    DATA PROBLEM: N    LANDSCAPE: N    LESS THAN 50 YEARS: N  
OTHER: N    PDIL: N    PERIOD: N    PROGRAM UNAPPROVED: N  
REQUEST: N    SAMPLE: N    SLR DRAFT: N    NATIONAL: N

COMMENT WAIVER: N

ACCEPT     RETURN     REJECT    6-28-10 DATE

ABSTRACT/SUMMARY COMMENTS:

**Entered in  
The National Register  
of  
Historic Places**

RECOM./CRITERIA \_\_\_\_\_

REVIEWER \_\_\_\_\_ DISCIPLINE \_\_\_\_\_

TELEPHONE \_\_\_\_\_ DATE \_\_\_\_\_

DOCUMENTATION see attached comments Y/N see attached SLR Y/N

If a nomination is returned to the nominating authority, the nomination is no longer under consideration by the NPS.



Hilmoe Barn - Minnehaha County - SD - 0001.tif



Hilmo e Barn - Minnehaha County - SD\_0002.tif



Hilmoer Barn - Minnehaha County - SD - 0003.tif



Hilmoe Barn - Minnehaha County - SD - 0004.tif



Hilmoe Barn - Minnehaha County - SD - 0005.tif

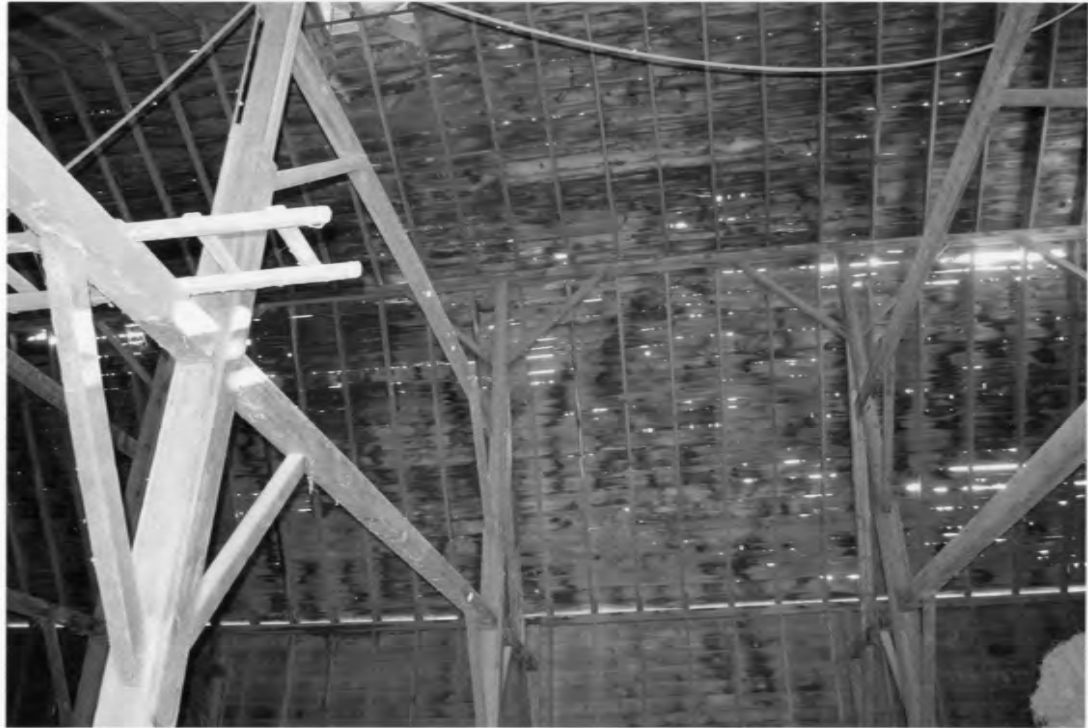

Hilmoe Barn - Minnehaha County - SD - 0006.tif

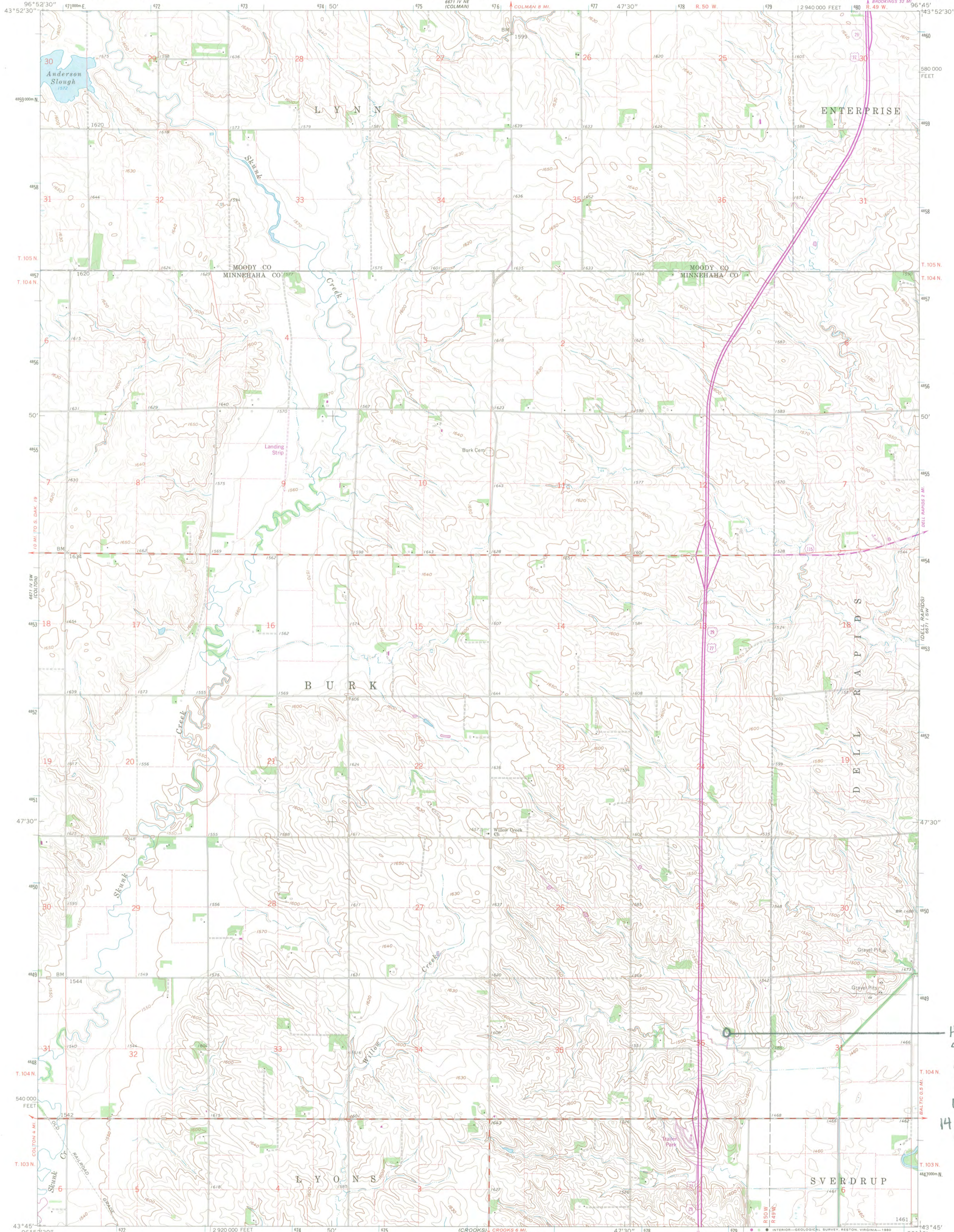

HILMOE, HANS J. BARN  
47170 Homestead Street  
Minnehaha County  
Baltic, SD  
UTM Reference  
14/678885/4848720

Mapped, edited, and published by U. S. Geological Survey

Control by USGS and NOS/NOAA

Topography by photogrammetric methods from aerial photographs taken 1961. Field checked 1962

Polyconic projection  
10,000-foot grid based on South Dakota coordinate system, south zone  
1000-meter Universal Transverse Mercator grid ticks,  
zone 14, shown in blue. 1927 North American Datum  
To place on the predicted North American Datum 1983  
move the projection lines 7 meters north and  
27 meters east as shown by dashed corner ticks

Fine red dashed lines indicate selected fence and field lines where generally visible on aerial photographs. This information is unchecked

Revisions shown in purple and woodland compiled from aerial photographs taken 1977 and other source data. This information not field checked. Map edited 1980

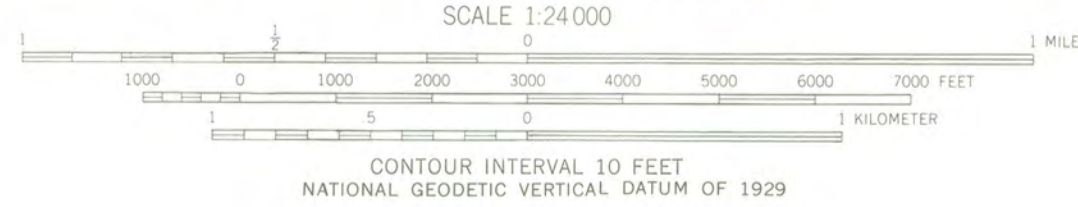

CONTOUR INTERVAL 10 FEET  
NATIONAL GEODETIC VERTICAL DATUM OF 1929

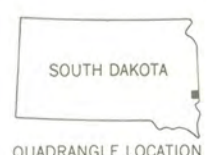

ROAD CLASSIFICATION

Primary highway, all weather, hard surface	Light-duty road, all weather, improved surface
Secondary highway, all weather, hard surface	Unimproved road, fair or dry weather

Legend:  
○ Interstate Route  
○ U. S. Route  
○ State Route

COLTON SE, S. DAK.  
N4345—W9645/7.5

1962  
PHOTOREVISED 1980  
DMA 6671 IV SE-SERIES V873

THIS MAP COMPLIES WITH NATIONAL MAP ACCURACY STANDARDS  
FOR SALE BY U. S. GEOLOGICAL SURVEY, DENVER COLORADO 80225, OR RESTON, VIRGINIA 22092  
A FOLDER DESCRIBING TOPOGRAPHIC MAPS AND SYMBOLS IS AVAILABLE ON REQUEST

# SOUTH DAKOTA STATE HISTORICAL SOCIETY

Department of Tourism and State Development

11 May 2010

Keeper of the National Register  
National Register of Historic Places  
National Parks Service  
1201 Eye St NW  
8<sup>th</sup> Floor (MS 2280)  
Washington DC 20005

Dear Keeper of the National Register:

Enclosed are four nominations: *Rapid City High School*, *Hilmoe Barn* and the *The Washington School*. Also enclosed is additional information for: *The Elster House*.

If you have any questions regarding any of these submittals, please feel free to contact me at 605-773-3103 or at [chrisb.nelson@state.sd.us](mailto:chrisb.nelson@state.sd.us).

Sincerely,



Chris B. Nelson  
Historic Preservation Specialist



Department of  
Tourism & State  
Development

Office of Tourism [TravelSD.com](http://TravelSD.com)  
Governor's Office of Economic Development [SDreadytowork.com](http://SDreadytowork.com)  
Tribal Government Relations [SDtribalrelations.com](http://SDtribalrelations.com)  
Arts Council [artscouncil.sd.gov](http://artscouncil.sd.gov)  
State Historical Society [history.sd.gov](http://history.sd.gov)  
Housing Development Authority [SDHDA.org](http://SDHDA.org)

2010  
initiative

[2010initiative.com](http://2010initiative.com)