

TENNESSEE MULTIPLE PROPERTY FORM

TITLE: Historic Resources of Grundy County

COUNTY: Grundy
SITE: 6

HISTORIC NAME: Stoker-Stampfli Farm

COMMON NAME: Stampfli Farm

ADDRESS: Colony Cemetery Road
Gruetli, Tennessee

OWNER: Ernest Stampfli Heirs
c/o Rosemarie Stampfli

ADDRESS: Colony Cemetery Road
Gruetli, Tennessee 37339

HISTORIC USE: Residence/Farm

CURRENT USE: Residence

CATEGORY/BUILDING TYPE: Building/Residence

DATE OF CONSTRUCTION: 1869

ARCHITECT/BUILDER: unknown

ORIGINAL SITE: yes MOVED: N/A DATE: N/A

ORIGINAL OWNER/SIGNIFICANT INDIVIDUALS: Anton Stoker, Ernest Stampfli

HAS THIS PROPERTY BEEN DETERMINED ELIGIBLE? no DATE: N/A

CONTRIBUTING:

NON-CONTRIBUTING:

buildings	5	buildings	0
structures	1	structures	0
sites	0	sites	0
objects	0	objects	0

TOTAL	6	TOTAL	0
-------	---	-------	---

VERBAL BOUNDARY DESCRIPTION AND JUSTIFICATION:

The boundaries for the Stoker-Stampfli Farm begin at the intersection of the end of Colony Cemetery Road and the western property line, thence go northerly approximately 300 feet along the western property line to the north fence line, thence easterly along the north fence line approximately 750 feet to the eastern fence line, thence southerly along the eastern fence line approximately 700 feet to the southern fence line, thence westerly approximately 875 feet to the western fence line, thence northerly along the western fence line approximately 275 feet to the point of beginning. This includes sufficient property to protect the historic integrity of the farm.

ACREAGE: Approximately 11 acres

UTM REFERENCE: Altamont, Tennessee 99NW

A: 16/623120/3917290 C: 16/622890/3917090

B: 16/623160/3917090 D: 16/622890/3917250

SUPPLEMENTAL BIBLIOGRAPHICAL REFERENCES:

Interview with Stampfli family, October 1986.

PREPARED BY: Elizabeth A. Straw, Historic Preservation Specialist

ADDRESS: Tennessee Historical Commission
701 Broadway
Nashville, Tennessee 37219

TENNESSEE MULTIPLE PROPERTY FORM - CONTINUATION SHEET

TITLE: Historic Resources of Grundy County

SITE: 6

PAGE: 2

DESCRIPTION:

The Stoker-Stampfli farm is located at the end of Colony Cemetery Road in Gruetli, Tennessee. The small one-and-a-half story frame house built in 1869 has two front entrances flanked by 6/6 double hung windows. The entrance on the north end is built abutting the window and may have been added circa 1927. The second story contains three 6/6 windows that are placed directly above the two lower story windows and the south entrance. A simple shed roof porch extends the length of the house. A shed roof addition with no openings on the east or main facade was added to the north end of the house circa 1913.

The south facade of the house is covered with asphalt shingle siding and contains four 6/6 double hung windows and a small attic window. The west facade or rear of the house is similar to the main or east facade of the house and is three bays wide with a center entrance. A small addition is located at the south end of the back porch.

On the north end of the house is a shed or barnlike addition that sits slightly back from the rear of the house and is open on the west side. The addition shelters the entrance to the cellar and served as storage space for the farm. The north facade of the house is completely covered by the plain board wall of the shed addition and the steeply pitched roof. Only the attic window and roofline of the original house is visible above the addition.

The interior of the house consists of two main rooms equally dividing the front portion of the house and of a kitchen that extends along the entire length of the rear of the house. A modern bath has been added at the rear of the north room near the stairs to the second story. The walls and ceilings of all the downstairs rooms are tongue and groove paneling that has been painted. In the south or main living room of the house is a built-in, narrow gun cabinet located between the studs of the house.

The second story of the house is comprised of three rooms, one large open room on the north side of the house and two smaller bedrooms on the south side of the house. The tongue and groove walls and ceilings of the large room and the east bedroom have remained unpainted and retain their original oiled finish.

There are five contributing outbuildings on the farm. The five buildings include a frame corncrib, a log barn, a frame woodworking shop, a log chicken house, and a frame sweet potato house and smokehouse. All the outbuildings date from c.1913. The log barn was constructed in two sections, the east end of the barn was built circa 1913 of round logs and in 1927 the west end of the barn was constructed of hewn logs. The 1927 date is written on the barn doors and on one of the rafters.

TENNESSEE MULTIPLE PROPERTY FORM - CONTINUATION SHEET

TITLE: Historic Resources of Grundy County

SITE: 6

PAGE: 3

SIGNIFICANCE:

CRITERIA: A

CONSIDERATION: N/A

AREA OF SIGNIFICANCE: Settlement, Ethnic Heritage

PERIOD OF SIGNIFICANCE/SIGNIFICANT DATES: 1869-1937

LEVEL OF SIGNIFICANCE: Local

The Stoker-Stampfli Farm is being nominated under National Register criterion A for its significance in the settlement of the Swiss colony of Gruetli. The Stoker-Stampfli house was built in 1869 by Anton Stoker, one of the first permanent Swiss settlers in Gruetli. The Swiss settlement of Gruetli began in 1869 after Eugen H. Plumacher and Peter Staub, who were associated with the Swiss Emigration Society, chose and purchased 15,000 acres of land in Grundy County. Anton Stoker was in the first wave of immigrants to arrive in Grundy County in 1869.

Anton Stoker was an important member of the Swiss Colony serving as the first treasurer of the society in 1869. The Swiss Agricultural Society, an important organization in the Swiss colony, used the house as a meeting place for several years. The Swiss Agricultural Society played a very important role in the success of the Swiss farmers that remained in Gruetli. The Agricultural Society served as a form of co-operative, purchasing seeds in lots for the farmers and also as an educational center with instruction and research on the best types of crops to grow in the area. The Agricultural Society met on a regular basis and provided members with a revolving library of agricultural books. The society's extensive records of their meetings still exist and a portion of the records and the revolving library are still kept in the house.

In 1913 Ernest Stampfli purchased the property from Anton Stoker. The Stampfli family made several improvements on the farm and built the numerous outbuildings on the property. The Agricultural Society continued to meet in the large upstairs room of the house until it disbanded. Descendants of the Stampfli family continue to reside in the house.

The Stoker-Stampfli Farm is the best example of an early extant Swiss Colony farm complex remaining in Gruetli. It is not only an excellent example of the type of farms the Swiss settlers built, but is also important for its role in the close cultural ties the colonists retained through the Swiss Agricultural Society.

United States Department of the Interior
National Park Service

National Register of Historic Places
Inventory—Nomination Form

Historic Resources of

Continuation sheet Grundy County

Item number 10

Page 6

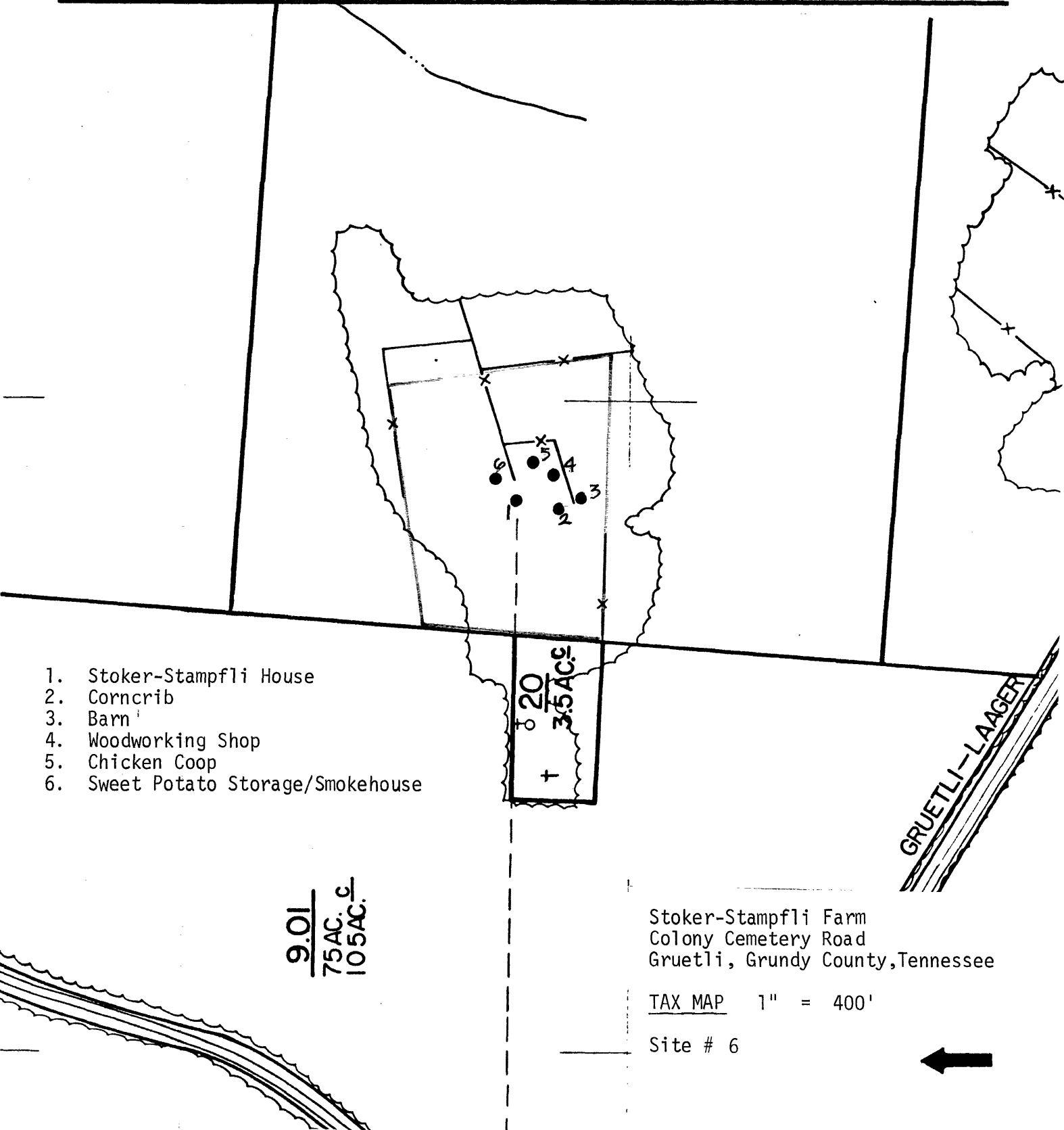
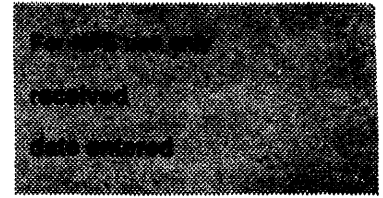

1. Stoker-Stampfli House
2. Corncrib
3. Barn
4. Woodworking Shop
5. Chicken Coop
6. Sweet Potato Storage/Smokehouse

Stoker-Stampfli Farm
Colony Cemetery Road
Gruetli, Grundy County, Tennessee

TAX MAP 1" = 400'

Site # 6

