

United States Department of the Interior
National Park Service

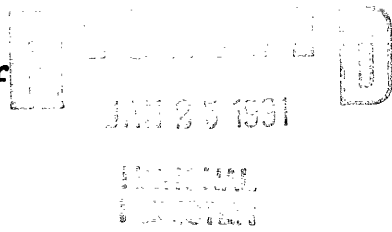

NATIONAL REGISTER OF HISTORIC PLACES
REGISTRATION FORM

1. Name of Property

historic name: PAGO PILLBOX II (66-09-1216)

other name/site number: PAGO PILLBOX II

2. Location

street & number: ROUTE FOUR

not for publication:

city/town: CHALAN PAGO

vicinity:

state: GU county: CHALAN PAGO code: 010 zip code: 96924

3. Classification

Ownership of Property: PRIVATE

Category of Property: STRUCTURE

Number of Resources within Property:

Contributing	Noncontributing	
_____	_____	buildings
_____	_____	sites
<u>ONE</u>	_____	structures
_____	_____	objects
<u>ONE</u>	_____	Total

Number of contributing resources previously listed in the National Register: 0

Name of related multiple property listing: JAPANESE DEFENSE FORTIFICATIONS

4. State/Federal Agency Certification

As the designated authority under the National Historic Preservation Act of 1986, as amended, I hereby certify that this nomination _____ request for determination of eligibility meets the documentation standards for registering properties in the National Register of Historic Places and meets the procedural and professional requirements set forth in 36 CFR Part 60. In my opinion, the property meets _____ does not meet the National Register Criteria. _____ See continuation sheet.

D. J. [Signature] _____ 11/7/91
Signature of certifying official Date

State or Federal agency and bureau

In my opinion, the property _____ meets _____ does not meet the National Register criteria. _____ See continuation sheet.

Signature of commenting or other official Date

State or Federal agency and bureau

5. National Park Service Certification

I, hereby certify that this property is:

- entered in the National Register _____
_____ See continuation sheet.
- determined eligible for the National Register _____
_____ See continuation sheet.
- determined not eligible for the National Register _____
- removed from the National Register _____
- other (explain): _____

Cave O'Shull 3-4-91

Signature of Keeper Date of Action

6. Function or Use

Historic: MILITARY Sub: FORTIFICATION

Current : VACANT/NOT IN USE Sub: _____

=====
7. Description
=====

Architectural Classification:

NO STYLE

Other Description: _____

Materials: foundation CONCRETE roof CONCRETE
walls CONCRETE other _____
LIMESTONE

Describe present and historic physical appearance. X See continuation sheet.

=====
8. Statement of Significance
=====

Certifying official has considered the significance of this property in relation to other properties: _____.

Applicable National Register Criteria: A,C,D

Criteria Considerations (Exceptions) : G

Areas of Significance: MILITARY

Period(s) of Significance: 1941-1944

Significant Dates : 1944

Significant Person(s): N/A

Cultural Affiliation: N/A

Architect/Builder: N/A

State significance of property, and justify criteria, criteria considerations, and areas and periods of significance noted above. X See multiple resource nomination.

=====

9. Major Bibliographical References

=====

See multiple resource nomination.

Previous documentation on file (NPS):

- preliminary determination of individual listing (36 CFR 67) has been requested.
- previously listed in the National Register
- previously determined eligible by the National Register
- designated a National Historic Landmark
- recorded by Historic American Buildings Survey # _____
- recorded by Historic American Engineering Record # _____

Primary Location of Additional Data:

- State historic preservation office
- Other state agency
- Federal agency
- Local government
- University
- Other -- Specify Repository: _____

=====

10. Geographical Data

=====

Acreage of Property: LESS THAN ONE ACRE

UTM References: Zone Easting Northing Zone Easting Northing

A	<u>55</u>	<u>259875</u>	<u>1484250</u>	B	___	___	___
C	___	___	___	D	___	___	___

___ See continuation sheet.

Verbal Boundary Description: ___ See continuation sheet.

The boundry of the Pago Pillbox II is shown as a dot on the USGS map reference (66-09-1216).

Boundary Justification: ___ See continuation sheet.

The boundry includes the features historically associated with the site.

=====

11. Form Prepared By

=====

Name/Title: Antonio E. Martinez, Jr./ Archeological Technician I

Organization: Guam Historic Preservation

Date: November 1, 1990

Street & Number: 490 Chalan Palasyo Rd.

Telephone: (671) 477-9620

City or Town: Agana Heights

State: GU ZIP: 96919

**United States Department of the Interior
National Park Service**

**NATIONAL REGISTER OF HISTORIC PLACES
CONTINUATION SHEET**

Section number 7

Pago Pillbox II (66-09-1216)

=====

The pillbox is situated along the southern shoreline of Pago Bay approximately 550.0m west of Pago point and 1.0m south of the high tide line. Built of steel-reinforced the structure is in good condition and it blends in with its surroundings.

The exterior dimensions of the structure measure 3.10m by 2.70m by 1.5m high. The entrance is located on the west side of the structure. One gun port is located in the north wall and one gun port is located in the northwest wall. The gun ports have views of Pago Bay. The wall with the gun ports are nearly 1.0m thick due to the additon of limestone boulders to the exterior sides of the walls. One section of the exterior face of the northwest wall has been broken away, exposing impressions of tree trunks in the concrete. The impressions suggest that logs were originally incorporated into the wall.

The structure had a flat roof with two vents. The vents are stepped. Larger on the surface of the roof where they measure .40 x .40m, they become narrower toward the ceiling of the interior where they measure .20 x .20m. The roof is .75m thick. The floor of the interior consists of coral and limestone rocks. Coral beach pebbles were mixed with the cement. Horizontal impressions of the boards used to build the form into which the concrete was poured are apparent on the interior walls. The interior height is 1.30m.

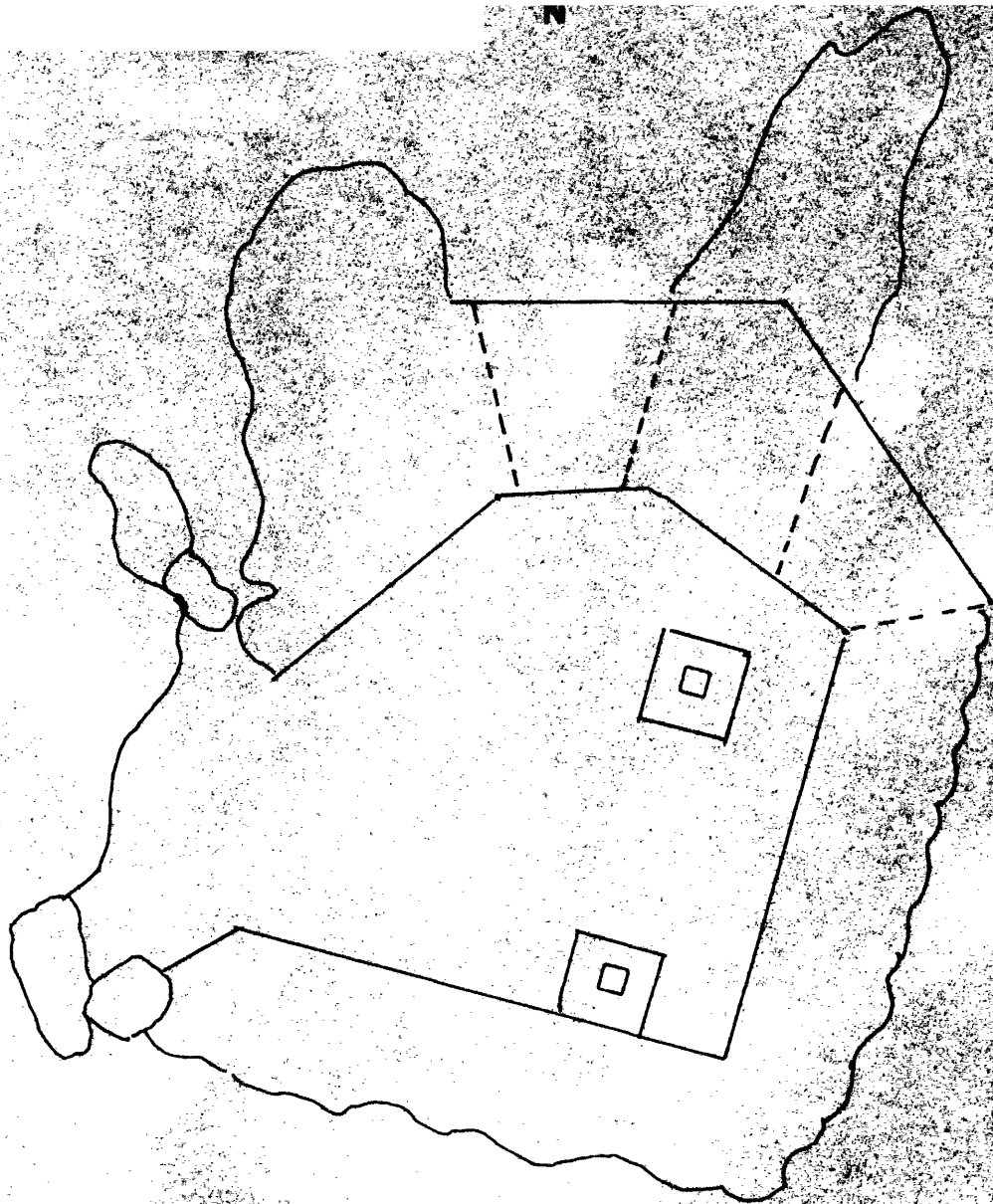

scale: 1cm = 30m

Plan view

Pago Bay fortification

AUG 22 1988

United States Department of the Interior
National Park Service

National Register of Historic Places Continuation Sheet

Section number _____ Page _____

SUPPLEMENTARY LISTING RECORD

NRIS Reference Number: 88001879 Date Listed: 3/4/91

<u>Pagu' Pillbox II</u>	<u>Guam</u>	<u>Guam</u>
Property Name	County	State

Japanese Coastal Defense Fortifications on Guam TR
Multiple Name

 This property is listed in the National Register of Historic Places in accordance with the attached nomination documentation subject to the following exceptions, exclusions, or amendments, notwithstanding the National Park Service certification included in the nomination documentation.

<u><i>Richard Davis</i></u>	<u>3/14/91</u>
Signature of the Keeper	Date of Action

=====
Amended Items in Nomination:

Statement of Significance: This property is evaluated at the national level.

The Applicable National Register Criteria includes A and C only. Criterion D is deleted.

The Areas of Significance section includes Engineering.

This information was confirmed with Richard Davis, Deputy SHPO of Guam.

DISTRIBUTION:

- National Register property file
- Nominating Authority (without nomination attachment)