

NATIONAL REGISTER OF HISTORIC PLACES
INVENTORY - NOMINATION FORM

(Type all entries - complete applicable sections)

STATE: South Dakota	
COUNTY: Custer	
FOR NPS USE ONLY	
ENTRY NUMBER	DATE
MAR 7 1973	

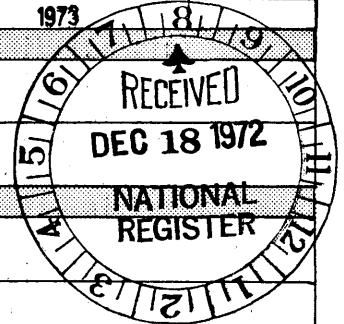

1. NAME

COMMON:
Way Park Museum

AND/OR HISTORIC:
Log Cabin Museum

2. LOCATION

STREET AND NUMBER:
Corner 4th & Mt. Rushmore Rd. on south side of street

CITY OR TOWN:
Custer

STATE South Dakota	CODE 40	COUNTY: Custer	CODE 033
------------------------------	-------------------	--------------------------	--------------------

3. CLASSIFICATION

CATEGORY (Check One)	OWNERSHIP	STATUS	ACCESSIBLE TO THE PUBLIC
<input type="checkbox"/> District <input type="checkbox"/> Site <input type="checkbox"/> Object <input checked="" type="checkbox"/> Building <input type="checkbox"/> Structure	<input checked="" type="checkbox"/> Public <input type="checkbox"/> Private <input type="checkbox"/> Both	Public Acquisition: <input type="checkbox"/> In Process <input type="checkbox"/> Being Considered <input type="checkbox"/> Occupied <input checked="" type="checkbox"/> Unoccupied <input type="checkbox"/> Preservation work in progress	Yes: <input type="checkbox"/> Restricted <input checked="" type="checkbox"/> Unrestricted <input type="checkbox"/> No
PRESENT USE (Check One or More as Appropriate)			
<input type="checkbox"/> Agricultural <input type="checkbox"/> Commercial <input type="checkbox"/> Educational <input type="checkbox"/> Entertainment	<input type="checkbox"/> Government <input type="checkbox"/> Industrial <input type="checkbox"/> Military <input checked="" type="checkbox"/> Museum	<input type="checkbox"/> Park <input type="checkbox"/> Private Residence <input type="checkbox"/> Religious <input type="checkbox"/> Scientific	<input type="checkbox"/> Transportation <input type="checkbox"/> Other (Specify) _____ <input type="checkbox"/> Comments _____

4. OWNER OF PROPERTY

OWNER'S NAME:
City of Custer

STREET AND NUMBER:

CITY OR TOWN:
Custer

STATE: South Dakota	CODE: 40
-------------------------------	--------------------

5. LOCATION OF LEGAL DESCRIPTION

COURTHOUSE, REGISTRY OF DEEDS, ETC.:
Register of deeds office

STREET AND NUMBER:
411 Mt. Rushmore Rd.

CITY OR TOWN:
Custer

STATE: South Dakota	CODE: 40
-------------------------------	--------------------

6. REPRESENTATION IN EXISTING SURVEYS

TITLE OF SURVEY:
South Dakota Historical Sites Survey

DATE OF SURVEY:
 Federal
 State
 County
 Local

DEPOSITORY FOR SURVEY RECORDS:
South Dakota Historic Preservation Program

STREET AND NUMBER:
W. H. Over Dakota Museum, University of South Dakota

CITY OR TOWN:
Vermillion

STATE: South Dakota	CODE: 40
-------------------------------	--------------------

SEE INSTRUCTIONS

STATE:

COUNTY:

ENTRY NUMBER

DATE

FOR NPS USE ONLY

7. DESCRIPTION

CONDITION	(Check One)					
	<input type="checkbox"/> Excellent	<input checked="" type="checkbox"/> Good	<input type="checkbox"/> Fair	<input type="checkbox"/> Deteriorated	<input type="checkbox"/> Ruins	<input type="checkbox"/> Unexposed
	(Check One)			(Check One)		
	<input type="checkbox"/> Altered	<input checked="" type="checkbox"/> Unaltered		<input checked="" type="checkbox"/> Moved	<input type="checkbox"/> Original Site	

DESCRIBE THE PRESENT AND ORIGINAL (if known) PHYSICAL APPEARANCE

This building which has been moved a few feet from its original site, is a one story log cabin. It is constructed of hand hewn logs approx. 10 to 12 in. in diameter. (unpainted) The roof is shingle, natural color. The four windows, two in front and one on each side, have white trim. It has a board floor, wainscoted ceiling, and a native stone fire place that was added in later years. The outside measurements are approx. 16 by 20 ft.

The cabin is located in the S.E. section of Harry Way Park. The Park also contains a large stone monument honoring Horatio N. Ross, who discovered gold in the Black Hills in 1874. Also under cover is the original Sidney - Custer lawns, walk ways and shade trees and is surrounded by a well kept hedge. A 3x4 ft. sign at Park entrance gives a brief history of the building. (This building has one room)



SEE INSTRUCTIONS

2. SIGNIFICANCE

PERIOD (Check One or More as Appropriate)

- | | | | |
|--|---------------------------------------|--|---------------------------------------|
| <input type="checkbox"/> Pre-Columbian | <input type="checkbox"/> 16th Century | <input type="checkbox"/> 18th Century | <input type="checkbox"/> 20th Century |
| <input type="checkbox"/> 15th Century | <input type="checkbox"/> 17th Century | <input checked="" type="checkbox"/> 19th Century | |

SPECIFIC DATE(S) (If Applicable and Known)

Built in 1875

AREAS OF SIGNIFICANCE (Check One or More as Appropriate)

- | | | | |
|---|---|--|--|
| <input type="checkbox"/> Aboriginal | <input checked="" type="checkbox"/> Education | <input type="checkbox"/> Political | <input type="checkbox"/> Urban Planning |
| <input type="checkbox"/> Prehistoric | <input type="checkbox"/> Engineering | <input type="checkbox"/> Religion/Philosophy | <input type="checkbox"/> Other (Specify) |
| <input type="checkbox"/> Historic | <input type="checkbox"/> Industry | <input type="checkbox"/> Science | _____ |
| <input type="checkbox"/> Agriculture | <input type="checkbox"/> Invention | <input type="checkbox"/> Sculpture | _____ |
| <input type="checkbox"/> Architecture | <input type="checkbox"/> Landscape Architecture | <input type="checkbox"/> Social/Humanitarian | _____ |
| <input type="checkbox"/> Art | <input type="checkbox"/> Literature | <input type="checkbox"/> Theater | _____ |
| <input type="checkbox"/> Commerce | <input type="checkbox"/> Military | <input type="checkbox"/> Transportation | _____ |
| <input type="checkbox"/> Communications | <input type="checkbox"/> Music | | _____ |
| <input type="checkbox"/> Conservation | | | _____ |

STATEMENT OF SIGNIFICANCE

SEE INSTRUCTIONS

This log cabin was one of the first permanent buildings in the Black Hills. Built in 1875 it was used as military headquarters by Capt. Pollock during the time that the miners and early settlers were ordered out of the Black Hills, which at that time was Indian territory. It was later occupied by Dr. D. W. Flick- colorful pioneer doctor of the area, and by Capt. Jack Crawford, the poet scout.

In the building are nearly 200 separate items of historic importance. These include pictures and information of General George Custer -his men and his horse Comanche. Also of other Custer pioneers such as, Anna Tallent, first white woman in the Black Hills, Horatio Ross, the miner with Custer's expedition who discovered gold, and Clamaity Jane. Also mounted birds, animal, a gun collection and a rare mineral display.

The fact that it was one of the first permanent buildings in the Black Hills makes it one of the most historic sites in the State. It sheltered some of the most famous and colorful characters of the early west and eventually its owner became Judge Harry Way. The man for whom the park and museum were named and who contributed so much to the community. Way gave the building to the city of Custer and mainly through his efforts and foresight it is now preserved as a museum.



9. MAJOR BIBLIOGRAPHICAL REFERENCES

"A Visit to the Black Hills of South Dakota", 1931, page 21.
 "Black Hills of South Dakota", 1937, page 10.
 "Custer County Chronicle", July 23, 1942.
 "Custer County Chronicle", July 25, 1946.
 "Black Hills Industrial Review:", #1, April, 1911, page 19.

10. GEOGRAPHICAL DATA

LATITUDE AND LONGITUDE COORDINATES DEFINING A RECTANGLE LOCATING THE PROPERTY			OR	LATITUDE AND LONGITUDE COORDINATES DEFINING THE CENTER POINT OF A PROPERTY OF LESS THAN TEN ACRES		
CORNER	LATITUDE	LONGITUDE		LATITUDE	LONGITUDE	
	Degrees Minutes Seconds	Degrees Minutes Seconds		Degrees Minutes Seconds	Degrees Minutes Seconds	
NW	° ' "	° ' "		43 ° 45 ' 36 "	103 ° 36 ' 03 "	
NE	° ' "	° ' "				
SE	° ' "	° ' "				
SW	° ' "	° ' "				

APPROXIMATE ACREAGE OF NOMINATED PROPERTY: less than 1 acre

LIST ALL STATES AND COUNTIES FOR PROPERTIES OVERLAPPING STATE OR COUNTY BOUNDARIES

STATE:	CODE	COUNTY	CODE

11. FORM PREPARED BY

NAME AND TITLE:
Historical Sites Committee

ORGANIZATION: Custer County Historical Society DATE: 1972

STREET AND NUMBER:
Box 27

CITY OR TOWN: Custer STATE: South Dakota CODE: 40

12. STATE LIAISON OFFICER CERTIFICATION

As the designated State Liaison Officer for the National Historic Preservation Act of 1966 (Public Law 89-665), I hereby nominate this property for inclusion in the National Register and certify that it has been evaluated according to the criteria and procedures set forth by the National Park Service. The recommended level of significance of this nomination is:

National State Local

Name [Signature]

Title State Liaison Officer

Date 12-7-72

NATIONAL REGISTER VERIFICATION

I hereby certify that this property is included in the National Register.

[Signature]
 Chief, Office of Archeology and Historic Preservation

Date 3/7/73

ATTEST:
[Signature]
 Keeper of The National Register

Date 3-5-73

NO
 WORK
 (+)

SEE INSTRUCTIONS

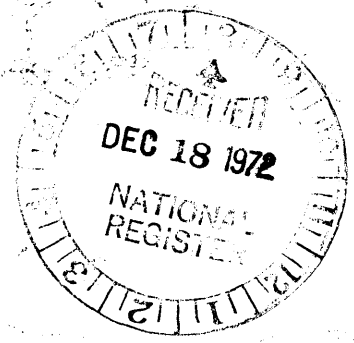
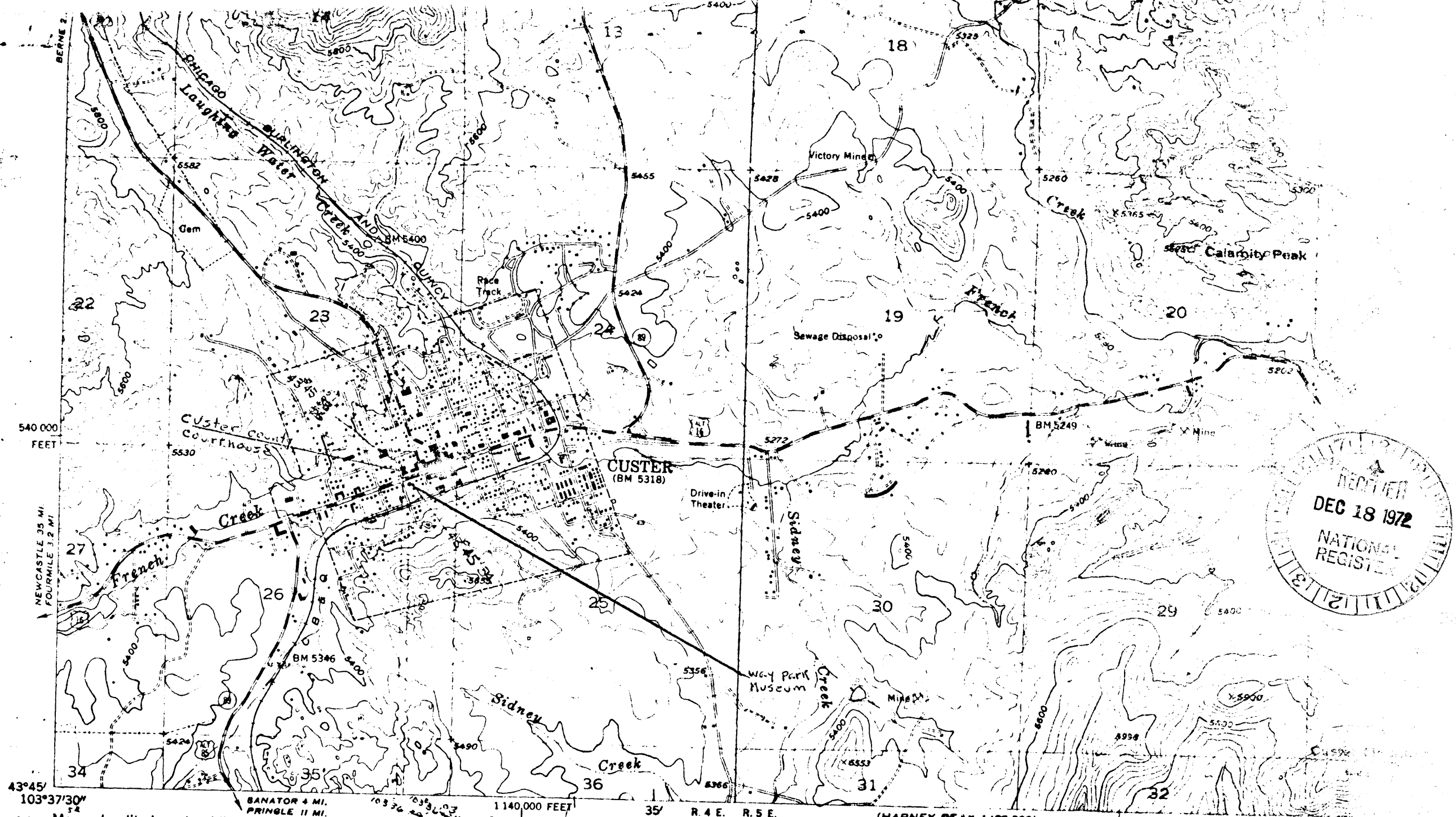

43°45'
103°37'30"

FOUR MILES

Mapped, edited, and published by the Geological Survey
Control by USGS and USC&GS

Topography from aerial photographs by multiplex methods
Aerial photographs taken 1952. Field check 1954

SANATOR 4 MI.
PRINGLE 11 MI.

1:140,000 FEET



35' R. 4 E. R. 5 E.

(HARNEY PEAK 1:125,000)

SCALE 1:24,000

