

PH0066362

**NATIONAL REGISTER OF HISTORIC PLACES
INVENTORY - NOMINATION FORM**

(Type all entries - complete applicable sections)

STATE: Colorado	
COUNTY: Denver	
FOR NPS USE ONLY	
ENTRY NUMBER 70-8-05-0013	DATE 8/25

1. NAME

COMMON:
Byers-Evans Home

AND/OR HISTORIC:
William Grey Evans

2. LOCATION

STREET AND NUMBER:
1310 Bannock St.

CITY OR TOWN:
Denver

STATE: Colorado CODE: 05 COUNTY: Denver CODE: 031

3. CLASSIFICATION

CATEGORY (Check One)	OWNERSHIP	PUBLIC ACQUISITION	STATUS	ACCESSIBLE TO THE PUBLIC
<input type="checkbox"/> District <input checked="" type="checkbox"/> Building <input type="checkbox"/> Site <input type="checkbox"/> Structure <input type="checkbox"/> Object	<input type="checkbox"/> Public <input checked="" type="checkbox"/> Private <input type="checkbox"/> Both	<input type="checkbox"/> In Process <input type="checkbox"/> Being Considered	<input checked="" type="checkbox"/> Occupied <input type="checkbox"/> Unoccupied <input type="checkbox"/> Preservation work in progress	Yes: <input type="checkbox"/> Restricted <input type="checkbox"/> Unrestricted <input checked="" type="checkbox"/> No
PRESENT USE (Check One or More as Appropriate)				
<input type="checkbox"/> Agricultural <input type="checkbox"/> Commercial <input type="checkbox"/> Educational <input type="checkbox"/> Entertainment	<input type="checkbox"/> Government <input type="checkbox"/> Industrial <input type="checkbox"/> Military <input type="checkbox"/> Museum	<input type="checkbox"/> Park <input checked="" type="checkbox"/> Private Residence <input type="checkbox"/> Religious <input type="checkbox"/> Scientific	<input type="checkbox"/> Transportation <input type="checkbox"/> Other (Specify)	<input type="checkbox"/> Comments

4. OWNER OF PROPERTY

OWNER'S NAME:
Katherine and Josephine Evans

STREET AND NUMBER:
1310 Bannock

CITY OR TOWN: Denver STATE: Colorado CODE: 05

5. LOCATION OF LEGAL DESCRIPTION

COURTHOUSE, REGISTRY OF DEEDS, ETC.:
Tax Assessor's Office

STREET AND NUMBER:
City and County Building

CITY OR TOWN: Denver STATE: Colorado CODE: 05

6. REPRESENTATION IN EXISTING SURVEYS

TITLE OF SURVEY:
Junior League Survey of Historic Denver Structures

DATE OF SURVEY: April, 1967 Federal State County Local

DEPOSITORY FOR SURVEY RECORDS:
Library of the State Historical Society of Colorado, State Museum

STREET AND NUMBER:
200 14th Avenue

CITY OR TOWN: Denver STATE: Colorado CODE: 05

SEE INSTRUCTIONS

STATE: Colorado
COUNTY: Denver
ENTRY NUMBER: 70-8-05-0013
DATE: 8/25
FOR NPS USE ONLY

7. DESCRIPTION

CONDITION	(Check One)					
	<input type="checkbox"/> Excellent	<input checked="" type="checkbox"/> Good	<input type="checkbox"/> Fair	<input type="checkbox"/> Deteriorated	<input type="checkbox"/> Ruins	<input type="checkbox"/> Unexposed
	(Check One)			(Check One)		
	<input type="checkbox"/> Altered	<input checked="" type="checkbox"/> Unaltered	<input type="checkbox"/> Moved	<input checked="" type="checkbox"/> Original Site		

DESCRIBE THE PRESENT AND ORIGINAL (if known) PHYSICAL APPEARANCE

Both the architect and builder of this Victorian house are unknown. The house was erected in 1880 for William N. Byers, publisher of the Rocky Mountain News. It stands two stories, plus a basement, and was constructed of common brick. Porch floors are tiled in red. Windows are double hung and possess leaded panes. A cast-iron widow's walk encircles the house. In 1890, Byers sold the house to the Evans family; in whose ownership the house has been ever since.

The Evans family constructed a large addition to the house in 1898. The two-story addition contains a library, 4 bedrooms and 2 baths. In 1910 a stairway was relocated in order to enlarge one of the rooms into a parlor.

Today, the house is much the same. Many of the furnishings are the originals which were used at the turn of the century. The property is immediately adjacent to the Denver Art Museum.

SEE INSTRUCTIONS

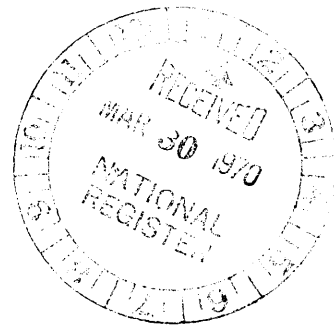

NATIONAL REGISTER OF HISTORIC PLACES
INVENTORY - NOMINATION FORM

(Continuation Sheet)

STATE	
Colorado	
COUNTY	
Denver	
FOR NPS USE ONLY	
ENTRY NUMBER	DATE
70-8-05-0013	8/25

(Number all entries) 7. Description (continued)

The style is Victorian Eclectic. Below is given a detailed description of the notable features.

Facade combines architectural features borrowed from several sources:

Classic elements in the crowning cornice, dentil range, bracket range at porch cornice, and pediment-shaped lintels over two second-story windows;

Baroque interplay of forms in the projecting facade; Segmental and Tudor arches above a second-story bay window and alternating across the porch front; and Gothic motifs in the cast and wrought iron trim.

Several ornamental features are noteworthy:

A wood porch extends across the facade worked in geometric carving and blocked areas, relieved by alternating arch forms;

Additional wood work above the second-story bay window, which has four 12-light windows, and in the crowning cornice. (All columns are geometric.)

A tin "mansarded" porch "roof" with geometric patterning supports a wrought iron cresting with Gothic-trefoil arches alternating with five-armed starburst finials. Corner posts are of an unusual looped-and-pointed design.

The arch-starburst design tops front and sides of porch "roof" and repeats as a cresting on the crowning cornice. The same tin work and scroll-patterned ironwork is used on the sides of building at second-story level.

Chimney has interesting brick detailing with projecting and recessed areas and corbelled corners at the top.

In the rear of the building the windows have rusticated sills; two are geometric leaded windows; others have arched headings.

The 1898 addition matches the original structure in color, material and height, but not in fenestration. In effect, it became a separate apartment, which is now utilized by one of the owners.



SIGNIFICANCE

PERIOD (Check One or More as Appropriate)

- | | | | |
|--|---------------------------------------|--|---------------------------------------|
| <input type="checkbox"/> Pre-Columbian | <input type="checkbox"/> 16th Century | <input type="checkbox"/> 18th Century | <input type="checkbox"/> 20th Century |
| <input type="checkbox"/> 15th Century | <input type="checkbox"/> 17th Century | <input checked="" type="checkbox"/> 19th Century | |

SPECIFIC DATE(S) (If Applicable and Known) 1880

AREAS OF SIGNIFICANCE (Check One or More as Appropriate)

- | | | | |
|--|---|--|---|
| <input type="checkbox"/> Aboriginal | <input type="checkbox"/> Education | <input type="checkbox"/> Political | <input type="checkbox"/> Urban Planning |
| <input type="checkbox"/> Prehistoric | <input type="checkbox"/> Engineering | <input type="checkbox"/> Religion/Philosophy | <input checked="" type="checkbox"/> Other (Specify) |
| <input type="checkbox"/> Historic | <input type="checkbox"/> Industry | <input type="checkbox"/> Science | <u>Home of one of</u> |
| <input type="checkbox"/> Agriculture | <input type="checkbox"/> Invention | <input type="checkbox"/> Sculpture | <u>Colorado's</u> |
| <input checked="" type="checkbox"/> Architecture | <input type="checkbox"/> Landscape Architecture | <input type="checkbox"/> Social/Humanitarian | <u>prominent</u> |
| <input type="checkbox"/> Art | <input type="checkbox"/> Literature | <input type="checkbox"/> Theater | <u>pioneer families</u> |
| <input type="checkbox"/> Commerce | <input type="checkbox"/> Military | <input type="checkbox"/> Transportation | _____ |
| <input type="checkbox"/> Communications | <input type="checkbox"/> Music | | _____ |
| <input type="checkbox"/> Conservation | | | _____ |

STATEMENT OF SIGNIFICANCE

Although the Byers-Evans House is an example of the large typical Victorian town house, its chief significance lies in its owners' prominence in Colorado's history and development. William Evans, son of John Evans, Colorado's first territorial governor, acquired the house from its original owner, Byers, in 1890. John Evans, as a Coloradoan, founded the Colorado Seminary (now Denver University), sponsored or developed railroads and industry. His son, William Grey Evans, carried on the progressive attitude of the governor. He participated in the construction of four railroads, organized the Denver Electric & Cable Company and became president of its successor, the Denver Tramway Company. In 1902 William became President of the Board of Trustees of the University of Denver.

Ann Evans, daughter of the governor was a prominent figure in Denver's cultural affairs. Among other things, she was the co-founder of the Denver Art Museum. She was also a member of the New York World's Fair Commission, co-founder of the Central City Opera House Commission, and a member of the Denver Library Commission.

The Byers-Evans House is regarded as a monument to the spirit of the Evans tradition. The present owners, Katherine and Josephine Evans maintain the house much as it was during their father's lifetime.

SEE INSTRUCTIONS

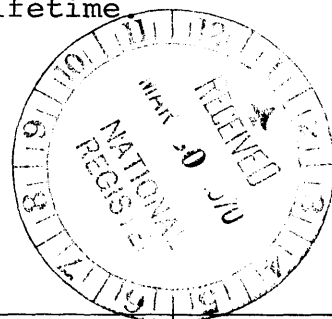

9. MAJOR BIBLIOGRAPHICAL REFERENCES

Denver Dwelling & Descendents, by Sally Davis and Betty Baldwin

Denver's Historic Mansions, by Edith Eudora Kohl

10. GEOGRAPHICAL DATA

LATITUDE AND LONGITUDE COORDINATES DEFINING A RECTANGLE LOCATING THE PROPERTY				O R	LATITUDE AND LONGITUDE COORDINATES DEFINING THE CENTER POINT OF A PROPERTY OF LESS THAN TEN ACRES									
CORNER	LATITUDE				LONGITUDE			LATITUDE			LONGITUDE			
	Degrees	Minutes	Seconds	Degrees	Minutes	Seconds	Degrees	Minutes	Seconds	Degrees	Minutes	Seconds		
NW	°	'	"	°	'	"	39	°	44'	14"	104	°	59'	22"
NE	°	'	"	°	'	"								
SE	°	'	"	°	'	"								
SW	°	'	"	°	'	"								

APPROXIMATE ACREAGE OF NOMINATED PROPERTY: LESS THAN TEN

LIST ALL STATES AND COUNTIES FOR PROPERTIES OVERLAPPING STATE OR COUNTY BOUNDARIES

STATE:	CODE	COUNTY	CODE

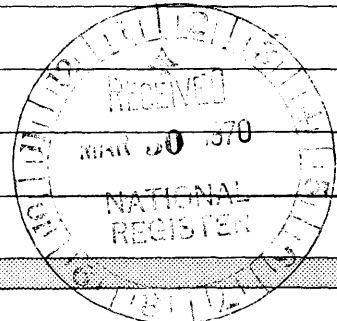

13/500900/4398380

SEE INSTRUCTIONS

11. FORM PREPARED BY

NAME AND TITLE: Robert Fink, Assistant to the Director

ORGANIZATION: State Historical Society of Colorado DATE: 3/10/70

STREET AND NUMBER: 200 Fourteenth Avenue

CITY OR TOWN: Denver STATE: Colorado CODE: 05

12. STATE LIAISON OFFICER CERTIFICATION

As the designated State Liaison Officer for the National Historic Preservation Act of 1966 (Public Law 89-665), I hereby nominate this property for inclusion in the National Register and certify that it has been evaluated according to the criteria and procedures set forth by the National Park Service. The recommended level of significance of this nomination is:

National State Local

Name: Stephen H. Hart

Title: State Liaison Officer of Colorado

Date: 9/13/70

NATIONAL REGISTER VERIFICATION

I hereby certify that this property is included in the National Register.

Ernest Allen Conroy
Chief, Office of Archeology and Historic Preservation
AUG 25 1970

Date: _____

ATTEST: William J. [Signature]
Keeper of The National Register

Date: JUN 23 1970

(14th Avenue)

Bannock Street

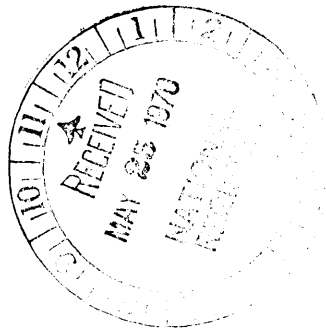

(alley)

North



Byers-Evans House, Denver
Map from Sanborn Insurance Maps
of Denver, vol. 2, 1929
Scale: 1" = 50'

property line

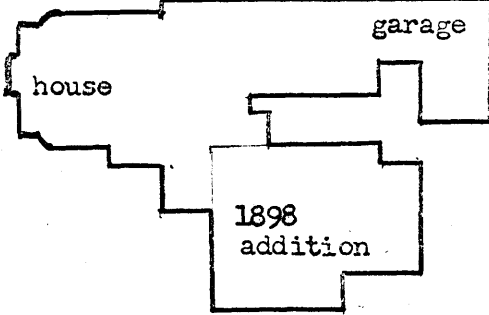

West 13th Avenue