

United States Department of the Interior  
National Park Service

For NPS use only

National Register of Historic Places  
Inventory—Nomination Form

received JUN 27 1985

date entered JUL 25 1985

See instructions in *How to Complete National Register Forms*  
Type all entries—complete applicable sections

1. Name

historic First National Bank of Bristol

and or common Same

2. Location

street & number 500 State Street N/A not for publication

city, town Bristol N/A vicinity of

state Tennessee code 047 county Sullivan code 163

3. Classification

Category	Ownership	Status	Present Use
<input type="checkbox"/> district	<input type="checkbox"/> public	<input type="checkbox"/> occupied	<input type="checkbox"/> agriculture
<input checked="" type="checkbox"/> building(s)	<input checked="" type="checkbox"/> private	<input type="checkbox"/> unoccupied	<input checked="" type="checkbox"/> commercial
<input type="checkbox"/> structure	<input type="checkbox"/> both	<input checked="" type="checkbox"/> work in progress	<input type="checkbox"/> educational
<input type="checkbox"/> site	<b>Public Acquisition</b>	<b>Accessible</b>	<input type="checkbox"/> entertainment
<input type="checkbox"/> object	<input type="checkbox"/> in process	<input type="checkbox"/> yes: restricted	<input type="checkbox"/> government
	<input checked="" type="checkbox"/> being considered	<input checked="" type="checkbox"/> yes: unrestricted	<input type="checkbox"/> industrial
		<input type="checkbox"/> no	<input type="checkbox"/> military
			<input type="checkbox"/> museum
			<input type="checkbox"/> park
			<input type="checkbox"/> private residence
			<input type="checkbox"/> religious
			<input type="checkbox"/> scientific
			<input type="checkbox"/> transportation
			<input type="checkbox"/> other:

4. Owner of Property

name Robert Mandler and John G. Byers, Jr.

street & number P.O. Box 3707

city, town Bristol N/A vicinity of state Tennessee 37620

5. Location of Legal Description

courthouse, registry of deeds, etc. Sullivan County Courthouse

street & number Main Street

city, town Blountville state Tennessee 37617

6. Representation in Existing Surveys

title N/A has this property been determined eligible?  yes  no

date N/A N/A federal  state  county  local

depository for survey records N/A

city, town N/A state N/A

## 7. Description

<b>Condition</b>		<b>Check one</b>	<b>Check one</b>
<input checked="" type="checkbox"/> excellent	<input type="checkbox"/> deteriorated	<input type="checkbox"/> unaltered	<input checked="" type="checkbox"/> original site
<input type="checkbox"/> good	<input type="checkbox"/> ruins	<input checked="" type="checkbox"/> altered	<input type="checkbox"/> moved date _____
<input type="checkbox"/> fair	<input type="checkbox"/> unexposed		

### Describe the present and original (if known) physical appearance

The First National Bank of Bristol is located on the southwest corner of State and Fifth Streets in downtown Bristol, Tennessee (pop. 23,986). Built around 1905 with a reinforced concrete structure, the rectangular shaped building is faced with grey-white limestone, pink granite and beige brick. The three story eclectic style commercial building evinces Beaux Arts and Classical Revival design elements. The bank is distinguished by a classically pedimented main entry, limestone pilasters and columns, and decorative spandrel panels, piers and medallions. Having undergone few exterior alterations, the First National Bank of Bristol has retained its architectural integrity.

Only two elevations of the bank are exposed. The north (front) elevation is three bays wide and the east elevation is seven bays wide. Both elevations are symmetrically designed and embellished with similar decorative elements. The exterior surface of the bank is composed of a double course of rusticated limestone blocks that rest on a foundation course of chiselled granite blocks. Limestone block Ionic columns and pilasters separate windows and the door on the first story. An entablature located between the first and second stories is comprised of an architrave with fascias, an undecorated frieze, and a cornice embellished with egg and dart molding, bead and reel molding, and ogee shaped molding. Quoins and Ionic pilasters decorated with acanthus leaves between the volutes and embellished with lions heads and garlands along the shaft flank the windows on the second and third stories. Quoins are also located at the edges of the bank. Located directly above the first story pilasters, beige brick fills the spaces between the quoins, creating double toned piers on the upper stories. The entablature, quoins, and pilasters are made of chiselled limestone.

The entablature at the roof line exhibits a more elaborate decorative treatment than the lower one. The architrave is ornamented with a beaded molding course while the frieze is embellished with an egg and dart molding course. Modillions, trefoil molding, and acanthus leaves embellish the cornice. Surmounting this is a parapet decorated with ogee molding. Medallions depicting the head of Liberty and an American eagle are found on the frieze above the brick piers. Two eagles are on the north elevation while six alternating eagles and Liberty heads are distinguishing features on the south elevation. All of the ornament-  
ed work is chiselled limestone.

Situated in the central bay of the north facade, the main entry is flanked by two Ionic columns that are embellished with leaf and floral designs. Above this is a frieze inscribed with "First National Bank" and a pediment with a molded cornice. The original bronze double doors are extant. They are ornamented with bronze rivets along the edges and have large glass panels. A transom window in a bronze casing surmounts the doors. Two Ionic pilasters, enriched with egg and dart molding, flank the pedimented entry while two single light windows are located between the pilasters and the edges of the building on the first story. Fenestration on the second and third stories consists of one set of centrally placed paired windows and two single windows. All of the windows on the facade (and the east elevation) are single lights. The paired windows are separated by Doric pilasters while spandrel panels with ornamental molding delineate the spaces between the second and third story windows.

Fenestration on the east elevation consists of seven bays of paired single light windows on the second and third stories. The first story windows are divided into thirds with metal strips. Originally, the windows were sash windows with transoms. Spandrel panels and

**United States Department of the Interior  
National Park Service**

**National Register of Historic Places  
Inventory—Nomination Form**

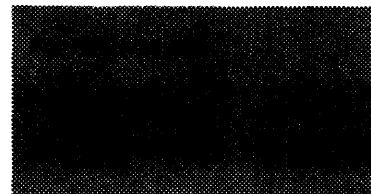

Continuation sheet First National Bank of

Item number 7

Page 2

Bristol

Doric pilasters, identical to those on the north facade, ornament the upper two stories.

The first story interior contains a modern wood and formica tellers' counter along the western wall. This replaced the original wood, glass and cast iron tellers' cages which were located along the east wall. The floor where the original cages stood is wood while the rest of the floor is marble, although this is now covered with carpeting. A 1921 York Safe and Vault Company vault is located on the southern wall. An aluminum door in the vestibule replaced an interior bronze door. Until the mid-1940s when an elevator was installed, a staircase located at the back of the first story was the only access to the upper stories.

The upper stories, now partitioned with particle board, were usually leased for office space. The original 1905 safe, manufactured by the Herring-Hall-Marvin Safe Company of Hamilton, Ohio, is located on the second story. Two other safes are located in the basement.

At present the bank is unused, although there are plans to remodel it for use as a restaurant.

## 8. Significance

Period	Areas of Significance—Check and justify below			
<input type="checkbox"/> prehistoric	<input type="checkbox"/> archeology-prehistoric	<input type="checkbox"/> community planning	<input type="checkbox"/> landscape architecture	<input type="checkbox"/> religion
<input type="checkbox"/> 1400–1499	<input type="checkbox"/> archeology-historic	<input type="checkbox"/> conservation	<input type="checkbox"/> law	<input type="checkbox"/> science
<input type="checkbox"/> 1500–1599	<input type="checkbox"/> agriculture	<input type="checkbox"/> economics	<input type="checkbox"/> literature	<input type="checkbox"/> sculpture
<input type="checkbox"/> 1600–1699	<input checked="" type="checkbox"/> architecture	<input type="checkbox"/> education	<input type="checkbox"/> military	<input type="checkbox"/> social/ humanitarian
<input type="checkbox"/> 1700–1799	<input type="checkbox"/> art	<input type="checkbox"/> engineering	<input type="checkbox"/> music	<input type="checkbox"/> theater
<input type="checkbox"/> 1800–1899	<input checked="" type="checkbox"/> commerce	<input type="checkbox"/> exploration/settlement	<input type="checkbox"/> philosophy	<input type="checkbox"/> transportation
<input checked="" type="checkbox"/> 1900–	<input type="checkbox"/> communications	<input type="checkbox"/> industry	<input type="checkbox"/> politics/government	<input type="checkbox"/> other (specify)
		<input type="checkbox"/> invention		

Specific dates 1905-1935

Builder/Architect Pettyjohn Construction Company

### Statement of Significance (in one paragraph)

The Frist National Bank of Bristol (c. 1905) is being nominated under National Register criteria A and C for its local historical and architectural significance. Located at 500 State Street in Bristol, Sullivan County, Tennessee, the bank is historically significant to the city of Bristol for its role in the community's economic growth and commercial development. Architecturally, the bank is an attractive example of eclectic design that combines Beaux Arts and Classical Revival elements. Although the interior of the bank has been modernized, the exterior has had only minor alterations, and has retained its historic and architectural integrity.

In 1868, Joseph Rhea Anderson (1819-1888), a prominent businessman and political figure in Bristol, Tennessee, founded and became the president of the Bank of Bristol, a state chartered bank. The bank was located on the west corner of Main Street (now State Street) and Bank Street. (This building is still extant but has been altered.) Anderson and his brother-in-law, Colonel John G. King, re-organized the bank as the First National Bank of Bristol under a federal charter in 1874. The bank then had capital valued at \$50,000. This charter was surrendered in 1878 and the bank rechartered through the state as the Bank of Bristol. In 1882, the federal charter was regained and the bank renamed the National Bank of Bristol. By 1887 the bank capital had increased to \$100,000.

Anderson died in 1888 and his son John C. Anderson assumed the presidency of the bank, a position he held until his death in 1912. John C. Anderson's brother-in-law John H. Caldwell served as bank vice-president from the 1890s until the early 1930s. It was during John C. Anderson's presidency that the current bank building, the third one, was constructed. (A second bank building at 414 Main Street, now State Street, is non-extant.) In 1905, with the bank again known as the First National Bank of Bristol, the current reinforced concrete structure was built, probably by the Pettyjohn Construction Company of Lynchburg, Virginia. This firm was active in many of the southwestern Virginia and north-eastern Tennessee towns that were located on major railroad lines. Pettyjohn Construction Company is credited with the construction of the Norfolk and Western Railroad Station (c. 1902) in Bristol, Virginia, directly across the border from Bristol, Tennessee.

Joseph Rhea Anderson and his son John C. Anderson were prominent members of the Bristol community. In 1852 the elder Anderson purchased 100 acres of land in King's Meadow (present day Bristol) and built a house and store. He subdivided the property into lots of 50'x150', asking \$100.00 for each one. When Bristol was incorporated in 1856, he became its first mayor. Anderson donated some of the land and funds for King College (c. 1866) in Bristol, an association made through his wife, Melinda W. King.

John C. Anderson followed the civic and financial footsteps of his father. In 1880, he was elected to the board of aldermen and in 1891 he was elected to serve a six year term as mayor. Among his various business endeavors he was the treasurer for the Holston National Building and Loan Association, the vice-president for the Bristol Door and Lumber Company, and the treasurer for Hamilton-Bacon-Hamilton (a fertilizer and seed company).

## 9. Major Bibliographical References

See Continuation Sheet.

## 10. Geographical Data

Acreeage of nominated property ~~less than one acre~~

Quadrangle name Bristol, Tennessee

Quadrangle scale 1:24,000

UTM References

A 

1	7	3	9	4	2	2	0	4	0	5	0	3	5	0
Zone			Easting					Northing						

B 

Zone			Easting					Northing						

C 

Zone			Easting					Northing						

D 

Zone			Easting					Northing						

E 

Zone			Easting					Northing						

F 

Zone			Easting					Northing						

G 

Zone			Easting					Northing						

H 

Zone			Easting					Northing						

**Verbal boundary description and justification** The nominated property, rectangular in shape and less than one acre in size, is bounded on the north by State Street, on the east by Fifth Street, and on the west and south by adjacent property lines. It includes all land historically associated with the First National Bank of Bristol.

List all states and counties for properties overlapping state or county boundaries

state N/A code N/A county N/A code N/A

state N/A code N/A county N/A code N/A

## 11. Form Prepared By

name/title Martha Gray Hagedorn - Historic Preservation Planner

organization First TN Development District date March 21, 1985

street & number 207 N. Boone St., Suite 800 telephone (615) 928-0224

city or town Johnson City state Tennessee 37601

## 12. State Historic Preservation Officer Certification

The evaluated significance of this property within the state is:

national  state  local

As the designated State Historic Preservation Officer for the National Historic Preservation Act of 1966 (Public Law 89-665), I hereby nominate this property for inclusion in the National Register and certify that it has been evaluated according to the criteria and procedures set forth by the National Park Service.

Deputy  
State Historic Preservation Officer signature Herbert L. Hager

title Executive Director, Tennessee Historical Commission date 6/11/85

For NPS use only

I hereby certify that this property is included in the National Register

Entered in the  
National Register

date 7-25-85

Keeper of the National Register

Attest:

date

Chief of Registration

**United States Department of the Interior  
National Park Service**

**National Register of Historic Places  
Inventory—Nomination Form**

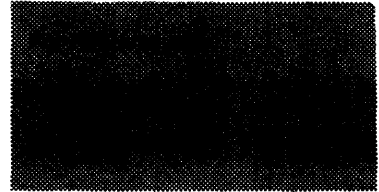

First National Bank of  
Bristol

Continuation sheet

Item number 8

Page 2

The First National Bank was a commercial bank which was owned by a stock holding corporation. It furnished the capital for new businesses and homes, concentrating its lending on the Bristol area. The bank continued to expand its business and in 1921 a twenty-nine ton vault was installed on the first floor of the bank. First National advertisements in the 1920s editions of the Bristol City Directories attribute the success of the bank to the "businessmen of Bristol and the farmers in the surrounding county."

The First National Bank weathered the economic crisis of the 1930s without collapse, although its outstanding loans wiped out the capital surplus. To avert disaster, First National redivided its stock, offering an increased number of shares and absorbed two Bristol banks which had failed, the Bank of Bristol and the Citizen's Bank. Carl A. Jones assumed the presidency in 1932, presiding over the restructuring. Advertisements in later years would stress the security and dependability of the bank.

In 1961 the bank merged with the First National Bank of Kingsport and became the First National Bank of Sullivan County. The First American National Corporation purchased the bank in 1982, moving its offices to 840 State Street in Bristol, Tennessee. Currently unused, the First National Bank of Bristol building will be remodeled for use as a restaurant. It is a historically and architecturally significant resource in Bristol, Tennessee.

**United States Department of the Interior  
National Park Service**

**National Register of Historic Places  
Inventory—Nomination Form**

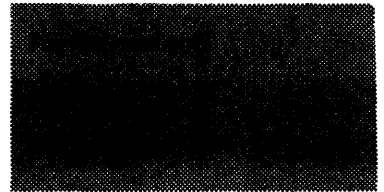

Continuation sheet First National Bank of Bristol Item number 9 Page 2

Bristol, Virginia-Tennessee Directory, 1896. Bristol, TN: Johnson Directory Co., 1896.

Bristol, Virginia-Tennessee Directories, 1905-1946. Bristol, TN: Hill Directory Co.

Davenport, Clayton, former First National vice-president. Telephone interview with Martha Hagedorn, 26, 27 February 1985.

The First National Bank: 50th Anniversary, 1868-1918. Bristol, TN: King Printing Co., 1918.

Goodspeed's History of East Tennessee. Nashville: Goodspeed Publishing Co., 1887.

Herald Courier (Bristol), 1 July 1947, p.3.

"Industrial Supplement: Bristol - A Story of its early history, its prominent citizens, houses, industries, resources, and future prospects." Courier (Bristol), 2 October 1904.

Loving, Robert S. Double Destiny: The Story of Bristol, Tennessee-Virginia. Bristol, TN: King Printing Co., 1951.

Mainous, Ike, former First National officer. Telephone interview with Martha Hagedorn, 1 March 1985.

Piper, Mrs. Harry, daughter of John C. Anderson. Personal interview with Martha Hagedorn, 26 February 1985.

Preston, T. W. The Story of Bristol, Vols. I and II. Bristol, TN: King Printing Co., nd.

Sullivan County. Deed Books, 1902-1984. Courthouse. Blountville, Tennessee.

Tennessee Bankers' Association. Telephone interview with Martha Hagedorn, 27 February 1985.

Virginia Historic Landmarks Commission. "Bristol Union Railway Station." National Register Nomination, 1980.

Washington County, Virginia

Sullivan County, Tennessee

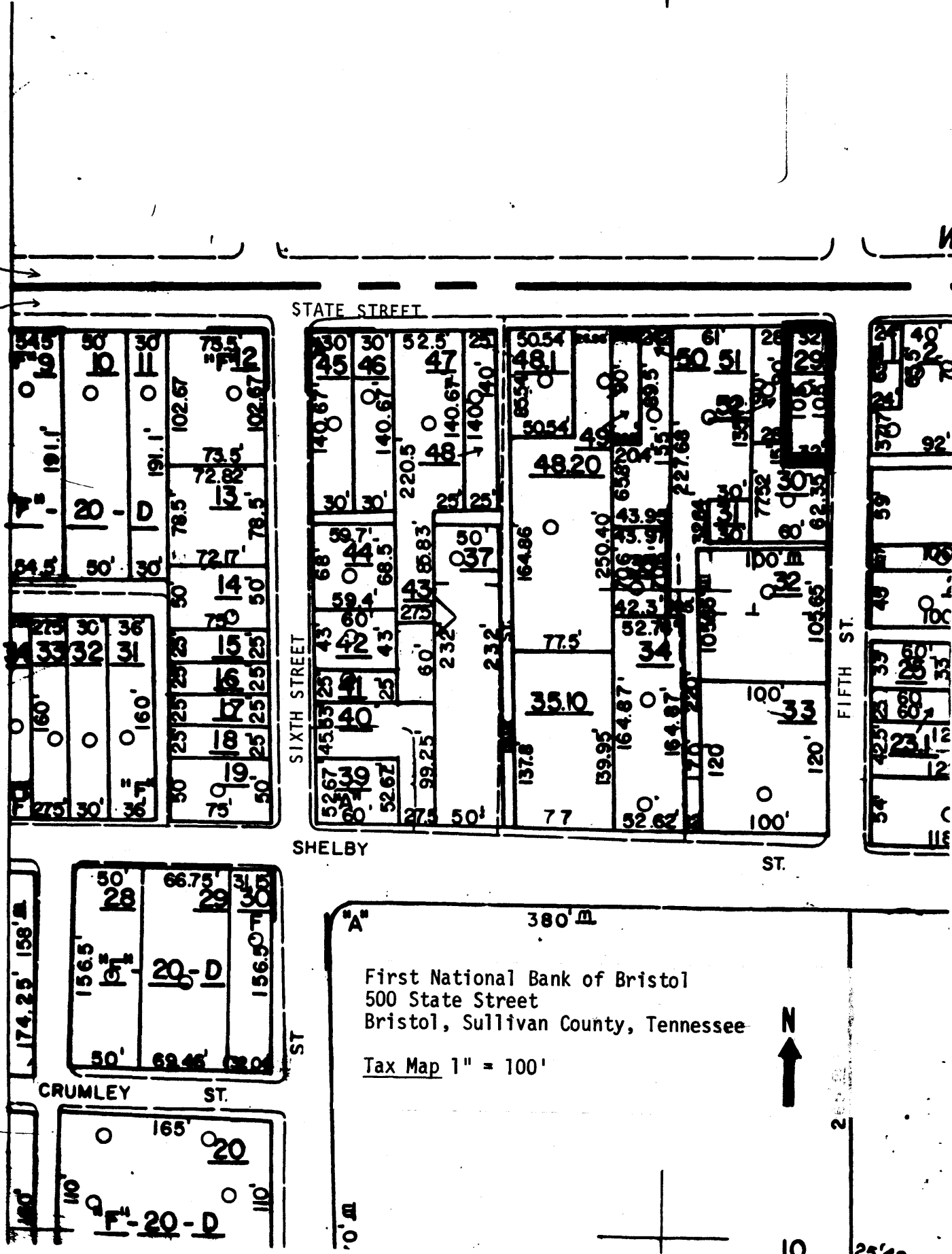

First National Bank of Bristol  
 500 State Street  
 Bristol, Sullivan County, Tennessee

Tax Map 1" = 100'



10

2

25