

HISTORIC PRESERVATION UNIT
DEPARTMENT OF CULTURE & HISTORY
SCIENCE & CULTURE CENTER
CHARLESTON, WEST VIRGINIA 25305

File No: 4
 Theme(s):
 Neg No(s):
 USGS Quad:
 UTM Ref: 17/452130/4346260

DISTRICT: SITE: BUILDING: STRUCTURE: OBJECT

1. NAME(S), historic/common: ^{ggg} Bethel A.M.E. Church

(Downtown Parkersburg map)

2. LOCATION, street/road: 820 Clay St.

TAX MAP- LOT #

80-168 city/town: Parkersburg, WV 26101
(incorporated/unincorporated)

3. USE/FUNCTION, present: vacant

(public/private)
restricted

original: church

4. OWNER/ADDRESS, present: Bethel African M.E. Church
address above

(public/private)

original: African M.E. Church

5. PHOTO/SKETCH OF: 8112-R3-F2-3

7. PLAN (include approx. dimensions):



6. LOCALE/ENVIRONMENT (map):

8. ACREAGE (approx):

42' x 70' x 80'

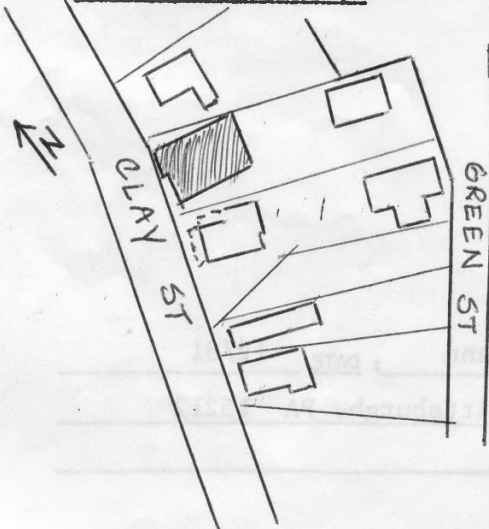

COUNTY: Wood
 Survey Region: _____
 Planning District: _____

9. DESCRIPTION (clarify as appropriate): See attached

a. Exterior Fabric

stone _____
 brick _____
 concrete _____
 stucco _____ X
 weatherboard _____
 clapboard _____
 board & batten _____
 shingle _____
 other _____

b. Structural System

masonry _____ X
 frame _____
 log _____
 metal _____
 other _____
 foundation stone _____

c. Roofing Material

wood _____
 metal _____ X
 slate _____
 tile _____
 asphalt _____
 composition _____
 other _____

d. Associated Structures (use/type):

outbuildings _____

 dependencies _____

 other _____

e. Integrity (include dates):

original site/relocated _____
 alterations stucco _____

 additions _____

f. Condition:

excellent _____
 good _____
 fair _____ X
 deteriorated _____
 abandoned _____

g. Threats:

Deferred maintenance.

10. SIGNIFICANCE (use additional sheet if necessary):

a. Architect/Builder/Engineer:

b. Style/Period: Vernacular
 Gothic Revival

c. Date(s): 1887 (date stone)

This was one of three Black churches in the City of Parkersburg. Its design is the very simplest interpretation of a common ecclesiastical style. It is the oldest black church building in west-central West Virginia and commands a site only a block from the central areas of the downtown. It is a quiet sentinel of a settled and older neighborhood significant in the black history of Wood County.

11. BIBLIOGRAPHY:

12. FORM PREPARED BY Eliza Smith, Christina Mann ; DATE 12/81

a. Address Allegheny Square West, Pittsburgh, PA 15212

b. Organization Landmarks Planning,

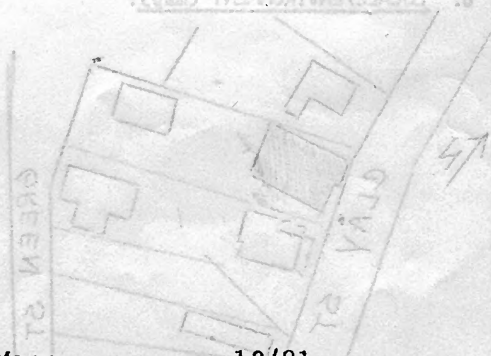

Bethel A.M.E. Church
820 Clay St.
80-168

Located in a neighborhood of slightly deteriorating wood frame houses of the late 19th century, this is a simple 2 story church building of 1 by 3 bays. It is faced in stucco. The metal gable roof has small exposed rafter ends. The 2nd story windows are slightly arched d/s (2/2); in the NW end, the window is stained glass. The 1st story windows are d/s (2/2) set in segmental arched apertures. A datestone is above the central door on the NW.



Rehoboth A.M.E. Church
210 Clay St.
80-158

located in a neighborhood of slightly deteriorating wood frame houses of
the late 19th century, this is a simple 2 story church building of 1 by 3
bays. It is faced in stucco. The metal gable roof has small exposed rafters
ends. The 2nd story windows are slightly arched 8/8 (2/2) in the NW end,
the window is stained glass. The 1st story windows are 8/8 (2/2) set in
segmental arched apertures. A balcony is above the central door on the NW

8112 R3-F3