

OHIO HISTORIC INVENTORY

Ohio Historic Preservation Office
Ohio Historical Center
Columbus, Ohio 43211

JUN 27 1976

17

Summit

Lock No. 27 ("Johnny Cake Lock")

1. No. 17

2. County
Summit

3. Location of Negatives
OHS

4. Present Name(s)
Lock No. 27 ("Johnny Cake Lock")

5. Other Name(s)

6. Specific Location
on private road approx. 400 ft. east of intersection of Riverview & Everett Rds.

7. City or Town If Rural, Township & Vicinity
Everett

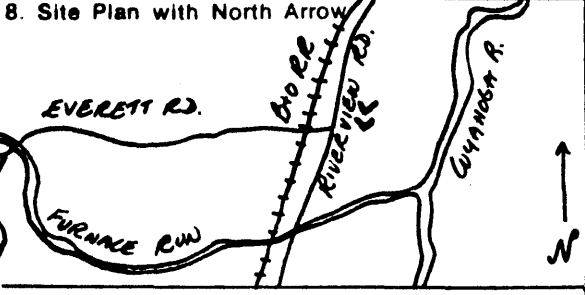

9. Coordinates

Lat. _____ Long. _____

U.T.M. Reference

17	452140	4561240
Zone	Easting	Northing

10. Site Building Structure Object

11. On National Register? Yes No

12. Is It Eligible? Yes No

13. Part of Estab. Hist. Dist.? Yes No

14. District Potent'l? Yes No

16. Thematic Category
F, H, I

17. Date(s) or Period
1825-1827

18. Style or Design

19. Architect or Engineer

20. Contractor or Builder

21. Original Use, If apparent
canal lock

22. Present Use
--

23. Ownership Public Private

24. Owner's Name & Address, if known
Akron Metro. Park District
976 Treaty Line Rd., Akron

25. Open to Public? unrestricted Yes No

26. Local Contact Person or Organization
Summit Co. Hist. Soc.

27. Other Surveys in Which Included
included in "Ohio & Erie Canal historic civil engineering landmark, Ohio Council ASCE"

Approx. Acreage: less than 1

28. No. of Stories

29. Basement? Yes No

30. Foundation Material

31. Wall Construction
load-bearing masonry

32. Roof Type & Material

33. No. of Bays Front _____ Side _____

34. Wall Treatment
cut stone/concrete

35. Plan Shape rectangle

36. Changes (Explain in #42) Addition Altered Moved

37. Condition
poor
XXXXXX fair

38. Preservation Underway? Yes No

39. Endangered? By What? Yes No

40. Visible from Public Road? Yes No

41. Distance from and Frontage on Road

42. Further Description of Important Features
Lock is standard mitered gate type. The lock chamber is 90 feet long by 15 feet wide. Of cut sandstone construction, it was repaired with concrete c. 1905. Both gates are missing. Some water in lock chamber, canal itself is dry south of Peninsula. There is an original piece of hardware--probably the wrought iron collar bearing that held the oak gate post--in the east lock wall at south end.



43. History and Significance
According to tradition, in the spring of 1828 a flood in Furnace Run swept into the canal and stopped navigation. "...the crews and passengers were compelled to live, water-bound, as best they could. They were at last reduced to johnnycake, which constituted their diet for a number of days." Thus the origin of the name for this lock at Everett, a canal stopover then known as

44. Description of Environment and Outbuildings Unionville.

In the small residential neighborhood that constitutes the village of Everett.

45. Sources of Information
History of Summit County, ed. William Henry Perrin (Chicago: Baskin & Battey, Historical Publishers, 1881), p. 540
Frank Wilcox, The Ohio Canals, selec. and ed. William A. McGill (Kent, O.: Kent State University Press, 1969), see esp. p. 21 on lock hardware.

46. Prepared by
Carol Poh Miller

47. Organization

48. Date 3/76 49. Revision Date(s)