

H13 WO PH 0041645
472

Form 10-300
(July 1969)

UNITED STATES DEPARTMENT OF THE INTERIOR
NATIONAL PARK SERVICE

NATIONAL REGISTER OF HISTORIC PLACES INVENTORY - NOMINATION FORM

(Type all entries - complete applicable sections)

STATE: Arizona	
COUNTY: Yavapai	
FOR NPS USE ONLY	
ENTRY NUMBER 71-10,04,0012	DATE 10/7/71

1. NAME

COMMON:
Fort Verde (1879-1890) District

AND/OR HISTORIC:
Camp Verde (1868-1879) Camp Lincoln (1865-1868)

2. LOCATION

STREET AND NUMBER:
see section 7 for full description of street location

CITY OR TOWN:
Camp Verde Zip 86322

STATE Arizona	CODE 04	COUNTY: Yavapai	CODE 025
-------------------------	-------------------	---------------------------	--------------------

3. CLASSIFICATION

CATEGORY (Check One)	OWNERSHIP	STATUS	ACCESSIBLE TO THE PUBLIC
<input checked="" type="checkbox"/> District <input type="checkbox"/> Site <input type="checkbox"/> Object	<input checked="" type="checkbox"/> Public <input type="checkbox"/> Private <input type="checkbox"/> Both	<input checked="" type="checkbox"/> Occupied <input type="checkbox"/> Unoccupied <input type="checkbox"/> Preservation work in progress	Yes: <input checked="" type="checkbox"/> Restricted <input type="checkbox"/> Unrestricted <input type="checkbox"/> No
PRESENT USE (Check One or More as Appropriate)			
<input type="checkbox"/> Agricultural <input type="checkbox"/> Commercial <input type="checkbox"/> Educational <input type="checkbox"/> Entertainment	<input type="checkbox"/> Government <input type="checkbox"/> Industrial <input type="checkbox"/> Military <input checked="" type="checkbox"/> Museum	<input checked="" type="checkbox"/> Park <input type="checkbox"/> Private Residence <input type="checkbox"/> Religious <input type="checkbox"/> Scientific	<input type="checkbox"/> Transportation <input type="checkbox"/> Other (Specify) _____ _____

4. OWNER OF PROPERTY

OWNER'S NAME:
State of Arizona, Parks Board

STREET AND NUMBER:
1688 West Adams

CITY OR TOWN:
Phoenix

STATE:
Arizona

CODE
04

*Pre-1937 Arizona owner
T.A. PARSONS
BOX 457
CAMP VERDE, AZ, 86322 7/25/77*

5. LOCATION OF LEGAL DESCRIPTION

COURTHOUSE, REGISTRY OF DEEDS, ETC.:
Tax Assessor's Office

STREET AND NUMBER:
Yavapai County Courthouse

CITY OR TOWN:
Prescott

STATE:
Arizona

CODE
04

6. REPRESENTATION IN EXISTING SURVEYS

TITLE OF SURVEY:
Historic American Buildings Survey

DATE OF SURVEY:
1937

DEPOSITORY FOR SURVEY RECORDS:
HABSI Office - Library of Congress

STREET AND NUMBER:
Washington

CITY OR TOWN:
Washington

STATE:
D. C.

CODE
08

SEE INSTRUCTIONS

STATE: **Arizona**

COUNTY: **Yavapai**

ENTRY NUMBER: **71-10,04,0012**

DATE: **10/7/71**

FOR NPS USE ONLY

SEE INSTRUCTIONS

7. DESCRIPTION

CONDITION	(Check One)					
	<input type="checkbox"/> Excellent	<input type="checkbox"/> Good	<input checked="" type="checkbox"/> Fair	<input type="checkbox"/> Deteriorated	<input type="checkbox"/> Ruins	<input type="checkbox"/> Unexposed
	(Check One)			(Check One)		
	<input type="checkbox"/> Altered	<input checked="" type="checkbox"/> Unaltered		<input type="checkbox"/> Moved	<input checked="" type="checkbox"/> Original Site	

DESCRIBE THE PRESENT AND ORIGINAL (if known) PHYSICAL APPEARANCE

Fort Verde was established at its present location in the Spring of 1871. It was laid out in a typical quadrangle surrounding a parade ground--officers' row on one side and enlisted men's quarters on the opposite. In this instance, the corrals were behind the enlisted quarters.

Today, all of the buildings along the southwest side of the quadrangle have either been destroyed or altered beyond recognition. But four buildings along the south and east sides have survived from the early 1870's, when they were built. Three are officers' quarters and one is the "office" shown on the map (see diagram on continuation sheet.)

A. This is a private residence today. Originally, the building was identical to building "B" described below.

B. The north building is a one story structure built in an "L" shape with a porch along the west or parade ground side of the house. It is built of adobe, stuccoed on the outside and plastered inside. It has a wood-shingled gable roof and pine plank floors.

C. This building is identified in photographs as the commanding officer's home. It is a two-story building with gambrel shingled roof and dormers. It is a house with vertical batten siding. It also has a porch along the street side and a rear wing which makes the plan that of an inverted "L". This building is now furnished with period decor and is open to the public.

D. On the south side of the parade ground, at the east side, is the office. This is a one story building of adobe with a wooden porch running the length of its north side. It, too, has pine plank floors. The office now serves as a museum.

In designating the extent of this site as a district, the following, tentative boundaries are listed:

- The parade ground of the Fort is bordered by three named streets and one unnamed, designated street, to the south:
 - Hance Street (north)
 - Coppinger Street (east)
 - Woods Street (west)

Furthermore, it is stated that the boundaries of the nominated district be considered as extending 300 feet from the center line of the designated roadways, outward; in order to include the extant structures, foundations, etc.

SIGNIFICANCE

PERIOD (Check One or More as Appropriate)

- Pre-Columbian | 16th Century | 18th Century | 20th Century
 15th Century | 17th Century | 19th Century

SPECIFIC DATE(S) (If Applicable and Known) 1879-1890

AREAS OF SIGNIFICANCE (Check One or More as Appropriate)

- | | | | |
|--|--|---|--|
| <input type="checkbox"/> Aboriginal | <input type="checkbox"/> Education | <input type="checkbox"/> Political | <input type="checkbox"/> Urban Planning |
| <input type="checkbox"/> Prehistoric | <input type="checkbox"/> Engineering | <input type="checkbox"/> Religion/Phi- | <input type="checkbox"/> Other (Specify) |
| <input type="checkbox"/> Historic | <input type="checkbox"/> Industry | osophy | _____ |
| <input type="checkbox"/> Agriculture | <input type="checkbox"/> Invention | <input type="checkbox"/> Science | _____ |
| <input checked="" type="checkbox"/> Architecture | <input type="checkbox"/> Landscape | <input type="checkbox"/> Sculpture | _____ |
| <input type="checkbox"/> Art | Architecture | <input type="checkbox"/> Social/Human- | _____ |
| <input type="checkbox"/> Commerce | <input type="checkbox"/> Literature | itarian | _____ |
| <input type="checkbox"/> Communications | <input checked="" type="checkbox"/> Military | <input type="checkbox"/> Theater | _____ |
| <input type="checkbox"/> Conservation | <input type="checkbox"/> Music | <input type="checkbox"/> Transportation | _____ |

STATEMENT OF SIGNIFICANCE

Fort Verde is the best preserved and least altered of any military post associated with General Crook's 1872-73 campaign against the northern Apaches. Furthermore, it played a key role in that campaign.

Apache raiders kept Arizona in turmoil during the 1860's and '70's, retarding settlement and development by whites. Lt. Col. George Crook was given command of Arizona troops and told to end Apache depredations. He was within hours of launching a campaign in the Fall of 1871 when notified to abort operations so as not to interfere with the Vincent Colyer group which was to make peace with and establish reservations for the Apaches. The Wickenburg massacre occurred on the heels of the Colyer visit, enabling Crook to reschedule the campaign. Then General O. O. Howard arrived to enter into a "treaty" with Cochise and the southern Apaches. However, Howard agreed to a campaign against hostile Mohave and Tonto Apaches in the northern sector.

Crook began his campaign in mid-November, 1872, using five columns of cavalry, each guided by Apache scouts and trailed by top-notch pack trains. Camp Verde, Fort McDowell, and Camp Grant were the main posts involved in the operation. Because of its location closest to the heart of the renegade country, Camp Verde was the "playmaker" and

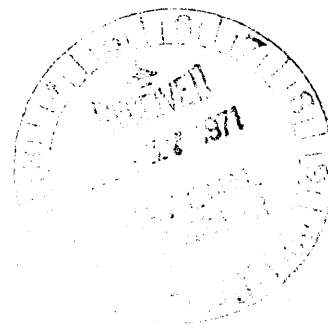

SEE INSTRUCTIONS

9. MAJOR BIBLIOGRAPHICAL REFERENCES

Fort Verde: An Era of Men and Courage, Nicholas J. Eason
Fort Verde Museum Society, 1966

Frontier Military Outposts of Arizona, Ray Brandes; Dale
S. King, publisher, Globe, 1960 pp 70-73

Conquest of Apacheria, Dan Thrapp;
University of Oklahoma Press, 1967

10. GEOGRAPHICAL DATA

LATITUDE AND LONGITUDE COORDINATES DEFINING A RECTANGLE LOCATING THE PROPERTY			O R	LATITUDE AND LONGITUDE COORDINATES DEFINING THE CENTER POINT OF A PROPERTY OF LESS THAN TEN ACRES		
CORNER	LATITUDE	LONGITUDE		LATITUDE	LONGITUDE	
	Degrees Minutes Seconds	Degrees Minutes Seconds		Degrees Minutes Seconds	Degrees Minutes Seconds	
NW	34 ° 33 ' 59 "	111 ° 51 ' 12 "				
NE	34 ° 33 ' 59 "	111 ° 51 ' 04 "				
SE	34 ° 33 ' 50 "	111 ° 51 ' 04 "				
SW	34 ° 33 ' 50 "	111 ° 51 ' 12 "				

APPROXIMATE ACREAGE OF NOMINATED PROPERTY: **12**

LIST ALL STATES AND COUNTIES FOR PROPERTIES OVERLAPPING STATE OR COUNTY BOUNDARIES

STATE:	CODE	COUNTY	CODE

11. FORM PREPARED BY

NAME AND TITLE:
Wallace Vegors, Preservation Officer

ORGANIZATION: **Arizona State Parks Board** DATE: **20 May 1970**

STREET AND NUMBER:
1688 West Adams

CITY OR TOWN: **Phoenix** STATE: **Arizona** CODE: **04**

12. STATE LIAISON OFFICER CERTIFICATION NATIONAL REGISTER VERIFICATION

<p>As the designated State Liaison Officer for the National Historic Preservation Act of 1966 (Public Law 89-665), I hereby nominate this property for inclusion in the National Register and certify that it has been evaluated according to the criteria and procedures set forth by the National Park Service. The recommended level of significance of this nomination is:</p> <p>National <input type="checkbox"/> State <input checked="" type="checkbox"/> Local <input type="checkbox"/></p> <p>Name <u><i>Dennis McCarthy</i></u> Dennis McCarthy</p> <p>Title <u>Director, Arizona State Parks Board</u></p> <p>Date <u>8/12/71</u></p>	<p>I hereby certify that this property is included in the National Register.</p> <p><u><i>Ernest A. Connally</i></u> Chief, Office of Archeology and Historic Preservation</p> <p>Date OCT 7 1971</p> <p>ATTEST:</p> <p><u><i>William J. Stewart</i></u> Keeper of The National Register</p> <p>Date SEP 29 1971</p>
--	--

SEE INSTRUCTIONS

NATIONAL REGISTER OF HISTORIC PLACES
INVENTORY - NOMINATION FORM

(Continuation Sheet)

STATE	
Arizona	
COUNTY	
Yavapai	
FOR NPS USE ONLY	
ENTRY NUMBER	DATE
71.10.04.0012	10/7/71

(Number all entries)

7. Description (continued.)

The district limitations described herein correspond roughly to the county zoning considered by Yavapai County for the unincorporated village of Camp Verde. In the zoning, the area of the Fort is zoned for "Future Public Use" and takes in the parade ground, the extant military quarters, and a series of non-historic structures on the west. Where non historic, non-military buildings exist within the proposed district, only the site is considered as included within the historic district; not the later buildings.

A more detailed description of each of the four extant Ft. Verde buildings follows on additional continuation sheets.



NATIONAL REGISTER OF HISTORIC PLACES
INVENTORY - NOMINATION FORM

(Continuation Sheet)

STATE	
Arizona	
COUNTY	
Yavapai	
FOR NPS USE ONLY	
ENTRY NUMBER	DATE
71.10.04.0012	10/5/71

(Number all entries)

7. Description (continued)

Below is given an 1877 sketch of the Fort Verde layout. The large letters are added to indicate the extant buildings.

North is towards the top of the page.

Plan, Camp Verde, August 1877.

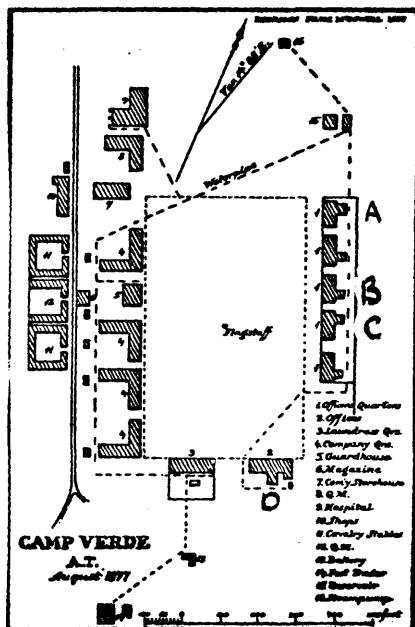

NATIONAL REGISTER OF HISTORIC PLACES
INVENTORY - NOMINATION FORM

(Continuation Sheet)

STATE Arizona	
COUNTY Yavapai	
FOR NPS USE ONLY	
ENTRY NUMBER	DATE
71.10.04.0012	10/7/71

(Number all entries)

8. Significance (continued)

main supply post, although Crook and his troops ranged between all of them.

Following a hard six months campaign, during which scores of Apache rancherias were attacked with little or no advanced warning, resulting in the death or capture of hundreds of Apaches, the Tontos and Mohave-Apaches began surrendering at the forts. The back of the Apache resistance was broken when Cha-lipun, representing about 2000 Mohave-Apaches, surrendered to Crook on April 6th, 1873, reportedly on the steps of the commanding officer's house at Ft. Verde.

Individual outbreaks and the 1882-86 southern Apache campaign kept the army busy in Arizona for years to come. But, relative peace was established in the north. Camp Verde was renamed Fort Verde in 1879 and was abandoned in 1890.

Principally, the parade ground, the office, the commanding officer's quarters, and the two officers' quarters are seeking nomination to the National Register.

The original location of Camp Lincoln was approximately one mile north of the present town. Camp Lincoln was renamed Camp Verde in 1868. In 1871, Camp Verde was relocated to its present site, and, on April 5, 1879, the name changed once again to Fort Verde.

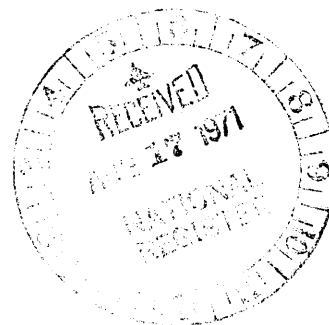

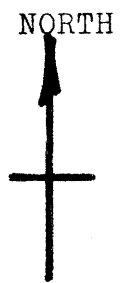
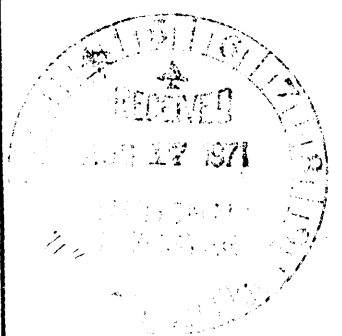
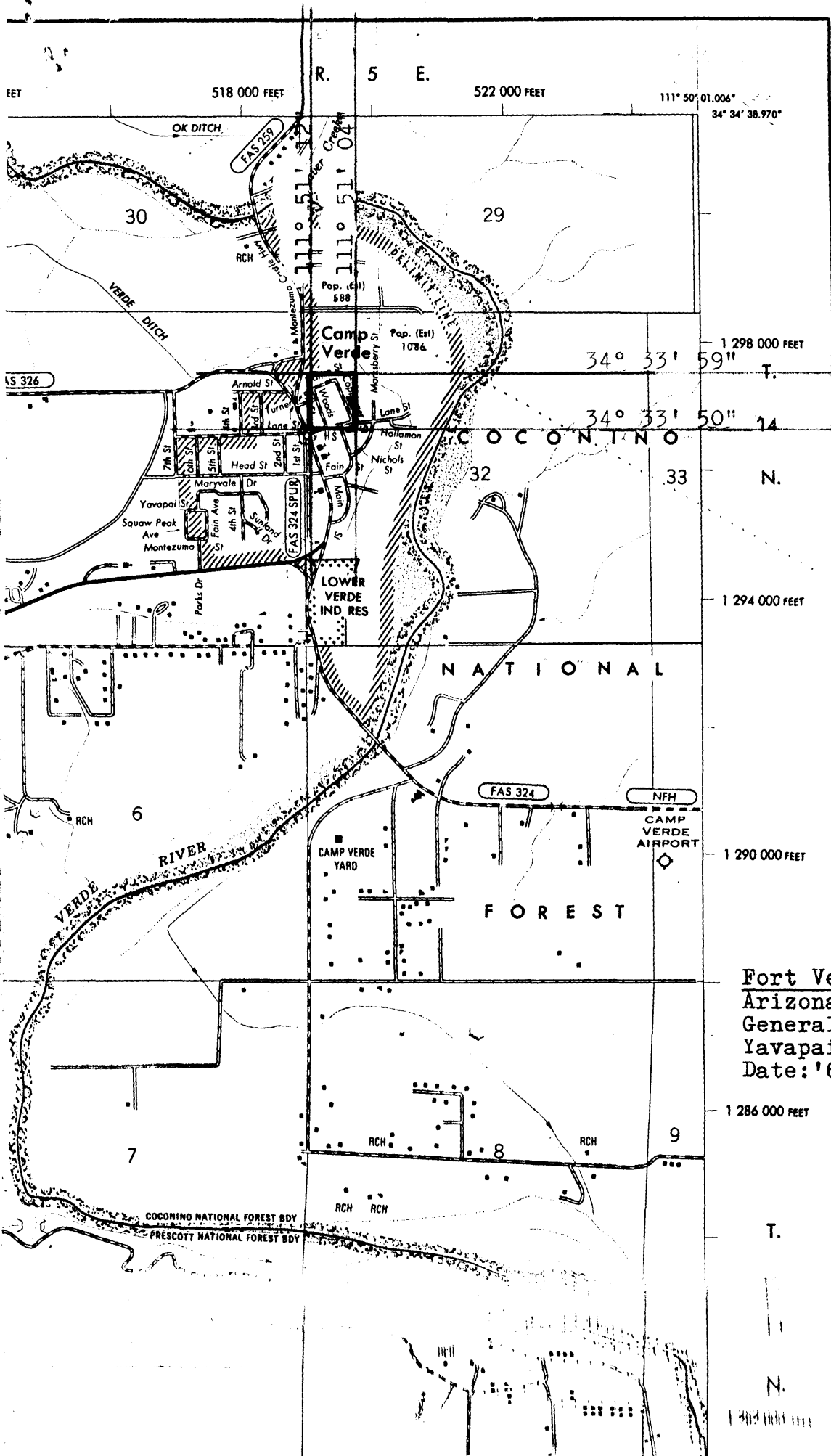

Fort Verde, Camp Verde,
 Arizona
 General Highway Map of
 Yavapai County by AHD
 Date: '67, Scale: 1"=2000'

1 298 000 FEET
 34° 33' 59" T.
 34° 33' 50" 14
 33 N.
 1 294 000 FEET
 1 290 000 FEET
 1 286 000 FEET
 T.
 N.
 1 282 000 FEET