

IDENTIFICATION

Historic name: Andy Wood Log House and Willie Wood Blacksmith Shop
 Common name: same
 Address: SR 1 Route 1
Georgetown, Tennessee
 Owner's name: Willie Wood
 Owner's address: Route 1
Georgetown, Tennessee 37366
 Classification: Building-private
 Tax map reference: Dist. 1, Map 81, Parcel 26
 Acreage: 2.6 acres
 UTM reference: Zone 16 N3913960
E688240

STATUS

Open to public: Yes No Restricted
 Visible from road: Yes No
 Occupied: Yes No
 Present use: Private residence; Industrial
 Current condition: Fair; Poor
 Alterations: Rear shed addition (ca.1930) attached to house.
 Site features: N/A

HISTORY

Date of construction: House ca. 1890; Blacksmith Shop 1912
 Architect/builder: House-Andy Wood, Blacksmith Shop-Willie Wood (son of Andy Wood)
 Original or previous owners: Andy Wood, original; Willie Wood, current.
 Original use: Residence; Industrial
 Theme/s: Primary Commercial
Secondary Black History
 Other N/A

SOURCES

Bibliographical data: Interview with Willie Wood, Georgetown, TN., April 19, 1979.
Bureau of the Census, 1980.
1850 and 1880 Census Schedules
 Form prepared by: Stephen T. Rogers
 Title: Cultural Resource Surveyor
 Organization: Tennessee Historical Commission
 Date: 12/3/80

DESCRIPTION

The Andy Wood Log House (#39) is a one story single pen log building sided with weatherboards. Simple in design and scale, the Wood House rests on a foundation of stone piers. A metal gable roof covers the rectangular shaped house and a large exterior end stone chimney is located on the east elevation. The facade, north elevation, has a single bay and is covered by a simple shed roof supported by square posts. A single casement window is located on each gable end. There are no windows on the rear, and only a single leaf door with vertical boards is located on the rear elevation. A rear shed addition (ca.1930) is attached to the rear of the house. Exhibiting the same simplicity as the house, a one story rectangular shaped framed blacksmith shop is sided with board and battens, and covered by a metal gable roof. The blacksmith shop has a one story side addition of the same construction type that extends from the facade. The facade (north elevation) of the shop has three doors built of vertical boards. The building's

SIGNIFICANCE

The Wood Log House and Blacksmith Shop are important buildings relating to black history and industry. This is particularly important because Meigs County historically has had a small black population, 1.8% in 1980 census. Built by Andy Wood, ca. 1890, the log house has not been modernized by the addition of electricity and is the best example of a single pen log building in the county. The rural blacksmith has traditionally been important to the county. The 1850 census listed 28 blacksmiths, representing 24.5% of the occupations other than farmer. By 1880, the number dropped to 10 blacksmiths and the Wood Shop is the only one still in operation with in Meigs County. Built in 1912 by Willie Wood, son of Andy, the blacksmith shop is filled

PHOTOGRAPHIC DATA

Photographer: Stephen T. Rogers
Date: 10/17/80
Negatives on file: Tennessee Historical
Commission
Photographer facing: N & E elevation-facing SW
Photograph number 47 of 55 South elevation-
48 of 55, facing north

CONTINUATION

Description:
only window is located at the rear in the area of the forge.

Significance:
with a large variety of tools and equipment. The shop, like the log cabin, has no electricity, and the machinery is powered by hand or gasoline engine. Both buildings remain in the Wood family.

SITE PLAN - Include North Arrow

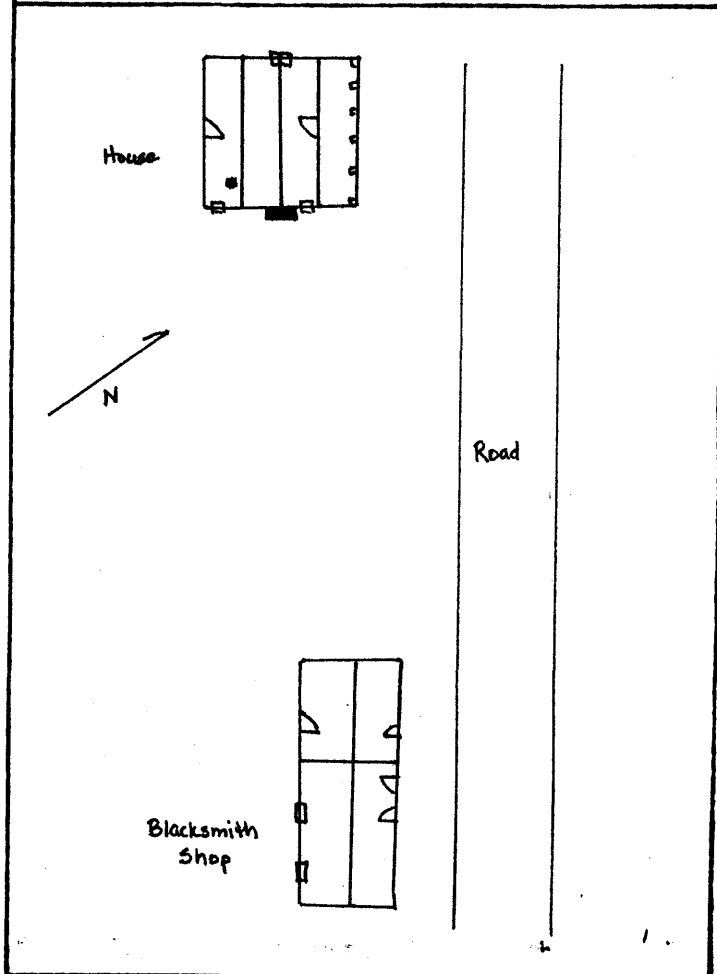

**United States Department of the Interior
Heritage Conservation and Recreation Service**

**National Register of Historic Places
Inventory—Nomination Form**



Continuation sheet Historic Resources of Meigs County, Tennessee Item number Identification Page 2

MEIGS COUNTY MULTIPLE RESOURCE NOMINATION - Andy Wood Log House and Willie Wood Blacksmith Shop (#39) and (#40)

Verbal Boundary Description and Justification:

39. and 40. The boundaries begin at a point 1250 feet northwest of the intersection of Blythes Ferry Road and East View Road, thence northwest along the south side of Blythes Ferry Road 350 feet to a fence line, thence southwest along fence line 325 feet, thence southeast along fence line 350 feet, thence northeast 325 feet along fence line to the beginning, continuing approximately 2.6 acres on which the buildings sit.

Historic Resources of Meigs County,
Tennessee
(Partial Inventory: Historic and
Architectural Resources)

ANDY WOOD LOG HOUSE and
WILLIE WOOD BLACKSMITH SHOP (#s 39 and 40)

