

PH0660841

DATA SHEET

UNITED STATES DEPARTMENT OF THE INTERIOR
NATIONAL PARK SERVICE

FOR NPS USE ONLY
RECEIVED JAN 24 1978
DATE ENTERED JUN 23 1978

NATIONAL REGISTER OF HISTORIC PLACES
INVENTORY -- NOMINATION FORM

SEE INSTRUCTIONS IN HOW TO COMPLETE NATIONAL REGISTER FORMS
TYPE ALL ENTRIES -- COMPLETE APPLICABLE SECTIONS

1 NAME

HISTORIC

AND/OR COMMON

** W.H. Shipman Residence

2 LOCATION

STREET & NUMBER

141 Kaiulani Street

NOT FOR PUBLICATION

CITY, TOWN

Hilo

CONGRESSIONAL DISTRICT

VICINITY OF

2nd

STATE

Hawaii

CODE
15

COUNTY
Hawaii

CODE
001

3 CLASSIFICATION

CATEGORY

- DISTRICT
- BUILDING(S)
- STRUCTURE
- SITE
- OBJECT

OWNERSHIP

- PUBLIC
- PRIVATE
- BOTH
- PUBLIC ACQUISITION**
- IN PROCESS
- BEING CONSIDERED

STATUS

- OCCUPIED
- UNOCCUPIED
- WORK IN PROGRESS
- ACCESSIBLE**
- YES: RESTRICTED
- YES: UNRESTRICTED
- NO

PRESENT USE

- AGRICULTURE
- MUSEUM
- COMMERCIAL
- PARK
- EDUCATIONAL
- PRIVATE RESIDENCE
- ENTERTAINMENT
- RELIGIOUS
- GOVERNMENT
- SCIENTIFIC
- INDUSTRIAL
- TRANSPORTATION
- MILITARY
- OTHER:

4 OWNER OF PROPERTY

NAME

Multiple Ownership - Mailing Address: W.H. Shipman Ltd.

STREET & NUMBER

P.O. Box 950

CITY, TOWN

Keaau, Hawaii

VICINITY OF

STATE

Hawaii

5 LOCATION OF LEGAL DESCRIPTION

COURTHOUSE,
REGISTRY OF DEEDS, ETC.

Bureau of Conveyances

STREET & NUMBER

1151 Punchbowl Street

CITY, TOWN

Honolulu

STATE

Hawaii

6 REPRESENTATION IN EXISTING SURVEYS

TITLE

Hawaii Register of Historic Places, Site #10-35-7405

DATE

Initially registered 12/5/73

FEDERAL STATE COUNTY LOCAL

DEPOSITORY FOR
SURVEY RECORDS

State of Hawaii, Department of Land and Natural Resources,
State Historic Preservation Office

CITY, TOWN

Honolulu

STATE

Hawaii

7 DESCRIPTION

CONDITION		CHECK ONE	CHECK ONE
<input type="checkbox"/> EXCELLENT	<input type="checkbox"/> DETERIORATED	<input type="checkbox"/> UNALTERED	<input checked="" type="checkbox"/> ORIGINAL SITE
<input checked="" type="checkbox"/> GOOD	<input type="checkbox"/> RUINS	<input checked="" type="checkbox"/> ALTERED	<input type="checkbox"/> MOVED DATE _____
<input type="checkbox"/> FAIR	<input type="checkbox"/> UNEXPOSED		

DESCRIBE THE PRESENT AND ORIGINAL (IF KNOWN) PHYSICAL APPEARANCE

The Shipman Sisters' house at Hilo is a noteworthy example of a turn of the century large mansion-style family home. It is located on Reed's Island in the outskirts North of Hilo on a sloping ridge between the Wailuku River and small Waikapu stream. The South and East side (rear) of the site slopes precipitously down to the stream gulch, making a spectacular contrast with the extensive lawns and gardens surrounding the house. These gardens are informally laid out in a manner that offers striking vistas of the main house. Curving driveways lead up to the main entrance and to the service areas in the rear.

The complex of buildings includes the large main house prominently located, a smaller guest house, a garage, and a servant's quarters in back on the edge of the stream gulch.

The main house is a large two-story and attic, wood structure with wide verandas around the first floor front and sides, and an imposing second floor porch. The house is set about four feet above the grade in front, sloping off to a high basement on the sides and rear.

The main roof is a steep pitched hip with four large intersecting gables facing the front, rear, and sides. The verandas on the first floor have low pitched shed roofs with hips at the corners. A striking feature is the two-story rounded tower on the Northeast corner with a conical roof. The tower is further accented by the circular veranda encloses it at the first floor level. There is a large formal porte-cochere on the North front, covering the driveway which leads through from both directions. Broad wood steps lead up to the veranda and main entrance doors.

Although the general aspect of the house is assymetrical and informal, it does take on a certain formal character because of size, opulence, Georgian detail, imposing main entrance and particularly the wide verandas which enclose the front and sides. The verandas are supported by classic Doric columns set on molded pedestals. A turned wood balustrade and classic cornice are present - all in the best wood Georgian tradition.

Other noteworthy details are the large double-hung rounded wood sashes with large curved panes of clear glass. These occur in the round tower windows and the curved bay on North wall of the drawing room (leading to veranda).

All main windows are furnished with adjustable wood louvred shutters, painted green against white trim.

Outside walls are beveled wood siding painted white with molded wood trim. The main gables are shingled with sawed scallop pattern.

(Continued)

8 SIGNIFICANCE

PERIOD	AREAS OF SIGNIFICANCE -- CHECK AND JUSTIFY BELOW			
<input type="checkbox"/> PREHISTORIC	<input type="checkbox"/> ARCHEOLOGY-PREHISTORIC	<input type="checkbox"/> COMMUNITY PLANNING	<input type="checkbox"/> LANDSCAPE ARCHITECTURE	<input type="checkbox"/> RELIGION
<input type="checkbox"/> 1400-1499	<input type="checkbox"/> ARCHEOLOGY-HISTORIC	<input type="checkbox"/> CONSERVATION	<input type="checkbox"/> LAW	<input type="checkbox"/> SCIENCE
<input type="checkbox"/> 1500-1599	<input type="checkbox"/> AGRICULTURE	<input type="checkbox"/> ECONOMICS	<input type="checkbox"/> LITERATURE	<input type="checkbox"/> SCULPTURE
<input type="checkbox"/> 1600-1699	<input checked="" type="checkbox"/> ARCHITECTURE	<input type="checkbox"/> EDUCATION	<input type="checkbox"/> MILITARY	<input type="checkbox"/> SOCIAL/HUMANITARIAN
<input type="checkbox"/> 1700-1799	<input type="checkbox"/> ART	<input type="checkbox"/> ENGINEERING	<input type="checkbox"/> MUSIC	<input type="checkbox"/> THEATER
<input checked="" type="checkbox"/> 1800-1899	<input type="checkbox"/> COMMERCE	<input type="checkbox"/> EXPLORATION/SETTLEMENT	<input type="checkbox"/> PHILOSOPHY	<input type="checkbox"/> TRANSPORTATION
<input checked="" type="checkbox"/> 1900-	<input type="checkbox"/> COMMUNICATIONS	<input type="checkbox"/> INDUSTRY	<input type="checkbox"/> POLITICS/GOVERNMENT	<input type="checkbox"/> OTHER (SPECIFY)
		<input type="checkbox"/> INVENTION		

SPECIFIC DATES Prior to 1900 BUILDER/ARCHITECT J. R. Wilson

STATEMENT OF SIGNIFICANCE

This site is being recommended for Valuable status based on:

1. Its architectural style. It is one of the few remaining Victorian mansions in the islands;
2. Its association with W. H. Shipman, Hilo businessman and Big Island rancher, and his family.

The house was built prior to 1900 by J. R. Wilson, a Hilo businessman. It was the first house to be built in the exclusive area known at that time as Reed's Island, and was constructed at a cost of \$13,000.00. The house was sold in 1900 to W. H. Shipman.

William Herbert Shipman was born in 1854 at Lahainaluna, the son of missionary parents, William Cornelius and Jane Stobie Shipman. He came to Hilo as a young boy after the death of his father. His mother had moved the family to Hilo to begin a school for both Hawaiian and white children in order to support the family. He attended Puna-hou School and Knox College in Galesburg, Illinois.

Returning from college, he became manager of Kapapala Ranch, which was owned by his stepfather W. H. Reed, and C. E. Richardson. His early introduction to cattle was instrumental in his later days as one of East Hawaii's best known ranchers.

Records at the Hawaii Archives show that as early as 1883 he had applied for a butcher's license. He also served as government land appraiser for the Hilo district in 1887. In 1889 he became executive inspector of animals for the island of Hawaii.

After leaving Kapapala, Shipman began raising cattle on his own in the Kapoho area of the Puna district. He and Capt. Herman Elderts expanded their interests and bought land in Keaau which was being auctioned off to provide funds for the Lunalilo Home in Honolulu. Shipman later bought out Eldert's and S. M. Damon's interests in the Keaau property. The ranch expanded and land was also leased from the Waiakea Mill Company in Waiakea. When that property was taken back to be used for cane, Shipman obtained the lease for John T. Baker's land at Puu Oo (see HRHP Site #7473).

Shipman was president of the Hilo Meat Company. He died in 1943.

The house is lived in and maintained by two of W. H. Shipman's daughters.

9 MAJOR BIBLIOGRAPHICAL REFERENCES

Paradise of the Pacific, December, 1901, p.48
Thrum, Hawaii Annual, 1928, p.105
Records, Archives of Hawaii
Honolulu Star Bulletin, 7-8-43
Honolulu Advertiser, 7-10-43
 University of Hawaii Biography Files

10 GEOGRAPHICAL DATA

ACREAGE OF NOMINATED PROPERTY 4.941 A

UTM REFERENCES

A	<u>05</u>	<u>280210</u>	<u>2182685</u>	B			
	ZONE	EASTING	NORTHING		ZONE	EASTING	NORTHING
C				D			

VERBAL BOUNDARY DESCRIPTION

The W. H. Shipman Residence is bounded by Kaiulani Street on the North and East sides. It is bounded by Waikapu Stream on the South and by the Tax Map Parcel 2-3-15:37, on the West. The Residence itself is comprised of two tax map parcels 2-3-15:4 and 2-3-15:5.

LIST ALL STATES AND COUNTIES FOR PROPERTIES OVERLAPPING STATE OR COUNTY BOUNDARIES

STATE	CODE	COUNTY	CODE

11 FORM PREPARED BY

NAME / TITLE

Gary Cummins and M. Mitchell

December, 1973

ORGANIZATION

State Historic Preservation Office

DATE

548-7460

STREET & NUMBER

P.O. Box 621

TELEPHONE

CITY OR TOWN

Honolulu

STATE

Hawaii

12 STATE HISTORIC PRESERVATION OFFICER CERTIFICATION

THE EVALUATED SIGNIFICANCE OF THIS PROPERTY WITHIN THE STATE IS:

NATIONAL

STATE

LOCAL

As the designated State Historic Preservation Officer for the National Historic Preservation Act of 1966 (Public Law 89-665), I hereby nominate this property for inclusion in the National Register and certify that it has been evaluated according to the criteria and procedures set forth by the National Park Service.

STATE HISTORIC PRESERVATION OFFICER SIGNATURE

TITLE

Jane L. Silverman

SHPO

DATE

Jan. 10, 1978

FOR NPS USE ONLY

I HEREBY CERTIFY THAT THIS PROPERTY IS INCLUDED IN THE NATIONAL REGISTER

ATTEST

Walter C. ...

DIRECTOR, OFFICE OF ARCHAEOLOGY AND HISTORIC PRESERVATION

KEEPER OF THE NATIONAL REGISTER

KEEPER OF THE NATIONAL REGISTER

DATE

C2378

DATE

6-6-78

UNITED STATES DEPARTMENT OF THE INTERIOR
NATIONAL PARK SERVICE

**NATIONAL REGISTER OF HISTORIC PLACES
INVENTORY -- NOMINATION FORM**

FOR NPS USE ONLY	
RECEIVED	JAN 24 1978
DATE ENTERED	JUN 23 1978

CONTINUATION SHEET

ITEM NUMBER 7 PAGE 1

The first floor interior consists of a central main entrance hall leading to spacious living rooms on either side, with Georgian wood detail and sumptuous furnishings. In the rear are service rooms and a one-story dining room.

(Limited description note: no entry to second floor; only superficial view of first floor.)

A formal wood molded stair leads to the upper floor, which consist mainly of bedrooms with services.

Architecturally, this house is an excellent example of the turn of the century formal style and opulent living. It is still in use and is in good condition and well maintained.

It is a style that has gone completely out of date, principally due to modern materials, methods, tastes and modes of living. It should be preserved both for its intrinsic usefulness and historical connotations.

UNITED STATES DEPARTMENT OF THE INTERIOR
NATIONAL PARK SERVICE

FOR NPS USE ONLY

RECEIVED JAN 24 1978

DATE ENTERED

NATIONAL REGISTER OF HISTORIC PLACES
INVENTORY -- NOMINATION FORM

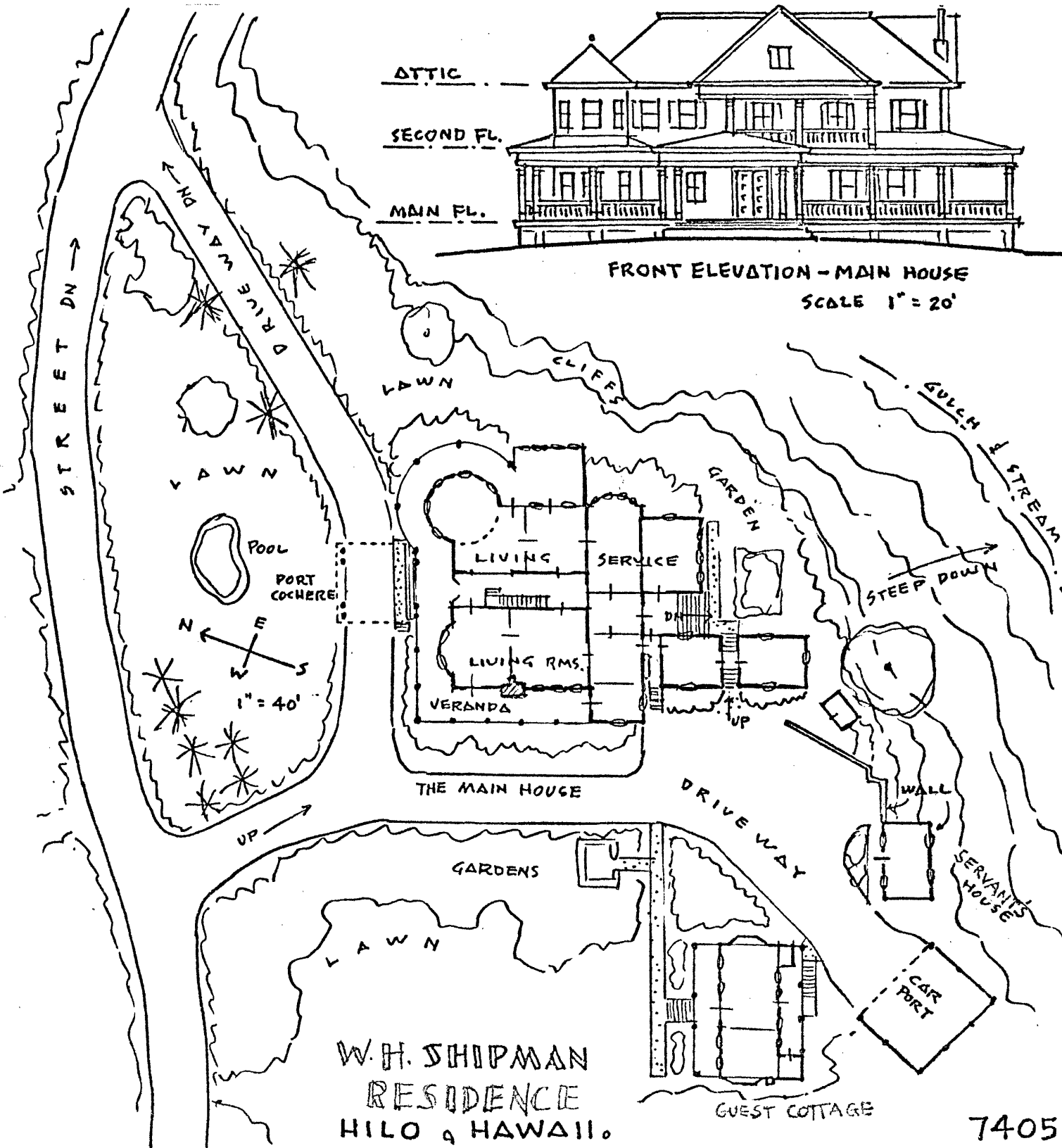

W. H. SHIPMAN
RESIDENCE
HILO, HAWAII.

7405