

UNITED STATES DEPARTMENT OF THE INTERIOR  
NATIONAL PARK SERVICE

FOR NPS USE ONLY

RECEIVED MAY 8 1980  
DATE ENTERED JUN - 4 1980

NATIONAL REGISTER OF HISTORIC PLACES  
INVENTORY -- NOMINATION FORM

SEE INSTRUCTIONS IN HOW TO COMPLETE NATIONAL REGISTER FORMS  
TYPE ALL ENTRIES -- COMPLETE APPLICABLE SECTIONS

**1 NAME**

HISTORIC

5 HOKES MILL COVERED BRIDGE

AND/OR COMMON

**2 LOCATION**

STREET & NUMBER Secondary Route 62  
at the Hokes Mill Crossing of Second Creek

NOT FOR PUBLICATION

CITY, TOWN

CONGRESSIONAL DISTRICT

X VICINITY OF Roncerverte

2

STATE

CODE

COUNTY

CODE

West Virginia

54

Greenbrier

025

**3 CLASSIFICATION**

CATEGORY	OWNERSHIP	STATUS	PRESENT USE	
<input type="checkbox"/> DISTRICT	<input checked="" type="checkbox"/> PUBLIC	<input checked="" type="checkbox"/> OCCUPIED in service	<input type="checkbox"/> AGRICULTURE	<input type="checkbox"/> MUSEUM
<input type="checkbox"/> BUILDING(S)	<input type="checkbox"/> PRIVATE	<input type="checkbox"/> UNOCCUPIED	<input type="checkbox"/> COMMERCIAL	<input type="checkbox"/> PARK
<input checked="" type="checkbox"/> STRUCTURE	<input type="checkbox"/> BOTH	<input type="checkbox"/> WORK IN PROGRESS	<input type="checkbox"/> EDUCATIONAL	<input type="checkbox"/> PRIVATE RESIDENCE
<input type="checkbox"/> SITE	<input checked="" type="checkbox"/> PUBLIC ACQUISITION	<input checked="" type="checkbox"/> ACCESSIBLE	<input type="checkbox"/> ENTERTAINMENT	<input type="checkbox"/> RELIGIOUS
<input type="checkbox"/> OBJECT	<input type="checkbox"/> IN PROCESS	<input type="checkbox"/> YES: RESTRICTED	<input type="checkbox"/> GOVERNMENT	<input type="checkbox"/> SCIENTIFIC
	<input type="checkbox"/> BEING CONSIDERED	<input checked="" type="checkbox"/> YES: UNRESTRICTED	<input type="checkbox"/> INDUSTRIAL	<input checked="" type="checkbox"/> TRANSPORTATION
		<input type="checkbox"/> NO	<input type="checkbox"/> MILITARY	<input type="checkbox"/> OTHER:

**4 OWNER OF PROPERTY**

NAME

West Virginia Department of Highways

STREET & NUMBER

1900 Washington Street, East

CITY, TOWN

Charleston

VICINITY OF

STATE

West Virginia 25305

**5 LOCATION OF LEGAL DESCRIPTION**

COURTHOUSE,  
REGISTRY OF DEEDS, ETC.

Greenbrier County Court House

STREET & NUMBER

CITY, TOWN

Lewisburgh

STATE

West Virginia

**6 REPRESENTATION IN EXISTING SURVEYS**

TITLE

None

DATE

FEDERAL STATE COUNTY LOCAL

DEPOSITORY FOR  
SURVEY RECORDS

CITY, TOWN

STATE

# DESCRIPTION

CONDITION		CHECK ONE	CHECK ONE
<input type="checkbox"/> EXCELLENT	<input checked="" type="checkbox"/> DETERIORATED	<input type="checkbox"/> UNALTERED	<input checked="" type="checkbox"/> ORIGINAL SITE
<input type="checkbox"/> GOOD	<input type="checkbox"/> RUINS	<input checked="" type="checkbox"/> ALTERED	<input type="checkbox"/> MOVED      DATE _____
<input type="checkbox"/> FAIR	<input type="checkbox"/> UNEXPOSED		

---

DESCRIBE THE PRESENT AND ORIGINAL (IF KNOWN) PHYSICAL APPEARANCE

The Hokes Mill Covered Bridge is 12 feet wide and measures 81.6 feet between the insides of the endposts. It has board-and-batten siding painted barn red and a standing seam metal roof. The truss is a modified Long truss. The three 11 foot 10 inch high center panels of variable lengths, contain double diagonals consisting of two-4 x 8 inch members and 4½ x 8 inch single diagonals, which fit between and are pinned to the double diagonals. The 9 foot 8 inch long panel has a double diagonal made up of two-4½ x 7 inch members and a 4 x 6 inch single diagonal. The end diagonals are secured to the bottom chord, which consists of three-4 x 9½ inch members, by the bolt and rod system. Shear keys, which are small 2 x 3 inch blocks of wood that fit into notches made between the bottom chord members, help to transfer shear uniformly along the bottom chord.

The recent major modifications to the bridge include the replacement of the wooden transverse floor beams with steel girders and the addition of two wide flange beams, a W 36 x 194 and a W 36 x 182, which have been placed at either side of the deck and extend along the length of the bridge.

# 8 SIGNIFICANCE

PERIOD	AREAS OF SIGNIFICANCE -- CHECK AND JUSTIFY BELOW			
<input type="checkbox"/> PREHISTORIC	<input type="checkbox"/> ARCHEOLOGY-PREHISTORIC	<input type="checkbox"/> COMMUNITY PLANNING	<input type="checkbox"/> LANDSCAPE ARCHITECTURE	<input type="checkbox"/> RELIGION
<input type="checkbox"/> 1400-1499	<input type="checkbox"/> ARCHEOLOGY-HISTORIC	<input type="checkbox"/> CONSERVATION	<input type="checkbox"/> LAW	<input type="checkbox"/> SCIENCE
<input type="checkbox"/> 1500-1599	<input type="checkbox"/> AGRICULTURE	<input type="checkbox"/> ECONOMICS	<input type="checkbox"/> LITERATURE	<input type="checkbox"/> SCULPTURE
<input type="checkbox"/> 1600-1699	<input type="checkbox"/> ARCHITECTURE	<input type="checkbox"/> EDUCATION	<input type="checkbox"/> MILITARY	<input type="checkbox"/> SOCIAL/HUMANITARIAN
<input type="checkbox"/> 1700-1799	<input type="checkbox"/> ART	<input checked="" type="checkbox"/> ENGINEERING	<input type="checkbox"/> MUSIC	<input type="checkbox"/> THEATER
<input checked="" type="checkbox"/> 1800-1899	<input type="checkbox"/> COMMERCE	<input type="checkbox"/> EXPLORATION/SETTLEMENT	<input type="checkbox"/> PHILOSOPHY	<input checked="" type="checkbox"/> TRANSPORTATION
<input type="checkbox"/> 1900-	<input type="checkbox"/> COMMUNICATIONS	<input type="checkbox"/> INDUSTRY	<input type="checkbox"/> POLITICS/GOVERNMENT	<input type="checkbox"/> OTHER (SPECIFY)
		<input type="checkbox"/> INVENTION		

---

SPECIFIC DATES	c 1899	BUILDER/ARCHITECT	Unknown
----------------	--------	-------------------	---------

---

## STATEMENT OF SIGNIFICANCE

In 1897, during the April term of the Greenbrier County Court, it was ordered that B. F. Mann, R. A. McDowell and Austin B. Erwin be appointed commissioners to have a covered bridge built on stone abutments across Second Creek above Smith's Mill (formerly Hoke's Mill) for a cost of \$700.00. The court records do not pinpoint the date of the completion of the bridge, but various drafts were issued between the terms of January 1898 and March 1899 for road repairs in the Irish Corner tistrict. A draft for \$175.00 was the only one specifically referenced to the construction of the bridge. Therefore, the bridge was probably completed between April 1897 and March 1899.

The Hokes Mill Covered bridge is one of Greenbrier Counties two remaining covered bridges, and has a superstructure consisting of a modified version of the patented Long truss. The bridge is in a deteriorating condition, and although the two large wide flange beams help to support the bridge, they have adversely affected its aesthetic value and historic integrity. This bridge deserves a better fate and should be restored.

# 9 MAJOR BIBLIOGRAPHICAL REFERENCES

Order Book #6, ;reenbrier County Court, pp. 260, 300, 323, 336, 372.

## 10 GEOGRAPHICAL DATA

**UTM NOT VERIFIED**  
**ACREAGE NOT VERIFIED**

ACREAGE OF NOMINATED PROPERTY Not Applicable 7/

QUADRANGLE NAME Fort Spring

QUADRANGLE SCALE 1:24000

UTM REFERENCES

A 1, 7 | 54, 18, 7, 0 | 4, 17, 21, 2, 0

B | | | | | | | | | | | | | | | |

ZONE EASTING NORTHING

ZONE EASTING NORTHING

C | | | | | | | | | | | | | | | |

D | | | | | | | | | | | | | | | |

E | | | | | | | | | | | | | | | |

F | | | | | | | | | | | | | | | |

G | | | | | | | | | | | | | | | |

H | | | | | | | | | | | | | | | |

VERBAL BOUNDARY DESCRIPTION

LIST ALL STATES AND COUNTIES FOR PROPERTIES OVERLAPPING STATE OR COUNTY BOUNDARIES

STATE	CODE	COUNTY	CODE
STATE	CODE	COUNTY	CODE

## 11 FORM PREPARED BY

NAME / TITLE

E.L. Kemp, Professor History of Science & Technology and of Civil Engineering

ORGANIZATION

DATE

West Virginia University

STREET & NUMBER

TELEPHONE

G14 Woodburn Hall, Town Campus

(304) 293-3867

CITY OR TOWN

STATE

Morgantown

West Virginia 26506

## 12 STATE HISTORIC PRESERVATION OFFICER CERTIFICATION

THE EVALUATED SIGNIFICANCE OF THIS PROPERTY WITHIN THE STATE IS:

NATIONAL     

STATE     

LOCAL     

As the designated State Historic Preservation Officer for the National Historic Preservation Act of 1966 (Public Law 89-665), I hereby nominate this property for inclusion in the National Register and certify that it has been evaluated according to the criteria and procedures set forth by the National Park Service.

STATE HISTORIC PRESERVATION OFFICER SIGNATURE

TITLE

DATE

FOR NPS USE ONLY

I HEREBY CERTIFY THAT THIS PROPERTY IS INCLUDED IN THE NATIONAL REGISTER

DATE

ATTEST: KEEPER OF THE NATIONAL REGISTER

DATE

CHIEF OF REGISTRATION

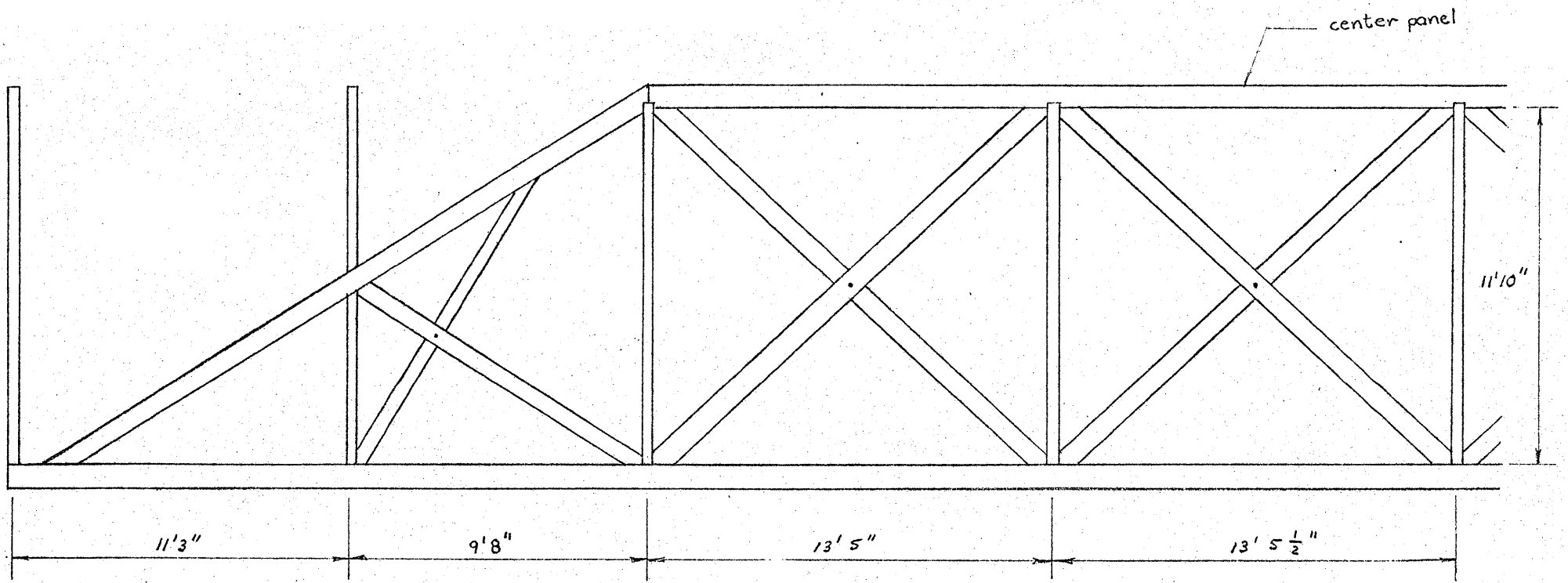

6. HOKES MILL COVERED BRIDGE

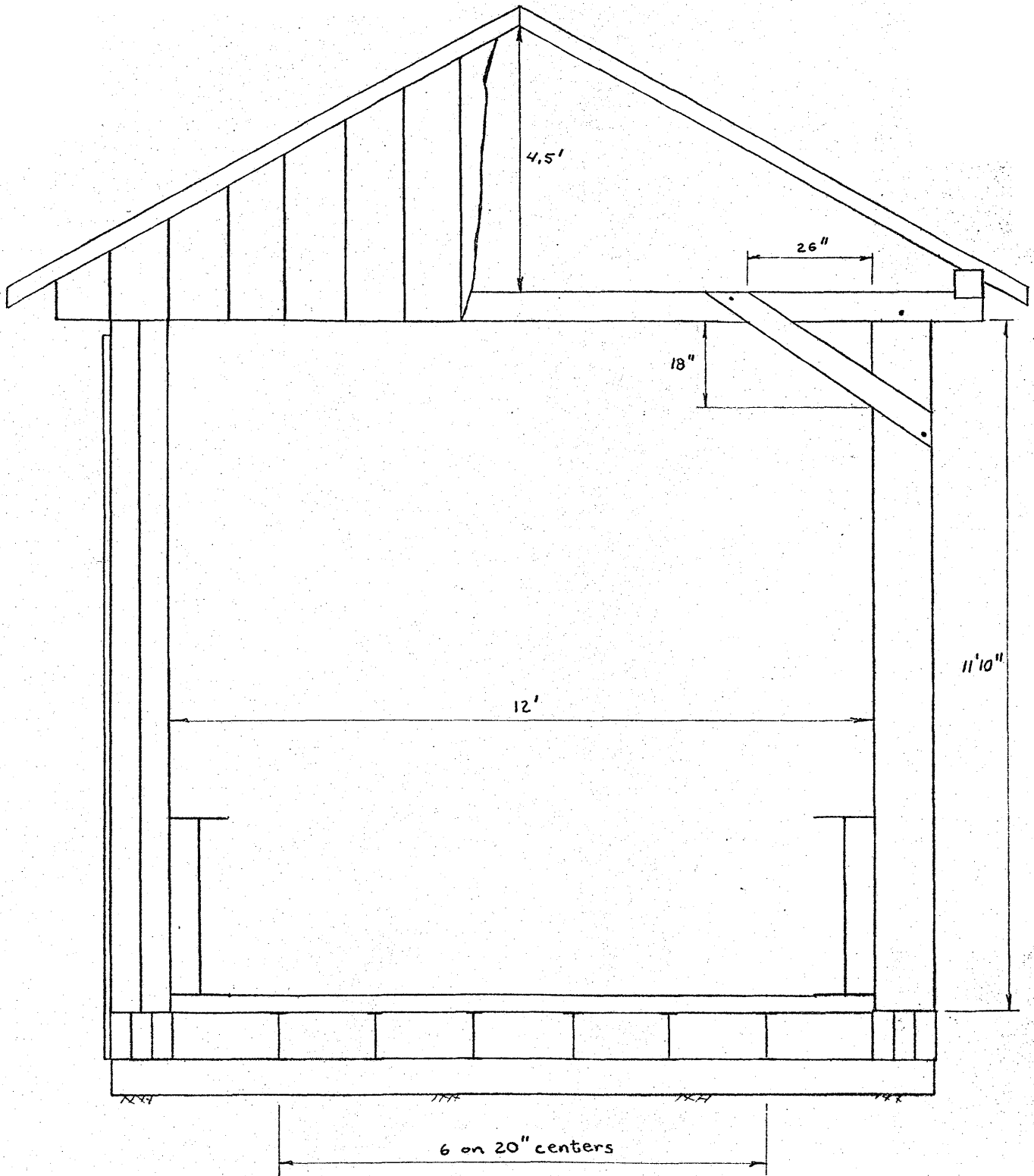

6. HOKES MILL COVERED BRIDGE

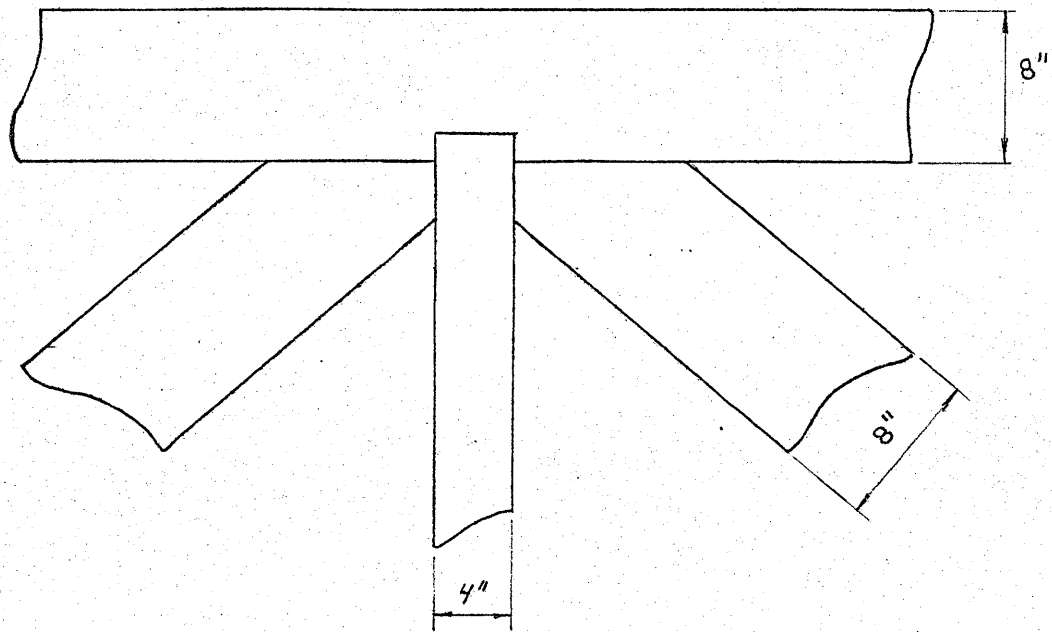

6. HOKES MILL COVERED BRIDGE