

2896

NOV 15 1988

KENTUCKY HISTORIC RESOURCES  
Individual Inventory Form

Resource # SH 232  
SHELBY County

1. Name of Resource: BURTON HOUSE

2. Original Owner: JOHN D. BURTON

3. Other Names: D.B. LIGHTER

4. Prehistoric Site	Building X Historic Site	Object Structure	Other
---------------------	-----------------------------	---------------------	-------

5. Location: EMINENCE QUAD.; W.S. BURKS BRANCH RD  
1 MI. S. OF FOX RUN INTERSECTION

6. Owner's Name: WILLIS AND EDITH COULTER [ P ]

7. Owner's Address: ROUTE 2  
SHELBYVILLE, KENTUCKY 40065

8. Evaluation: N.R. POTENTIAL [ N ]

9. Recognition & Date:  
 Nat. Landmark \_\_\_\_\_ Local Landmark \_\_\_\_\_  
 Nat. Register \_\_\_\_\_ HABS/HAER \_\_\_\_\_  
 Highway Marker \_\_\_\_\_ KY Inventory 1986 \_\_\_\_\_  
 KY Landmark Certificate \_\_\_\_\_

10. N.R. Status & Date: \_\_\_\_\_

11. N.R. Group:  
 District Name: [ ]  
 Mult. Resource Area: SHELBY CO MRA [ ]  
 Thematic Name: [ ]

12. Historical Theme:  
 Primary: ARCHITECTURE [ 030 ]  
 Secondary: [ ]  
 Other: [ ]

13. Statement of Significance: [ ]

14. History: [ ]

THE BURTON HOUSE IS SIGNIFICANT ON A LOCAL LEVEL UNDER CRITERIA C AS A RARE EXAMPLE OF AN ASYMMETRIC PLAN TURN-OF-THE-CENTURY (LATE 19TH C.) FARMHOUSE IN SHELBY COUNTY. THE MAJORITY OF HOMES (CONTINUED)

15. Source of historical information and/or contact person:  
SHELBY COUNTY CLERK AND RECORDER;  
1882 ATLAS OF HENRY AND SHELBY COS.,

16. Date: Original Building CA. 1882 [ 5 ]  
Addition [ ]

17. Style: PRINCESS ANNE [ 4P ]

18. Architect/Builder: UNKNOWN

19. No. of Stories: TWO [ 2.0 ]

20. Original Floor Plan: ASYMMETRICAL, PICTURESQUE [ AP ]

21. Single Pile Double Pile N.A. X

22. Roof Form & Material: Original \_\_\_\_\_  
GABLE, ASPHALT SHINGLE Not Original X

23. Structural Material: FRAME [ W ]

24. Exterior Material: CLAPBOARD [ W ]  
DECORATIVE TRIM [ W ]

25. Foundation Material: STONE AND CONCRETE (REAR) [ S ]

26. Major Alterations: None \_\_\_\_\_  
Moved/Rebuilt \_\_\_\_\_ Other \_\_\_\_\_  
Additions X

27. Special Features: \_\_\_\_\_

28. Outbuildings: MEATHOUSE [ 1 ]

29. Original Function: RESIDENTIAL [ 01A ]

30. Present Use: RESIDENTIAL [ 01A ]

31. Condition: GOOD [ G ]

32. Endangered: Yes \_\_\_\_\_  
No X

33. Attach Photos: Roll 4, 5 Photo Nos: 23- No. of Slides: 2

34. Prepared by: CHRISTINE AMOS

35. Organization: SHELBY CO. HIST. SOC.

36. Date: 7/1986

37. New Survey X Resurvey \_\_\_\_\_

KENTUCKY HISTORIC RESOURCES  
 Individual Inventory Form

Resource # SH 232

38. UTM Point of Primary Building: Quadrant: <u>EMINENCE</u>	Zone <u>16</u>	Easting <u>655220</u>	Northing <u>4236520</u>	39. G.I.S. Mod. [ ]	40. Coordi.Accuracy [ ]
41. UTM Points of Boundary (for N. R. eligible sites only):					
A. ---				D. ---	
B. ---				E. ---	
C. ---				F. ---	
42. Total Acreage in Present Property: <u>119 a.</u>					
43. Acreage included in proposed N.R. boundary: <u>&lt;1</u>					
44. Site Plan (and boundary description and justification for N.R. sites):					

The boundary of the property includes the house and meat house, located in a rectangular yard area south of the farm buildings. The farm buildings are of recent construction or in poor condition and although located near or in the vicinity of historic locations, do not contribute to the overall integrity of the property. The property's significance is based on the architectural qualities of the farmhouse. The boundary is therefore justified as the 75' by 150' rectangular space of the domestic yard area that is conveniently isolated from the rest of the farm by a post and woven wire fence to the north and south sides. Beginning at point A on the west side of Burks Branch Road, which is the south yard fence, proceed 75' north to the north yard fence at point B; then north 150' along the fenceline to point C; then 75' south to the south fenceline; then 150' east along that fenceline to the point of origin.

45. Description and House Plan:

The property consists of two frame buildings; the house and meat house of a turn-of-the-century farm complex. The two buildings are located near the west edge of the Burks Branch Road, surrounded by a yard with a post and woven wire fence. Mature sugar and water maple and locust trees and landscaped bushes and flowers define the yard boundaries. Out buildings (garage, milk house, tobacco barn, etc.), are not included in the site because of recent construction dates or loss of physical integrity. The farm's dairy barn burned in November of 1985 and was not replaced. The nominated property maintains good overall integrity.

The house is a two story, frame Princess Anne dwelling with multi-gabled roof; chevron patterned gable ends; two interior brick chimneys and one brick flue on the rear addition; boxed eave; elaborate gingerbread porch frieze with turned columns; double vertical light sash windows with bullseye block corner trim; a carved, half light entry door with bracketed hood; and stone foundation. The interior plan is asymmetrical with the front entry hall featuring an elaborate stairway with bullseye blocks on every riser end; window and door trim of pine with bullseye corner blocks and panel inserts beneath windows; and fireplaces in each room. Two rear additions include (continued)

## 13. Statement of Significance, continued

built on farms in the closing decades of the 19th century were of either a center passage I-house plan or T-plan. Far less common is an asymmetrical plan with only one room opening off the formal entry hall. In addition, the decorative porch and window trim, applied to an otherwise plain Princess Anne exterior form indicates a desire to build in a style popularized in widely distributed pattern books with up-to-date ideas on late Victorian design. The house is an interesting vernacular adaptation of that national era, in the way the plain, almost homely form is embellished here and there (gable ends, window trim and porch frieze; all the logical places) with elaborate jigsaw and stock trim.

## 45. Description and House Plan

a one-story, gable roofed kitchen and a single story enclosed porch. These alterations are to the rear and do not compromise the building's integrity to a significant degree.

The meat house, located in the rear, domestic yard has vertical board walls, a gable roof with single entry beneath and stone foundation.

The property boundaries include two contributing buildings.

house	C
meathouse	C

SH 232 BURTON HOUSE  
SITE PLAN



NOT TO  
SCALE

PHOTOS

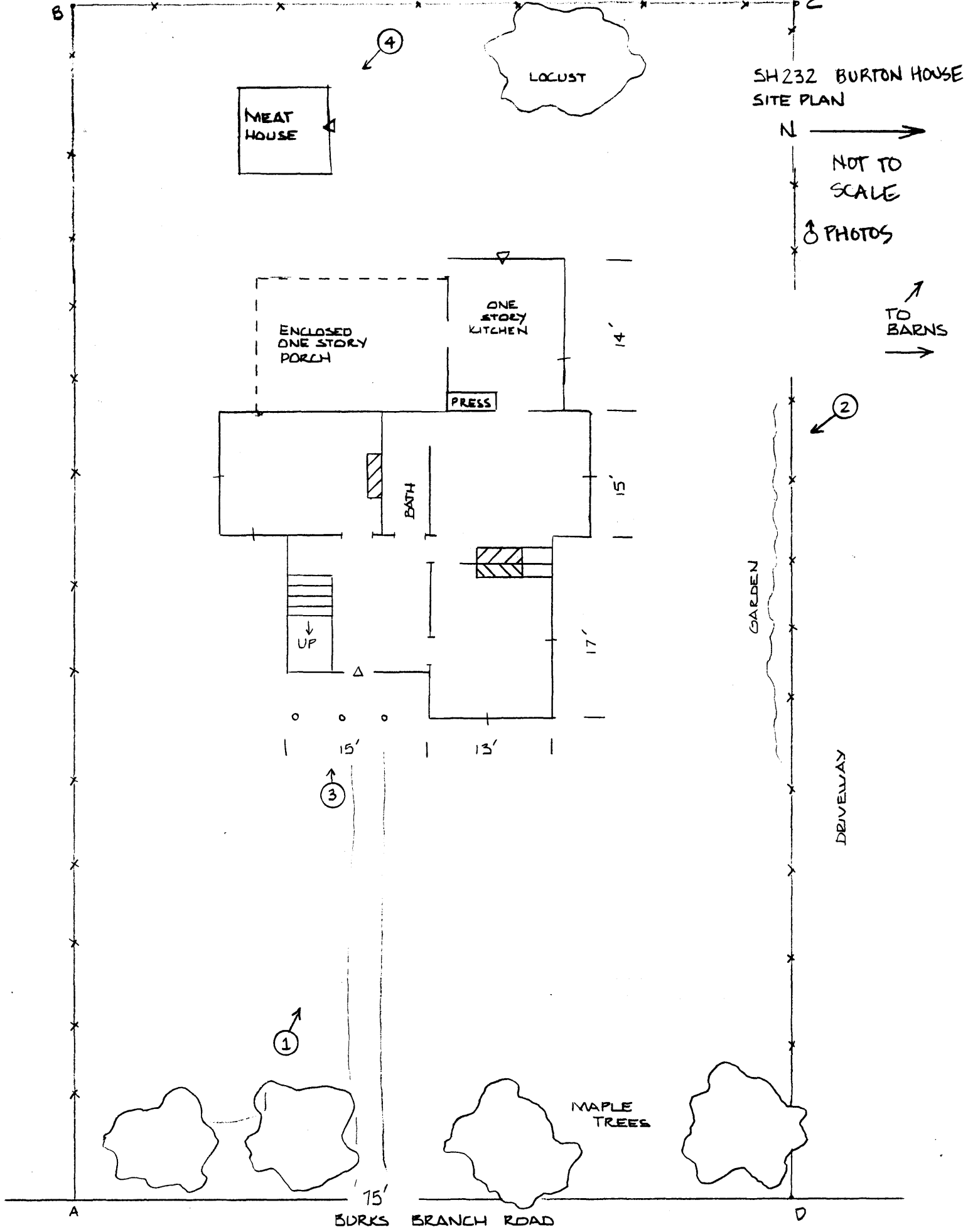

MEAT  
HOUSE

LOCUST

ENCLOSED  
ONE STORY  
PORCH

ONE  
STORY  
KITCHEN

PRESS

BATH

UP

GARDEN

DRIVEWAY

MAPLE  
TREES

BURKS BRANCH ROAD

1

3

2

4