

MAIN STREET HISTORIC DISTRICT WESTERLY, RHODE ISLAND

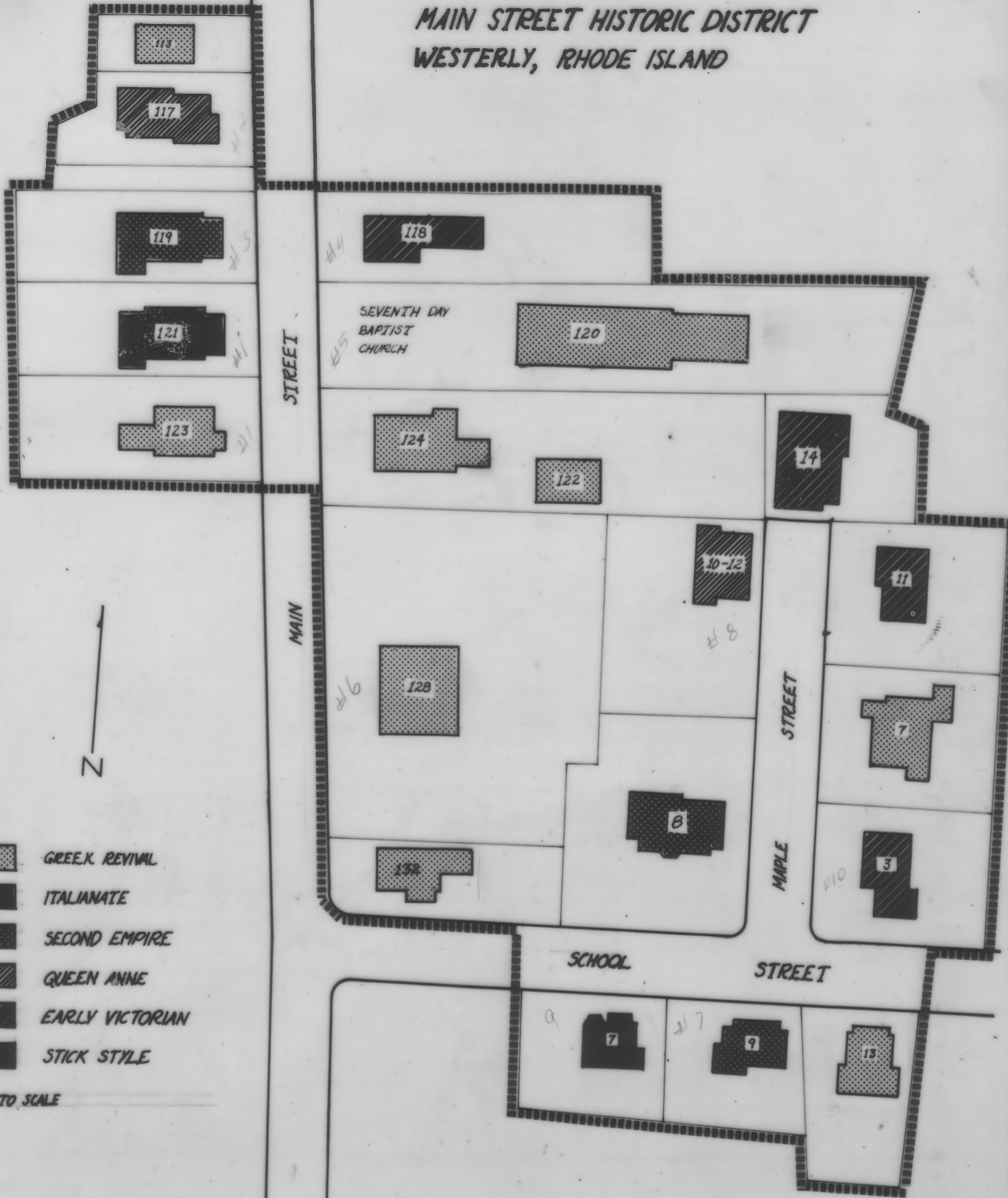

-  GREEK REVIVAL
-  ITALIANATE
-  SECOND EMPIRE
-  QUEEN ANNE
-  EARLY VICTORIAN
-  STICK STYLE

NOT TO SCALE



PROPERTY OF THE NATIONAL REGISTER

113-123 Main Street
Main Street Historic District, Westerly, R. I.

R. O. Christensen January, 1977
Negative filed: Rhode Island Historical Preservation
Commission

West side of Main Street from southeast.

JAN 9 1978

JUN 28 1977 #1710

Washington Co.





121 MAIN STREET

BICYCLES
PARKING

PROPERTY OF THE NATIONAL REGISTER

Samuel B. Segar House, 119 Main Street
Main Street Historic District, Westerly, R. I.

R. O. Christensen January, 1977
Negative filed: Rhode Island Historical Preservation
Commission

Exterior from the southeast.

JAN 9 1978 #3 of 10

JUN 28 1977.

Washington Co.



PROPERTY OF THE NATIONAL REGISTER

Pawcatuck 7th Day Baptist Church parsonage, 118 Main Street
Main Street Historic District, Westerly, R. I.

Beth F. Cohen:

February, 1977

Negative filed: Rhode Island Historical Preservation
Commission

Exterior from the southwest.

JAN 9 1978

#4 q10

JUN 28 1977

Washington Co.



PAWCATUCK
SEVENTH DAY BAPTIST
CHURCH
FOUNDED 1840
Sabbath Worship 11:00 A.M.
ALL ARE WELCOME

PROPERTY OF THE NATIONAL REGISTER

Pawcatuck 7th Day Baptist Church, 120 Main Street
[Main Street Historic District,] Westerly, R. I.

Beth F. Cohen

February, 1977

Negative filed: Rhode Island Historical Preservation
Commission

Exterior from the northwest.

JAN 9 1978

JUN 28 1977

#5910

Washington Co.



PROPERTY OF THE NATIONAL REGISTER

Charles Maxson House, 128 Main Street
Main Street Historic District, Westerly, R. I.

R. O. Christensen
Negative filed: Rhode Island Historical Preservation
Commission

January, 1977

Exterior from the northwest.

JAN 9 1978

JUN 28 1977

#68/10

Washington Co.





PROPERTY OF THE NATIONAL REGISTER

10-12

B. Courtland Bentley House, 2 Maple Street
Main Street Historic District, Westerly, R. I.

R. O. Christensen
Negative filed: Rhode Island Historical Preservation
Commission

January, 1977

Exterior from the northeast.

JAN 9 1978

JUN 28 1977

#82-10

Washington Co.





