

NATIONAL REGISTER OF HISTORIC PLACES  
INVENTORY - NOMINATION FORM

(Type all entries - complete applicable sections)

STATE: <b>Minnesota</b>	
COUNTY: <b>Olmsted</b>	
FOR NPS USE ONLY	
ENTRY NUMBER <b>70-9-22-0010</b>	DATE <b>9/22/70</b>

**1. NAME**

COMMON:  
**Mayowood or "Big House"**

AND/OR HISTORIC:

**2. LOCATION**

STREET AND NUMBER:  
**Rural Route 2, County Road "D"**

CITY OR TOWN:  
**Rochester** *Stewartville vicinity*

STATE: **Minnesota** CODE: **22** COUNTY: **Olmsted** CODE: **109**

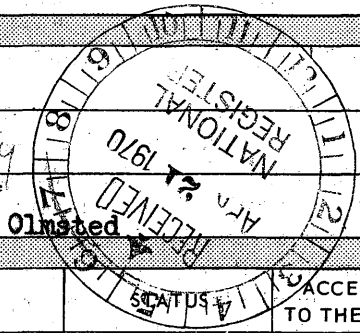

**3. CLASSIFICATION**

CATEGORY (Check One)	OWNERSHIP	ACCESSIBLE TO THE PUBLIC
<input checked="" type="checkbox"/> District <input type="checkbox"/> Site <input type="checkbox"/> Object <input type="checkbox"/> Building <input type="checkbox"/> Structure <input type="checkbox"/> Object	<input type="checkbox"/> Public <input checked="" type="checkbox"/> Private <input type="checkbox"/> Both	Public Acquisition: <input type="checkbox"/> In Process <input type="checkbox"/> Being Considered
PRESENT USE (Check One or More as Appropriate)		<input type="checkbox"/> Occupied <input checked="" type="checkbox"/> Unoccupied <input type="checkbox"/> Preservation work in progress
<input type="checkbox"/> Agricultural <input type="checkbox"/> Commercial <input checked="" type="checkbox"/> Educational <input checked="" type="checkbox"/> Entertainment <input type="checkbox"/> Government <input type="checkbox"/> Industrial <input type="checkbox"/> Military <input checked="" type="checkbox"/> Museum		<input type="checkbox"/> Park <input type="checkbox"/> Private Residence <input type="checkbox"/> Religious <input type="checkbox"/> Scientific <input type="checkbox"/> Transportation <input checked="" type="checkbox"/> Other (Specify) <b>Memorial</b>
		Yes: <input checked="" type="checkbox"/> Restricted <input type="checkbox"/> Unrestricted <input type="checkbox"/> No

**4. OWNER OF PROPERTY**

OWNER'S NAME:  
**Olmsted County Historical Society**

STREET AND NUMBER:  
**214 - 3rd Ave. S.W.**

CITY OR TOWN: **Rochester** STATE: **Minnesota** CODE: **22**

**5. LOCATION OF LEGAL DESCRIPTION**

COURTHOUSE, REGISTRY OF DEEDS, ETC.:  
**Olmsted County Courthouse**

STREET AND NUMBER:  
**2nd St. S.W.**

CITY OR TOWN: **Rochester** STATE: **Minnesota** CODE: **22**

**6. REPRESENTATION IN EXISTING SURVEYS**

TITLE OF SURVEY:  
**Minnesota State Register of Historic Sites**

DATE OF SURVEY: **1969**  Federal  State  County  Local

DEPOSITORY FOR SURVEY RECORDS:  
**Minnesota Historical Society**

STREET AND NUMBER:  
**690 Cedar Street**

CITY OR TOWN: **St. Paul** STATE: **Minnesota** CODE: **22**

SEE INSTRUCTIONS

STATE: **Minnesota**

COUNTY: **Olmsted**

ENTRY NUMBER: **70-9-22-0010**

DATE: **9/23/70**

FOR NPS USE ONLY

7. DESCRIPTION

CONDITION	(Check One)					
	<input type="checkbox"/> Excellent	<input checked="" type="checkbox"/> Good	<input type="checkbox"/> Fair	<input type="checkbox"/> Deteriorated	<input type="checkbox"/> Ruins	<input type="checkbox"/> Unexposed
	(Check One)			(Check One)		
	<input checked="" type="checkbox"/> Altered	<input type="checkbox"/> Unaltered	<input type="checkbox"/> Moved	<input checked="" type="checkbox"/> Original Site		

DESCRIBE THE PRESENT AND ORIGINAL (if known) PHYSICAL APPEARANCE

This 10-acre district consists of a master house, related buildings and structures, objects, and garden/lawn tracts. It was the residence and the nucleus of a large estate owned first by Dr. C. H. Mayo (c. 1910-39) and second by Dr. C. W. Mayo (c. 1939-68). Located in Section 17, Township 106 N., Range 11 W., Olmsted County, Minnesota, this district overlooks a man-made lake created by the damming of the Zumbro River. The present appearance of the district could be described as a "group of buildings, structures, objects, etc. in a 'natural' and in a managed setting of trees, shrubs, lawns, gardens, and walks.

The master house is a 40-room, poured concrete structure, consisting of five levels of floors, and is the key building of the district. Some architectural elements suggest the influence of late 18th century style. Perhaps the style is best described by saying it is of a period that Tunnard and Reed refer to "as being characterized by the building of private palaces, country villas, and formal gardens by the rich." The architecture and interior decoration are just as varied as the tastes and affluence of the owner. The essential floor plan can be described as a rectangular block, the length running north and south, with two attached wings on the east side that partially enclose a courtyard. (120x84' exterior). A concrete and limestone foundation becomes all concrete in forming the exterior walls from the second level up to the roof. The roof is asbestos shingle on the pitched sections; copper plate on the deck or flat sections. All trim and casing is wood. Iron rails and concrete balustrades are found exterior porches and stairwells.

The first level entrance opens into a vestibule and a staircase; the latter providing one of two accesses to the second level from the first level. On the first level is a gun room, a double garage, a boiler room, a workshop, a laundry room, and several storage rooms. In the first level's northwest corner there is an exit leading to a tunnel providing access to the bottom portion of the tea house. Two doors open off the tunnel; one to the north lawn, and the other to a garden just off the house's northwest corner.

Major rooms on the second level of large dimensions are the library, study, music room, living room, dining room, kitchen, and the servant's dining area. On the west side of the first level, just off the music room and the living room, is an exposed terrace running the full length of the house. On the east side of the second level, and in the gallery, two doors open into the courtyard. The library, green room and study overlook a small balcony on the south side of the second level.

The southeast wing and the south end of the third level contains two bedrooms, two bathrooms, two dressing rooms, and several closets. Off the central hallway are three more bedrooms with baths, and a nursery with bath. This hallway is lined with linen closets on the west side. Located in the north end of the house are two more bedrooms and a single bath. The northeast wing contains the servant's quarters.

A single large room (c. 117x35'), called the ballroom, and two storage areas are on the fourth level. The ballroom is finished off with panel and wallboard and dormers on its west and east sides provide natural light.

S E M I N S T R U C T I O N S

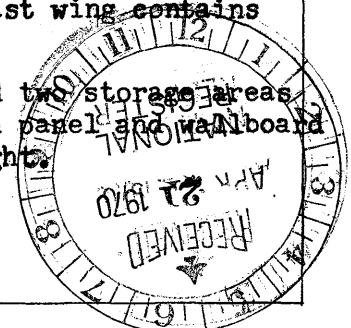

NATIONAL REGISTER OF HISTORIC PLACES  
INVENTORY - NOMINATION FORM

(Continuation Sheet)

STATE Minnesota	
COUNTY Olmsted	
FOR NPS USE ONLY	
ENTRY NUMBER	DATE
70 9. 22. 0010	9/22/70

(Number all entries) 7. Description (Mayowood)

The fifth level is a single room described as an observatory. It is the upper terminal for the elevator shaft and likely a room that resulted from the installation of the elevator. This room has a door, on the north side, that opens onto the roof deck.

Tony's house is a frame house constructed on the foundation of an old barn. Of no particular style this house was built to house the groundskeeper and his wife; the latter served as housekeeper for the Mayos. This house is located about one hundred yards northeast of the mansion.

The tea house is a two level octagon structure about twenty-five yards northwest of the master house. The lower level, basically the foundation, is limestone and concrete. These walls enclose a single room with exits to the tunnel and garden. The tea house proper has an octagon shingled roof supported by concrete pillars. It is enclosed by a concrete balustrade and screens. A single entrance opens to the covered walk leading to the master house.

Built into the hillside on the east side of the master house is the root cellars. Divided into cubicles, each having its own door, this structure was used for storage. Above and behind the cellars is the frame icehouse. A poured concrete double garage is located south and east of the master house. The roof of this building supports a large iron and concrete fountain; attached to it are several dog kennels. South and west of the master house is a limestone and concrete round tower. Between the round tower and the master house is a drive. The round tower is a part of the wall that runs along the west side of this drive.

Included in the classification of objects are the pools, fountains, walks, statues, and garden lawn areas. Because of the deterioration of these objects, and incomplete or missing research, a description of what was once a very formal and complex arrangement cannot be given. In summary most of the objects related to an oriental theme. The major arrangement of these objects was on the west side of the master house and towards the end of the district's ten acres. Seven pools extended down the hill toward the lake; among these pools were numerous gardens and walks.

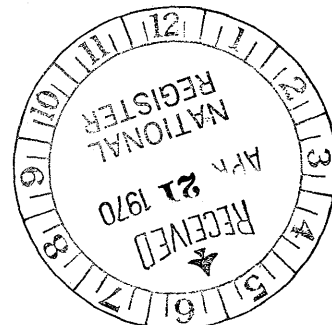

**SIGNIFICANCE**

PERIOD (Check One or More as Appropriate)

- Pre-Columbian     16th Century     18th Century     20th Century  
 15th Century     17th Century     19th Century

SPECIFIC DATE(S) (If Applicable and Known) **1910-1968**

AREAS OF SIGNIFICANCE (Check One or More as Appropriate)

- |  |  |  |  |
|--|--|--|--|
| <input checked="" type="checkbox"/> Aboriginal     | <input type="checkbox"/> Education                         | <input type="checkbox"/> Political           | <input type="checkbox"/> Urban Planning        |
| <input type="checkbox"/> Prehistoric               | <input type="checkbox"/> Engineering                       | <input type="checkbox"/> Religion/Philosophy | <input type="checkbox"/> Other (Specify) _____ |
| <input checked="" type="checkbox"/> Historic       | <input type="checkbox"/> Industry                          | <input checked="" type="checkbox"/> Science  | _____  |
| <input type="checkbox"/> Agriculture               | <input type="checkbox"/> Invention                         | <input type="checkbox"/> Sculpture           | _____  |
| <input checked="" type="checkbox"/> Architecture   | <input checked="" type="checkbox"/> Landscape Architecture | <input type="checkbox"/> Social/Humanitarian | _____  |
| <input type="checkbox"/> Art                       | <input type="checkbox"/> Literature                        | <input type="checkbox"/> Theater             | _____  |
| <input checked="" type="checkbox"/> Commerce       | <input type="checkbox"/> Military                          | <input type="checkbox"/> Transportation      | _____  |
| <input checked="" type="checkbox"/> Communications | <input type="checkbox"/> Music                             |  |  |
| <input type="checkbox"/> Conservation              |  |  |  |

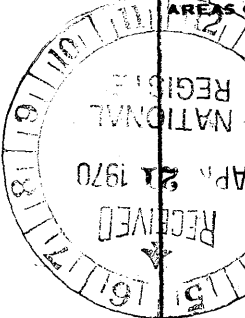

STATEMENT OF SIGNIFICANCE

Three areas of significance have been checked for this application; architecture, landscape architecture, and medical science. Without any stretch of the imagination other areas could have been checked. For example in education Dr. Charlie's and Dr. Will's foresighted establishment of the Mayo Clinic Graduate school of medicine in 1915 has produced a Renaissance in medical specialties. Of these three areas there can be no doubt that medical science is the most significant, not only from Minnesota's standpoint, but also from the standpoint of the nation and the world.

When the builder and planner of Mayowood was born in 1865, Rochester, Minnesota, his birthplace, was a typical prairie pioneer community serving a rich but still heavily wooded farm area. Charles H. Mayo was destined to become part of a team of brothers who changed this rural orientated community into a world famous medical community. With the heritage of his doctor father, and the partnership of his elder brother, William J. Mayo, Dr. Charles founded a group practice of medicine which was unique to medical history.

The Mayo Clinic became a pattern for medical clinics throughout the world. A benchmark in medical history was established. To see for themselves how this unusual and successful experiment worked, the medical world came to Rochester and Minnesota. The growing fame of the brothers brought them invitations and honors from home and abroad.

In 1911, at the early stages of this fame, Dr. Charlie built Mayowood, an unusually large house for southeastern Minnesota and the city of Rochester. It was as if Dr. Charlie knew that it would be a center for social life as well as the scientific life the growing community. Mayowood did become this center; the spread of the Clinic's fame filled its rooms with guests from every profession and walk of life. From 1911 to 1935 Dr. C.H. Mayo served as host; from 1939 to 1968 Dr. C.W. succeeded in his father's role.

The proposed district, through its occupants, guests, and visitors, is a part of the Mayo Clinic's history.

Excluding the weight of significance associated with medical history; the house alone is significant for its design and construction. A house that reflects, with its changes and additions, two generations of social life and tastes of two distinguished Minnesota citizens in the period from 1910 to 1968. It is a house that is not necessarily typical of any architectural style and one that need not be restored to appreciate its value.

(more)

SEE INSTRUCTIONS

9 MAJOR BIBLIOGRAPHICAL REFERENCES

Olmsted County Historical Society, Research Department, Local papers and assorted manuscript files.

Clapesattle, Helen, The Doctor's Mayo, The University of Minnesota Press, Minneapolis, 1941.

10 GEOGRAPHICAL DATA

LATITUDE AND LONGITUDE COORDINATES DEFINING A RECTANGLE LOCATING THE PROPERTY			O R	LATITUDE AND LONGITUDE COORDINATES DEFINING THE CENTER POINT OF A PROPERTY OF LESS THAN TEN ACRES		
CORNER	LATITUDE	LONGITUDE		LATITUDE	LONGITUDE	
	Degrees Minutes Seconds	Degrees Minutes Seconds		Degrees	Minutes	Seconds
NW	0 . "	0 . "		43°	59'	25.5"
NE	0 . "	0 . "		92°	31'	43"
SE	0 . "	0 . "				
SW	0 . "	0 . "				

APPROXIMATE ACREAGE OF NOMINATED PROPERTY: 10 acres (less than)

LIST ALL STATES AND COUNTIES FOR PROPERTIES OVERLAPPING STATE OR COUNTY BOUNDARIES

STATE:	CODE	COUNTY	CODE

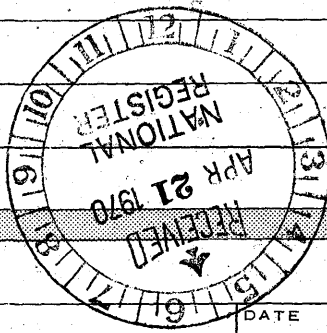

NO  
UTM  
CO

SEE INSTRUCTIONS

11. FORM PREPARED BY

NAME AND TITLE: John Grossman, Survey and Planning

ORGANIZATION: Minnesota Historical Society DATE: 3/20/70

STREET AND NUMBER: Fort Snelling Branch, Building 25

CITY OR TOWN: St. Paul STATE: Minnesota CODE: 22

12. STATE LIAISON OFFICER CERTIFICATION

As the designated State Liaison Officer for the National Historic Preservation Act of 1966 (Public Law 89-665), I hereby nominate this property for inclusion in the National Register and certify that it has been evaluated according to the criteria and procedures set forth by the National Park Service. The recommended level of significance of this nomination is:

National  State  Local

Name: Russell W. Fridley

Title: Director, Minn. Historical Society

Date: 4-15-70

NATIONAL REGISTER VERIFICATION

I hereby certify that this property is included in the National Register.

Arrest Alton Connally  
Chief, Office of Archeology and Historic Preservation

SEP 22 1970

Date: \_\_\_\_\_

ATTEST: William J. Mitchell  
Keeper of The National Register

Date: JUL 8 1970

**NATIONAL REGISTER OF HISTORIC PLACES  
INVENTORY - NOMINATION FORM**

(Continuation Sheet)

STATE <b>Minnesota</b>	
COUNTY <b>Olmsted</b>	
FOR NPS USE ONLY	
ENTRY NUMBER <b>70.9.22.0010</b>	DATE <b>9/22/70</b>

(Number all entries) **8. Significance (Mayowood)**

This district's landscape architecture, although deteriorated at the present time, is also significant. It is characteristic of this period (Tunnard and Reed) and when restored certainly will be a surviving example for southeastern Minnesota.

The district was designated as a Minnesota Historic Site on March 10, 1967.

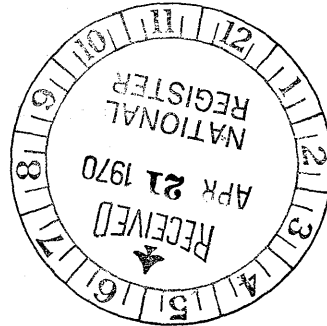

SECTION NO. 17 TOWNSHIP OF ROCHESTER TOWNSHIP 106 N. RANGE 14 W.

OLMSTED COUNTY, MINN.

MILLER-DAVIS CO., MINNEAPOLIS

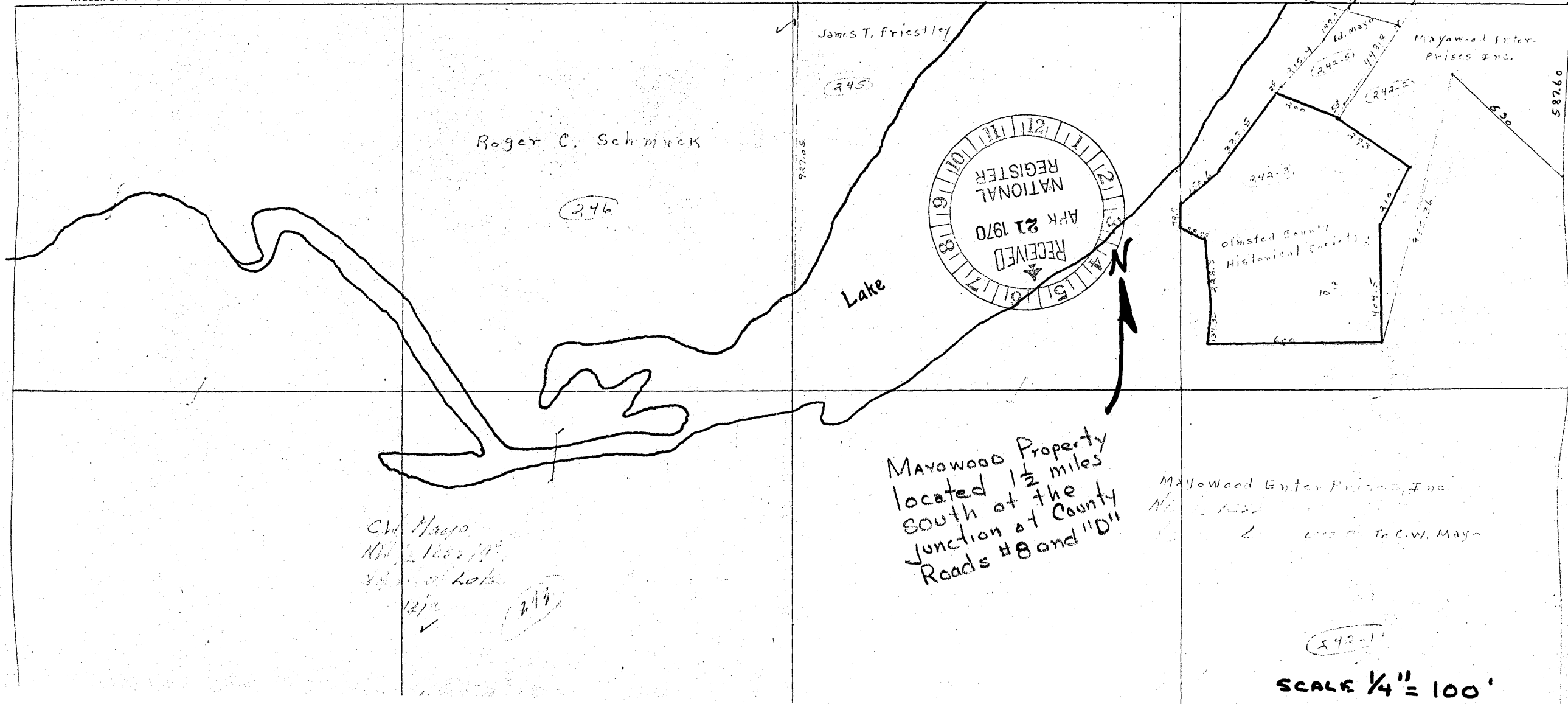

Roger C. Schmuck

James T. Priestley

RECEIVED  
APR 21 1970  
NATIONAL REGISTER

Lake

Maywood Enter. Prises Inc.

Olmsted County Historical Society

Maywood Property located 1 1/2 miles south at the junction at County Roads #8 and #D

Maywood Enter. Prises, Inc.

242-1

SCALE 1/4" = 100'

C.W. Mayo  
Nov 2 1885 1900  
W. of Lake  
1812  
✓

248

**NATIONAL REGISTER OF HISTORIC PLACES  
PROPERTY MAP FORM**

STATE	Minnesota
COUNTY	Olmsted
FOR NPS USE ONLY	
ENTRY NUMBER	DATE
70.9.22.0010	9/22/70

(Type all entries - attach to or enclose with map)

SEE INSTRUCTIONS

<b>1. NAME</b>			
COMMON: Mayowood or "Big house"			
AND/OR HISTORIC: Mayowood or "big house"			
<b>2. LOCATION</b>			
STREET AND NUMBER: Rural Route 2 - County Road "D"			
CITY OR TOWN: Rochester			
STATE: Minnesota	CODE 22	COUNTY: Olmsted	CODE 109
<b>3. MAP REFERENCE</b>			
SOURCE: Olmsted County Courthouse - Register of Deeds			
SCALE: $\frac{1}{4}'' = 100'$			
DATE: 1965			
<b>4. REQUIREMENTS</b>			
TO BE INCLUDED ON ALL MAPS			
1. Property boundaries where required.			
2. North arrow.			
3. Latitude and longitude reference.			

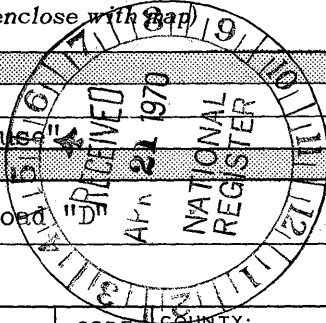



(ROCHESTER)

Y.PON 2.6 MI. R. 15 W. 1.4 MI. TO U.S. 14 35' 1.4 MI. TO U.S. 14 R. 14 W. 2390000 FEET 92°30' 44°00'

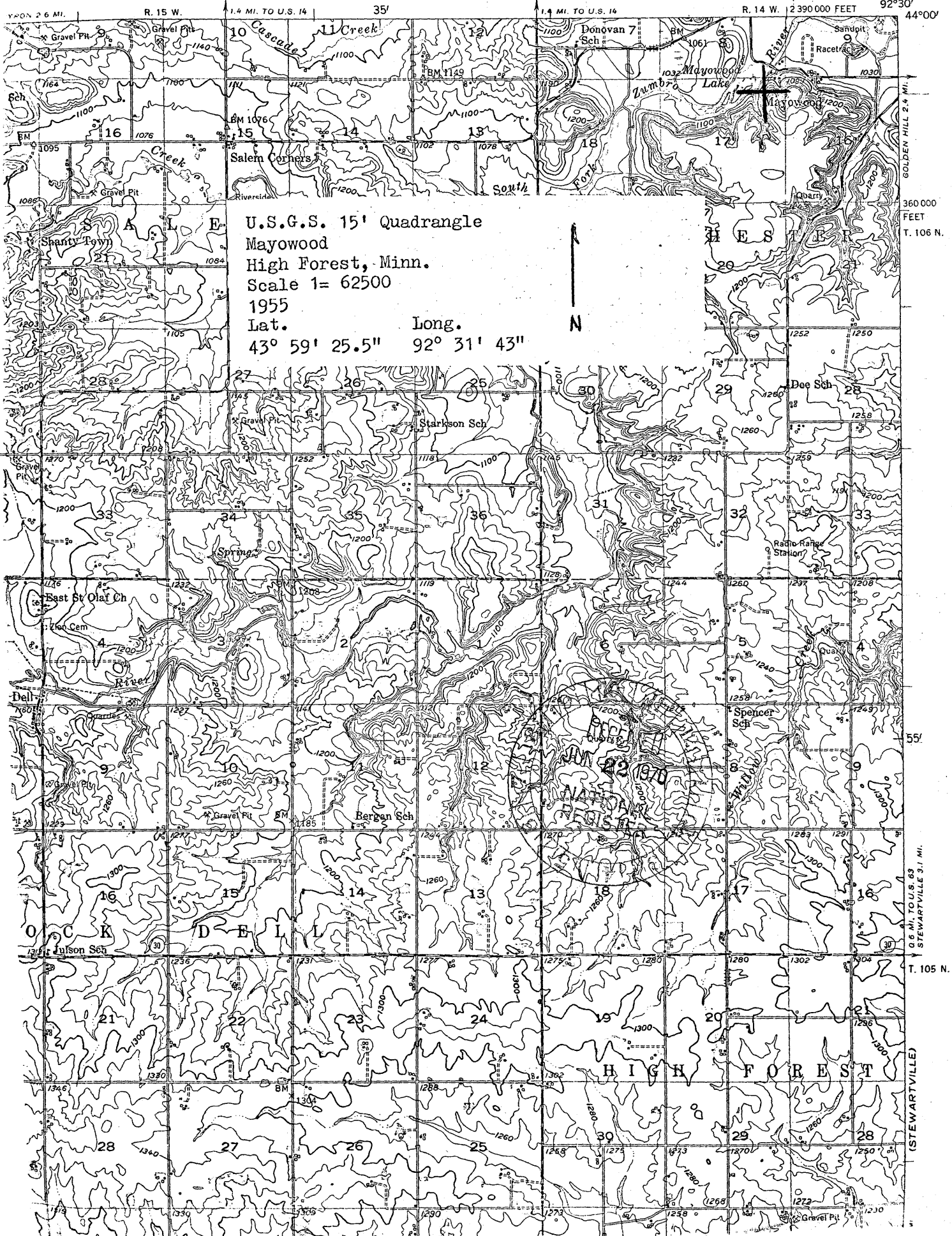

GOLDEN HILL 2.4 MI.

360000  
FEET  
T. 106 N.

55'

0.6 MI. TO U.S. 63  
1 STEWARTVILLE 3.1 MI.

T. 105 N.

(STEWARTVILLE)

Form 10-301  
(Dec. 1968)

UNITED STATES DEPARTMENT OF THE INTERIOR  
NATIONAL PARK SERVICE

**NATIONAL REGISTER OF HISTORIC PLACES  
PROPERTY MAP FORM**

(Type all entries - attach to or enclose with map)

STATE Minnesota	
COUNTY Olmsted	
FOR NPS USE ONLY	
ENTRY NUMBER	DATE
	70.9.22.0010 9/22/70

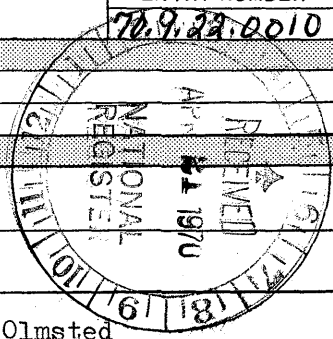

SEE INSTRUCTIONS

<b>1. NAME</b>			
COMMON: Mayowood or "big house"			
AND/OR HISTORIC: Mayowood or "big house"			
<b>2. LOCATION</b>			
STREET AND NUMBER: Rural Route 2 - County Road "D"			
CITY OR TOWN: Rochester			
STATE: Minnesota	CODE 22	COUNTY: Olmsted	CODE 109
<b>3. MAP REFERENCE</b>			
SOURCE: U.S.G.S. 15' Quadrangle; High Forest, Minn. Quadrangle			
SCALE: 1" = 62500			
DATE: 1955			
<b>4. REQUIREMENTS</b>			
TO BE INCLUDED ON ALL MAPS			
1. Property boundaries where required.			
2. North arrow.			
3. Latitude and longitude reference.			

**United States Department of the Interior  
Heritage Conservation and Recreation Service**

**National Register of Historic Places  
Inventory—Nomination Form**

For HCRS use only  
received FEB 17 1982  
date entered MAR 31 1982

See instructions in *How to Complete National Register Forms*  
Type all entries—complete applicable sections

**1. Name**

historic Mayowood Historic District

and/or common Mayowood

**2. Location**

street & number SR County Road 125 N/A— not for publication

city, town Rochester mc Township N/A vicinity of congressional district First

state Minnesota code 22 county Olmsted code 109

**3. Classification**

<b>Category</b>	<b>Ownership</b>	<b>Status</b>	<b>Present Use</b>	
<input checked="" type="checkbox"/> district	<input type="checkbox"/> public	<input checked="" type="checkbox"/> occupied	<input checked="" type="checkbox"/> agriculture	<input checked="" type="checkbox"/> museum
<input type="checkbox"/> building(s)	<input type="checkbox"/> private	<input type="checkbox"/> unoccupied	<input type="checkbox"/> commercial	<input type="checkbox"/> park
<input type="checkbox"/> structure	<input checked="" type="checkbox"/> both	<input type="checkbox"/> work in progress	<input checked="" type="checkbox"/> educational	<input checked="" type="checkbox"/> private residence
<input type="checkbox"/> site	<b>Public Acquisition</b>	<b>Accessible</b>	<input type="checkbox"/> entertainment	<input type="checkbox"/> religious
<input type="checkbox"/> object	<input type="checkbox"/> in process	<input checked="" type="checkbox"/> yes: restricted	<input type="checkbox"/> government	<input type="checkbox"/> scientific
	<input type="checkbox"/> being considered	<input type="checkbox"/> yes: unrestricted	<input type="checkbox"/> industrial	<input type="checkbox"/> transportation
	N/A	<input type="checkbox"/> no	<input type="checkbox"/> military	<input type="checkbox"/> other:

**4. Owner of Property**

name Multiple Ownership -- See continuation sheet

street & number N/A

city, town N/A N/A vicinity of state N/A

**5. Location of Legal Description**

courthouse, registry of deeds, etc. Olmsted County Courthouse

street & number 515 Second Street SW

city, town Rochester state Minnesota 55901

**6. Representation in Existing Surveys**

National Register of Historic Places (1970): Mayowood House only  
title Statewide Survey of Historic Resources has this property been determined eligible?  yes  no

date 1979-80  federal  state  county  local

depository for survey records Minnesota Historical Society -- 240 Summit Avenue-Hill House

city, town St. Paul state Minnesota 55102

## 7. Description

<b>Condition</b>		<b>Check one</b>	<b>Check one</b>
<input type="checkbox"/> excellent	<input type="checkbox"/> deteriorated	<input checked="" type="checkbox"/> unaltered	<input checked="" type="checkbox"/> original site
<input checked="" type="checkbox"/> good	<input type="checkbox"/> ruins	<input checked="" type="checkbox"/> altered	<input type="checkbox"/> moved
<input checked="" type="checkbox"/> fair	<input type="checkbox"/> unexposed		date _____

### Describe the present and original (if known) physical appearance

The Maywood Historic District includes a large tract of land of about 120 acres, located approximately two miles southwest of the city of Rochester. Within the district there are several clusters of buildings and structures and several individual buildings. The heavily wooded and rolling terrain of the area adjoins the South Fork of the Zumbro River where it widens into Maywood Lake.

Maywood Master House (1910-11): The master house is a very large, five-story, forty-room structure of reinforced concrete. In plan it consists of a central north-south rectangle with two attached wings on the east side which partially enclose a courtyard. Hipped roof sections have asbestos shingles while flat roof sections are sheathed in copper plates. Fenestration consists of a variety of multi-light double-hung sash, often arranged in rows. A large stone and concrete wall and double stairway extend northwest from the front of the house. The interior consists of a variety of richly finished rooms, all unaltered. In the vicinity of the house are remnants of the once-elaborate landscaping. Also nearby are root cellars, ice house, double garage, and round tower, along with fountains, walks, and statuary.

Ivy Lodge Complex: The Ivy Lodge complex consists of Ivy Lodge (1908), a large two-story gable and hipped-roof house of concrete construction; Coach House (ca.1910-20), a two-story gable-roofed auto and carriage garage; Ivy Cottage (ca.1910-20), a small gable-roofed structure built as an ice house, later converted into a residence; and Ivy Cottage Garage (ca.1910-20), a shop and garage.

Farm Number One Complex: Farm No. 1 consists of Horse Stables (ca.1910-20), two-story gable-roofed wood frame stables, now converted to apartments; Stone Barn (ca.1910-20), a long, rectangular stone barn; Stone House (ca.1910-20); House (no date), a small, Greek Revival residence; the ruins of a poured concrete silo, modern silos, and pole barns.

(Adolph Bierman House)

Miscellaneous Buildings: Red Brick House (ca.1870), a large two-story gable-roofed residence with associated spring house; Greenhouse Complex (ca.1910-20), a long glass-enclosed greenhouse with associated two-story service building; Dam House (1910-20), a modest two-story gable-roofed house located near the present dam; Dam (no date), a dam structure creating a lake to the northwest of the master house.

# 8. Significance

Period	Areas of Significance—Check and justify below			
<input type="checkbox"/> prehistoric	<input type="checkbox"/> archeology-prehistoric	<input type="checkbox"/> community planning	<input type="checkbox"/> landscape architecture	<input type="checkbox"/> religion
<input type="checkbox"/> 1400-1499	<input type="checkbox"/> archeology-historic	<input type="checkbox"/> conservation	<input type="checkbox"/> law	<input type="checkbox"/> science
<input type="checkbox"/> 1500-1599	<input type="checkbox"/> agriculture	<input type="checkbox"/> economics	<input type="checkbox"/> literature	<input type="checkbox"/> sculpture
<input type="checkbox"/> 1600-1699	<input type="checkbox"/> architecture	<input type="checkbox"/> education	<input type="checkbox"/> military	<input checked="" type="checkbox"/> social/
<input type="checkbox"/> 1700-1799	<input type="checkbox"/> art	<input type="checkbox"/> engineering	<input type="checkbox"/> music	<input type="checkbox"/> humanitarian
<input checked="" type="checkbox"/> 1800-1899	<input type="checkbox"/> commerce	<input type="checkbox"/> exploration/settlement	<input type="checkbox"/> philosophy	<input type="checkbox"/> theater
<input checked="" type="checkbox"/> 1900-	<input type="checkbox"/> communications	<input type="checkbox"/> industry	<input type="checkbox"/> politics/government	<input type="checkbox"/> transportation
		<input type="checkbox"/> invention		<input type="checkbox"/> other (specify)

**Specific dates** 1870s, 1911, 1920s      **Builder/Architect** Unknown

**Statement of Significance (in one paragraph)**

The Mayowood estate is significant as the second and principal home of Dr. Charles H. Mayo and family from its construction in 1911 to his death in 1939, and the home of his son, Dr. Charles W. Mayo, from 1939 until 1968. Charles H. is significant as co-founder of the Mayo Clinic at the beginning of the twentieth century, and as a world-reknowned surgeon. His son Charles W. continued in the role of physician and Mayo Clinic practioner. The building known as Ivy Lodge in the Ivy Lodge Complex was built by Charles H. Mayo to experiment with the concrete construction techniques employed in the master house in 1910-11. After completion of the master house, the Ivy Lodge complex served a variety of functions, including accommodating numerous Mayowood guests and visitors. Farm Number One, along with the greenhouse, reflects the variety of extracurricular interests of the Mayo, including horse breeding and horticulture. The master house has been listed on the National Register of Historic Places since 1970. This nomination is intended to extend those boundaries to include the significant buildings, structures, and landscaping which once were part of the complete Mayowood estate. Since 1968 the master house has been maintained by the Olmsted County Historical Society as a historic house open to the public.

UTM NOT VERIFIED

ACREAGE NOT VERIFIED

# 9. Major Bibliographical References

Blapesattle, Helen. The Doctors Mayo. Minneapolis: University of Minnesota Press, 1941.  
Olsted County Historical Society, Rochester, MN. Extensive interviews with Bradford Linder, Curator, and George Tyrrell, Director. 1979-80.

# 10. Geographical Data

Acreeage of nominated property approx. 120 acres

Quadrangle name Salem Corners, Minn.

Quadrangle scale 7.5

### UMT References

A 

1	5	5	3	9	2	1	0	4	8	7	1	6	8	0
Zone		Easting				Northing								

B 

1	5	5	3	9	1	6	0	4	8	7	0	6	8	0
Zone		Easting				Northing								

C 

1	5	5	3	8	2	1	0	4	8	7	0	6	6	0
Zone		Easting				Northing								

D 

1	5	5	3	8	2	0	0	4	8	7	1	6	7	0
Zone		Easting				Northing								

E 

Zone		Easting				Northing								

F 

Zone		Easting				Northing								

G 

Zone		Easting				Northing								

H 

Zone		Easting				Northing								

### Verbal boundary description and justification

See continuation sheet - page 2

### List all states and counties for properties overlapping state or county boundaries

state N/A code county code

state N/A code county code

# 11. Form Prepared By

name/title Robert M. Frame III, Ph.D., Architectural Historian

organization Minnesota Historical Society

date April 1980

street & number 240 Summit Avenue-Hill House

telephone 612-296-9074

city or town St. Paul,

state Minnesota

# 12. State Historic Preservation Officer Certification

The evaluated significance of this property within the state is:

national  state  local

As the designated State Historic Preservation Officer for the National Historic Preservation Act of 1966 (Public Law 89-665), I hereby nominate this property for inclusion in the National Register and certify that it has been evaluated according to the criteria and procedures set forth by the Heritage Conservation and Recreation Service.

State Historic Preservation Officer signature

Russell W. Fridley

title State Historic Preservation Officer

date 2/2/82

For HCRS use only

I hereby certify that this property is included in the National Register

date 3.31.82

Keeper of the National Register

Attest:

date

Chief of Registration

107

UNITED STATES DEPARTMENT OF THE INTERIOR  
NATIONAL PARK SERVICE

**NATIONAL REGISTER OF HISTORIC PLACES  
INVENTORY -- NOMINATION FORM**

FOR NPS USE ONLY

RECEIVED FEB 17 1982

DATE ENTERED

Mayowood Historic District

**CONTINUATION SHEET**

ITEM NUMBER 4

PAGE 1

Ownership List:

Mayowood Enterprises  
c/o Bernard Donoval  
RR 2  
Byron, MN 55920

David Gimbert  
3716 Mayowood Road S.W.  
Rochester, MN 55901

Olmsted County  
c/o Dave Dunn  
Olmsted County Park and Recreation Dept.  
1421 Third Ave. S.E.  
Rochester, MN 55901

Olmsted County Historical Society  
c/o George Tyrrell, Director  
Box 6411, Salem Road N.W.  
Rochester, MN 55901

UNITED STATES DEPARTMENT OF THE INTERIOR  
NATIONAL PARK SERVICE

FOR NPS USE ONLY

RECEIVED FEB 17 1982

DATE ENTERED

**NATIONAL REGISTER OF HISTORIC PLACES  
INVENTORY -- NOMINATION FORM**

Mayowood Historic District

**CONTINUATION SHEET**

ITEM NUMBER 10 PAGE 2

Verbal Boundary Description:

Commencing at the northeast corner point of section 17, Township 106 North, Range 14 West, thence due south 1000 feet along the east section line of section 17; thence due west one-quarter mile to the quarter-section line of section 17; thence due north along said quarter-section line, continuing into section 8, to the northwest bank of the South Fork of the Zumbro River; thence along the said bank of said river in a general northeasterly direction, continuing into section 9, to a point 2300 feet north of the south section line of section 9; thence due east to the quarter-section line which is one-quarter mile east of the west section line of section 9; thence due south 1500 feet along said quarter-section line; thence due east 500 feet; thence due south to the south section line of section 9; thence due west along said section line to the point of beginning.



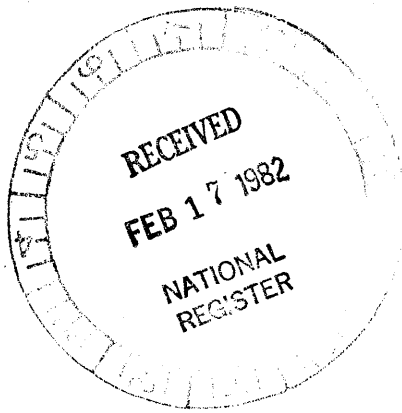

NORTH

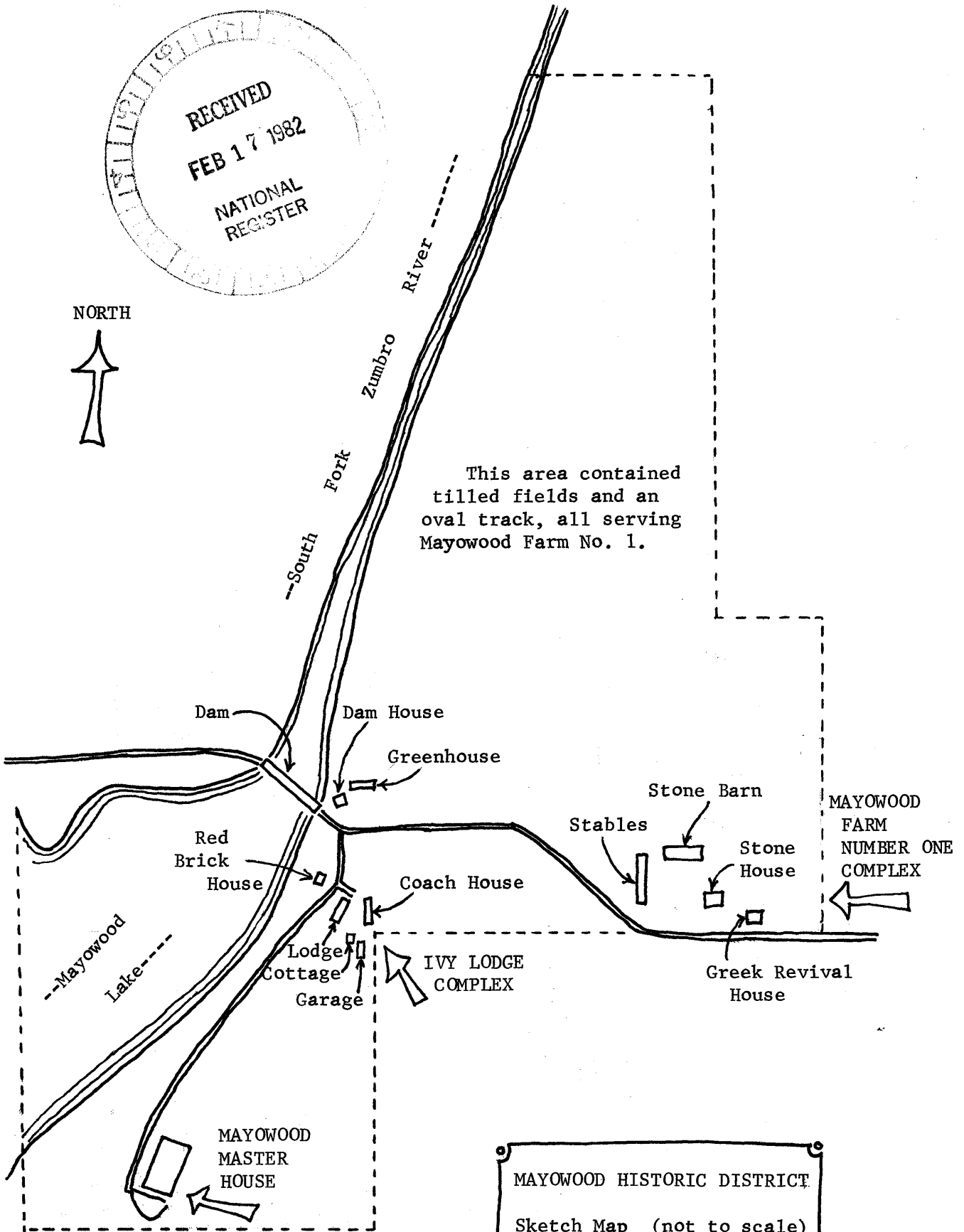

MAYOWOOD HISTORIC DISTRICT  
 Sketch Map (not to scale)  
 Vicinity of Rochester, MN.

United States Department of the Interior  
National Park Service

# National Register of Historic Places Continuation Sheet

Section number \_\_\_\_\_ Page \_\_\_\_\_

---

**Note: These changes apply to  
Mayowood Historic District in  
Olmsted County, Minnesota.**

**REFERENCE NUMBER:** 70000306

**STATE:** MINNESOTA

**COUNTY:** Olmsted

**RESOURCE NAME (HISTORIC):**

**CITY:** Rochester

**VICINITY OF:**

**ADDRESS:** Co.Hwy. 125

**CERTIFICATION DATE:** 03/31/82

**REMOVED DATE:**

**COMMENTS:** District located in city of Rochester.  
House listed on NRHP on 09/22/70.  
Expanded to a district in 1982.

*Nina M. Archabal*  
\_\_\_\_\_  
**Nina M. Archabal**  
**State Historic Preservation Officer**

**JUN 17 1988**  
\_\_\_\_\_  
**Date**

UNITED STATES DEPARTMENT OF THE INTERIOR  
NATIONAL PARK SERVICE

NATIONAL REGISTER OF HISTORIC PLACES  
EVALUATION/RETURN SHEET

REQUESTED ACTION: ADDITIONAL DOCUMENTATION

PROPERTY NAME: Mayowood Historic District

MULTIPLE NAME:

STATE & COUNTY: MINNESOTA, Olmsted

DATE RECEIVED: 8/07/01 DATE OF PENDING LIST:  
DATE OF 16TH DAY: DATE OF 45TH DAY: 9/22/01  
DATE OF WEEKLY LIST:

REFERENCE NUMBER: 70000306

NOMINATOR: STATE

REASONS FOR REVIEW:

APPEAL: N DATA PROBLEM: N LANDSCAPE: N LESS THAN 50 YEARS: N  
OTHER: N PDIL: N PERIOD: N PROGRAM UNAPPROVED: N  
REQUEST: N SAMPLE: N SLR DRAFT: N NATIONAL: N

COMMENT WAIVER: N

ACCEPT  RETURN  REJECT 9/15/01 DATE

ABSTRACT/SUMMARY COMMENTS:

**Additional Documentation Accepted**

RECOM./CRITERIA \_\_\_\_\_

REVIEWER \_\_\_\_\_ DISCIPLINE \_\_\_\_\_

TELEPHONE \_\_\_\_\_ DATE \_\_\_\_\_

DOCUMENTATION see attached comments Y/N see attached SLR Y/N

AD

United States Department of the Interior  
National Park Service

National Register of Historic Places  
Continuation Sheet

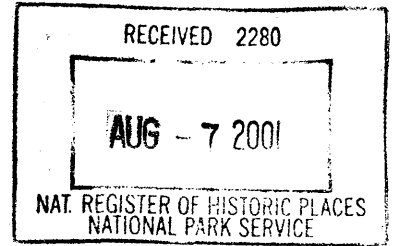

Section number 2 Page 1

Mayowood Historic District  
Olmsted County, Minnesota

Reference Number: 70000306

State: Minnesota

County: Olmsted

Resource Name (Historic): Mayowood Historic District

Location, Street & Number: 3720 Mayowood Rd. S.W.

Comments: 3720 Mayowood Rd. S.W. is the new street address

*Britta L. Bloomberg*

Britta L. Bloomberg  
Deputy State Historic  
Preservation Officer

8/1/01  
Date