

RECEIVED

RECEIVED

NOV 08 1993

JUL 13 1993

NPS Form 10-900 (Rev. 10-90)

NATIONAL REGISTER

OMB No. 1024-0018

OHP

United States Department of the Interior National Park Service

RECEIVED

NATIONAL REGISTER OF HISTORIC PLACES REGISTRATION FORM

NOV 08 1993

NATIONAL REGISTER

This form is for use in nominating or requesting determinations for individual properties and districts. See instructions in How to Complete the National Register of Historic Places Registration Form (National Register Bulletin 16A). Complete each item by marking "x" in the appropriate box or by entering the information requested. If any item does not apply to the property being documented, enter "N/A" for "not applicable." For functions, architectural classification, materials, and areas of significance, enter only categories and subcategories from the instructions. Place additional entries and narrative items on continuation sheets (NPS Form 10-900a). Use a typewriter, word processor, or computer, to complete all items.

1. Name of Property

historic name Wheatland Masonic Temple other names/site number Odd Fellows Hall/Nicolaus Masonic Lodge No. 129

2. Location

street & number 400 Front Street city or town Wheatland state California code CA county Yuba code 115 zip code 95692

3. State/Federal Agency Certification

As the designated authority under the National Historic Preservation Act of 1986, as amended, I hereby certify that this nomination request for determination of eligibility meets the documentation standards for registering properties in the National Register of Historic Places and meets the procedural and professional requirements set forth in 36 CFR Part 60. In my opinion, the property meets does not meet the National Register Criteria. I recommend that this property be considered significant nationally statewide locally. See continuation sheet for additional comments.)

Signature of certifying official Steade R. Craygo Date 11.3.93

California Office of Historic Preservation State or Federal agency and bureau

In my opinion, the property meets does not meet the National Register criteria. See continuation sheet for additional comments.)

Signature of commenting or other official Date

State or Federal agency and bureau

4. National Park Service Certification

I, hereby, certify that this property is:

- | | | |
|--|--|--|
| <input checked="" type="checkbox"/> entered in the National Register
<input type="checkbox"/> See continuation sheet.
<input type="checkbox"/> determined eligible for the
National Register
<input type="checkbox"/> See continuation sheet.
<input type="checkbox"/> determined not eligible for the
National Register
<input type="checkbox"/> removed from the National Register

<input type="checkbox"/> other (explain): _____ | 

_____ |

12/23/93

_____ |
|--|--|--|

*f*n Signature of Keeper Date
 of Action

5. Classification

Ownership of Property (Check as many boxes as apply)

- private
- public-local
- public-State
- public-Federal

Category of Property (Check only one box)

- building
- district
- site
- structure
- object

Number of Resources within Property

Contributing	Noncontributing
__1__	_____ buildings
_____	_____ sites
_____	_____ structures
_____	_____ objects
__1__	__-0-__ Total

Number of contributing resources previously listed in the National Register __-0-__

Name of related multiple property listing (Enter "N/A" if property is not part of a multiple property listing.) N/A _____

=====

6. Function or Use

=====

Historic Functions (Enter categories from instructions)

Cat: Social _____	Sub: Meeting Hall _____
Commerce _____	Department Store _____
_____	_____
_____	_____
_____	_____
_____	_____
_____	_____

Current Functions (Enter categories from instructions)

Cat: Social _____	Sub: Meeting Hall _____
Health Care _____	Medical Office _____
Commerce _____	Specialty _____
_____	_____
_____	_____
_____	_____
_____	_____

=====

7. Description

=====

Architectural Classification (Enter categories from instructions)
Classical Revival

Materials (Enter categories from instructions)

foundation cement _____
roof _____
walls brick _____
other stucco over brick _____

Narrative Description (Describe the historic and current condition of the property on one or more continuation sheets.)

=====

8. Statement of Significance

=====

Applicable National Register Criteria (Mark "x" in one or more boxes for the criteria qualifying the property for National Register listing)

- A Property is associated with events that have made a significant contribution to the broad patterns of our history.
- B Property is associated with the lives of persons significant in our past.
- C Property embodies the distinctive characteristics of a type, period, or method of construction or represents the work of a master, or possesses high artistic values, or represents a significant and distinguishable entity whose components lack individual distinction.
- D Property has yielded, or is likely to yield information important in prehistory or history.

Criteria Considerations (Mark "X" in all the boxes that apply.)

- A owned by a religious institution or used for religious purposes.
- B removed from its original location.
- C a birthplace or a grave.
- D a cemetery.
- E a reconstructed building, object, or structure.
- F a commemorative property.
- G less than 50 years of age or achieved significance within the past 50 years.

Areas of Significance: (Enter categories from instructions)

A. Social History

C. Architecture

Period of Significance: 1898-1943

Significant Dates: 1898-1899 Construction

Significant Person (Complete if Criterion B is marked above)

Cultural Affiliation N/A _____

Architect/Builder Cook, A.A., Architect _____
Bovyer, E.A, Builder 520 L St., Sac. (1881, 1898?)

Narrative Statement of Significance (Explain the significance of the property on one or more continuation sheets.)

=====

9. Major Bibliographical References

=====

(Cite the books, articles, and other sources used in preparing this form on one or more continuation sheets.)

- Previous documentation on file (NPS)
 preliminary determination of individual listing (36 CFR 67) has been requested. (see Attachments)
 previously listed in the National Register
 previously determined eligible by the National Register
 designated a National Historic Landmark
 recorded by Historic American Buildings Survey # _____
 recorded by Historic American Engineering Record # _____

- Primary Location of Additional Data
 State Historic Preservation Office
 Other State agency
 Federal agency
 Local government
 University
 Other

Name of repository: _____

=====

10. Geographical Data

=====

Acreage of Property 5,200 sq ft (100' X 52')

UTM References (Place additional UTM references on a continuation sheet)

	Zone	Easting	Northing	Zone	Easting	Northing
1	10	636600	4318980	3	_____	_____
2	_____	_____	_____	4	_____	_____

_____ See continuation sheet.

Verbal Boundary Description (Describe the boundaries of the property on a continuation sheet.)

Boundary Justification (Explain why the boundaries were selected on a continuation sheet.)

USDI/NPS NRHP Registration Form

Wheatland Masonic Temple
Yuba County, California

11. Form Prepared By

name/title Eleanor H. Derr / Earl D. Nelson

organization Cultural Resources Unlimited / EDN Associates date December 1992

street & number 2614 Aramon Dr./3201 San Carlos Way phone (916)363-8774/453-1534

city or town Rancho Cordova / Sacramento state CA zip code 95670 /95817

Additional Documentation

Submit the following items with the completed form:

Continuation Sheets

Maps

A USGS map (7.5 or 15 minute series) indicating the property's location.

A sketch map for historic districts and properties having large acreage or numerous resources.

Photographs

Representative black and white photographs of the property.

Additional items (Check with the SHPO or FPO for any additional items)

Property Owner

(Complete this item at the request of the SHPO or FPO.)

name__Nicolaus Masonic Lodge #129

street & number__400 Front Street telephone_(916) 633-

city or town__Wheatland state_CA zip code __95692

Paperwork Reduction Act Statement: This information is being collected for applications to the National Register of Historic Places to nominate properties for listing or determine eligibility for listing, to list properties, and to amend existing listings. Response to this request is required to obtain a benefit in accordance with the National Historic Preservation Act, as amended (16 U.S.C. 470 et seq.).

Estimated Burden Statement: Public reporting burden for this form is estimated to average 18.1 hours per response including the time for reviewing instructions, gathering and maintaining data, and completing and reviewing the form. Direct comments regarding this burden estimate or any aspect of this form to the Chief, Administrative Services Division, National Park Service, P.O. Box 37127, Washington, DC 20013-7127; and the Office of Management and Budget, Paperwork Reductions Project (1024-0018), Washington, D.C. 20503

United States Department of the Interior
National Park Service
NATIONAL REGISTER OF HISTORIC PLACES
CONTINUATION SHEET

Section 7 Page 7

Wheatland Masonic Lodge _____
name of property
Yuba County, California _____
county and State

=====
Narrative Description

The Wheatland Lodge is a two-story Late 19th-Century Revival building displaying Italianate and Classical influences. It is a west-facing rectangular brick structure 52 feet in width and 85 feet long located on the southeast corner of Fourth and Front Streets in downtown Wheatland. The front (west) elevation, south elevation and the west 35 feet of the north elevation (facing Fourth Street) have been covered with a one-half inch layer of stucco, painted white. The rear of the building and rear portion of the north elevation are exposed unpainted common bond red brick with white mortar. The property currently closely resembles the original facade, with some modification of the parapet and storefronts, however, the building still retains a high level of integrity.

The ground floor along Front Street provides commercial store-front shop space for a hair styling salon and a dental office. The entire second floor is dedicated to Masonic Temple activities and consists of a large meeting hall, a smaller dining hall, a kitchen, several anterooms, restrooms and storage space. An unfinished full basement with a dirt floor and brick walls lies beneath the entire building. The Temple entrance is located on the rear portion of the Fourth Street elevation, with second story access provided by means of a six-foot wide carpeted wooden staircase in the foyer. A recent modification has been the installation of a mechanized chair lift along the wall for mandated handicapped access. The staircase makes a 90-degree turn at the landing midway up, and the walls flanking the staircase have dark stained hardwood paneling for wainscoting. The second story wooden hand rail is supported by wooden balusters.

The Fourth Street (front) elevation stucco covering contains a cosmetic trowel design which gives the appearance of masonry block construction, simulating blocks 12 inches high and 52 inches in length. The remainder of the stucco on all sides is smoothly finished. Other decorative features on the front elevation, second story level, consist of stucco-covered pilasters with vertical recessed plain panels. The pilasters separate three bays. The two outside bays each contain two large rectangular double-hung sash windows, one with inside louvered shutters. The top portion of each inside window in these two bays contains a leaded glass design with two half and three full intertwined vertical ellipses. This same leaded glass design occurs in the two western-most windows facing Fourth Street. The middle bay of the Front Street elevation contains three smaller fixed windows featuring colored leaded glass, with each window set above a corresponding recessed panel (possibly a previous window). All of the windows are topped by flat elliptical arches. The flat roof is hidden by a parapet containing recessed panels of festoon-like ornamental plasterwork.

United States Department of the Interior
National Park Service

NATIONAL REGISTER OF HISTORIC PLACES

CONTINUATION SHEET

Section 7 Page 8

Wheatland Masonic Lodge _____
name of property
Yuba County, California _____
county and State

=====

Narrative Description Continued

The two commercial shops at the street level each occupy half of the ground floor. Each shop has a double door entrance at its center flanked on each side by two large shop windows, one leading from the doors to the street on an angle, and one paralleling the street. The doors are of hardwood, each with a single glass panel. Above each large front window is another window complex consisting of a single large rectangular pane of glass surrounded by smaller glass panels, retaining the original design. Below the main shop windows, at the sidewalk and entrance, are matching decorative rectangular panels, as was on the building in the historic period. Those panels located adjacent to the street contain cast metal decorative venting grillwork surrounded by wood molding. Those alongside the entrance are of wood surrounded by similar molding.

On the Fourth Street side, the rear portion of the building is exposed red brick comprising four bays separated by pilasters. On the second floor, two of the four bays are each divided in half by pilasters. The cornice is characterized by dentils. The second floor windows are rectangular double hung sash, some with inside louvered shutters. All windows and doors on this elevation are topped with elliptical arches. All windows on the rear of the building (east side) and the south side are flanked by permanently mounted iron eyelets intended to support exterior metal-clad shutters. Only one set of such shutters remains--on the ground floor window at the rear of the building under the fire escape.

The building is taller than the surrounding buildings and is prominently located on a corner in the central business district facing the only railroad which passes through town. The adjacent auto parts store to the south is of similar vintage; other buildings in the neighborhood are generally newer or have been modernized, and none are now as architecturally interesting as the Masonic Temple.

Modifications

The stucco on the front portion of the building was added in 1903 to conceal some damage after a fire. Cornice details of the building top were removed during repairs in the mid-1950s, and an angled aluminum awning was extended across its length above the doors and windows of the shops, replacing the original flatter wooden canopy. Ornamental work was removed from the top of the walls about 1958.

United States Department of the Interior
National Park Service
NATIONAL REGISTER OF HISTORIC PLACES
CONTINUATION SHEET

Section 7 Page 9

Wheatland Masonic Lodge _____
name of property
Yuba County, California _____
county and State

=====
Narrative Description Continued

Old photos (circa 1917, 1930) show the two doors at Anderson's (northern store) each divided vertically into two shorter panels, with a horizontal wooden panel above the existing lower wooden panel. These lower wooden panels also show two square panels, rather than one horizontal panel. It is possible that these were screen doors placed over the single-pane glassed doors, as it is believed by the lodge that the current doors are original. The old photo shows the southern store with doors as in the existing configuration.

United States Department of the Interior
National Park Service
NATIONAL REGISTER OF HISTORIC PLACES
CONTINUATION SHEET

Section 8 Page 10

Wheatland Masonic Lodge _____
name of property
Yuba County, California _____
County and State

=====
Statement of Significance

The building is historically significant under National Register Criteria A, association with events which have made a broad contribution to the social history of Wheatland by its service to the community as a fraternal hall; and C, as the most architecturally significant and distinguished building in the City of Wheatland. Although still significant in its appearance and lodge activities, the period of significance is arbitrarily ended in 1943, as the National Register does not list properties for events that have occurred in the last fifty years.

The building's dedication to quasi-public temple use (Odd Fellows, Masons and Eastern Star) resulted in a significant role in the lives of many Wheatland citizens virtually through the entire history of the community, contributing to the development of the social history of the community. The contributions made to the community by the lodges after 1898, when this building was first constructed (it was partially rebuilt in 1903 after a fire--see Appeal-Democrat 1/23/1960:C-13,c.4,7) may be summarized as being a cohesive force in the development of feelings of community life (friendship) and civic responsibility (community pride). These attributes were important in developing an early-day community, especially in rural areas where social affairs were limited and opportunities for acquaintance were fewer than in urban areas. Churches and lodges were primary social venues and the friendships forged in such settings often led to the desire to improve life in the community as a whole. The lodge and its activities are still important to Wheatland residents, however as described above, the more important time for these developments was when Wheatland was a small, somewhat isolated community with fewer resources for social and entertainment activities than now exist.

Activities which have taken place in the building include church services, funerals, socials and lodge meetings. As well as being the town's primary lodge hall, the building was also the site of the Justice Court of Wheatland, utilizing a ground floor office, and a stationery store (Anderson's) which housed the Wheatland telephone exchange for many years.

The building is also significant under National Register Criteria C, in the area of architecture as a rare example in the community of Wheatland of a 19th Century non-residential building. It is one of the oldest remaining buildings in the City of Wheatland. The lodge building is one of the most visually interesting (see description above) and one of the best preserved buildings in the town. It's location in the heart of the Wheatland business district and its height and design--it is taller and more elaborate than the surrounding buildings--make it the most prominent building in the downtown area. Its brick and stucco construction has survived the ravages of time well, making it

United States Department of the Interior
National Park Service
NATIONAL REGISTER OF HISTORIC PLACES
CONTINUATION SHEET

Section 8 Page 11

Wheatland Masonic Lodge _____
name of property
Yuba County, California _____
County and State

=====
especially suited to historic preservation. It is on its original location and has retained its original function. It is in good physical condition and its recent remodeling/ updating has been done in accordance with preservation guidelines. The only other building of comparable age and relatively good integrity is the former bank building adjacent on the south. This building, although architecturally interesting, is smaller and does not appear from the outside to be in as good condition as the lodge building. A few other buildings of some age remain, but have been remodeled and their distinguishing architectural features destroyed or covered up by newer materials and styles. None of these appear to have ever had the architectural quality or imposing size of the lodge building.

The town of Wheatland was laid out in 1866, on land surrounded by 20,000 acres of wheat fields. Wheatland also later became one of the world's major hop-growing regions. A post office was established in 1866 and the California and Oregon Railroad (later the Southern Pacific) was built through town along with an associated depot. Lot sales were most active in 1871 and 1872 and early buildings included a store at Main and Front Streets, a residence at Main and D Streets, a blacksmith shop at Main and C and a hotel at the east end of Main Street. In 1872 the Wheatland Flour Mill was founded, later owned by the Sperry Flour Company (1892-1896). The town was incorporated on March 13, 1874 and by 1878 had a population of 400. Major fires occurred in 1880, 1898 and 1902. After the 1898 fire, a news story from Marysville commented that "the Odd-Fellows' Hall was the finest building in Wheatland and will be a great loss to the town. It's value in connection with contents was about \$18,000." The town always rebuilt and by 1900 the population had reached 1,000. A small Chinatown existed on the other side of the railroad tracks.

The Nicolaus Lodge #129, Free and Accepted Masons (F.& A.M.) was founded on May 13, 1858 in the town of Nicolaus, west of Wheatland. By 1871 the membership had declined to 12, and the lodge was officially transferred to Wheatland, then a growing community. From the beginning they met in the I.O.O.F. Hall (Independent Order of Odd Fellows), located on the property of the current lodge building. The Eastern Star, Chapter #48 also met there (chartered on October 18, 1881 with 26 members).

The first Odd Fellows Lodge building burned on August 30, 1880 and the lodges then met in Pacific Hall. The replacement hall was built in 1885, which also burned on August 12, 1898 after which the existing building was constructed. The first Masonic meeting in the existing building was on May 8, 1899, with the Masons having a share in the ownership of the Odd Fellows Hall Association. In 1948 the Masons bought out the Odd Fellows and formed a new building association.

United States Department of the Interior
National Park Service

NATIONAL REGISTER OF HISTORIC PLACES CONTINUATION SHEET

Section 8 Page 12

Wheatland Masonic Lodge _____
name of property
Yuba County, California _____
County and State

=====

The Wheatland telephone service was established in 1893 by the Sunset Telephone Company, a predecessor of the Pacific Bell Telephone Company. By 1905 long distance was limited to Marysville, Smartsville and rural areas along the Bear and Yuba Rivers. In 1907 F.W. Anderson, owner of a stationery store located in the ground floor of the lodge hall and with interest in establishing a farmer's line, was made telephone agent and the exchange was moved from the post office building to his store. Mr. Anderson also put in a new Wheatland-Marysville line. The exchange stayed in this location until 1948, when dial service was installed. The Andersons, with help from their son and daughter, ran the phone service as a family business. In 1938 a grandson and his wife, living in the rear of the store, also began taking night calls, continuing for ten years until the dial system began operations.

United States Department of the Interior
National Park Service

NATIONAL REGISTER OF HISTORIC PLACES CONTINUATION SHEET

Section 9 Page 13

Wheatland Masonic Lodge _____
name of property
Yuba County, California _____
county and State

=====

Bibliography

- Baltzell, Philip O.
1958 "One Hundred Years of Nicolaus Lodge #129 F. & A.M."
Unpublished ms. on file, Wheatland Lodge.
- Wheatland Historical Society
1974 "The City of Wheatland, California, 1874-1974: The History of
Wheatland". Wheatland.

Newspapers

- Appeal-Democrat: Centennial Edition. 'Wheatland Area Developed Early'.
January 23, 1960, Pp. C-13. Marysville.
- Appeal-Democrat. 'Wheatland era coming to an end: Anderson's Store readied
to close'. March 16, 1985.
- Marysville Daily Appeal. (Article on 1898 fire, comments on destruction of
Odd-Fellows Hall). August 13, 1898.

Letters

- M. Lortie, Office of Historic Preservation; per Jim Hudson, to Earl D.
Nelson July 30, 1986.

United States Department of the Interior
National Park Service
NATIONAL REGISTER OF HISTORIC PLACES
CONTINUATION SHEET

Section 10 Page 14

Wheatland Masonic Lodge _____
name of property
Yuba County, California _____
county and State

=====

Geographical Data

Verbal Boundary Description

The corner of Front Street (front of building) and Fourth Street (side of building), in the City of Wheatland, Yuba County, California. Assessor's Map Book 15, Page 25, Lot #1 (noted as 'Andersons' on Assessor's map).

Boundary Justification

Property is located on its original city lot located on the southeast corner of Fourth and Front Streets in the City of Wheatland, CA (Yuba County). This lot encompasses only the building and its adjacent rear parking area.

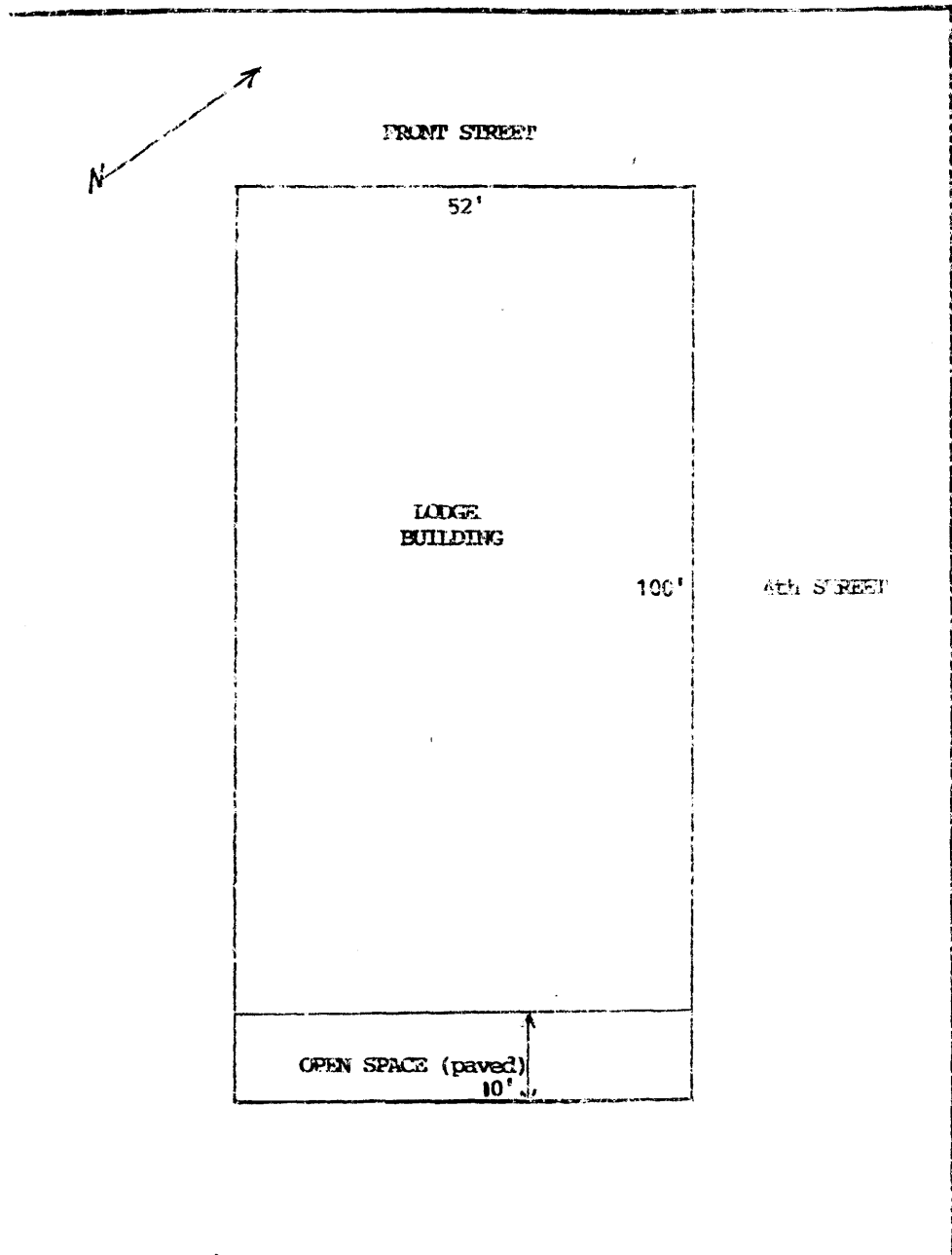

Wheatland Lodge Building
Wheatland, Yuba County, CA