

**NATIONAL REGISTER OF HISTORIC PLACES
INVENTORY - NOMINATION FORM**

(Type all entries - complete applicable sections)

STATE: Nebraska	
COUNTY: Jefferson	
FOR NPS USE ONLY	
ENTRY NUMBER	DATE
	MAR 16 1972

1. NAME

COMMON:
Steele City Historic District

AND/OR HISTORIC:

2. LOCATION

STREET AND NUMBER:
(See continuation sheet)

CITY OR TOWN:
Steele City

STATE:
Nebraska

CODE: 095

Jefferson

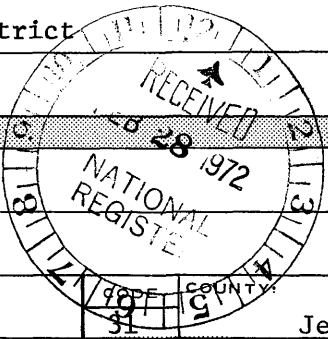

3. CLASSIFICATION

CATEGORY (Check One)	OWNERSHIP	STATUS	ACCESSIBLE TO THE PUBLIC
<input checked="" type="checkbox"/> District <input type="checkbox"/> Site <input type="checkbox"/> Object <input type="checkbox"/> Building <input type="checkbox"/> Structure <input type="checkbox"/> Object	<input type="checkbox"/> Public <input checked="" type="checkbox"/> Private <input type="checkbox"/> Both	Public Acquisition: <input type="checkbox"/> In Process <input type="checkbox"/> Being Considered	<input checked="" type="checkbox"/> Occupied <input checked="" type="checkbox"/> Unoccupied <input checked="" type="checkbox"/> Preservation work in progress
PRESENT USE (Check One or More as Appropriate)			
<input type="checkbox"/> Agricultural <input type="checkbox"/> Commercial <input type="checkbox"/> Educational <input type="checkbox"/> Entertainment	<input type="checkbox"/> Government <input type="checkbox"/> Industrial <input type="checkbox"/> Military <input checked="" type="checkbox"/> Museum	<input type="checkbox"/> Park <input checked="" type="checkbox"/> Private Residence <input type="checkbox"/> Religious <input type="checkbox"/> Scientific	<input type="checkbox"/> Transportation <input checked="" type="checkbox"/> Other (Specify) Vacant

4. OWNER OF PROPERTY

OWNER'S NAME:
(Multiple private ownership)

STREET AND NUMBER:

CITY OR TOWN:
Steele City

STATE:
Nebraska

CODE:
31

5. LOCATION OF LEGAL DESCRIPTION

COURTHOUSE, REGISTRY OF DEEDS, ETC.:
County Clerk, Jefferson County Court House

STREET AND NUMBER:

CITY OR TOWN:
Fairbury

STATE:
Nebraska

CODE:
31

6. REPRESENTATION IN EXISTING SURVEYS

TITLE OF SURVEY:
Historic Preservation in Nebraska - Preliminary Plan

DATE OF SURVEY: October 1970
 Federal State County Local

DEPOSITORY FOR SURVEY RECORDS:
Nebraska State Historical Society

STREET AND NUMBER:
1500 "R" Street

CITY OR TOWN:
Lincoln

STATE:
Nebraska

CODE:
31

First Nebraska Congressional District

SEE INSTRUCTIONS

STATE: Nebraska

COUNTY: Jefferson

ENTRY NUMBER: MAR 16 1972

DATE: MAR 16 1972

FOR NPS USE ONLY

7. DESCRIPTION

CONDITION	(Check One)					
	<input type="checkbox"/> Excellent	<input checked="" type="checkbox"/> Good	<input type="checkbox"/> Fair	<input type="checkbox"/> Deteriorated	<input type="checkbox"/> Ruins	<input type="checkbox"/> Unexposed
	(Check One)			(Check One)		
	<input type="checkbox"/> Altered	<input checked="" type="checkbox"/> Unaltered		<input type="checkbox"/> Moved	<input checked="" type="checkbox"/> Original Site	

DESCRIBE THE PRESENT AND ORIGINAL (if known) PHYSICAL APPEARANCE

Steele City is situated on a picturesque site in the heavily wooded valley of the Little Blue River which runs diagonally through Jefferson County.

Listed below are those Steele City structures deemed most significant and worthy of National Register recognition. All the buildings nominated reflect that era in western history when the horse was the first and many times the only means of transportation.

Steele City Historic District has been so defined that all of the following buildings are included. The building locations are shown on an accompanying map as Steele City historic sites 1 through 7.

1. Livery Stable - Built in 1902, it's design is very clean and utilitarian. It is constructed of native rough quarried sandstone and mortar, with a low hip roof.

The First floor has a large brick arched doorway which provides a large enough opening to allow a carriage or wagon to pass through. There is also another archway on the southeast side of the building. These archways are provided with large sliding wood doors.

The second floor appears to have been used as living quarters for the owner. There is a doorway above the archway on the front facade which probably opened onto a deck which served as a protective porch for the main first floor entrance. The southeast portion of the second floor was originally used as a hay loft and another large archway, with a sliding door, accomodates it.

The building's windows are cleanly cut in the walls. Their framings and lintels are constructed of wood, but a few are arched with brick.

Recently a new shingle roof replaced a temporary metal roof. Although many of the window's mullions and panes have been broken, the building is in a good state of repair. The interior still reflects the original function and the basic character of the building has not been altered over the years.

2. Blacksmith Shop - Constructed in 1900 by J. W. Peters, who's name is inscribed on a superficial plaque, along with the date of construction, above the main entrance.

This building is also constructed of sandstone, rough cut and mortared. Its character is similar to the Livery Stable, but it's construction preceded that of the Livery Stable by two years. It has one and one half stories with the attic story furnishing quarters for the owner, as in the Livery Stable.

The structure has a gabled roof with two dormers directly opposite each other. The archways and the windows are spanned in brick and framed

SEE INSTRUCTIONS

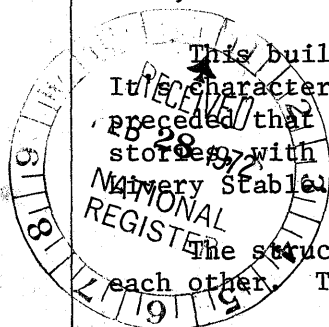

NATIONAL REGISTER OF HISTORIC PLACES
INVENTORY - NOMINATION FORM

STATE	Nebraska	
COUNTY	Jefferson	
FOR NPS USE ONLY		
ENTRY NUMBER		DATE
		MAR 16 1972

Page 1

(Continuation Sheet)

(Number all entries)

#2 Location - Bounded on the north by Curtis Street; on the south by Caroline Street; on the west by the corporate line; and on the east by Second Street.

#7 Description

in wood. There are two large archways along the building's lengthway axis which provides a circulation path through the building with offshoot stalls for the repair work. These main entrance archways are provided with sliding doors.

The roof has recently been re-shingled but minor carpentry work is still needed, mainly the replacement of most windows. Minor interior deterioration is the only physical change since it's original construction. The buildings original integrity remains unaltered.

3. Bank Building - The present structure was built between the years 1880 and 1890. The building was constructed by Abner Baker to take the place of a store swept away when the Little Blue River flooded in 1869. The building was first used as a general store but between the years 1889 and 1915 three different banking companies occupied the building. At one time the banker and his family lived in back which added another function the building had to provide.

The bank was recently purchased by the Jefferson County Historical Society who have refurbished it completely. The structure has been restored to it's early 1900's appearance when the late banker H. Clapp owned the structure.

Debris was cleaned from the main floor and wallpaper was scraped off the walls. Through contributions and local initiative the bank has succeeded in achieving an authentic restoration of it's peak commercial period. The business and residence sections have been completely refurbished and are now open to public tours.

The building material of this period tended toward longer lasting materials such as stone and brick of which this building is constructed. The lower story is of rough cut sandstone and mortar construction and the upper story, which opens onto the street level, is of brick and mortar construction. The bricks were made at a pottery factory in Steele City at that time.

The bank building is a typical example of turn of the century commercial architecture, utilitarian in character and simple in form and construction.

Baptist Church - On October 20, 1882, Robert Crinklan transferred a plot of ground to the Trustees of the First Baptist Church in Steele City, and at same year a church was erected.

In 1901, as many of the older members passed away and it became more

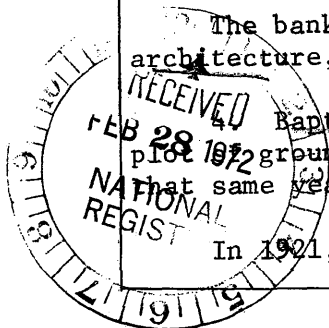

**NATIONAL REGISTER OF HISTORIC PLACES
INVENTORY - NOMINATION FORM**

STATE	
Nebraska	
COUNTY	
Jefferson	
FOR NPS USE ONLY	
ENTRY NUMBER	DATE
	MAR 16 1972

Page 2

(Continuation Sheet)

(Number all entries)

difficult to maintain a pastor, the Deed and assets of the church were transferred to the Nebraska Baptist State Convention who in turn sold the building to the Lincoln Lodge, Knights of Pythias 146, of Steele City. The Knights of Pythias still occupy and maintain the building.

The church is Romanesque in character with a large round cathedral window on the front facade, reminiscent of Gothic influences. Arthur Bower, a stone cutter, is accredited with the building of this pretentious structure. The church is constructed of fine grade limestone which the members hauled from a quarry near Hanover, Kansas. Mr. Bower shaped the rough quarried limestone into oblong blocks, all of the same size. Each block had a border of smooth rock, with the natural rough surface forming the inner part of the block. This rough stone construction is typical of the Richardsonian Romanesque Style. The interior integrity has been preserved by use of hard wood floors and partitions.

The original character of the church has endured through the years and represents a rugged well preserved building. It is one of the few remaining disbanded church buildings in Jefferson County today.

The round stained glass window on the front has in recent years been bricked up and there are minor cracks from foundation settling apart from this the church is a true representation of the original structure.

5. Zoellin House - The house may have been built by J. F. Zoellin in ca. 1890. The structure is Victorian in character but has many Italianate features. The roof system is a very curious combination of forms. The front half has a very steep pitch which turns out sharply and extends past the walls forming a hip roof appearance. The rear half drops down approximately 18" and is flat. The entire eaves line is treated in an Italianate manner with ornate angle supports, regularly spaced.

The facade has two bay windows, one of which extends two stories. A porch extends around the entire front half of the house. The rear half of the house appears to be a latter addition but is reflective, in construction and building materials used, of the original structure.

6. and 7. - Two additional structures located within the defined boundaries of Steele City Historic District and with sufficient significance to be noted here, is a one story, frame house and barn (noted on the map as site No. 6) built in ca. 1880 and the Mercantile store building (noted on the map as site No. 7) built in ca. 1900. Both structures, in materials used and construction method, are typical products of home and commercial building during this period.

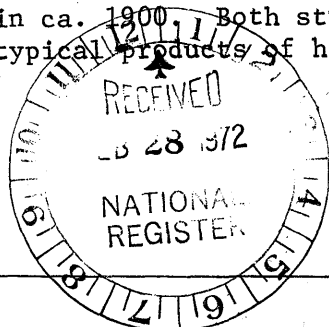

SIGNIFICANCE

PERIOD (Check One or More as Appropriate)

- | | | | |
|--|---------------------------------------|--|---------------------------------------|
| <input type="checkbox"/> Pre-Columbian | <input type="checkbox"/> 16th Century | <input type="checkbox"/> 18th Century | <input type="checkbox"/> 20th Century |
| <input type="checkbox"/> 15th Century | <input type="checkbox"/> 17th Century | <input checked="" type="checkbox"/> 19th Century | |

SPECIFIC DATE(S) (If Applicable and Known)

AREAS OF SIGNIFICANCE (Check One or More as Appropriate)

- | | | | |
|--|---|--|--|
| <input type="checkbox"/> Aboriginal | <input type="checkbox"/> Education | <input type="checkbox"/> Political | <input type="checkbox"/> Urban Planning |
| <input type="checkbox"/> Prehistoric | <input type="checkbox"/> Engineering | <input type="checkbox"/> Religion/Philosophy | <input type="checkbox"/> Other (Specify) _____ |
| <input type="checkbox"/> Historic | <input type="checkbox"/> Industry | <input type="checkbox"/> Science | _____ |
| <input type="checkbox"/> Agriculture | <input type="checkbox"/> Invention | <input type="checkbox"/> Sculpture | _____ |
| <input checked="" type="checkbox"/> Architecture | <input type="checkbox"/> Landscape Architecture | <input type="checkbox"/> Social/Humanitarian | _____ |
| <input type="checkbox"/> Art | <input type="checkbox"/> Literature | <input type="checkbox"/> Theater | _____ |
| <input checked="" type="checkbox"/> Commerce | <input type="checkbox"/> Military | <input type="checkbox"/> Transportation | _____ |
| <input type="checkbox"/> Communications | <input type="checkbox"/> Music | | |
| <input type="checkbox"/> Conservation | | | |

STATEMENT OF SIGNIFICANCE

SEE INSTRUCTIONS

Steele City was platted in 1873, six years after Nebraska became a State, by Abner Baker and Robert Crinklow. The town was named in honor of D. M. Steele, President at the time, of the St. Joe & Western Railway. This railroad line ran through the town and stimulated the towns gradual growth into one of the best business centers and largest shipping stations along the St. Joe & Western lines. In 1879 Steele City was organized as a village under Nebraska Statute provisions.

During the late 1880's and early 1890's the town continued to grow and contained several stores, a flour mill, grain warehouses, and other business establishments.

In more recent years, due to declining railroad activity, the town's expansion and population has leveled off, but the town still functions as a rural center of business interests and organizations.

All of the structures in the Steele City Historical District represent fine examples of vernacular architecture, or an architecture without architects. They represent that period in western development when ornament for ornaments sake was consumed by the specific need for functional buildings. The designer, in most cases a technically competent layman, constructed the building without preoccupation with the intrinsic design elements that were in popular demand during this period. This kind of building is perhaps the truest form of a native American Architectural Style.

overridden

During the past year efforts have been made by the local community and interested individuals to restore the buildings within the Steele City Historic District, and if these efforts continue, Steele City could well develop into one of the best, typical restored frontier cities in the midwest.

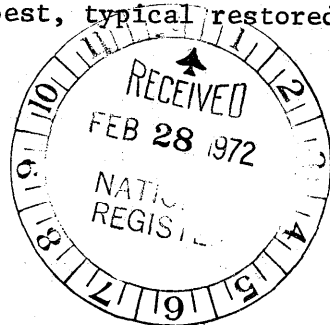

9. MAJOR BIBLIOGRAPHICAL REFERENCES

Files, Nebraska State Historical Society

10. GEOGRAPHICAL DATA

LATITUDE AND LONGITUDE COORDINATES DEFINING A RECTANGLE LOCATING THE PROPERTY			O R	LATITUDE AND LONGITUDE COORDINATES DEFINING THE CENTER POINT OF A PROPERTY OF LESS THAN TEN ACRES		
CORNER	LATITUDE			LATITUDE		LONGITUDE
	Degrees	Minutes	Seconds	Degrees	Minutes	Seconds
NW	97°	01'	35"	40°	02'	22"
NE	97°	01'	35"	40°	02'	22"
SE	97°	01'	12"	40°	02'	07"
SW	97°	01'	12"	40°	02'	07"

APPROXIMATE ACREAGE OF NOMINATED PROPERTY: Approximately 7 acres

LIST ALL STATES AND COUNTIES FOR PROPERTIES OVERLAPPING STATE OR COUNTY BOUNDARIES

STATE:	CODE	COUNTY:	CODE

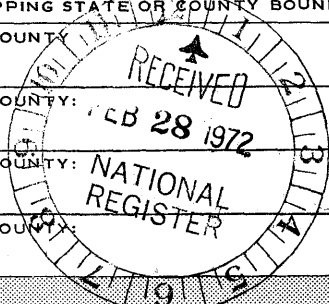

11. FORM PREPARED BY

NAME AND TITLE:
Persijs Kolberg, Curator of Historic Sites

ORGANIZATION: Nebraska State Historical Society DATE: Febr. 1, 1972

STREET AND NUMBER:
1500 "R" Street

CITY OR TOWN: Lincoln STATE: Nebraska CODE: 31

12. STATE LIAISON OFFICER CERTIFICATION

As the designated State Liaison Officer for the National Historic Preservation Act of 1966 (Public Law 89-665), I hereby nominate this property for inclusion in the National Register and certify that it has been evaluated according to the criteria and procedures set forth by the National Park Service. The recommended level of significance of this nomination is:

National State Local

Name Martin O'Kretz

Title Director, Nebraska State Historical Society

Date Febr. 1, 1972

NATIONAL REGISTER VERIFICATION

I hereby certify that this property is included in the National Register.

Ernest A. Connally
Chief, Office of Archeology and Historic Preservation

MAR 16 1972

Date _____

ATTEST: William Stuebel
Keeper of The National Register

MAR 7 1972

Date _____

SEE INSTRUCTIONS

Steele City

JEFFERSON CO

SEC 19. T. 1 N. R. 4 E.

Scale 600 ft. to 1 Inch.

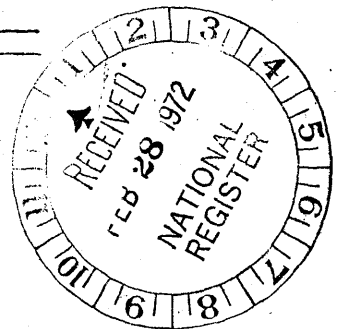
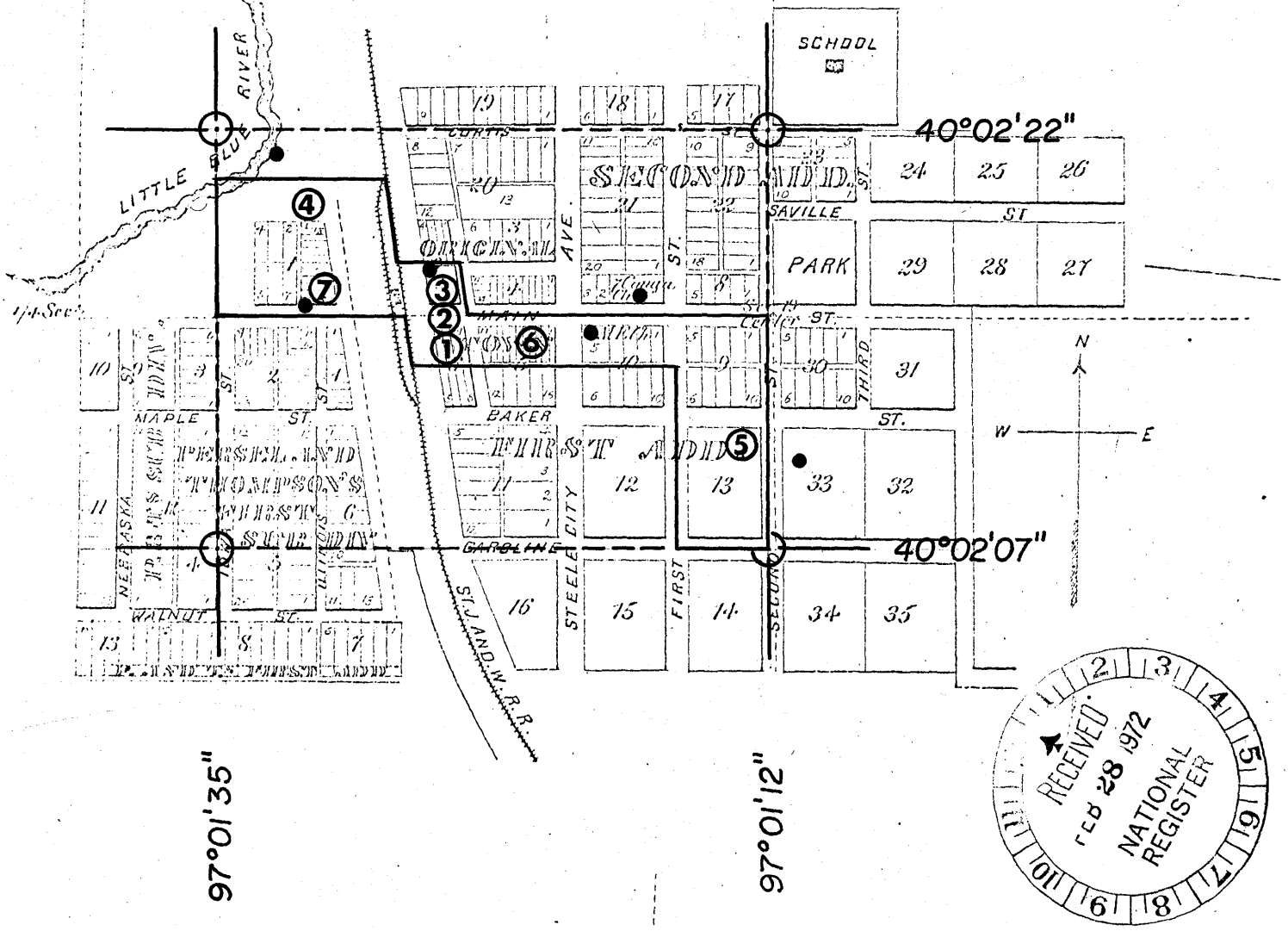

STEEL CITY HISTORIC DISTRICT
 PRINCIPAL HISTORIC BUILDINGS
 AND STRUCTURES _____ ③
 ADDITIONAL HISTORIC BUILDINGS
 AND SITES _____ ●

Form 10-301
(July 1969)

UNITED STATES DEPARTMENT OF THE INTERIOR
NATIONAL PARK SERVICE

**NATIONAL REGISTER OF HISTORIC PLACES
PROPERTY MAP FORM**

(Type all entries - attach to or enclose with map)

STATE Nebraska	
COUNTY Jefferson	
FOR NPS USE ONLY	
ENTRY NUMBER	DATE
	MAR 16 1972

SEE INSTRUCTIONS

1. NAME			
COMMON:		Steele City Historic District	
AND/OR HISTORIC:			
2. LOCATION			
STREET AND NUMBER:			
(See continuation sheet)			
CITY OR TOWN:			
Steele City			
STATE:	CODE	COUNTY:	CODE
Nebraska	31	Jefferson	095
3. MAP REFERENCE			
SOURCE:			
The Official Atlas of Nebraska			
SCALE:			
1" = 600'			
DATE:			
1885 (compiled by Everts and Kirk, Philadelphia)			
4. REQUIREMENTS			
TO BE INCLUDED ON ALL MAPS			
1. Property boundaries where required.			
2. North arrow.			
3. Latitude and longitude reference.			

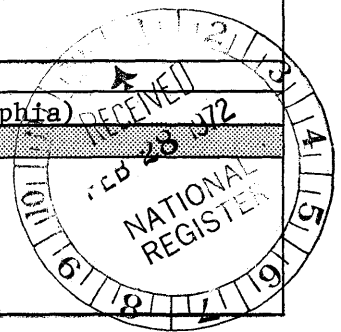

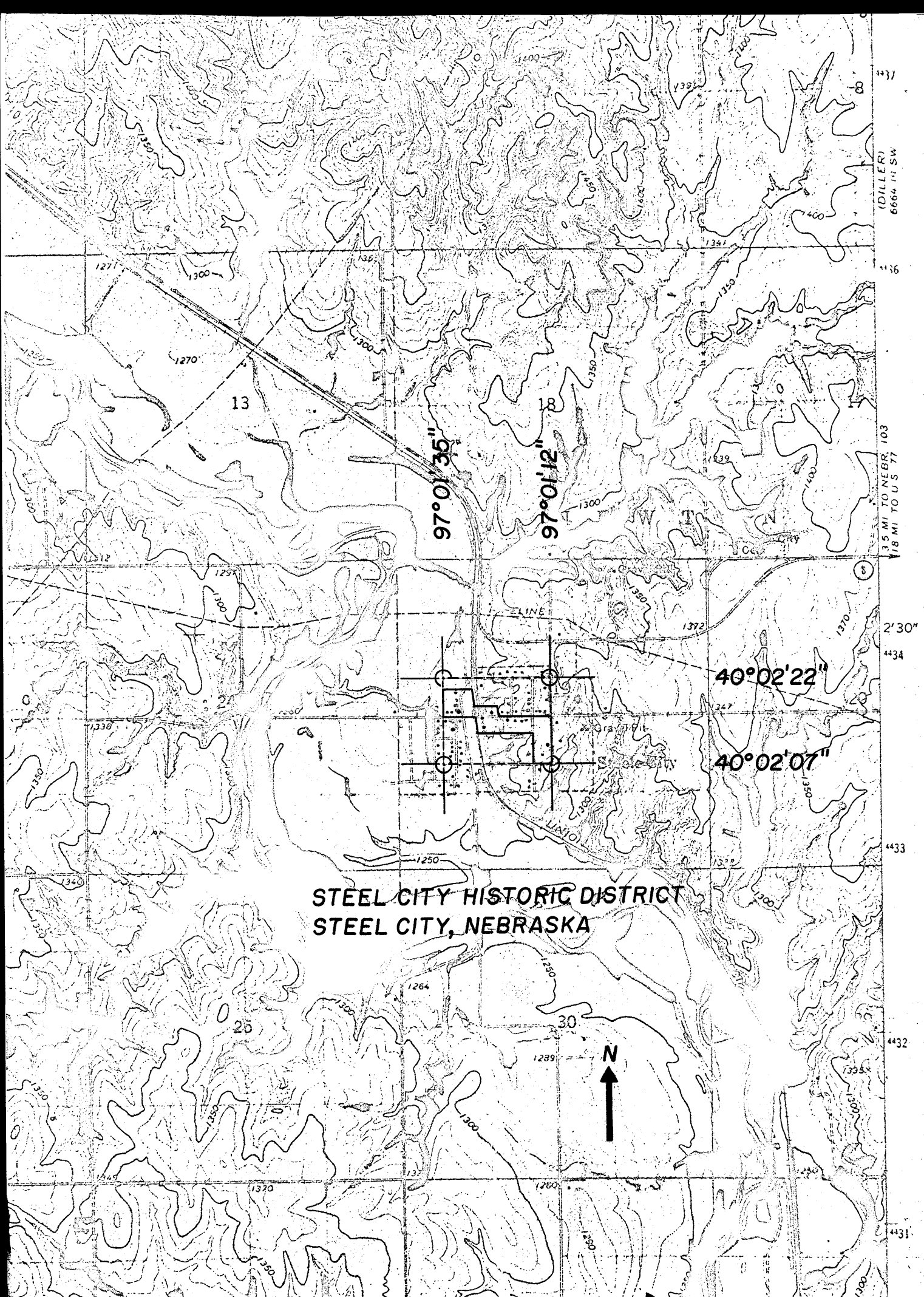

**STEEL CITY HISTORIC DISTRICT
STEEL CITY, NEBRASKA**



97°01'35"

97°01'12"

40°02'22"

40°02'07"

(DILLER)
6664 11 SW

3.5 MI TO NEBR 103
1.8 MI TO U.S. 77

2'30"

4433

4432

4431

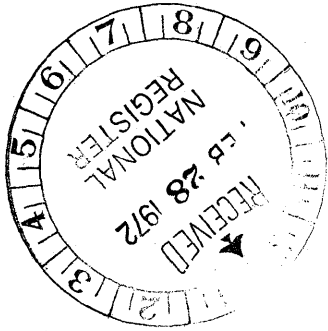

Form 10-301
(July 1969)

UNITED STATES DEPARTMENT OF THE INTERIOR
NATIONAL PARK SERVICE

**NATIONAL REGISTER OF HISTORIC PLACES
PROPERTY MAP FORM**

(Type all entries - attach to or enclose with map)

STATE Nebraska	
COUNTY Jefferson	
FOR NPS USE ONLY	
ENTRY NUMBER MAR 16 1972	DATE

SEE INSTRUCTIONS

1. NAME			
COMMON:	Steele City Historic District		
AND/OR HISTORIC:			
2. LOCATION			
STREET AND NUMBER:			
(See continuation sheet)			
CITY OR TOWN:			
Steele City			
STATE:	CODE	COUNTY:	CODE
Nebraska	31	Jefferson	095
3. MAP REFERENCE			
SOURCE:			
U.S.G.S., 7½', Endicott Quadrangle			
SCALE:			
1:24,000			
DATE:			
1970 (Final advance)			
4. REQUIREMENTS			
TO BE INCLUDED ON ALL MAPS			
1. Property boundaries where required.			
2. North arrow.			
3. Latitude and longitude reference.			

