

Form 10-300
(July 1969)

UNITED STATES DEPARTMENT OF THE INTERIOR
NATIONAL PARK SERVICE

NATIONAL REGISTER OF HISTORIC PLACES INVENTORY - NOMINATION FORM

(Type all entries - complete applicable sections)

STATE: Idaho	
COUNTY: Caribou	
FOR NPS USE ONLY	
ENTRY NUMBER	DATE
	APR 24 1975

1. NAME	
COMMON: Lander Road	
AND/OR HISTORIC:	

2. LOCATION			
STREET AND NUMBER: <i>NE of Soda Springs</i> T6 and 7S, R44-46E S of ED 34 in			
CITY OR TOWN: <i>Soda Springs vic. Caribou National Forest</i>			
STATE Idaho	CODE 16	COUNTY: Caribou	CODE 029

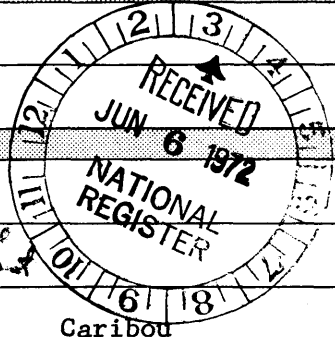

3. CLASSIFICATION			
CATEGORY (Check One)	OWNERSHIP	STATUS	ACCESSIBLE TO THE PUBLIC
<input checked="" type="checkbox"/> District <input type="checkbox"/> Building <input type="checkbox"/> Site <input type="checkbox"/> Structure <input type="checkbox"/> Object	<input checked="" type="checkbox"/> Public <input type="checkbox"/> Private <input type="checkbox"/> Both	Public Acquisition: <input type="checkbox"/> In Process <input type="checkbox"/> Being Considered	Yes: <input type="checkbox"/> Restricted <input checked="" type="checkbox"/> Unrestricted ✓ <input type="checkbox"/> No
PRESENT USE (Check One or More as Appropriate)			
<input checked="" type="checkbox"/> Agricultural <input type="checkbox"/> Commercial <input type="checkbox"/> Educational <input type="checkbox"/> Entertainment	<input type="checkbox"/> Government <input type="checkbox"/> Industrial <input type="checkbox"/> Military <input type="checkbox"/> Museum	<input type="checkbox"/> Park <input type="checkbox"/> Private Residence <input type="checkbox"/> Religious <input type="checkbox"/> Scientific	<input type="checkbox"/> Transportation <input type="checkbox"/> Other (Specify) _____ _____ _____

4. OWNER OF PROPERTY			
OWNER'S NAME: U.S. Forest Service			
STREET AND NUMBER:			
CITY OR TOWN:	STATE:	CODE:	

5. LOCATION OF LEGAL DESCRIPTION			
COURTHOUSE, REGISTRY OF DEEDS, ETC.: Caribou County Courthouse			
STREET AND NUMBER:			
CITY OR TOWN: Soda Springs	STATE: Idaho	CODE: 16	

6. REPRESENTATION IN EXISTING SURVEYS			
TITLE OF SURVEY:			
DATE OF SURVEY: <input type="checkbox"/> Federal <input type="checkbox"/> State <input type="checkbox"/> County <input type="checkbox"/> Local			
DEPOSITORY FOR SURVEY RECORDS:			
STREET AND NUMBER:			
CITY OR TOWN:	STATE:	CODE:	

SEE INSTRUCTIONS

STATE: Idaho
COUNTY: Caribou
ENTRY NUMBER: APR 24 1975
DATE: _____
FOR NPS USE ONLY

7 DESCRIPTION

CONDITION	(Check One)					
	<input checked="" type="checkbox"/> Excellent	<input type="checkbox"/> Good	<input type="checkbox"/> Fair	<input type="checkbox"/> Deteriorated	<input type="checkbox"/> Ruins	<input type="checkbox"/> Unexposed
	(Check One)			(Check One)		
	<input type="checkbox"/> Altered	<input checked="" type="checkbox"/> Unaltered	<input type="checkbox"/> Moved	<input checked="" type="checkbox"/> Original Site		

DESCRIBE THE PRESENT AND ORIGINAL (if known) PHYSICAL APPEARANCE

This section of Lander's road runs through Caribou National Forest along Stump creek and up Terrace canyon. Construction was particularly difficult in the canyon, where the grade is narrow, rocky, and steep. Rock had to be broken off the upper side of the sloping ledge through the canyon to fill the lower side: Mormons from Utah (including expert Cornish miners) came up to work in the canyon for a dollar a day. From Terrace canyon the road crosses into Lane's creek. Lander's road still may be seen over this entire course, because later roads have not run through this part of the country. On April 16, 1969, this stretch was withdrawn as an historic area, and the same boundaries used in the withdrawal are used to designate this site.

It includes a strip of land 100 feet on each side through the following described subdivisions:

T6S, R44E

Sec. 1, lot 7 and HES 765

Sec. 2, lot 7, SE $\frac{1}{4}$ SE $\frac{1}{4}$, and HES 765Sec. 12, W $\frac{1}{2}$ NW $\frac{1}{4}$, N $\frac{1}{2}$ SW $\frac{1}{4}$, SE $\frac{1}{2}$ SW $\frac{1}{4}$ Sec. 13, W $\frac{1}{2}$ NE $\frac{1}{4}$, E $\frac{1}{2}$ NW $\frac{1}{4}$, N $\frac{1}{2}$ SE $\frac{1}{4}$, SE $\frac{1}{2}$ SE $\frac{1}{4}$

T6S, R45E

Sec. 18, lot 4

Sec. 19, lot 1, SW $\frac{1}{4}$ NE $\frac{1}{4}$, E $\frac{1}{2}$ NW $\frac{1}{4}$, NE $\frac{1}{4}$ SW $\frac{1}{4}$, SE $\frac{1}{4}$ Sec. 20, SW $\frac{1}{4}$ SW $\frac{1}{4}$ Sec. 27, S $\frac{1}{2}$ SW $\frac{1}{4}$, SE $\frac{1}{4}$ SE $\frac{1}{4}$ Sec. 28, NW $\frac{1}{4}$ SW $\frac{1}{4}$, S $\frac{1}{2}$ S $\frac{1}{2}$ Sec. 29, NW $\frac{1}{4}$, SW $\frac{1}{4}$ NE $\frac{1}{4}$, N $\frac{1}{2}$ SE $\frac{1}{4}$, SE $\frac{1}{4}$ SE $\frac{1}{4}$ Sec. 30, NE $\frac{1}{4}$ NE $\frac{1}{4}$ Sec. 34, NE $\frac{1}{4}$, NE $\frac{1}{4}$ NW $\frac{1}{4}$ Sec. 35, S $\frac{1}{2}$ NW $\frac{1}{4}$, NE $\frac{1}{4}$ SW $\frac{1}{4}$, SE $\frac{1}{4}$

T7S, R45E

Sec. 1, lots 1, 2, and 5

T7S, R46E

Sec. 6, S $\frac{1}{2}$ S $\frac{1}{2}$ SE $\frac{1}{4}$, S $\frac{1}{2}$ SE $\frac{1}{4}$ SW $\frac{1}{4}$ Sec. 7, NE $\frac{1}{4}$ NE $\frac{1}{4}$ (unsurveyed)

SEE INSTRUCTIONS

6. SIGNIFICANCE

PERIOD (Check One or More as Appropriate)

<input type="checkbox"/> Pre-Columbian	<input type="checkbox"/> 16th Century	<input type="checkbox"/> 18th Century	<input type="checkbox"/> 20th Century
<input type="checkbox"/> 15th Century	<input type="checkbox"/> 17th Century	<input checked="" type="checkbox"/> 19th Century	

SPECIFIC DATE(S) (If Applicable and Known)

AREAS OF SIGNIFICANCE (Check One or More as Appropriate)

<input type="checkbox"/> Aboriginal	<input type="checkbox"/> Education	<input type="checkbox"/> Political	<input type="checkbox"/> Urban Planning
<input type="checkbox"/> Prehistoric	<input type="checkbox"/> Engineering	<input type="checkbox"/> Religion/Philosophy	<input type="checkbox"/> Other (Specify)
<input type="checkbox"/> Historic	<input type="checkbox"/> Industry	<input type="checkbox"/> Science	_____
<input type="checkbox"/> Agriculture	<input type="checkbox"/> Invention	<input type="checkbox"/> Sculpture	_____
<input type="checkbox"/> Architecture	<input type="checkbox"/> Landscape Architecture	<input type="checkbox"/> Social/Humanitarian	_____
<input type="checkbox"/> Art	<input type="checkbox"/> Literature	<input type="checkbox"/> Theater	_____
<input checked="" type="checkbox"/> Commerce	<input type="checkbox"/> Military	<input type="checkbox"/> Transportation	_____
<input type="checkbox"/> Communications	<input type="checkbox"/> Music		
<input type="checkbox"/> Conservation			

STATEMENT OF SIGNIFICANCE

An engineer from the Department of the Interior, Frederick W. Lander, supervised construction of an alternate road for the Oregon Trail west from South Pass to rejoin the regular emigrant road on Ross Fork above Fort Hall. By act of February 17, 1857, Congress funded the project, with construction undertaken from 1858-1859 as part of the Fort Kearney, South Pass, and Honey Lake Wagon Road. After examining sixteen passes, Lander chose a northern route (somewhat longer than a route through Cache valley) to obtain better grazing, water, fish, and game for emigrant travelers. He expected his wagon road route to become the route of the eventual Northern Pacific Railway. With the gold rush to Idaho and Montana not long after construction was completed, Lander's road had special value for traffic headed to the new mines, since it was shorter than any southern alternative would have been. This particular stretch of road got heavy traffic from salt wagons from the Oneida Salt works which operated after 1866 from a mine on Stump creek just below this section of Lander's road.

SEE INSTRUCTIONS



9. MAJOR BIBLIOGRAPHICAL REFERENCES

Harstad, Peter T, "The Lander Trail"
Idaho Yesterday, Fall, 1968, pp. 14-28.

10. GEOGRAPHICAL DATA

LATITUDE AND LONGITUDE COORDINATES DEFINING A RECTANGLE LOCATING THE PROPERTY				O R	LATITUDE AND LONGITUDE COORDINATES DEFINING THE CENTER POINT OF A PROPERTY OF LESS THAN TEN ACRES				
CORNER	LATITUDE				LONGITUDE				
	Degrees	Minutes	Seconds	Degrees	Minutes	Seconds	Degrees	Minutes	Seconds
NW	42°	55'	46"	111°	15'	26"			
NE	42°	55'	46"	111°	06'	47"			
SE	42°	50'	04"	111°	06'	47"			
SW	42°	50'	04"	111°	15'	26"			

APPROXIMATE ACREAGE OF NOMINATED PROPERTY: **245 acres**

LIST ALL STATES AND COUNTIES FOR PROPERTIES OVERLAPPING STATE OR COUNTY BOUNDARIES

STATE:	CODE	COUNTY	CODE

11. FORM PREPARED BY

NAME AND TITLE: **Merle Wells, State Liaison Officer**

ORGANIZATION: **Idaho State Historical Society** DATE: **Feb. 24, 1972**

STREET AND NUMBER: **610 North Julia Davis Drive**

CITY OR TOWN: **Boise** STATE: **Idaho** CODE: **16**

12. STATE LIAISON OFFICER CERTIFICATION

As the designated State Liaison Officer for the National Historic Preservation Act of 1966 (Public Law 89-665), I hereby nominate this property for inclusion in the National Register and certify that it has been evaluated according to the criteria and procedures set forth by the National Park Service. The recommended level of significance of this nomination is:

National State Local

Name Merle Wells

Title State Liaison Officer

Date February 24, 1972

NATIONAL REGISTER VERIFICATION

I hereby certify that this property is included in the National Register.

AR Maxteusen
 Chief, Office of Archeology and Historic Preservation

Date 4/24/75

ATTEST:
W. M. [Signature]
 Keeper of the National Register

Date **APR 23 1975**

NO
 COPY
 (B)

SEE INSTRUCTIONS

FOREST

14

111° 15' 26"

42055146"

T55
T65

Lander Creek

North

124

18

30

20

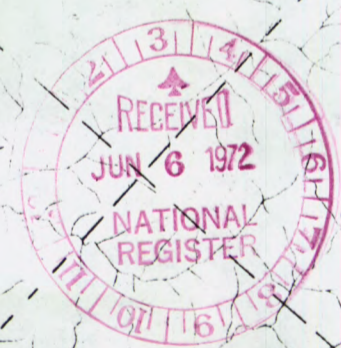

Northwest section

29

28

Terrace Canyon

Creek

FK STUMP

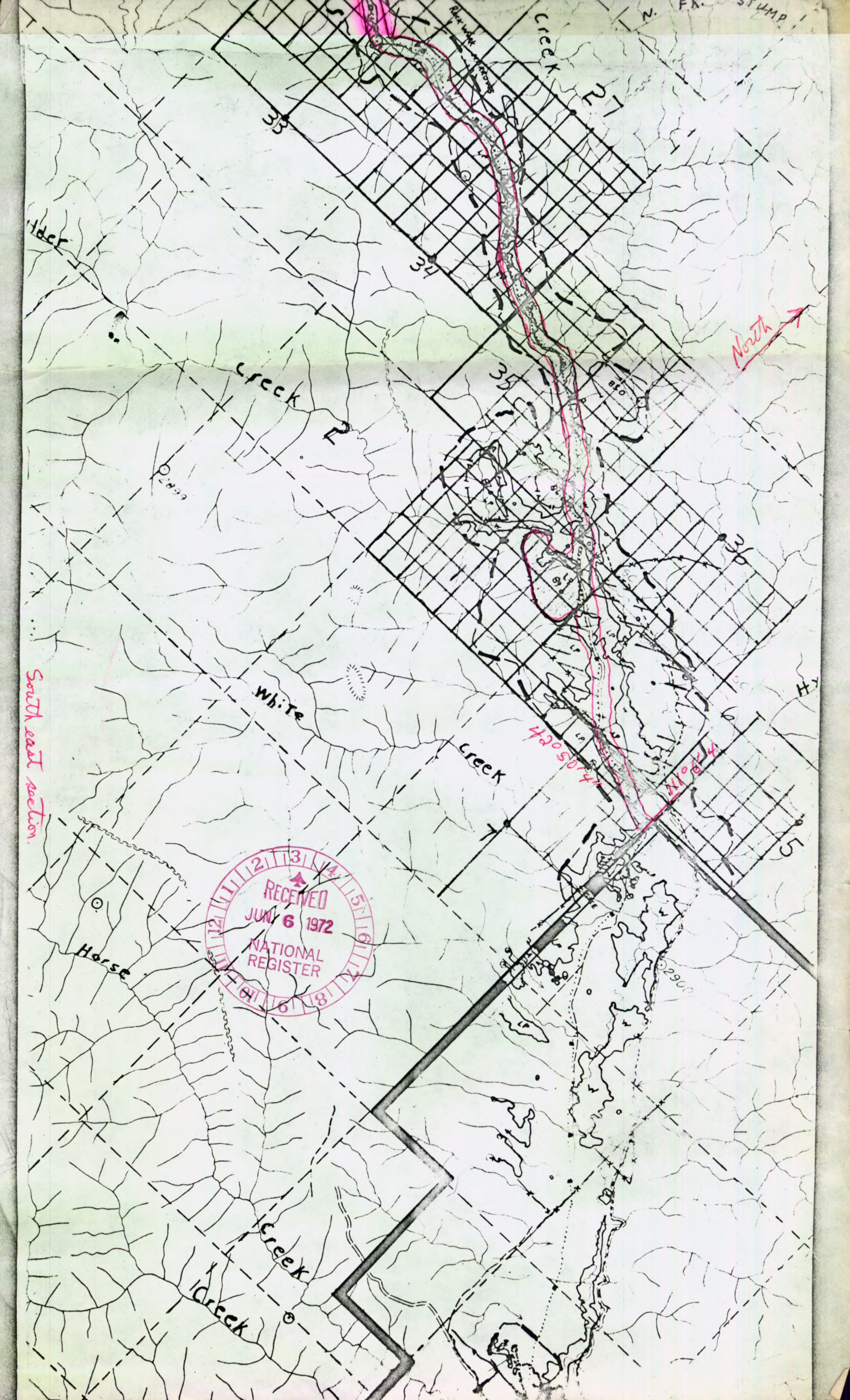

RECEIVED
JUN 6 1972
NATIONAL REGISTER

North

South east section

lder

Creek

White

Creek

Horse

Creek

Creek

4305 ft

4100 ft

2900

STUMP

**NATIONAL REGISTER OF HISTORIC PLACES
PROPERTY MAP FORM**

(Type all entries - attach to or enclose with map)

STATE Idaho	
COUNTY Caribou	
FOR NPS USE ONLY	
ENTRY NUMBER	DATE
	APR 24 1975

SEE INSTRUCTIONS

1. NAME			
COMMON:		Lander Road	
AND/OR HISTORIC:			
2. LOCATION			
STREET AND NUMBER:			
T6 and 7S, R44-46E			
CITY OR TOWN:			
STATE:	Idaho	CODE	COUNTY:
		16	Caribou
			CODE
			029
3. MAP REFERENCE			
SOURCE:			
U.S.G.S.			
SCALE:			
1:62,500			
DATE:			
1948			
4. REQUIREMENTS			
TO BE INCLUDED ON ALL MAPS			
<ol style="list-style-type: none"> Property boundaries where required. North arrow. Latitude and longitude reference. 			

JUL 6 1972