

DATA SHEET #0111988

Form 10-300
(Rev. 6-72)

UNITED STATES DEPARTMENT OF THE INTERIOR
NATIONAL PARK SERVICE

NATIONAL REGISTER OF HISTORIC PLACES INVENTORY - NOMINATION FORM

(Type all entries - complete applicable sections)

STATE: Colorado
COUNTY: Denver
FOR NPS USE ONLY
ENTRY DATE APR 21 1975

1. NAME

COMMON:	Richthofen Castle
AND/OR HISTORIC:	

2. LOCATION

STREET AND NUMBER: 7020 E. 12th Avenue			
CITY OR TOWN: Denver		CONGRESSIONAL DISTRICT	
STATE Colorado	CODE 08	COUNTY: Denver	CODE 031

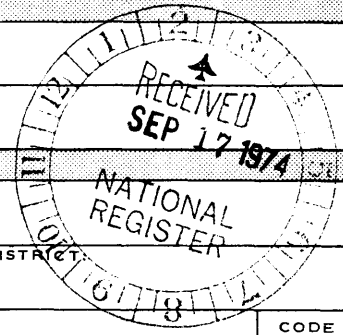

3. CLASSIFICATION

CATEGORY <i>(Check One)</i>	OWNERSHIP	STATUS	ACCESSIBLE TO THE PUBLIC
<input type="checkbox"/> District <input checked="" type="checkbox"/> Building <input type="checkbox"/> Site <input type="checkbox"/> Structure <input type="checkbox"/> Object	<input type="checkbox"/> Public <input checked="" type="checkbox"/> Private <input type="checkbox"/> Both	Public Acquisition: <input type="checkbox"/> In Process <input type="checkbox"/> Being Considered	<input checked="" type="checkbox"/> Occupied <input type="checkbox"/> Unoccupied <input type="checkbox"/> Preservation work in progress
PRESENT USE <i>(Check One or More as Appropriate)</i>			
<input type="checkbox"/> Agricultural <input type="checkbox"/> Commercial <input type="checkbox"/> Educational <input type="checkbox"/> Entertainment	<input type="checkbox"/> Government <input type="checkbox"/> Industrial <input type="checkbox"/> Military <input type="checkbox"/> Museum	<input type="checkbox"/> Park <input checked="" type="checkbox"/> Private Residence <input type="checkbox"/> Religious <input type="checkbox"/> Scientific	<input type="checkbox"/> Transportation <input type="checkbox"/> Other <i>(Specify)</i> _____ _____ _____
Yes: <input checked="" type="checkbox"/> Restricted <input type="checkbox"/> Unrestricted <input type="checkbox"/> No			

4. OWNER OF PROPERTY

OWNER'S NAME: Seiden, Othniel Joseph and Martha Sue			
STREET AND NUMBER: 3300 E. 17th			
CITY OR TOWN: Denver		STATE: Colorado	CODE 08

5. LOCATION OF LEGAL DESCRIPTION

COURTHOUSE, REGISTRY OF DEEDS, ETC.: Denver Assessment Division			
STREET AND NUMBER: 1445 Cleveland Place			
CITY OR TOWN: Denver		STATE Colorado	CODE 08

6. REPRESENTATION IN EXISTING SURVEYS

TITLE OF SURVEY: Historic American Buildings Survey			
DATE OF SURVEY: January, 1968 <input type="checkbox"/> Federal <input checked="" type="checkbox"/> State <input type="checkbox"/> County <input type="checkbox"/> Local			
DEPOSITORY FOR SURVEY RECORDS: State Historical Society, State Historical Museum Bldg.			
STREET AND NUMBER: 200 East Fourteenth Avenue			
CITY OR TOWN: Denver		STATE: Colorado	CODE 08

SEE INSTRUCTIONS

STATE: Colorado
COUNTY: Denver
ENTRY NUMBER APR 21 1975
FOR NPS USE ONLY DATE

7. DESCRIPTION

CONDITION	(Check One)					
	<input checked="" type="checkbox"/> Excellent	<input type="checkbox"/> Good	<input type="checkbox"/> Fair	<input type="checkbox"/> Deteriorated	<input type="checkbox"/> Ruins	<input type="checkbox"/> Unexposed
	(Check One)			(Check One)		
	<input checked="" type="checkbox"/> Altered	<input type="checkbox"/> Unaltered		<input type="checkbox"/> Moved	<input checked="" type="checkbox"/> Original Site	

DESCRIBE THE PRESENT AND ORIGINAL (if known) PHYSICAL APPEARANCE

Irregular in plan, the Castle is a single unit, two-storey building with a wine cellar and small tower rooms. On the front facade, eleven bays are apparent. The Exterior wall material, both visible and supporting, is stone with irregular coursing of rock-faced, squared stone. Some framing for support, with half-timbering in upper remodeled Tudor storey. The front and side facades are buttressed with attached, simple buttresses, about every twenty feet. Now of clay tile, the roof shape is modified Tudor with eaves barely overhanging; no raking type roof trim. There are two chimneys, one slightly off-center front, the other rear, both single stack units are irregular in plan. No projecting windows, no dormers. Surrounds of all the windows are of utmost simplicity, painted in dark brown and white. The main window is of the swing type, with second floor windows of different size and style than the first floor. The rear and side windows are smaller, but of the same type. The main door is set in over six inches with stone face setting. Door surround of head and sides is also of utmost simplicity, painted sills and headers; no transom panels. The front stair is a straight approach, with four stairs. Apparent alterations: \$2 million spent by E. B. Hendrie to convert the second storey of the front facade from a crenelated parapet fortress to modified Tudor. In 1910, the northwest wing was added with J. J. B. Benedict as architect; in 1924, the southwest wing was added with Maurice Biscoe directing.

Details of note: Limestone, handcarved in various places, is from Castle Rock, Colorado; in alterations, more Castle Rock limestone was used. Limestone coat of arms above the main door and shield details carved and placed on second storey, east facade. Sandstone bust of Frederick Barbarossa, "Red Beard" at northwest corner of the house. The moat has been covered with soil. The interior panelling is of dark oak, as is the floor; also golden oak with marble fireplaces and leaded glass windows in dining room with French doors. Hand tooled leather wall coverings. Interior plaster wall surfaces have been recently repainted. The floors are wood joist; golden oak with mahogany edging; wooden pegs throughout.

The castle is set in the northeasterly section of the remaining property. Outside of the castle and milkhouse the property is solely devoted landscaping and park-like grounds. The enclosed diagram will clarify.

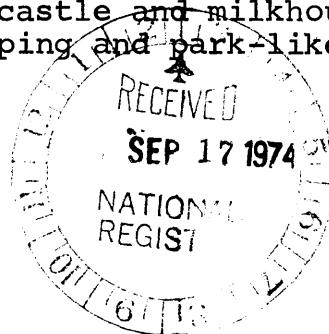

SEE INSTRUCTIONS

3. SIGNIFICANCE

PERIOD (Check One or More as Appropriate)

- | | | | |
|--|---------------------------------------|--|---------------------------------------|
| <input type="checkbox"/> Pre-Columbian | <input type="checkbox"/> 16th Century | <input type="checkbox"/> 18th Century | <input type="checkbox"/> 20th Century |
| <input type="checkbox"/> 15th Century | <input type="checkbox"/> 17th Century | <input checked="" type="checkbox"/> 19th Century | |

SPECIFIC DATE(S) (If Applicable and Known) 1886-7

AREAS OF SIGNIFICANCE (Check One or More as Appropriate)

- | | | | |
|--|---|---|--|
| <input type="checkbox"/> Aboriginal | <input type="checkbox"/> Education | <input type="checkbox"/> Political | <input type="checkbox"/> Urban Planning |
| <input type="checkbox"/> Prehistoric | <input type="checkbox"/> Engineering | <input type="checkbox"/> Religion/Philosophy | <input type="checkbox"/> Other (Specify) _____ |
| <input type="checkbox"/> Historic | <input type="checkbox"/> Industry | <input type="checkbox"/> Science | _____ |
| <input type="checkbox"/> Agriculture | <input type="checkbox"/> Invention | <input type="checkbox"/> Sculpture | _____ |
| <input checked="" type="checkbox"/> Architecture | <input type="checkbox"/> Landscape Architecture | <input checked="" type="checkbox"/> Social/Humanitarian | _____ |
| <input type="checkbox"/> Art | <input type="checkbox"/> Literature | <input type="checkbox"/> Theater | _____ |
| <input type="checkbox"/> Commerce | <input type="checkbox"/> Military | <input type="checkbox"/> Transportation | _____ |
| <input type="checkbox"/> Communications | <input type="checkbox"/> Music | | |
| <input type="checkbox"/> Conservation | | | |

STATEMENT OF SIGNIFICANCE

Built in 1886-1887 on the prairies fifteen miles east of downtown Denver, the castle stands today as a monument to the industry, fearlessness, imagination, and romanticism of its builder, Baron Walter von Richthofen, scion of the well-established von Richthofen family of Prussia. The family was known originally as gentlemen farmers, raising merino sheep, and dairy herds, and as huntsmen and horseback riders.

Baron von Richthofen was born in Silesia, East Germany, in 1848. He was the uncle of German flying ace Manfred von Richthofen, and one of the most colorful characters to hit the Wild West. Having fought in the Franco-Prussian and Austro-German wars, he came to America to escape the regimented life to which his notable military record had condemned him.

Backed by German and English capital, Richthofen purchased 320 acres which he named "Montclair" which he planned to develop into a health and recreational resort. A milkhouse, or "molkery", was connected by a 300 foot underground passage to the castle. The rich milk from the herd of Jersey cows which Richthofen imported from Switzerland was to be used in the treatment of tuberculosis. Plans for a 300 bed hospital and sanitarium were also drawn up.

The Baron also built an art gallery at 8th and Monaco where he exhibited a collection worth \$500,000.00. But when Denverites protested to the "lewd, brazen" pictures, Richthofen amiably turned the gallery into a casino, and

SEE INSTRUCTIONS

9. MAJOR BIBLIOGRAPHICAL REFERENCES

Arps, Louisa, Denver in Slices
 Burrows, William E., Richthofen
 Kohl, Edith Eudora, Denver's Historic Mansions, Sage Books,
 Denver, Colorado, 1957.

10. GEOGRAPHICAL DATA

LATITUDE AND LONGITUDE COORDINATES DEFINING A RECTANGLE LOCATING THE PROPERTY			O R	LATITUDE AND LONGITUDE COORDINATES DEFINING THE CENTER POINT OF A PROPERTY OF LESS THAN TEN ACRES		
CORNER	LATITUDE	LONGITUDE		LATITUDE	LONGITUDE	
	Degrees Minutes Seconds	Degrees Minutes Seconds		Degrees Minutes Seconds	Degrees Minutes Seconds	
NW	° ' "	° ' "		30 44 07	104 54 22	
NE	° ' "	° ' "				
SE	° ' "	° ' "				
SW	° ' "	° ' "				

13/508050
 4398170
 CD

APPROXIMATE ACREAGE OF NOMINATED PROPERTY: **1.07**

LIST ALL STATES AND COUNTIES FOR PROPERTIES OVERLAPPING STATE OR COUNTY BOUNDARIES

STATE:	CODE	COUNTY	CODE

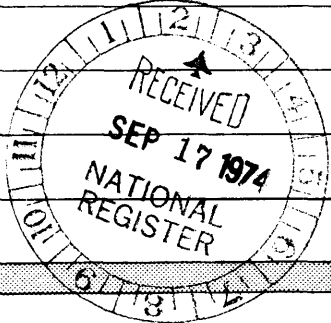

SEE INSTRUCTIONS

11. FORM PREPARED BY

NAME AND TITLE: **Mrs. Mayme A. Sweet**

ORGANIZATION: **Historic Denver, Inc.** DATE: **8/9/74**

STREET AND NUMBER: **1180 Niagara Street**

CITY OR TOWN: **Denver** STATE: **Colorado** CODE: **08**

12. STATE LIAISON OFFICER CERTIFICATION

As the designated State Liaison Officer for the National Historic Preservation Act of 1966 (Public Law 89-665), I hereby nominate this property for inclusion in the National Register and certify that it has been evaluated according to the criteria and procedures set forth by the National Park Service. The recommended level of significance of this nomination is:

National State Local

Name: *Stephen H. Wenz*

Title: *Colorado Historic Preservation Officer*

Date: *7/13/74*

NATIONAL REGISTER VERIFICATION

I hereby certify that this property is included in the National Register.

A. R. Mortensen
 Director, Office of Archeology and Historic Preservation

Date: *4/21/75*

ATTEST:
Charles A. ...
 Keeper of The National Register

Date: *4.18.75*

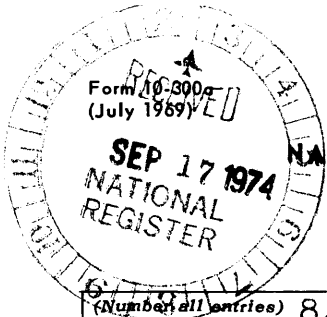

Form 10-800a
(July 1969)

UNITED STATES DEPARTMENT OF THE INTERIOR
NATIONAL PARK SERVICE

NATIONAL REGISTER OF HISTORIC PLACES
INVENTORY - NOMINATION FORM

(Continuation Sheet)

STATE Colorado	
COUNTY Denver	
FOR NPS USE ONLY	
ENTRY NUMBER	DATE
	APR 21 1975

(Number all entries) 8. Significance

part of his land into a new residential development.

Eventually, he met and married English-born Louise Ferguson. They were a devoted couple, and the baroness took her place as mistress of the castle where they entertained royally. At first, the baroness had been reluctant to live at Richthofen because it was too stark and cheerless, so the baron set out roses and red geraniums, imported several hundred canaries, turned them loose on the grounds, and moved his bride in.

When the crash came in 1893, von Richthofen tried desperately to save his multi-million-dollar development. Failing, he took jobs of one kind and another, and finally, he travelled over Colorado with a wagon and team selling books. Broken in health and spirit, Walter von Richthofen died in 1898 at the age of 50. His dream of the great health resort materialized when the world-famed Phipps sanitarium for tuberculosis was built from the Richthofen plans and in that section of the city.

The Montclair addition was saved for the baroness by a German syndicate. The Richthofen place was sold several times for a club. Then in 1910 the home was purchased by Edwin B. Hendrie, president of Hendrie and Bolthoff, Company, one of the world's greatest mining machinery distributing and supply companies. Hendrie's daughter Gertrude and her husband W. W. Grant, Jr., and their family then occupied the castle, comprising the third family of important Denver pioneers to find their home within its fortress-like walls. The fourth famous Denver frontier family to live in Richthofen was that of John Thams, owner of the Elephant Corral, the famous livery stable of Denver's gold rush days.

The City of Denver has recognized the importance of this building to its history, and designated the castle as a Denver Landmark on June 11, 1973. The molkery has been purchased by the city, and now houses the Montclair Community Association. Montclair, now a middle class residential area noted for its green lawns and old trees is permeated with the name, deeds,

NATIONAL REGISTER OF HISTORIC PLACES
INVENTORY - NOMINATION FORM

(Continuation Sheet)

STATE	Colorado	
COUNTY	Denver	
FOR NPS USE ONLY		
ENTRY NUMBER	DATE	
	APR 21 1975	

(Number all entries) 8. Significance (Continuation Sheet #2)

and legends of Baron von Richthofen.

In addition to the castle and milkhouse is the fountain or trough at the intersection of Richthofen Parkway, Oneida Street and Oneida Place. Constructed by the city of Denver from funds left in trust by the baron, who had originally intended it as a memorial to his son, the semi-circular structure is of pink granite with tall wrought iron lamp posts at either end, a large iron flower urn at the top center has two spouts at each side of the center from which water flows to the trough below. Cut in stone above the trough is a fitting tribute to this man who dreamed of doing so much for his fellow man: "He prayeth well who loveth man, birds and beasts."

Although the panic of 1893 prevented completion of the development, a decade of planning and labor was put into it, and the massive castle with its surrounding estate is a notable monument to the faith of the pioneers.

The Richthofen Castle is perhaps one of the most remarkable residential structures in Denver. It retains all of its original beauty of fine craftsmanship and stands in excellent condition amidst well-preserved surroundings. The quality to which it has been preserved and the lack of entruding influences sets it apart from other structures of its age and size. It is perhaps the only "castle" like structure in Denver of any size and is certainly the most well-preserved. The surrounding neighborhood has and does take quite a bit of pride and direction from the castle

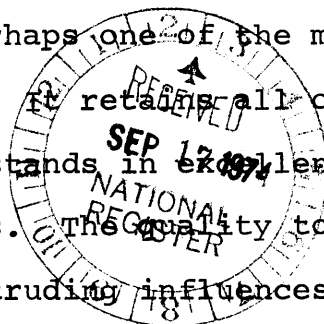

NATIONAL REGISTER OF HISTORIC PLACES
INVENTORY - NOMINATION FORM

(Continuation Sheet)

STATE Colorado	
COUNTY Denver	
FOR NPS USE ONLY	
ENTRY NUMBER	DATE
	APR 21 1975

(Number all entries)

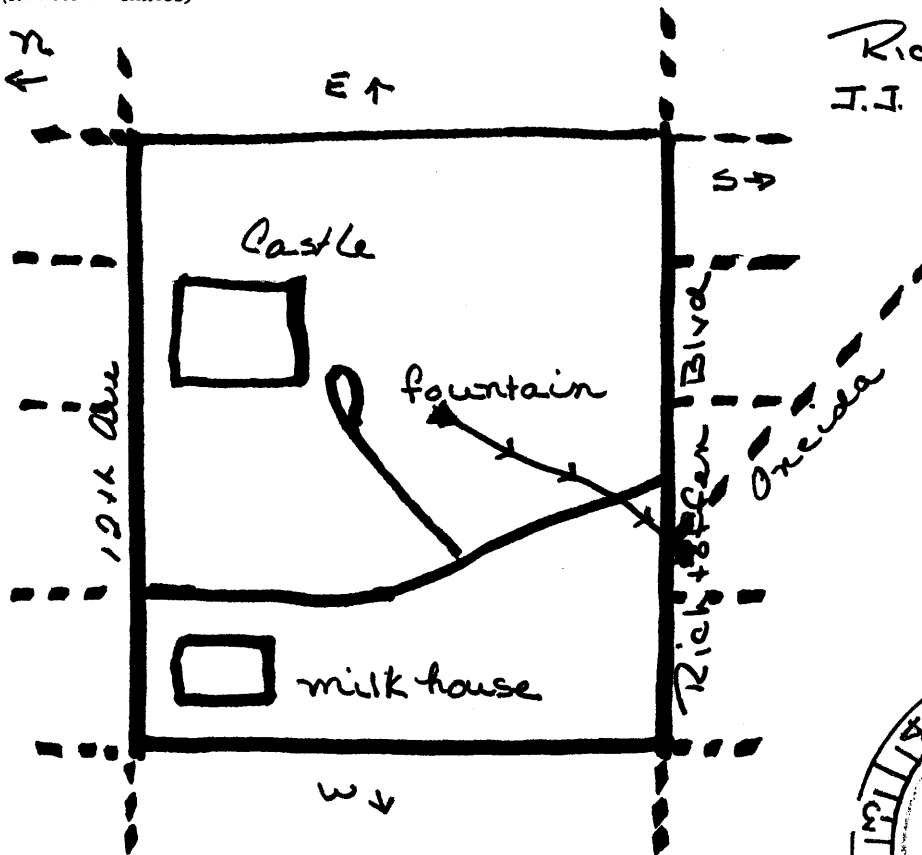

Richtoffen Park
J.I. Joslin subdivided

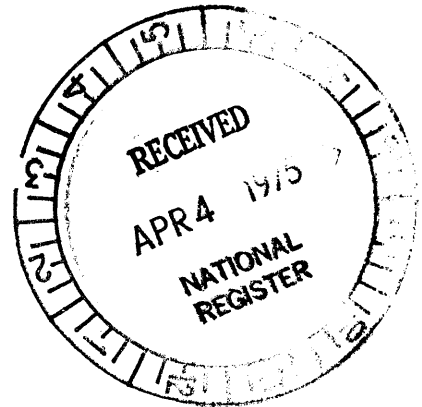

Castle to milkhouse 200-250 ft. no
Passageway. Castle now surrounded
by early Denver homes - most Clair Park
subdivided by Richtoffen himself.