

ARCHITECTURAL/HISTORICAL SURVEY

DAVENPORT, IOWA

The Architects Office

Wehner, Nowysz, Pottschiull and Pfiffner
801 clay building, iowa city, iowa 52240

DAVENPORT COMMUNITY DEVELOPMENT DEPARTMENT
IOWA DIVISION OF HISTORIC PRESERVATION

SITE # 82-10- 2-W1107 MAP # 1

HIST. DIST. _____

NAME Ferdinand Ewert Building (H) C

ADDRESS 1107 W. ^{2nd} ~~Second~~ St.

LEGAL DES. Tichenor's 2nd Add. 1 2 8' of Lot 3
SUB-DIVISION BLOCK PARCEL SUB-PARCEL Lot 2 & E.

UTM | 15 | 7011170145199200 | ACREAGE -1 ZONE C-4
EASTING NORTHING

OWNER Natalie A. Erritt
338 4th St., Bettendorf, IA 52722

TITLE H. _____
(IF DIFF) _____

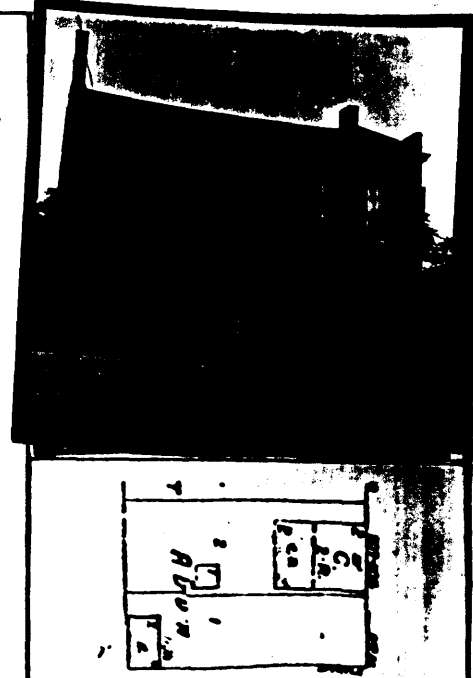

DESCRIPTION

FORM 2 story, side-gable, square main block w/rear wing & 5-bay symmetrical front const. c. 1852
MATERIALS Brick, stone ARCH STYLE vernacular
FENESTRATION 2/2 D.H.S.; Openings have segmental arches
DIST. FEATURES Shoulder parapets at gable ends; Greek Revival Entrance
ALTERATIONS Wood frieze removed ? window sash replaced; base of exterior walls faced
SITE & RELATED STR. Flat open site, no set-back. with concrete

STATEMENT

This vernacular town house form has few remaining examples in Davenport. Its simple form, frontal symmetry and parapet gable ends evoke the better known, but long gone LeClaire Row of 1853. Derived from Federal and Greek Revival forms, the house represents one of the architectural trends found in Davenport toward the end of its settlement period.

SOURCES

SITE SHEET

ARCHITECTURE

SIGNIFICANCE

HISTORY

DESCRIPTION

This house was probably built shortly after this area was platted in 1852. Gottlieb Wedige, a mechanical inventory, may have built this house. It was bought by Ferdinand Ewert, a teamster who lived across the street, in 1871.

SOURCES

City Directories, 1867, 1868-69, 1870-71, 1876, 1880.

Scott County Auditor's Deed Transfer Books, Vol. 4:246.

ARCHITECTURAL HISTORIAN: Martha Bowers | HISTORIAN: MARLYS SVENDSEN - ROESLER | SURVEY COMP 1981

EVALUATION

ARCHITECTURAL

- I. ARCH. EVALUATION Good
- II. ENVIR. STATURE Incident
- III. INT. OF CONTEXT Poor
- IV. INT. OF FABRIC Fair

LEVEL OF SIGNIFICANCE:

- NAT. STATE LOCAL N. ELIG.

HISTORICAL

I. THEME(S) OF SIGNIFICANCE:

- A. PRIMARY _____
- B. SECONDARY _____

II. LEVEL OF SIGNIFICANCE:

- NAT. STATE LOCAL

III. N.R.H.P.

- ELIGIBLE NOT ELIGIBLE

HISTORIC DISTRICT CLASSIFICATION

- A. B. C.

FOR DIVISION OF HISTORIC PRESERVATION USE ONLY

1. DATE RECEIVED _____

2. DATE OF STAFF EVALUATION _____

- | | | |
|---------------------------|--------------------------|--------------------------|
| | A. ARCHITECTURAL | B. HISTORICAL |
| ELIGIBLE FOR N.R.H.P. | <input type="checkbox"/> | <input type="checkbox"/> |
| NOT ELIGIBLE FOR N.R.H.P. | <input type="checkbox"/> | <input type="checkbox"/> |

3. N.R.H.P. ACTION

- A. STATE REVIEW COMM. APP. DISAPP. Tabled DATE _____
- B. FEDERAL REVIEW APP. DISAPP. Tabled DATE _____

4. D.H.P. SOURCES

- COUNTY RESOURCES
- W'SHIELD SURVEY
- N.R.H.P.
- GRANT _____
- DET. OF ELIGIBILITY
- R. & C. _____
- DAVENPORT A/H SURVEY
- _____
- _____

5. SUBJECT TRACES

6. PHOTO, 1695-3

