

88001791

Historic Resources of Hardin County

AUG 26 1988

Historic Name: Rawlings, Stephen, House (HDE-5) Classification: Building
Common Name: Rawlings, Stephen, House

Owner: Rena Parks, 811 N. Main St. Elizabethtown, KY 42701

Location: 811 N. Main Street, Elizabethtown, KY

<u>Contributing:</u>		<u>Non-Contributing:</u>	
Buildings	1	Buildings	0
Structures	0	Structures	0
Sites	0	Sites	0
<u>Total:</u>	1	<u>Total:</u>	0

Description:

The Stephen Rawlings House is a two-story brick residence built ca. 1810. The house was originally a two bay, single pile, hall and parlor design of common bond construction. A two-story addition was added on the north facade creating a T-plan ca. 1891 and a one-story brick addition was added at the rear. On the main (west) facade is a one story porch with ca. 1970 wrought iron posts. The main entrance has a ca. 1891 glass and frame door with a single light transom. Windows in the original section are rectangular ca. 1900 four-over-four sash. Windows in the additions are arched four-over-four sash. The house has a gable roof of composition shingles. The interior was inaccessible. There are no outbuildings.

Period of Significance: ca. 1810

Area of Significance: Exploration/Settlement

Criterion: B

Architect/Builder: Unknown

Statement of Significance:

The Stephen Rawlings House is notable for its association with Stephen Rawlings, an early settler of Elizabethtown. The building was constructed ca. 1810 for Stephen Rawlings, one of the first settlers in the Elizabethtown area. It was one of the first brick homes built in Elizabethtown and is one of the earliest which still exists. Rawlings was one of the gentlemen justices when the town was established in 1797 and he was one of the first trustees. The first Methodist religious services in Elizabethtown were held in the house. Since its construction the house has been altered into a T-plan appearance later alterations render the house ineligible under criterion C.

Acreage: Less than one acre.

UTM References: Elizabethtown Quad 16/601720/4173130

Verbal Boundary Description and Justification:

The boundary for the Stephen Rawlings House is illustrated on the accompanying Hardin County property tax map 220-4, block 5, lot 40, and is defined by the legal property boundary. The boundary includes the house and property sufficient to protect the historical setting of the site.

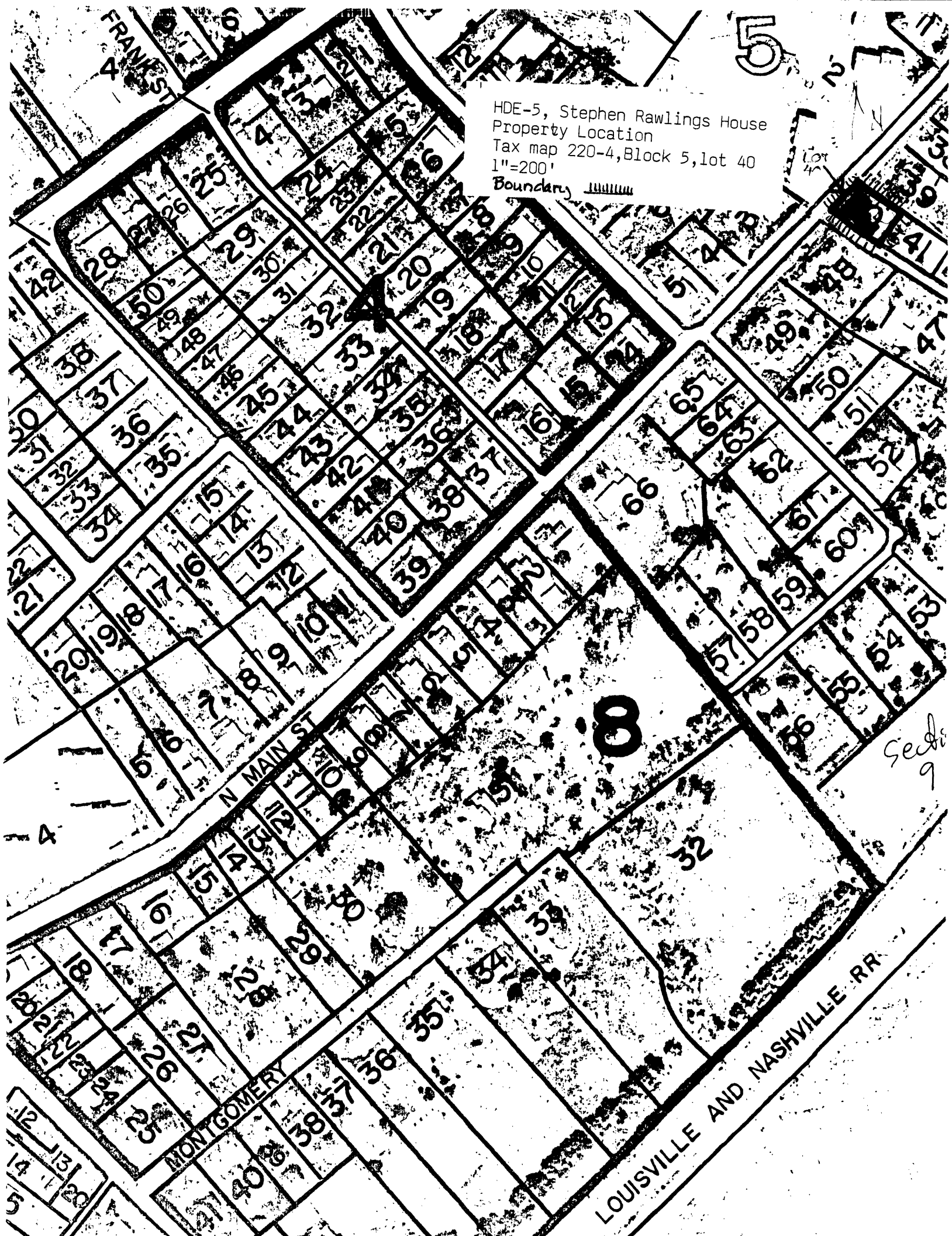

HDE-5, Stephen Rawlings House
Property Location
Tax map 220-4, Block 5, lot 40
1"=200'

Boundary

5

8

Sec 9

FRANK ST

N MAIN ST

MONTGOMERY ST

LOUISVILLE AND NASHVILLE RR