

Marr and Holman Buildings in Downtown Nashville (1922-1936) Thematic Resources

IDENTIFICATION	<p>Historic name: <u>(James Robertson Hotel)</u></p> <p>Common name: <u>James Robertson Apartments</u></p> <p>Address: <u>118 Seventh Avenue, North</u>  <u>Nashville, Tennessee</u></p> <p>Owner's name: <u>James Robertson Apartments Inc.</u></p> <p>Owner's address: <u>West Harpeth Road</u>  <u>Franklin, Tennessee 37064</u></p> <p>Classification: <u>Building</u></p> <p>Tax map reference: <u>93-6-3-25 Davidson County</u></p> <p>Acreage: <u>.45 acre</u></p> <p>UTM reference: <u>16/519645/4001540</u></p>	STATUS	<p>Open to public: <u>Yes <input checked="" type="checkbox"/> No <input type="checkbox"/> Restricted <input checked="" type="checkbox"/></u></p> <p>Visible from road: <u>Yes <input checked="" type="checkbox"/> No <input type="checkbox"/></u></p> <p>Occupied: <u>Yes <input checked="" type="checkbox"/> No <input type="checkbox"/></u></p> <p>Present use: <u>Apartments</u></p> <p>Current condition: <u>Good</u></p> <p>Alterations: <u>Interior remodeling took place in 1978 when the hotel was converted to elderly apartments.</u></p> <p>Site features: <u>The building sits on a city lot and faces Seventh Avenue, North. It is bounded by alleys and a vacant lot on the other three sides.</u></p>
HISTORY	<p>Date of construction: <u>1929</u></p> <p>Architect/builder: <u>Marr and Holman</u>  <u>Nashville, TN</u></p> <p>Original or previous owners: <u>Robert Eliot</u>  <u>Pritchett and Thomas Company</u></p> <p>Original use: <u>Hotel</u></p> <p>Theme/s: <u>Primary Architecture</u>  <u>Secondary Local History</u>  <u>Other N/A</u></p>	SOURCES	<p>Bibliographical data: <u>See nomination form.</u></p> <p>Form prepared by: <u>Philip Thomason</u></p> <p>Title: <u>Architectural Historian</u></p> <p>Organization: <u>Thomason and Associates</u>  <u>Nashville, TN</u> Date: <u>4/84</u></p>
DESCRIPTION	<p>The James Robertson Hotel is a twelve story steel and concrete structure with a masonry curtain wall. The building was completed in 1929 and features Art Deco detailing. The first two floors of the Seventh Avenue facade are sheathed in limestone. On the ground story are limestone piers separated by large plate glass windows and the main entrance. On the second floor the limestone piers terminate in a stepped design with inset floral and geometric decoration. The second story also displays octagonal casement windows and spandrels of floriated Art Deco design. On the third floor windows is elaborate stone hood molding with scrollwork and antefix. Between the second and top floors brick piers project beyond the window bays to accent the verticality of the building. All windows are one-over-one sash with concrete sills and heads of brick soldier coursing. At the roofline of the building the brick piers</p>		
SIGNIFICANCE	<p>The James Robertson Hotel was constructed in 1929 by the Pritchett-Thomas Company of Nashville. The building was one of many high rise structures completed in downtown Nashville during this decade. It was completed at a cost of over one million dollars with exterior limestone detailing and interior terrazzo marble floors. Marr and Holman designed the building to be reflective of the Art Deco style and it is one of the few high rise structures in the downtown area to display Art Deco detailing. The first</p> <p style="text-align: right;">(continued)</p>		

**PHOTOGRAPHIC DATA**

Photographer: Thomason and Assoc.

Date: April, 1984

Negatives on file: Thomason and Assoc.  
Nashville, TN

Photographer facing: NE - SE

Photograph number 8-9 of 21.

**CONTINUATION**

**SITE PLAN - Include North Arrow**

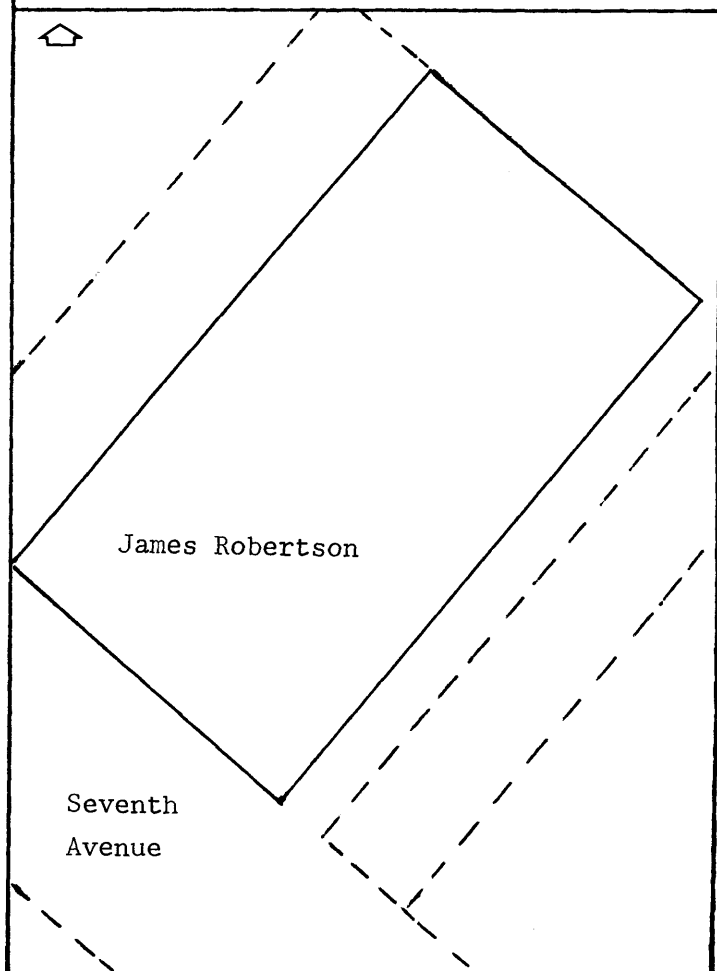

## Marr and Holman Buildings in Downtown Nashville (1922-1936) Thematic Resources

### James Robertson Hotel

#### Description continued:

project beyond the window bays to accent the verticality of the building. All windows are one-over-one sash with concrete sills and brick soldier coursing on the window heads. At the roofline of the building the brick piers are heightened with limestone stepped capping with zigzag and geometric banding. The roofline also features corbelled brickwork below the top floor. On the interior the lobby and ballroom have been retained and feature various Art Deco and Neo-Classic detailing. In past years the hotel rooms have been remodeled into modern elderly housing.

#### Significance continued:

and second floors are sheathed with limestone and feature panels of extensive foliated and geometric designs. The building is also very sleek and vertical in appearance with projecting masonry and limestone piers on the upper facade. Few alterations have occurred to the structure and its original detailing remains intact. The hotel operated under several owners until 1978 when it was purchased and rehabilitated into elderly apartments. The James Robertson continues today as a residential building with 123 apartments for senior citizens.

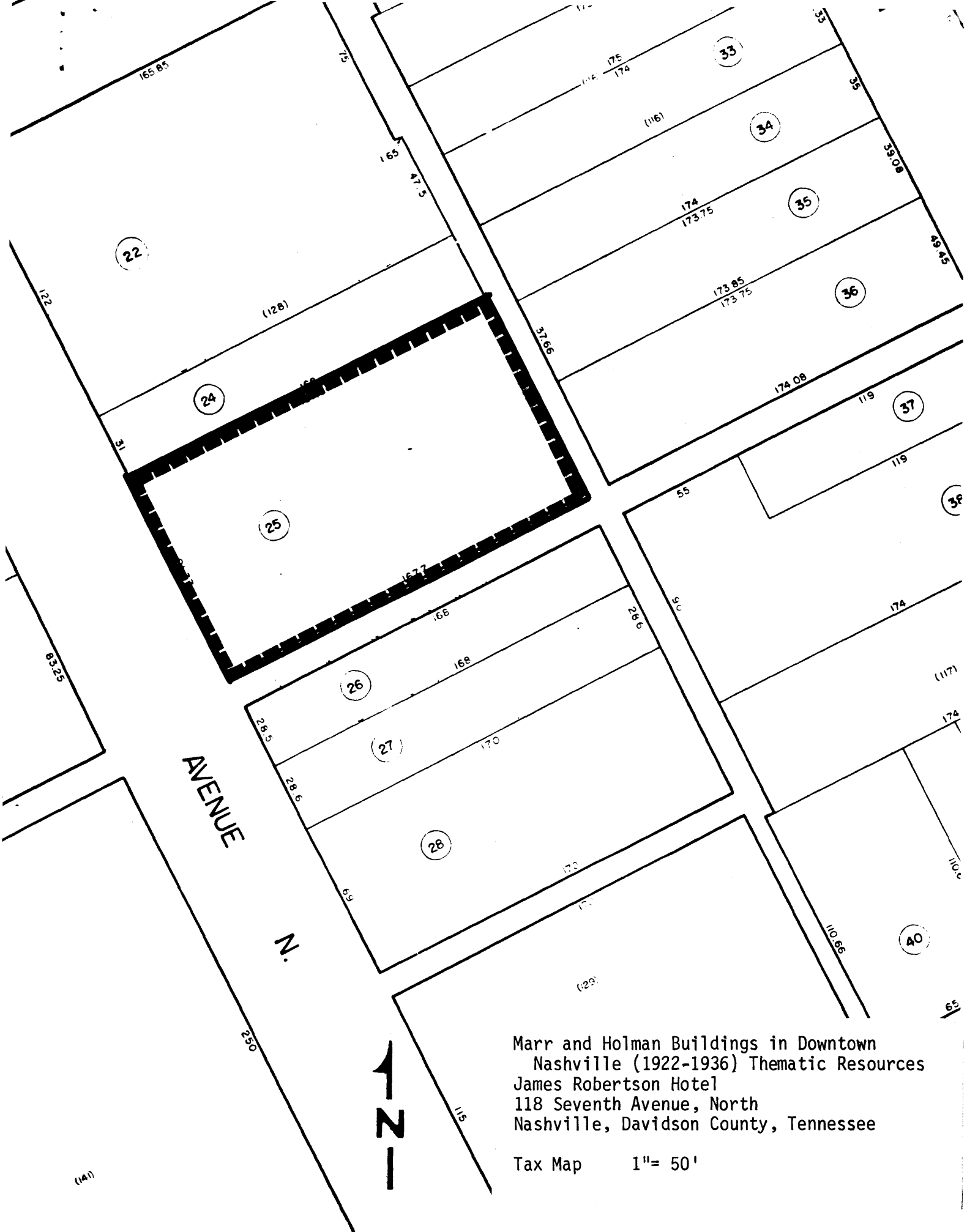

Marr and Holman Buildings in Downtown  
 Nashville (1922-1936) Thematic Resources  
 James Robertson Hotel  
 118 Seventh Avenue, North  
 Nashville, Davidson County, Tennessee

Tax Map 1" = 50'