

# DATA SHEET

Form 10-306  
(Oct. 1972)

UNITED STATES DEPARTMENT OF THE INTERIOR  
NATIONAL PARK SERVICE

## NATIONAL REGISTER OF HISTORIC PLACES INVENTORY - NOMINATION FORM FOR FEDERAL PROPERTIES

(Type all entries - complete applicable sections)

STATE: South Dakota
COUNTY: Gregory
FOR NPS USE ONLY
ENTRY DATE APR 22 1976

### 1. NAME

COMMON: <b>* * Fort Randall</b>
AND/OR HISTORIC: Fort Randall

### 2. LOCATION

STREET AND NUMBER:			
CITY OR TOWN: 3 miles southwest of Pickstown		CONGRESSIONAL DISTRICT: Second	
STATE: South Dakota	CODE:	COUNTY: Gregory	CODE: 053

### 3. CLASSIFICATION

CATEGORY (Check One)	OWNERSHIP	STATUS	ACCESSIBLE TO THE PUBLIC
<input checked="" type="checkbox"/> District <input type="checkbox"/> Building <input type="checkbox"/> Site <input type="checkbox"/> Structure <input type="checkbox"/> Object	<input checked="" type="checkbox"/> Public <input type="checkbox"/> Private <input type="checkbox"/> Both	Public Acquisition: <input type="checkbox"/> In Process <input type="checkbox"/> Being Considered	<input type="checkbox"/> Occupied <input checked="" type="checkbox"/> Unoccupied <input type="checkbox"/> Preservation work in progress
PRESENT USE (Check One or More as Appropriate)			
<input type="checkbox"/> Agricultural <input type="checkbox"/> Commercial <input type="checkbox"/> Educational <input type="checkbox"/> Entertainment	<input type="checkbox"/> Government <input type="checkbox"/> Industrial <input type="checkbox"/> Military <input type="checkbox"/> Museum	<input checked="" type="checkbox"/> Park <input type="checkbox"/> Private Residence <input type="checkbox"/> Religious <input type="checkbox"/> Scientific	<input type="checkbox"/> Comments <input type="checkbox"/> No

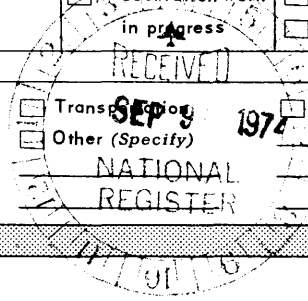

### 4. AGENCY

U. S. Army Corps of Engineers	
REGIONAL HEADQUARTERS: (If applicable) Omaha District	STREET AND NUMBER: Federal Post Office & Court House
CITY OR TOWN: Omaha	STATE: Nebraska
	CODE:

### 5. LOCATION OF LEGAL DESCRIPTION

COURTHOUSE, REGISTRY OF DEEDS, ETC. Gregory County Courthouse	
STREET AND NUMBER:	
CITY OR TOWN: Gregory	STATE: South Dakota
	CODE:

### 6. REPRESENTATION IN EXISTING SURVEYS

TITLE OF SURVEY: South Dakota Historic Sites Inventory (not published)	
DATE OF SURVEY: 1973	<input type="checkbox"/> Federal <input checked="" type="checkbox"/> State <input type="checkbox"/> County <input type="checkbox"/> Local
DEPOSITORY FOR SURVEY RECORDS: University of South Dakota	
STREET AND NUMBER:	
CITY OR TOWN: Vermillion	STATE: South Dakota
	CODE:

SEE INSTRUCTIONS

STATE:

COUNTY:

APR 22 1976  
ENTRY NUMBER

DATE

FOR NPS USE ONLY

4-10-1

7. DESCRIPTION

CONDITION	(Check One)					
	<input type="checkbox"/> Excellent	<input type="checkbox"/> Good	<input type="checkbox"/> Fair	<input type="checkbox"/> Deteriorated	<input checked="" type="checkbox"/> Ruins	<input type="checkbox"/> Unexposed
	(Check One)			(Check One)		
	<input type="checkbox"/> Altered	<input checked="" type="checkbox"/> Unaltered		<input type="checkbox"/> Moved	<input checked="" type="checkbox"/> Original Site	

DESCRIBE THE PRESENT AND ORIGINAL (if known) PHYSICAL APPEARANCE

Fort Randall went through several development phases.

The post was established in 1856 and was built of log structures, reputedly enclosed by a stockade.

In 1871, the log structures were torn down and replaced by frame buildings. In 1880, still more frame buildings were added to the post. The post was abandoned in 1892.

Today, only one of the post's structures has substantial standing remains. This is a chapel and lodge-hall, built by the I.O.O.F. members in 1875. Foundation ruins and cellars outline the post-1871 parade ground.

The stone-masonry shell of the 1875 chapel is the most picturesque feature of the post today. This structure has been stabilized and protectively fenced.

There are a number of interpretive markers on the site. These were placed there in recent years by the South Dakota Historical Society.

At the west end of the tract, on a terrace at the foot of "target hill", lies the old post cemetery. Most military burials were removed to Fort Leavenworth, Kansas after the post was abandoned. Several military burials remain along with a number of graves of civilian employees, Indian Scouts and military dependents.

The post lies adjacent U.S. Highway 18. The chapel and foundations are visible from that highway, and the Corps of Engineers road network gives ready access to the site. The Historical Society markers already there form a base for very effective interpretive development for a large visitation.

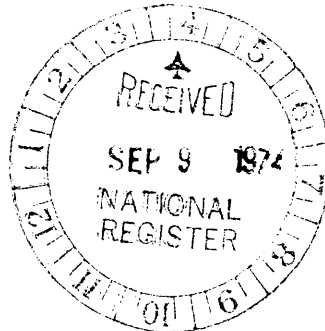

SECTIONS

**B. SIGNIFICANCE**

PERIOD (Check One or More as Appropriate)

- |  |                                       |  |                                       |
|--|---------------------------------------|--|---------------------------------------|
| <input type="checkbox"/> Pre-Columbian | <input type="checkbox"/> 16th Century | <input type="checkbox"/> 18th Century            | <input type="checkbox"/> 20th Century |
| <input type="checkbox"/> 15th Century  | <input type="checkbox"/> 17th Century | <input checked="" type="checkbox"/> 19th Century |                                       |

SPECIFIC DATE(S) (If Applicable and Known) **26 June 1856 to December 6, 1892**

AREAS OF SIGNIFICANCE (Check One or More as Appropriate)

- |  |   |   |  |
|--|---|---|--|
| <input type="checkbox"/> Aboriginal              | <input type="checkbox"/> Education              | <input checked="" type="checkbox"/> Political           | <input type="checkbox"/> Urban Planning        |
| <input type="checkbox"/> Prehistoric             | <input type="checkbox"/> Engineering            | <input checked="" type="checkbox"/> Religion/Philosophy | <input type="checkbox"/> Other (Specify) _____ |
| <input type="checkbox"/> Historic                | <input type="checkbox"/> Industry               | <input type="checkbox"/> Science                        | _____  |
| <input type="checkbox"/> Agriculture             | <input type="checkbox"/> Invention              | <input type="checkbox"/> Sculpture                      | _____  |
| <input checked="" type="checkbox"/> Architecture | <input type="checkbox"/> Landscape Architecture | <input type="checkbox"/> Social/Humanitarian            | _____  |
| <input type="checkbox"/> Art                     | <input type="checkbox"/> Literature             | <input type="checkbox"/> Theater                        | _____  |
| <input checked="" type="checkbox"/> Commerce     | <input checked="" type="checkbox"/> Military    | <input checked="" type="checkbox"/> Transportation      | _____  |
| <input type="checkbox"/> Communications          | <input type="checkbox"/> Music                  |   | _____  |
| <input type="checkbox"/> Conservation            |   |   | _____  |

STATEMENT OF SIGNIFICANCE

Fort Randall was established as the main U.S. outpost on the upper Missouri River in the wake of hostilities with the Sioux (Dakota) Indians in 1854-55. It served longer as a continuously occupied military post than any other post on the upper river.

The post served as a major base for operations against the Sioux in 1863, 1864, and 1865.

It was one of the chain of posts that surrounded the Sioux country from 1865 to 1876. The campaign of 1876 substantially ended the military aspect of the regional "Indian question". But the post continued to provide the security by assuring Federal presence to settlers who flocked into newly opened lands in the region.

After its abandonment, the post furnished a wealth of construction material for farms and ranches that were springing up in the vicinity.

We believe that the site has very strong national significance, as perhaps the post of greatest overall importance on the upper Missouri River for the longest period of time.

SEE INSTRUCTIONS



9. MAJOR BIBLIOGRAPHICAL REFERENCES

Outline Description of the Posts and Stations of Troops in the Military Division of Missouri, Chicago, 1871.

Same as above, new edition with more material, Chicago, 1872.

Linda W. Slaughter, "Fort Randall," Collections of the State Historical Society of North Dakota, Volume 1, Pages 423-429, 1906.

John E. Mills, Historic Sites Archeology in the Fort Randall Reservoir, South Dakota, R. B. Papers #16, BAE Bulletin 176, 1960.

10. GEOGRAPHICAL DATA

LATITUDE AND LONGITUDE COORDINATES DEFINING A RECTANGLE LOCATING THE PROPERTY				OR	LATITUDE AND LONGITUDE COORDINATES DEFINING THE CENTER POINT OF A PROPERTY OF LESS THAN TEN ACRES				
CORNER	LATITUDE		LONGITUDE		LATITUDE		LONGITUDE		
NW	Degrees	Minutes	Seconds	Degrees	Minutes	Seconds	Degrees	Minutes	Seconds
	43	03	38	99	14	26			
NE	43	03	38	99	13	26			
SE	43	02	36	99	13	26			
SW	43	02	36	99	14	26			

APPROXIMATE ACREAGE OF NOMINATED PROPERTY: **C. 200 acres**

LIST ALL STATES AND COUNTIES FOR PROPERTIES OVERLAPPING STATE OR COUNTY BOUNDARIES

STATE:	CODE	COUNTY:	CODE

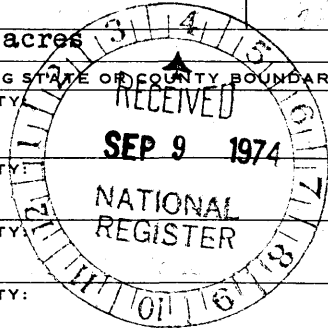

SEE INSTRUCTIONS

11. FORM PREPARED BY

NAME AND TITLE: <b>Robert A. Murray, Planning Consultant</b>		DATE: <b>3 May 1973</b>
BUSINESS ADDRESS: <b>Western Interpretive Services</b>		
STREET AND NUMBER: <b>545 S. Tschirgi</b>		PHONE: <b>674-4504</b>
CITY OR TOWN: <b>Sheridan</b>	STATE <b>Wyoming 82801</b>	CODE

12. CERTIFICATION OF NOMINATION

NATIONAL REGISTER VERIFICATION

State Liaison Officer recommendation:

- Yes
- No
- None

*[Signature]*  
State Liaison Officer Signature

In compliance with Executive Order 11593, I hereby nominate this property to the National Register, certifying that the State Liaison Officer has been allowed 90 days in which to present the nomination to the State Review Board and to evaluate its significance. The recommended level of significance is  National  State  Local

*[Signature]* **3 Sep 74**  
Federal Representative Signature Date  
**Fed Rep. Coye (clw)**  
Title

I hereby certify that this property is included in the National Register.

*[Signature]*  
Director, Office of Archeology and Historic Preservation

Date **4/22/96**

ATTEST:

*[Signature]*  
Keeper of The National Register

Date **4-16-76**

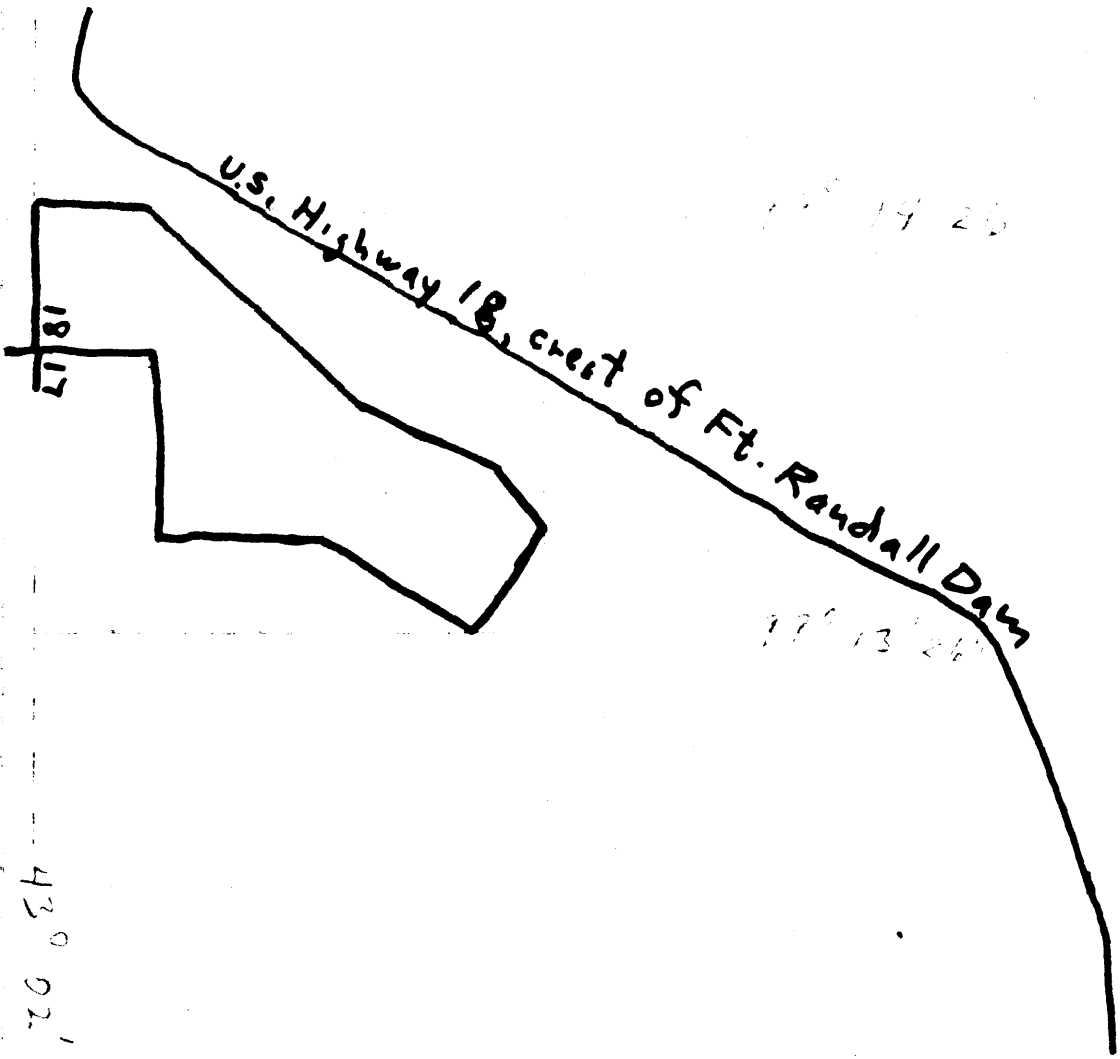

43° 02' 31\"/>

43° 02' 31\"/>



Form 10-301  
(July 1968)

UNITED STATES DEPARTMENT OF THE INTERIOR  
NATIONAL PARK SERVICE

**NATIONAL REGISTER OF HISTORIC PLACES  
PROPERTY MAP FORM**

*(Type all entries - attach to or enclose with map)*

**1. NAME**

COMMON	AND/OR HISTORIC	NUMERIC CODE <i>(Assigned by NPS)</i>
Fort Randall	Fort Randall	APR 22 1976

**2. LOCATION**

STATE	COUNTY	TOWN
South Dakota	Gregory	3 miles west of Pickstown

STREET AND NUMBER

**3. MAP REFERENCE**

SOURCE	DATE	SCALE
U. S. Army Corps of Engineers, Omaha	June, 1965	1" = 2,000'

REQUIREMENTS: PROPERTY BOUNDARIES, WHERE REQUIRED, AND NORTH ARROW.

