

NATIONAL REGISTER OF HISTORIC PLACES  
INVENTORY - NOMINATION FORM

STATE:  
California

COUNTY:  
San Francisco

FOR NPS USE ONLY

|              |      |
|--------------|------|
| ENTRY NUMBER | DATE |
| MAR 8 1973   |      |

(Type all entries - complete applicable sections)

1. NAME

COMMON: House at 1624 Post Street Western Addition Project Area Two

AND/OR HISTORIC: 1624 Post Street 1813-1813 Bldg Sutter Street

2. LOCATION

STREET AND NUMBER:  
1624 Post Street

CITY OR TOWN:  
San Francisco

STATE: California CODE: 06 COUNTY: San Francisco CODE: 075

3. CLASSIFICATION

| CATEGORY<br>(Check One)   | OWNERSHIP   | STATUS  | ACCESSIBLE TO THE PUBLIC   |
|---|---|---|--|
| <input type="checkbox"/> District<br><input type="checkbox"/> Site<br><input type="checkbox"/> Object<br><input checked="" type="checkbox"/> Building<br><input type="checkbox"/> Structure | <input type="checkbox"/> Public<br><input checked="" type="checkbox"/> Private<br><input type="checkbox"/> Both | <input type="checkbox"/> Occupied<br><input checked="" type="checkbox"/> Unoccupied<br><input type="checkbox"/> Preservation work in progress | Yes:<br><input checked="" type="checkbox"/> Restricted<br><input type="checkbox"/> Unrestricted<br><input type="checkbox"/> No |

PRESENT USE (Check One or More as Appropriate)

|  |                                     |   |  |                                   |
|--|-------------------------------------|---|--|-----------------------------------|
| <input type="checkbox"/> Agricultural  | <input type="checkbox"/> Government | <input type="checkbox"/> Park                         | <input type="checkbox"/> Transportation  | <input type="checkbox"/> Comments |
| <input type="checkbox"/> Commercial    | <input type="checkbox"/> Industrial | <input checked="" type="checkbox"/> Private Residence | <input type="checkbox"/> Other (Specify) |                                   |
| <input type="checkbox"/> Educational   | <input type="checkbox"/> Military   | <input type="checkbox"/> Religious                    |  |                                   |
| <input type="checkbox"/> Entertainment | <input type="checkbox"/> Museum     | <input type="checkbox"/> Scientific                   |  |                                   |

4. OWNER OF PROPERTY

OWNER'S NAME:  
~~San Francisco Redevelopment Agency~~ Byron & Carla Trott

STREET AND NUMBER:  
762 Fulton Street

CITY OR TOWN: San Francisco STATE: California CODE: 06

5. LOCATION OF LEGAL DESCRIPTION

COURTHOUSE, REGISTRY OF DEEDS, ETC.:  
San Francisco Assessor's Office

STREET AND NUMBER:  
City Hall

CITY OR TOWN: San Francisco STATE: California CODE: 06

6. REPRESENTATION IN EXISTING SURVEYS

TITLE OF SURVEY: San Francisco Conservation Committee Survey\*  
(Under the auspices of San Francisco Redevelopment Agency)

DATE OF SURVEY: 1962  Federal  State  County  Local

DEPOSITORY FOR SURVEY RECORDS:  
San Francisco Redevelopment Agency

STREET AND NUMBER:  
762 Fulton Street

CITY OR TOWN: San Francisco STATE: California CODE: 06

STATE: California

COUNTY: San Francisco

ENTRY NUMBER

DATE

FOR NPS USE ONLY

\*Also: Junior League of San Francisco Survey  
(Both surveys were adopted by the Landmarks Preservation Advisory Board of the City and County of San Francisco.)

SEE INSTRUCTIONS

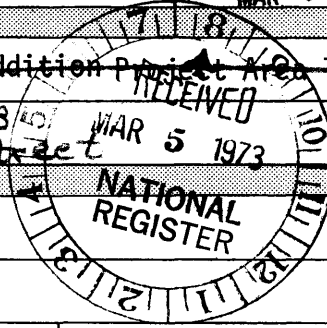

See letter 5/16/75

**7. DESCRIPTION**

|           |                                    |   |                               |   |  |                                    |
|-----------|------------------------------------|---|-------------------------------|---|--|------------------------------------|
| CONDITION | (Check One)                        |   |                               |   |  |                                    |
|           | <input type="checkbox"/> Excellent | <input checked="" type="checkbox"/> Good      | <input type="checkbox"/> Fair | <input type="checkbox"/> Deteriorated     | <input type="checkbox"/> Ruins         | <input type="checkbox"/> Unexposed |
|           | (Check One)                        |   |                               | In process (Check One)                    |  |                                    |
|           | <input type="checkbox"/> Altered   | <input checked="" type="checkbox"/> Unaltered |                               | <input checked="" type="checkbox"/> Moved | <input type="checkbox"/> Original Site |                                    |

DESCRIBE THE PRESENT AND ORIGINAL (if known) PHYSICAL APPEARANCE

This is a narrow two-story wood frame single family dwelling. The facade strongly emphasizes the vertical with a two-story high bay window, doorway and single upper window, all being tall, narrow and rectangular; the decorative elements as well are almost entirely vertical. In recent years the painting of the exterior has been applied to emphasize the extreme angularity and straightness of the architectural elements and ornamental detailing. The walls, consoles, cornice and background are in dark color, and the details are given emphasis by being painted in sharply contrasting white. This represents a return to the earlier practice in San Francisco where polychrome painting was the rule, whereas in the intermediate period of the history of Victorian structures a rather uniform grey or white was standard for the entire structure.

The elements of the facade composition are simple: a two-story angled bay window reaching almost to the ground on the east side and a narrow single opening (doorway at main story, window at second) to balance it on the opposite side. All openings are similar in design; being round-headed with double-hung windows, flanked by simple flat pilasters and with rectangular panels below the windows in the bays. A single window occupies each face of the bay at each story. Flat projecting cornices are above each opening. The cornices are unsupported in the bay, but the doorway has carved brackets; one on each side and above the doorway arch is a carved pierced wooden detail. The arch at the single upstairs window above the door has a keystone in wood. The flat roof projects out from the wall, forming a dominant roof cornice supported by detailed eave brackets separated by rectangular panels. The entire facade is faced with rusticated siding.

Even though this building was owned by many absentee landlords, it has remained in good condition through the years. This handsome Victorian structure is to be moved one block into a beautiful row of similar Italianate Victorians.

SEE INSTRUCTIONS



**SIGNIFICANCE**

PERIOD (Check One or More as Appropriate)

- |  |                                       |  |                                       |
|--|---------------------------------------|--|---------------------------------------|
| <input type="checkbox"/> Pre-Columbian | <input type="checkbox"/> 16th Century | <input type="checkbox"/> 18th Century            | <input type="checkbox"/> 20th Century |
| <input type="checkbox"/> 15th Century  | <input type="checkbox"/> 17th Century | <input checked="" type="checkbox"/> 19th Century |                                       |

SPECIFIC DATE(S) (If Applicable and Known) 1876

AREAS OF SIGNIFICANCE (Check One or More as Appropriate)

- |  |   |  |  |
|--|---|--|--|
| <input type="checkbox"/> Aboriginal              | <input type="checkbox"/> Education              | <input type="checkbox"/> Political           | <input type="checkbox"/> Urban Planning  |
| <input type="checkbox"/> Prehistoric             | <input type="checkbox"/> Engineering            | <input type="checkbox"/> Religion/Philosophy | <input type="checkbox"/> Other (Specify) |
| <input type="checkbox"/> Historic                | <input type="checkbox"/> Industry               | <input type="checkbox"/> Science             | _____                                    |
| <input type="checkbox"/> Agriculture             | <input type="checkbox"/> Invention              | <input type="checkbox"/> Sculpture           | _____                                    |
| <input checked="" type="checkbox"/> Architecture | <input type="checkbox"/> Landscape Architecture | <input type="checkbox"/> Social/Humanitarian | _____                                    |
| <input type="checkbox"/> Art                     | <input type="checkbox"/> Literature             | <input type="checkbox"/> Theater             | _____                                    |
| <input type="checkbox"/> Commerce                | <input type="checkbox"/> Military               | <input type="checkbox"/> Transportation      | _____                                    |
| <input type="checkbox"/> Communications          | <input type="checkbox"/> Music                  |  | _____                                    |
| <input type="checkbox"/> Conservation            |   |  | _____                                    |

STATEMENT OF SIGNIFICANCE

The San Francisco Water Department records show this building as being connected to the water system in 1876. The Junior League of San Francisco's book Here Today concurs with this date.

The original owner was Mr. or Ms. Gantzer who lived at 417 Kearny Street. This Italianate Victorian structure was built as a rental property. After the original owner, there were six owners before the final purchase by the San Francisco Redevelopment Agency. All of the previous owners were absentee landlords.

This Italianate Victorian structure survived the 1906 earthquake and fire and has remained in good condition up to the present. Because this building is within the Japanese section of the Western Addition, its previous uses have been varied and interesting, including its use as a Bonsai store and currently as a Japanese church.

Because of the zoning within the project area, this building has to be either demolished or moved to a more suitable location where it can be rehabilitated and preserved.

1624 Post is to be moved to Block 685, Lot 30, which is still within the Japanese section of the Western Addition (Nihon Machi) and will be one of a row of extremely handsome Italianate Victorians on Sutter near Buchanan, one of which has just completed rehabilitation. 1624 Post Street is one of the six most important Victorian structures chosen by the San Francisco Landmarks Preservation Advisory Board as having exceptional merit.



SEE INSTRUCTIONS

**9 MAJOR BIBLIOGRAPHICAL REFERENCES**

Junior League of San Francisco, Inc. Here Today- San Francisco's Architectural Heritage, (Chronicle Books, San Francisco, 1968)

**10. GEOGRAPHICAL DATA**

| LATITUDE AND LONGITUDE COORDINATES DEFINING A RECTANGLE LOCATING THE PROPERTY |                         |                         | O<br>R | LATITUDE AND LONGITUDE COORDINATES DEFINING THE CENTER POINT OF A PROPERTY OF LESS THAN TEN ACRES |                         |  |
|---|-------------------------|-------------------------|--------|---|-------------------------|--|
| CORNER  | LATITUDE                | LONGITUDE               |        | LATITUDE  | LONGITUDE               |  |
|   | Degrees Minutes Seconds | Degrees Minutes Seconds |        | Degrees Minutes Seconds   | Degrees Minutes Seconds |  |
| NW  | ° ' "                   | ° ' "                   |        | N37° 47' 10"  | W122° 25' 40"           |  |
| NE  | ° ' "                   | ° ' "                   |        |   |                         |  |
| SE  | ° ' "                   | ° ' "                   |        |   |                         |  |
| SW  | ° ' "                   | ° ' "                   |        |   |                         |  |

APPROXIMATE ACREAGE OF NOMINATED PROPERTY: **1,679 sq. ft.**

LIST ALL STATES AND COUNTIES FOR PROPERTIES OVERLAPPING STATE OR COUNTY BOUNDARIES

| STATE: | CODE | COUNTY | CODE |
|--------|------|--------|------|
|        |      |        |      |
|        |      |        |      |
|        |      |        |      |
|        |      |        |      |

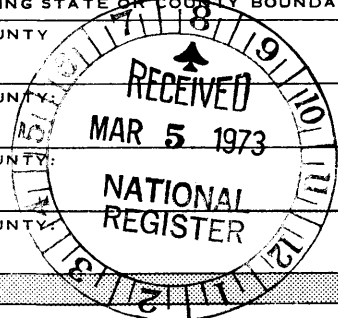

UTM  
10/55038  
4182020  
CD

SEE INSTRUCTIONS

**11. FORM PREPARED BY**

NAME AND TITLE: **Enid T. Sales, Rehabilitation Supervisor; Susan Bragstad, Architect**

ORGANIZATION: **SAN Francisco Redevelopment Agency \*** DATE: **January 9, 1973**

STREET AND NUMBER: **762 Fulton Street**

CITY OR TOWN: **San Francisco** STATE: **California** CODE: **06**

**12. STATE LIAISON OFFICER CERTIFICATION NATIONAL REGISTER VERIFICATION**

|   |   |
|---|---|
| <p>As the designated State Liaison Officer for the National Historic Preservation Act of 1966 (Public Law 89-665), I hereby nominate this property for inclusion in the National Register and certify that it has been evaluated according to the criteria and procedures set forth by the National Park Service. The recommended level of significance of this nomination is:</p> <p>National <input type="checkbox"/> State <input type="checkbox"/> Local <input checked="" type="checkbox"/></p> <p>Name <u><i>[Signature]</i></u></p> <p>Title <u>State Liaison Officer</u></p> <p>Date <b>FEB 12 1972</b></p> | <p>I hereby certify that this property is included in the National Register.</p> <p><u><i>[Signature]</i></u><br/>Chief, Office of Archeology and Historic Preservation</p> <p>Date <u>3/8/73</u></p> <p>ATTEST:</p> <p><u><i>[Signature]</i></u><br/>Keeper of The National Register</p> <p>Date <u>3.7.73</u></p> |
|---|---|

Also San Francisco Landmarks Preservation Advisory Board  
100 Larkin Street  
San Francisco, California 06

WEBSTER ST.

POST ST.

SUTTER ST.

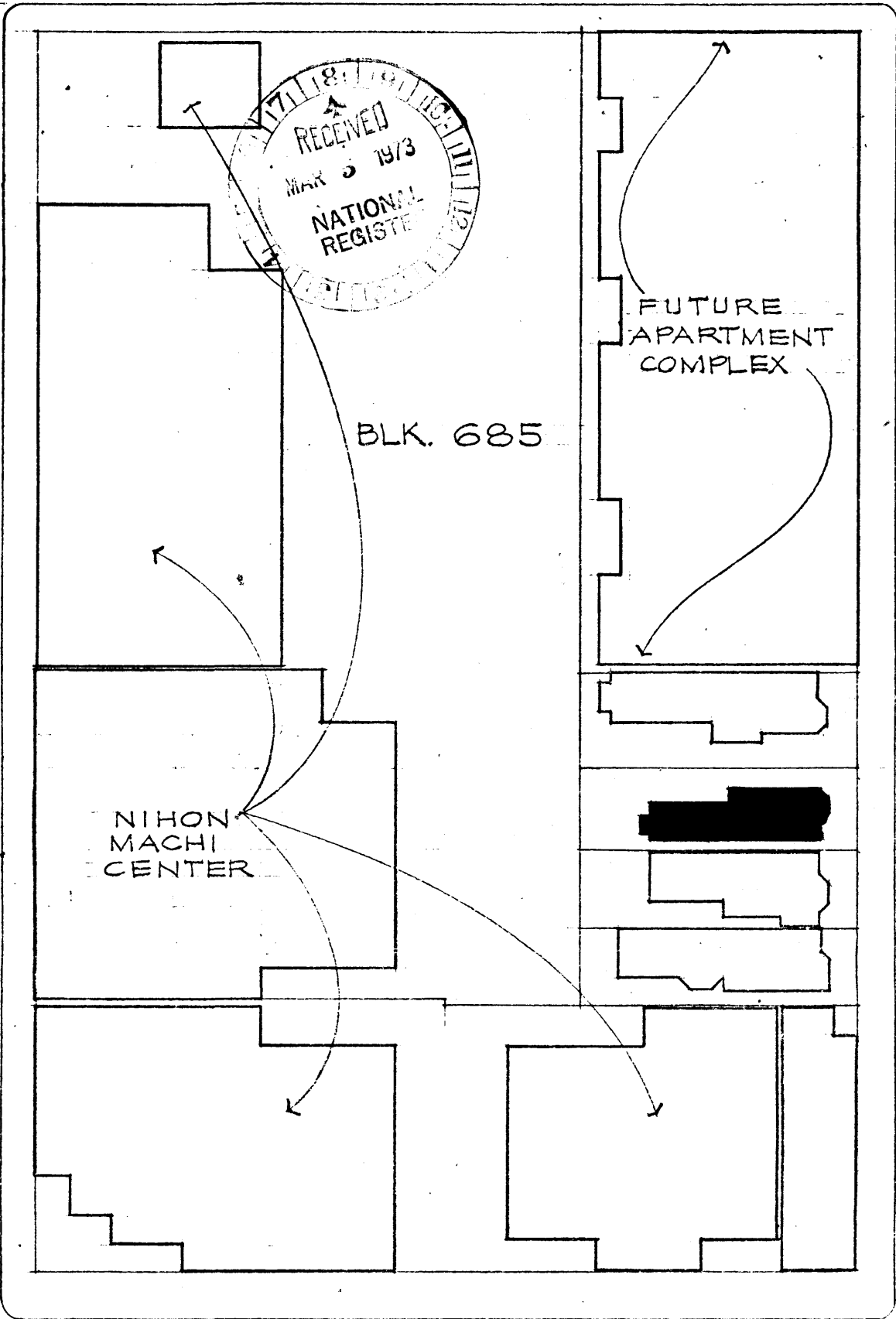

RECEIVED  
MAR 5 1973  
NATIONAL REGISTER

BLK. 685

FUTURE APARTMENT COMPLEX

NIHON MACHI CENTER

BUCHANAN ST.

LEGEND - MAP C: DEVELOPMENT PLAN

 NEW LOCATION OF 1624 POST  
 BLDGS. TO BE REHABILITATED

JAN. 8, 1973

NORTH



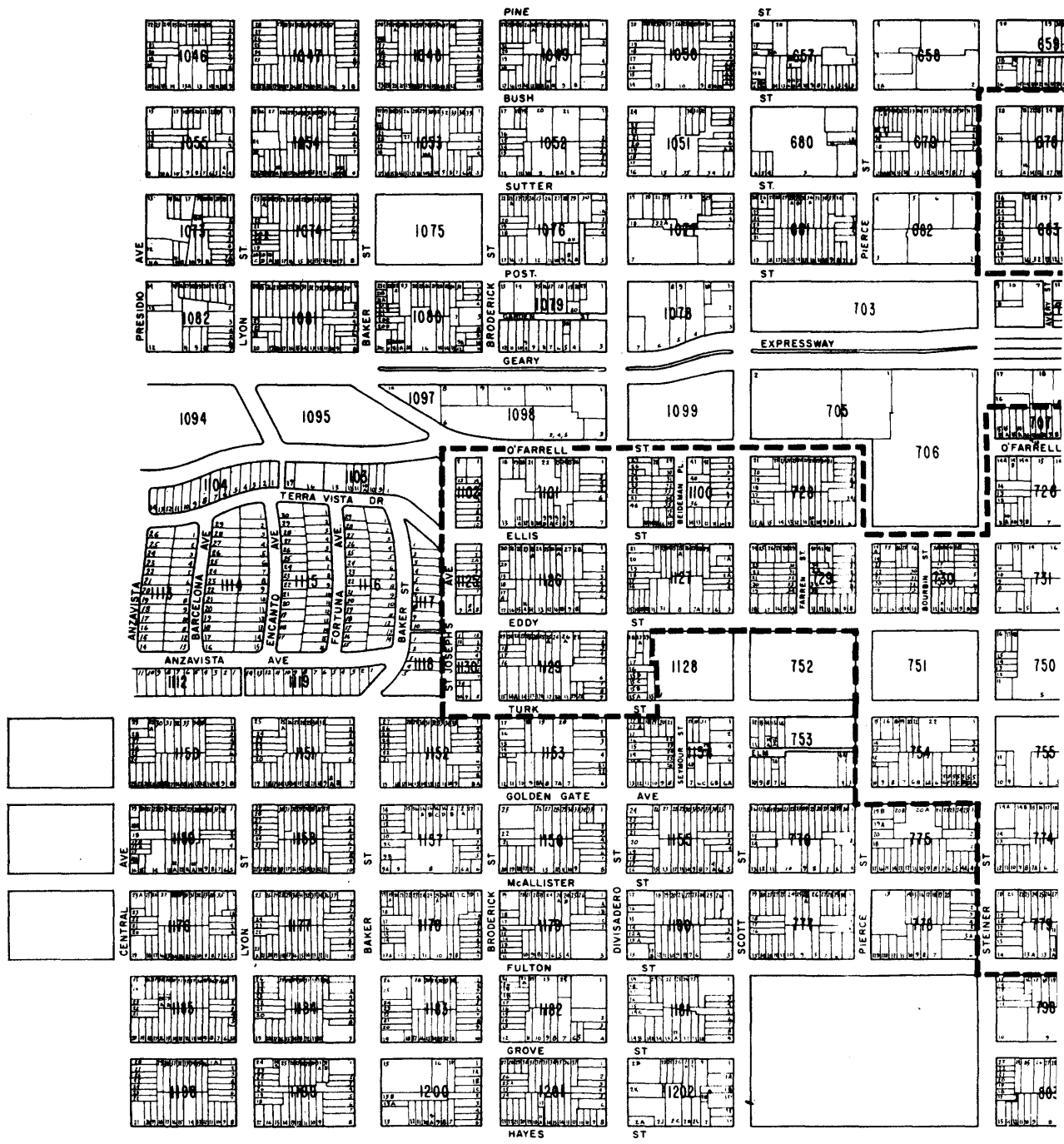

**LEGEND**      - - - - - PROJECT BOUNDARY

**WESTERN ADDIT**

**MAP B: RELOCATION OF 1624 POST**

- EXIST. LOCATION
- NEW LOCATION

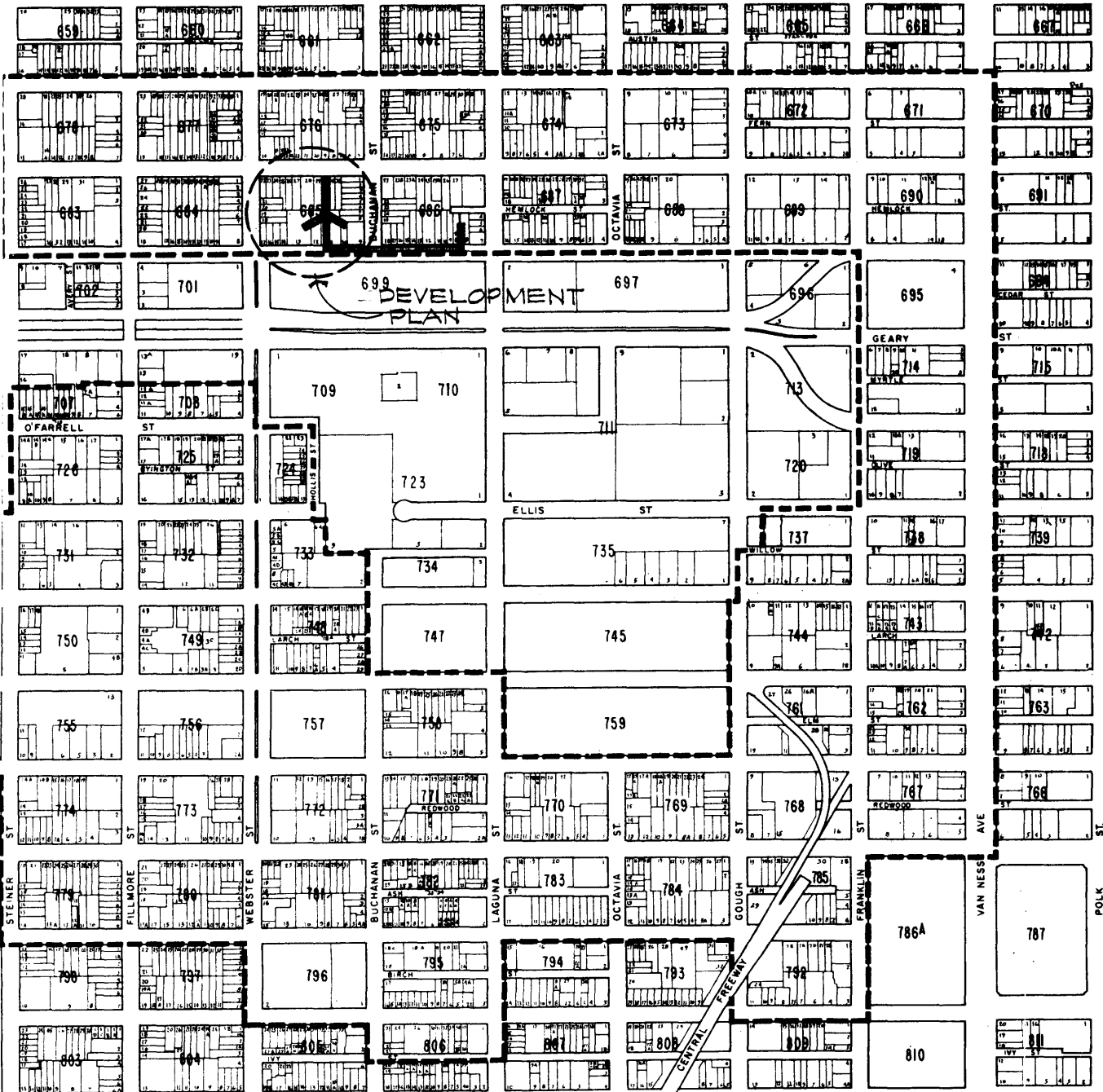

94102

ADDITION AREA TWO

ST

(REFER TO MAP "C" FOR DEVELOPMENT PLAN)

