

SITE #82-10-8-W1334 MAP NUMBER 7
HISTORIC DISTRICT
NAME St. Mary's Academy ✓
ADDRESS 1334 W. 8th St. ✓

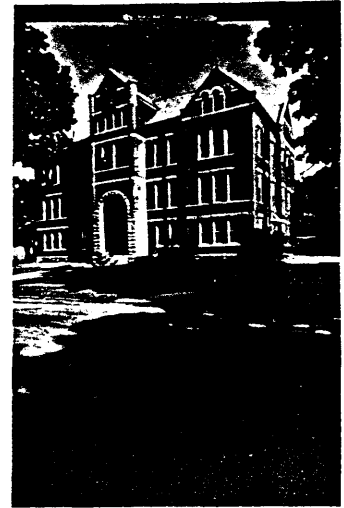

LEGAL DESCRIPTION Mitchell's 3rd Add., Blk. 20,
Lots 1 & 2

ACREAGE ap.2 ZONE R6M UTM 15/700750 4599940
OWNER Andrea & Emelia Bajc TITLE H
6206 Telegraph Rd.
Davenport IA

DESCRIPTION

ARCHITECTURAL STYLE Romanesque Revival DATE 1888
FORM 3-1/2 stories, rectangular plan, hipped roof; advanced corner
and end pavilions w/parapet gables; symmetrical front
MATERIALS red brick; rockfaced and smooth-dressed limestone
FENESTRATION primarily 1/1 d.h.s. beneath slab lintels; round arched windows
grouped in gable ends; triple windows beneath wide segmented arches on front
corner pavilions
FEATURES entry recessed within large round arch; decorative stonework on
entrance pavilion corner turrets; red-black brick diapering; cast-iron entry
with art glass and classical details
ALTERATIONS converted to apartments; no major exterior alterations since
early 20C chapel addition on north side
SITE shaded corner lot in late 19th century residential area

ARCHITECTURAL SIGNIFICANCE

Designed in the Victorian Romanesque Revival style, St. Mary's Academy features polychrome brick-and-stone facades, judicious use of the round arch, a brick corbel table, and prominent parapetted gables marking corners and the main entrance. This entrance, of cast iron with art glass and Greek fret decorative elements, is particularly fine. The rear chapel addition, dating from the turn of the century, continues the Romanesque theme in the round arches of its upper story windows. The result is an excellent illustration of the adaptation of the Romanesque Revival to institutional building forms.

HISTORICAL DATA

The Sisters of Mercy opened this building as a Roman Catholic school in 1889, calling it St. Mary's Academy. By the 1930's, the building had been converted to a home for the aged, operated under the auspices of St. Mary's Church.

HISTORICAL SIGNIFICANCE

SOURCES Davenport City Directories, 1890-91, 1892-3, 1938
Sanborn Fire Insurance Co. Map, Davenport, Iowa 1938

ARCHITECTURAL EVALUATION

DESIGN excellent STATURE landmark
LEVEL OF SIGNIFICANCE local

CONTEXT excellent FABRIC good/exc
DISTRICT CLASSIFICATION

HISTORICAL EVALUATION

PRIMARY THEME
LEVEL OF SIGNIFICANCE

SECONDARY THEME

NATIONAL REGISTER ELIGIBLE YES

PHOTO ID 1733-10,11

Martha H. Bowers, Architectural Historian

Marlys Svendsen, Historian

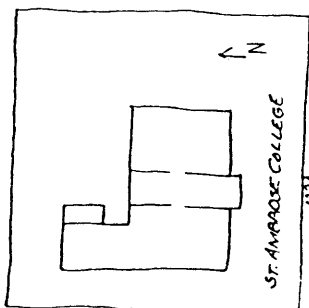

FOR DIVISION OF HISTORIC PRESERVATION USE ONLY

1 DATE RECEIVED _____

2 DATE OF STAFF EVALUATION _____

	A ARCHITECTURAL	B HISTORICAL
ELIGIBLE FOR NRHP	<input type="checkbox"/>	<input type="checkbox"/>
NOT ELIGIBLE FOR NRHP	<input type="checkbox"/>	<input type="checkbox"/>

3 NRHP ACTION

A STATE REVIEW COMM	APP <input type="checkbox"/>	DISAPP <input type="checkbox"/>	TABLED <input type="checkbox"/>	DATE _____
B FEDERAL REVIEW	APP <input type="checkbox"/>	DISAPP <input type="checkbox"/>	TABLED <input type="checkbox"/>	DATE _____

4 DHP SOURCES

<input type="checkbox"/> COUNTY RESOURCES	<input type="checkbox"/> DET OF ELIGIBILITY
<input type="checkbox"/> W SHIELD SURVEY	<input type="checkbox"/> R B C _____
<input type="checkbox"/> NRHP	<input checked="" type="checkbox"/> DAVENPORT A/H SURVEY
<input type="checkbox"/> GRANT _____	<input type="checkbox"/> _____

5 SUBJECT TRACES _____

6 PHOTO _____